



# Route Log Progress Chart

**DRAFT**

Please Note: Errors and Omissions May Exist.  
Contact the VTrans Mapping Unit with questions or concerns.

DISTRICT	TOWN	ROUTE
1	MANCHESTER	Maj-0171

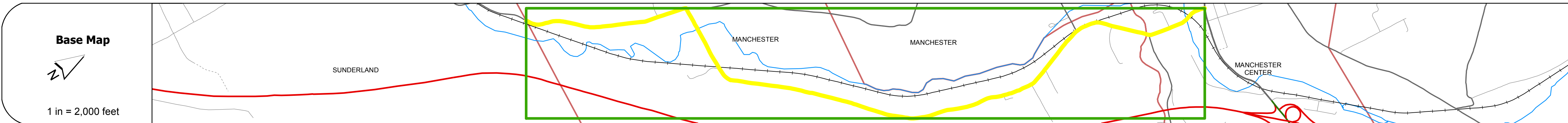
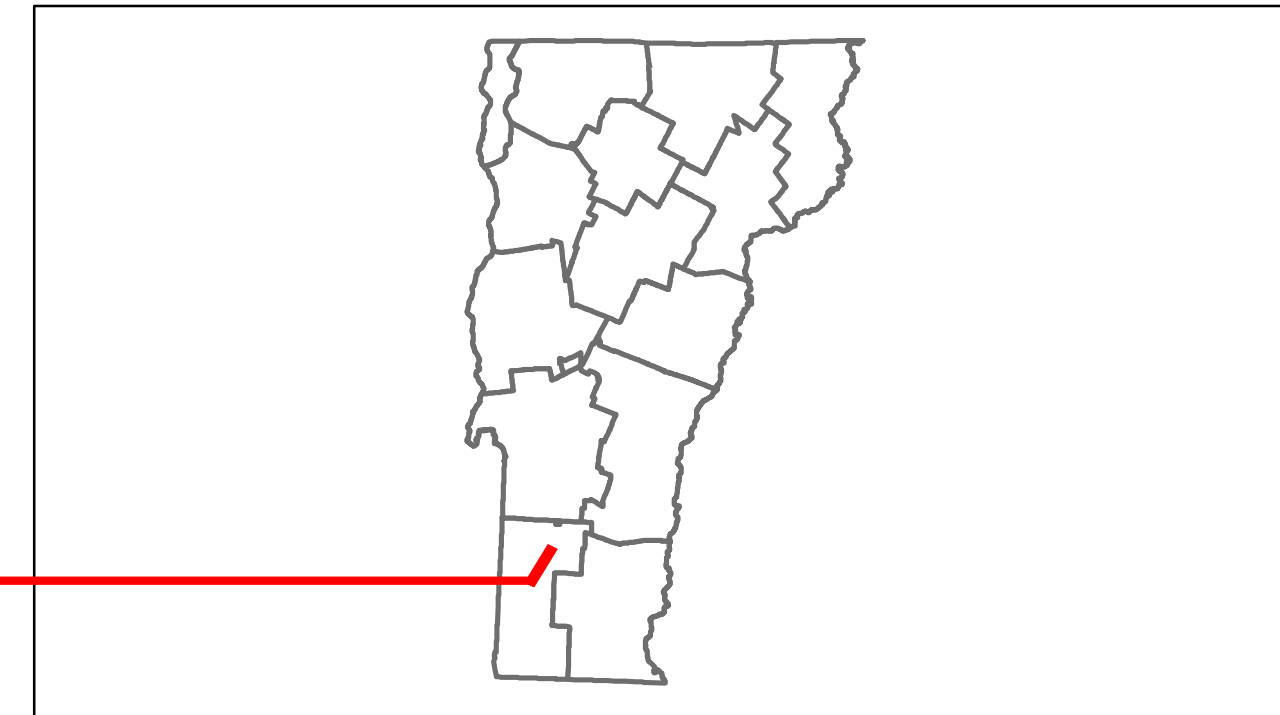

**Stick Diagram**

- Town Boundary
- Village/UC Boundaries
- District Boundaries
- State/Town Highway Change
- Divided Highway Limits
- Ghost Section Boundary
- FAU Limits
- Streams
- Town Center
- Primary Structures
- Secondary Structures
- Stations (Feet)
- Railroad Crossings
- Divided State Highway
- State Highway
- Divided Class 1 Town Highway
- Class 1 Town Highway

Scale: 1 INCH = 2000 FEET

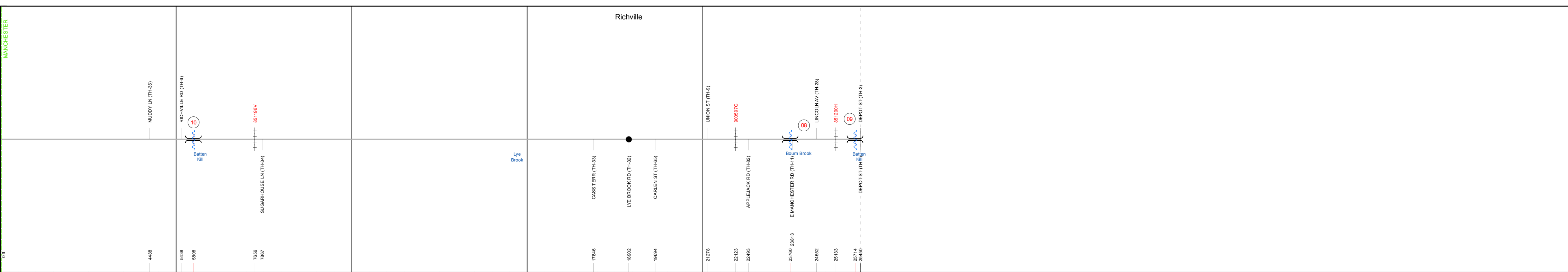

<b>Road Widths</b>	Travellane: 21, 24, 21, 22, 21, 22, 30	Roadway: 25, 28, 25, 28, 27, 24, 34	Lane Count: [Blank]	Base: [Blank]	Subbase: [Blank]
<b>Curves</b>	[Blank]	[Blank]	[Blank]	[Blank]	[Blank]
<b>Grades</b>	[Blank]	[Blank]	[Blank]	[Blank]	[Blank]
<b>Historic Projects</b>	[Blank]	[Blank]	[Blank]	[Blank]	[Blank]
<b>Maintenance Garage</b>	[Blank]	[Blank]	[Blank]	[Blank]	[Blank]
<b>Traffic Counters</b>	568310	568312, 568263	568275, 568313, 568177	[Blank]	[Blank]
<b>Functional Class</b>	7				
<b>Speed Zone</b>	[Blank]	[Blank]	[Blank]	[Blank]	[Blank]
<b>AADT Counts</b>	2012: 1100, 2011: 1100, 2010: 1100, 2009: 1100, 2008: 1000	2012: 950, 2011: 940, 2010: 950, 2009: 970, 2008: 980	[Blank]	[Blank]	[Blank]
<b>Crash Locations</b>	2012: [Blank], 2011: [Blank], 2010: [Blank], 2009: [Blank], 2008: [Blank]	[Blank]	[Blank]	[Blank]	[Blank]

**DESCRIPTION BLOCK**

**Bridge 10:**  
Stringer/multi-beam or girder - 1969  
Structure No. 200171001002062  
Length: 95'  
Width: 28.8'  
Facility Carried: TR 06 FAS 171  
Bridge Type: 3- SP CONT ROLLED BM  
Features Intersected: BATTEN KILL RIVER  
Surface: Bituminous  
Maintenance/Ownership: Town

**Bridge 8:**  
Tee Beam - 1929  
Structure No. 200171000802062  
Length: 44'  
Width: 22.8'  
Facility Carried: TR 06 FAS 171  
Bridge Type: CONCRETE T-BEAM  
Features Intersected: BOURN BROOK  
Surface: Bituminous  
Maintenance/Ownership: Town

**Bridge 9:**  
Stringer/multi-beam or girder - 1955  
Structure No. 200171000902062  
Length: 69'  
Width: 23.9'  
Weight Limit: 0  
Facility Carried: TR 06 FAS 171  
Bridge Type: ROLLED BEAM  
Features Intersected: BATTEN KILL RIVER  
Surface: Bituminous  
Maintenance/Ownership: Town

<b>Historic Projects</b>	<b>Functional Class</b>	<b>Curves</b>	<b>Road Widths</b>	<b>AADT</b>	<b>Mileage by Functional Class By Sheet</b>	<b>Mileage by Town By Sheet</b>	<b>DISTRICT</b>	<b>TOWN</b>	<b>Date: 05/21/14</b>	<b>ROUTE</b>
Retreatment, Resurface, Unknown, Bituminous Mix, Skimmy Mix, Bituminous Seal	1-19, Speed Zones	Left, Right	(ft)	(count)	0171 7 - Rural - Major collector 4.900	MANCHESTER - S01710206 4.9 of 4.9	1	MANCHESTER	1 of 1 TWN mileage: 0.0 to 4.9	Maj-0171 ETE mileage: 5.91 to 10.81
		<b>Grades</b>	<b>Traffic Counters</b>	<b>Crash Locations</b>	<b>Total Mileage: 4.900 mi</b>	<b>Total Mileage: 4.9 mi</b>				