



Route Log Progress Chart

DRAFT

Please Note: Errors and Omissions May Exist.
Contact the VTrans Mapping Unit with questions or concerns.

DISTRICT	TOWN	ROUTE
4	POMFRET	Maj-0166

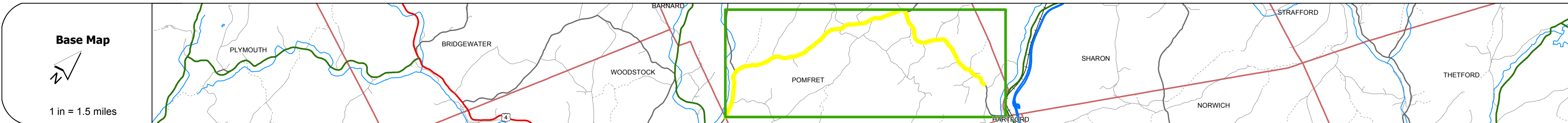
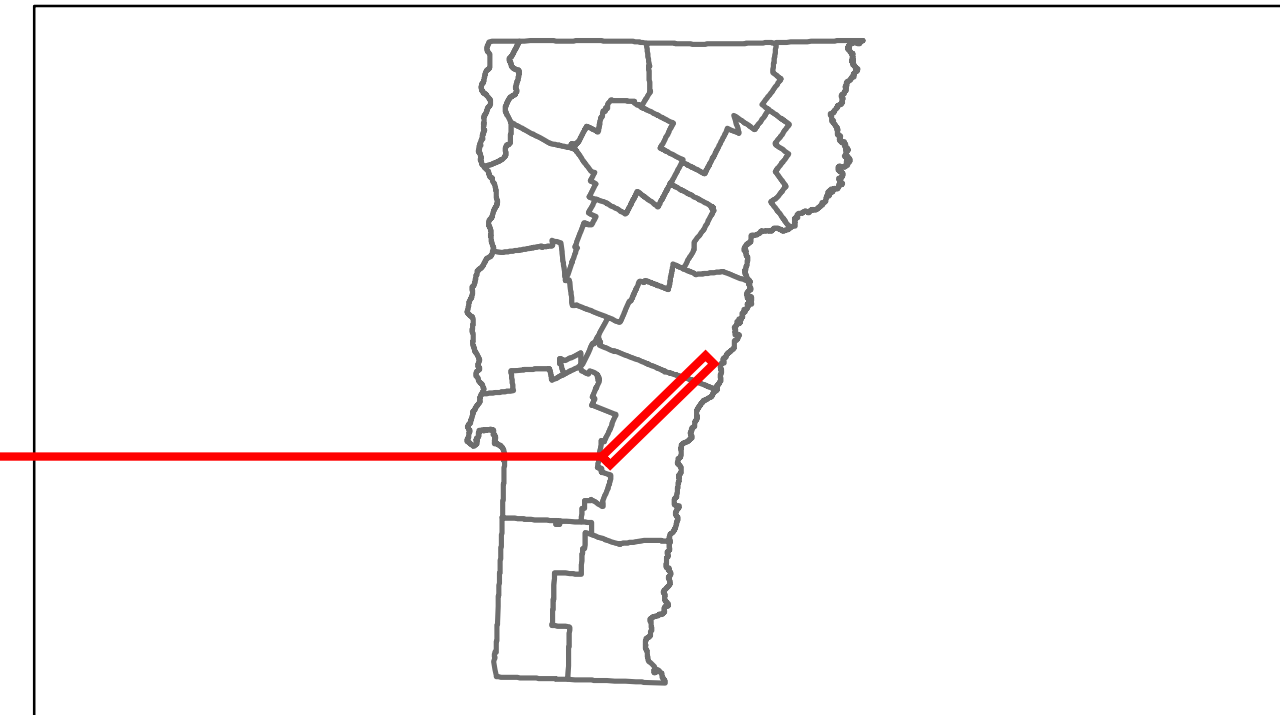

Stick Diagram

- Town Boundary
- Village/UC Boundaries
- District Boundaries
- State/Town Highway Change
- Divided Highway Limits
- Ghost Section Boundary
- FAU Limits
- Streams
- Town Center
- Primary Structures
- Secondary Structures
- Stations (Feet)
- Railroad Crossings
- Divided State Highway
- State Highway
- Divided Class 1 Town Highway
- Class 1 Town Highway

Scale: 1 INCH = 2000 FEET

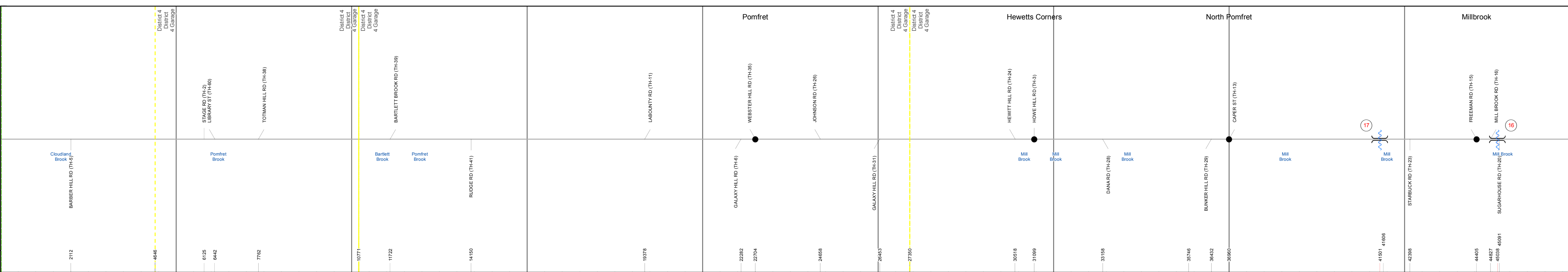

DESCRIPTION BLOCK

Bridge 17:
Stringer/multi-beam or girder - 1948
Structure No. 200166001714132
Length: 54'
Width: 26.5'
Weight Limit: 0
Facility Carried: TR 01 FAS 166
Bridge Type: ROLLED BEAM
Features Intersected: MILL BROOK
Surface: Bituminous
Maintenance/Ownership: Town

Bridge 16:
Slab - 1919
Structure No. 200166001614132
Length: 30'
Width: 28.0'
Weight Limit: 0
Facility Carried: TR 01 FAS 166
Bridge Type: CONCRETE SLAB
Features Intersected: MILL BROOK
Surface: Bituminous
Maintenance/Ownership: Town

	0	1	2	3	4	5	6	7	8	9
Road Widths										
Travellane			20			22			20	
Roadway			22			24			22	
Lane Count										
Base										
Subbase										
Curves										
Grades										
Historic Projects										
			1976: Unknown	1974: Unknown	1975: Unknown	1976: Unknown	1981: Unknown	1975: Unknown	1977: Unknown	1978: Unknown
	0: SA	1941: SA	1948: S, ST(1)	1949: SA	1950: SA	1951: SA	1952: SA	1953: SA	1954: SA	1955: SA
									1956: SA	1960: SA
										0: Unknown
Maintenance Garage							(Not State Maintained)			
Traffic Counters			SV1400		SV1333			SV1332		SV1331
Functional Class										
Speed Zone										
AADT Counts			2012: 1600		980		750		490	520
			2011: 1600		970		740		490	510
			2010: 1700		1000		770		510	510
			2009: 1700		1000		790		520	520
			2008: 1800		1100		820		540	520
Crash Locations										

<p>Historic Projects</p> <ul style="list-style-type: none"> Retreatment Resurface Unknown Bituminous Mix Skimpy Mix Bituminous Seal Gravel Surface Treated Gravel Plant Mix Reclaimed Base and Bituminous Concrete Concrete 	<p>Functional Class</p> <ul style="list-style-type: none"> 1 (Blue) 2 (Red) 3 (Green) 4 (Yellow) 5 (Purple) 6 (Orange) 7 (Pink) 8 (Light Blue) 9 (Light Green) 10 (Light Yellow) 11 (Light Purple) 12 (Light Orange) 13 (Light Pink) 14 (Light Light Blue) 15 (Light Light Green) 16 (Light Light Yellow) 17 (Light Light Purple) 18 (Light Light Orange) 19 (Light Light Pink) <p>Speed Zones</p> <ul style="list-style-type: none"> 25 30 35 40 45 50 55 60 65 	<p>Curves</p> <ul style="list-style-type: none"> Left Right <p>Grades</p> <ul style="list-style-type: none"> grade up grade down 	<p>Road Widths</p> <p>(ft)</p>	<p>Traffic Counters</p> <p>(counter ID)</p>	<p>Crash Locations</p> <ul style="list-style-type: none"> Fatal Property Damage Only Injury Unknown Crash Type 	<p>Mileage by Functional Class By Sheet</p> <p>0166 7 - Rural - Major collector 9.000</p>	<p>Mileage by Town By Sheet</p> <p>POMFRET - S01661413 9.0 of 10.15</p>	<p>DISTRICT</p> <p>4</p>	<p>TOWN</p> <p>POMFRET</p>	<p>Date: 05/21/14</p>	<p>ROUTE</p> <p>Maj-0166</p> <p>ETE mileage: 0.88 to 9.88</p>
						<p>Total Mileage: 9.000 mi</p>	<p>Total Mileage: 9.0 mi</p>				

For More Information Contact - Vermont Agency of Transportation, Policy, Planning and Intermodal Development Division - Mapping Unit, 1 National Life Drive, Montpelier, VT 05633-5001 Telephone: 802-828-2600.