



Route Log Progress Chart

DRAFT

Please Note: Errors and Omissions May Exist.
Contact the VTrans Mapping Unit with questions or concerns.

DISTRICT	TOWN	ROUTE
	ETE	I-93

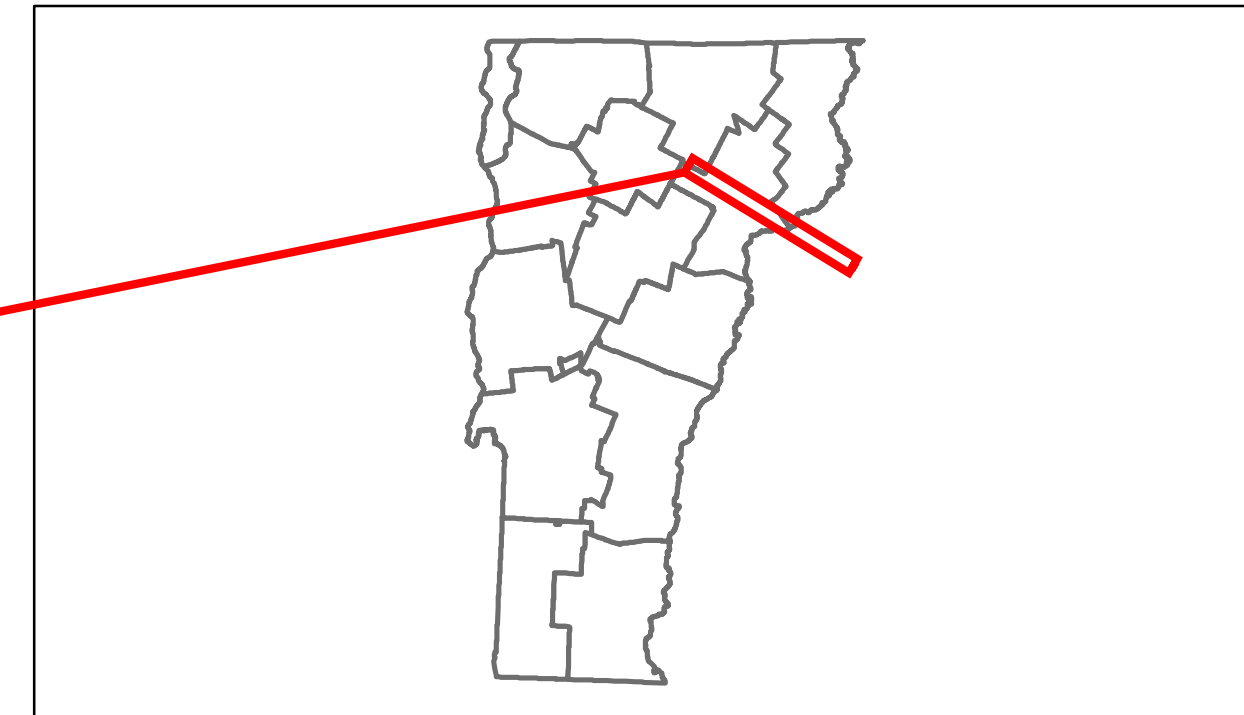

Base Map

1 in = 2 miles

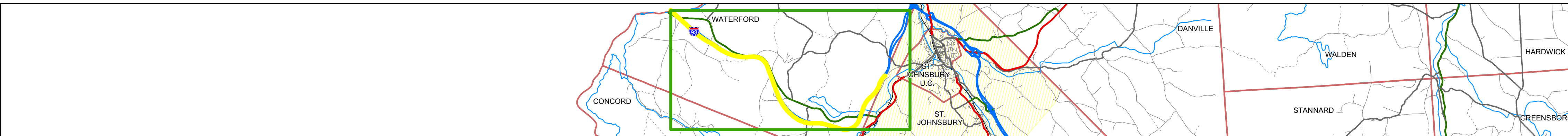

Stick Diagram

- Town Boundary
- Village/UC Boundaries
- District Boundaries
- State/Town Highway Change
- Divided Highway Limits
- Ghost Section Boundary
- FAU Limits
- Streams
- Town Center
- Primary Structures
- Secondary Structures
- Stations (Feet)
- Railroad Crossings
- Divided State Highway
- State Highway
- Divided Class 1 Town Highway
- Class 1 Town Highway

Scale: 1 INCH = 2000 FEET

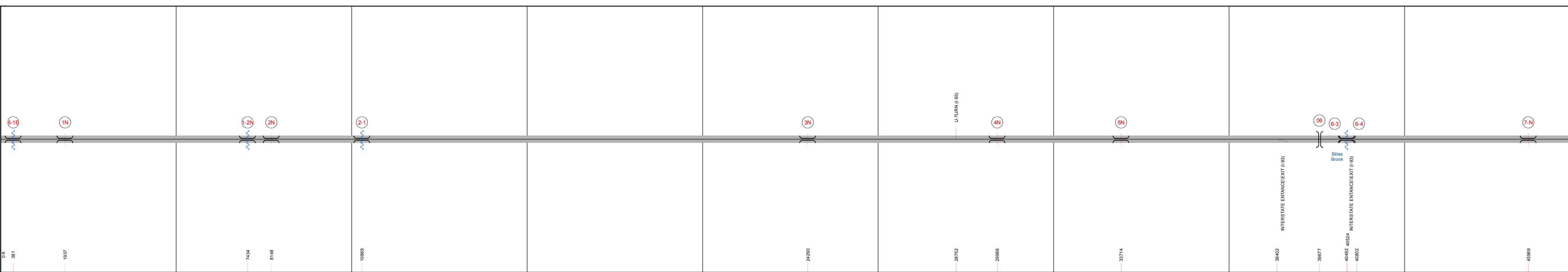

DESCRIPTION BLOCK

<p>Culvert 6-1B: Culvert - 1982 Structure No. 3000936-1B03161 Length: 14' Under Clearance: 7.0' Width: 36.7' Bridge Type: R C BOX Features Intersected: STILES BROOK Maintenance: State</p>	<p>Bridge 6-4: Culvert - 1982 Structure No. 30009306-403161 Length: 14' Under Clearance: 12.0' Facility Carried: I93 Bridge Type: R C BOX Features Intersected: LAND ACCESS ROAD Maintenance: State</p>
<p>Bridge 1N: Frame - 1982 Structure No. 200093001N03162 Length: 205' Width: 36.7' Under Clearance: 16.75' Facility Carried: I 00093 ML Bridge Type: STEEL RIGID FRAME Features Intersected: I 93 OVER VT 18 Surface: Bituminous Maintenance/Ownership: State</p>	<p>Bridge 7-N: Culvert - 1982 Structure No. 300093007N03161 Length: 14' Under Clearance: 12.0' Facility Carried: I93 Bridge Type: R C BOX Features Intersected: LAND ACCESS ROAD Maintenance: State</p>
<p>Culvert 1-2N: Culvert - 1982 Structure No. 3000931-2N03161 Length: 6' Under Clearance: 6.0' Facility Carried: I93 Bridge Type: ACCGMP Features Intersected: BROOK Maintenance: State</p>	
<p>Culvert 2N: Culvert - 1982 Structure No. 200093002N03162 Length: 28' Under Clearance: 14.17' Facility Carried: I 00093 ML Bridge Type: CONCRETE BOX Features Intersected: I 93 OVER TH NO 17 Maintenance/Ownership: State</p>	
<p>Culvert 2-1: Culvert - 1982 Structure No. 30009302-103161 Length: 7' Under Clearance: 7.0' Facility Carried: I93 Bridge Type: CCMPP Features Intersected: BROOK Maintenance: State</p>	
<p>Bridge 3N: Stringer/multi-beam or girder - 1982 Structure No. 200093003N03162 Length: 113' Width: 36.7' Under Clearance: 15.17' Facility Carried: I 00093 ML Bridge Type: WELDED PLATE GIRDER Features Intersected: I 93 OVER TH NO 12 Surface: Bituminous Maintenance/Ownership: State</p>	
<p>Culvert 4N: Culvert - 1982 Structure No. 200093004N03162 Length: 28' Under Clearance: 14.58' Facility Carried: I 00093 ML Bridge Type: CONCRETE BOX Features Intersected: I 93 OVER TH NO 1 Maintenance/Ownership: State</p>	
<p>Bridge 5N: Stringer/multi-beam or girder - 1982 Structure No. 200093005N03162 Length: 109' Width: 36.7' Under Clearance: 18.25' Facility Carried: I 00093 ML Bridge Type: WELDED PLATE GIRDER Features Intersected: I 93 OVER TH NO 7 Surface: Bituminous Maintenance/Ownership: State</p>	
<p>Bridge 6: Stringer/multi-beam or girder - 1982 Structure No. 200225000903162 Length: 214' Height: 0.0' Weight Limit: 0 Facility Carried: VT 00018 ML Bridge Type: 2 SP CONT WLD PL GIR Features Intersected: I 93 UNDER VT 18</p>	
<p>Culvert 6-3: Culvert - 1982 Structure No. 30009306-303161 Length: 9' Under Clearance: 7.0' Facility Carried: I93 Bridge Type: R C BOX Features Intersected: WATER MAIN SLEEVE Maintenance: State</p>	

Road Widths

Travellane: 42' 34'

Roadway Lane Count: 42' 34'

Base: 42' 34'

Subbase: 42' 34'

24	36	2	Two 2" 1/2" Plant Mix Base Courses	24" Crushed Stone
----	----	---	------------------------------------	-------------------

Curves

Grades

Historic Projects

1976: I 93-1(7)	1982: I 93-1(3) C1	1982: I 93-1(3) C2	1982: I 93-1(3) C3
1999: IM 093-1(9)			

Maintenance Garage

District 7 - St. Johnsbury Garage			
-----------------------------------	--	--	--

Traffic Counters

59C021	59C015
--------	--------

Functional Class

93-1	1 - Rural - Principal Arterial - Interstate
------	---

Speed Zone

--	--

AADT Counts

2012	6200	5900
2011	6200	5900
2010	6100	5900
2009	5900	5700
2008	5600	5400

Crash Locations

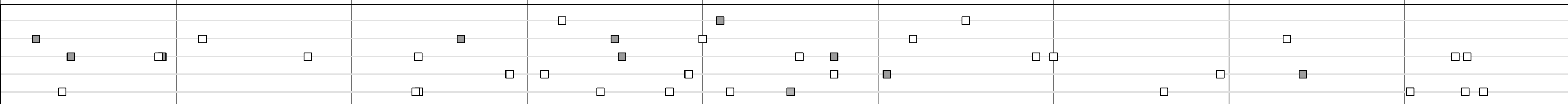

<p>Historic Projects</p> <ul style="list-style-type: none"> Retreatment Resurface Unknown Bituminous Mix Skimny Mix Bituminous Seal Gravel Surface Treated Gravel Plant Mix Reclaimed Base and Bituminous Concrete Concrete 	<p>Functional Class</p> <ul style="list-style-type: none"> 1 2 6 7 8 11 12 14 16 17 19 <p>Speed Zones</p> <p>25 30 35 40 45 50 55 60 65</p>	<p>Curves</p> <ul style="list-style-type: none"> Left Right <p>Grades</p> <ul style="list-style-type: none"> grade up grade down 	<p>Road Widths</p> <p>(ft)</p>	<p>Traffic Counters</p> <p>(counter ID)</p>	<p>Crash Locations</p> <ul style="list-style-type: none"> Fatal Injury Property Damage Only Unknown Crash Type 	<p>Mileage by Functional Class By Sheet</p> <p>93-1 1 - Rural - Principal Arterial - Interstate 9.000</p> <p>Total Mileage: 9.000 mi</p>	<p>Mileage by Town By Sheet</p> <p>ETE - I093-0000 9.0 of 11.104</p> <p>Total Mileage: 9.0 mi</p>	<p>DISTRICT</p> <p>ETE</p>	<p>TOWN</p> <p>ETE</p>	<p>Date: 05/21/14</p> <p>1 of 2</p> <p>TWN mileage: 0.0 to 9.0</p>	<p>ROUTE</p> <p>I-93</p> <p>ETE mileage: 0.0 to 9.0</p>
---	--	--	---------------------------------------	--	---	--	---	-----------------------------------	-------------------------------	---	---

For More Information Contact - Vermont Agency of Transportation, Policy, Planning and Intermodal Development Division - Mapping Unit, 1 National Life Drive, Montpelier, VT 05633-5001 Telephone: 802-828-2600.