



# Route Log Progress Chart

**DRAFT**

Please Note: Errors and Omissions May Exist.  
Contact the VTrans Mapping Unit with questions or concerns.

DISTRICT	TOWN	ROUTE
	ETE	I-91

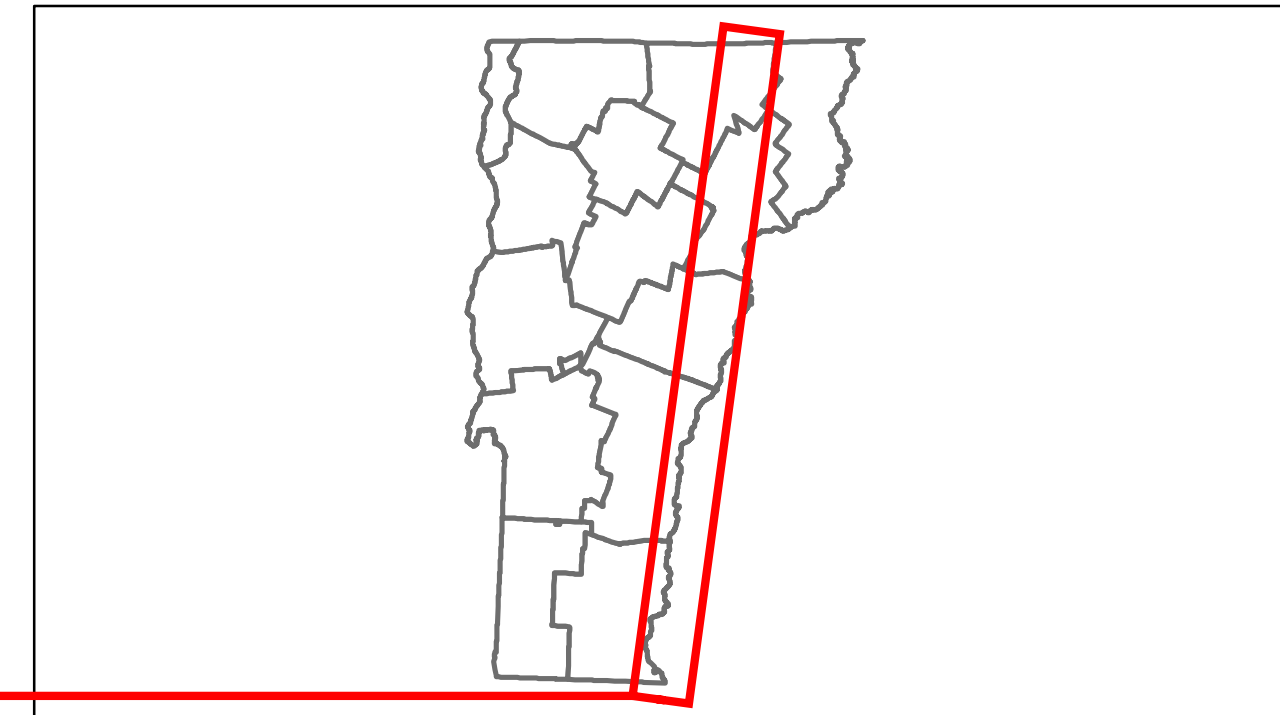

**Base Map**

1 in = 7 miles

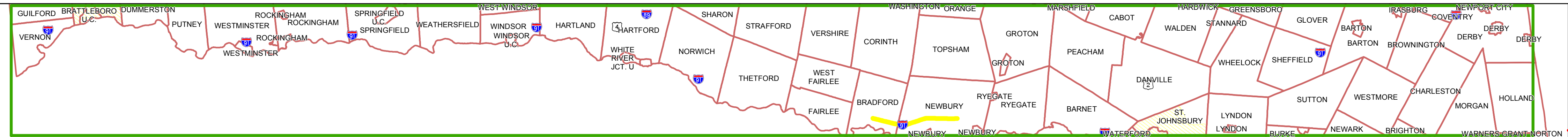

**Stick Diagram**

- Town Boundary
- Village/UC Boundaries
- District Boundaries
- State/Town Highway Change
- Divided Highway Limits
- Ghost Section Boundary
- FAU Limits
- Streams
- Town Center
- Primary Structures
- Secondary Structures
- Stations (Feet)
- Railroad Crossings
- Divided State Highway
- State Highway
- Divided Class 1 Town Highway
- Class 1 Town Highway

Scale: 1 INCH = 2000 FEET

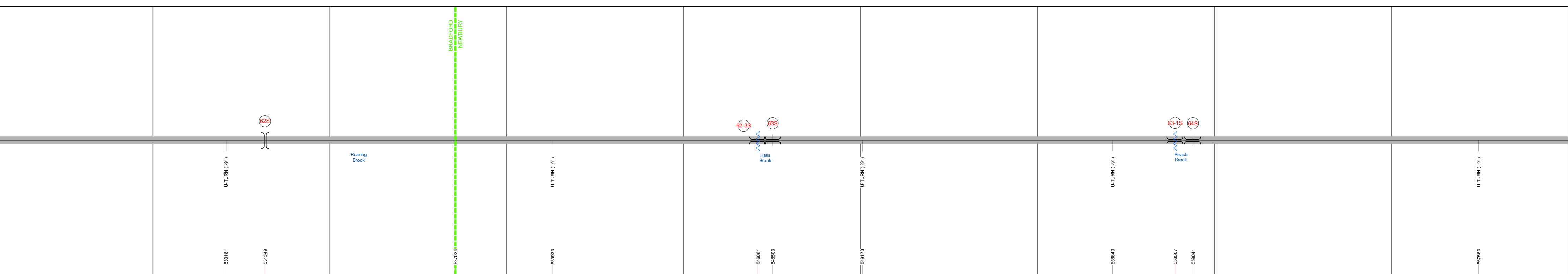

**Road Widths**

Travellane	
Roadway	
Lane Count	
Base	
Subbase	

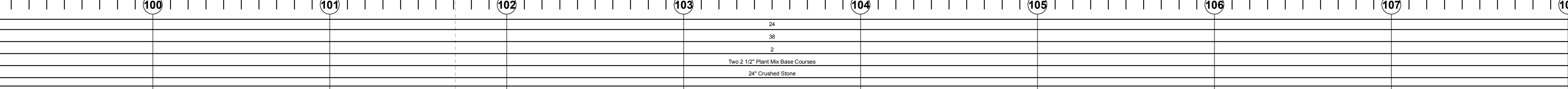

**Curves**

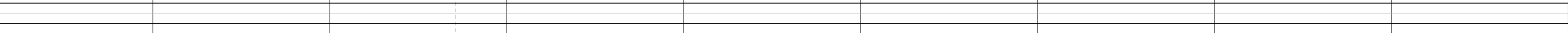

**Grades**

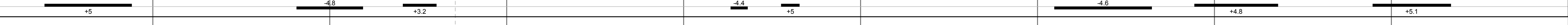

**Historic Projects**



**Maintenance Garage**



**Traffic Counters**

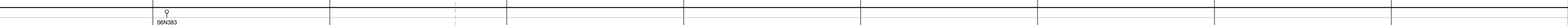

**Functional Class**

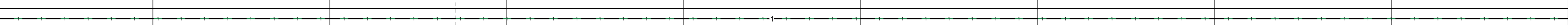

**Speed Zone**

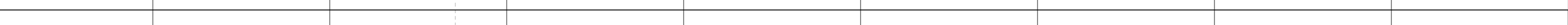

**AADT Counts**



**Crash Locations**



**DESCRIPTION BLOCK**

**Bridge 62S:**  
Stringer/multi-beam or girder - 1973  
Structure No. 200901D62S09011  
Length: 132'  
Height: 0.0'  
Weight Limit: 0  
Facility Carried: TR 00003  
Bridge Type: WELDED PLATE GIRDER  
Features Intersected: 1.91 UNDER TH NO 3

**Culvert 62-3S:**  
Culvert - 1974  
Structure No. 300091623S09071  
Length: 10'  
Under Clearance: 10.0'  
Facility Carried: 191  
Bridge Type: CGMP  
Features Intersected: HALLS BROOK  
Maintenance: State

**Bridge 63S:**  
Stringer/multi-beam or girder - 1973  
Structure No. 200901063S09072  
Length: 105'  
Width: 39.3'  
Under Clearance: 13.75'  
Facility Carried: I 00091 ML  
Bridge Type: WELDED PLATE GIRDER  
Features Intersected: 1.91 OVER TH NO 1  
Surface: Bituminous  
Maintenance/Ownership: State

**Culvert 63-1S:**  
Culvert - 1973  
Structure No. 300091631S09071  
Length: 18'  
Under Clearance: 12.0'  
Facility Carried: 191  
Bridge Type: CGMP  
Features Intersected: PEACH BROOK  
Maintenance: State

**Bridge 64S:**  
Stringer/multi-beam or girder - 1973  
Structure No. 200901064S09072  
Length: 128'  
Width: 36.6'  
Under Clearance: 14.0'  
Facility Carried: I 00091 ML  
Bridge Type: WELDED PLATE GIRDER  
Features Intersected: 1.91 OVER TH NO 4  
Surface: Bituminous  
Maintenance/Ownership: State

<p><b>Historic Projects</b></p> <ul style="list-style-type: none"> <li>Retreatment</li> <li>Resurface</li> <li>Unknown</li> <li>Bituminous Mix</li> <li>Skimny Mix</li> <li>Bituminous Seal</li> <li>Gravel</li> <li>Surface Treated Gravel</li> <li>Plant Mix</li> <li>Reclaimed Base and Bituminous Concrete</li> <li>Concrete</li> </ul>	<p><b>Functional Class</b></p> <ul style="list-style-type: none"> <li>1</li> <li>2</li> <li>3</li> <li>4</li> <li>5</li> <li>6</li> <li>7</li> <li>8</li> <li>9</li> <li>10</li> <li>11</li> <li>12</li> <li>13</li> <li>14</li> <li>15</li> <li>16</li> <li>17</li> <li>18</li> <li>19</li> </ul> <p><b>Speed Zones</b></p> <ul style="list-style-type: none"> <li>25</li> <li>30</li> <li>35</li> <li>40</li> <li>45</li> <li>50</li> <li>55</li> <li>60</li> <li>65</li> </ul>	<p><b>Curves</b></p> <ul style="list-style-type: none"> <li>Left</li> <li>Right</li> </ul> <p><b>Grades</b></p> <ul style="list-style-type: none"> <li>grade up</li> <li>grade down</li> </ul>	<p><b>Road Widths</b></p> <p>(ft)</p>	<p><b>Traffic Counters</b></p> <p>(counter ID)</p>	<p><b>AADT</b></p> <p>(count)</p>	<p><b>Crash Locations</b></p> <ul style="list-style-type: none"> <li>Fatal</li> <li>Injury</li> <li>Property Damage Only</li> <li>Unknown Crash Type</li> </ul>	<p><b>Mileage by Functional Class By Sheet</b></p> <p>91-2 1 - Rural - Principal Arterial - Interstate 9.000</p> <p><b>Total Mileage: 9.000 mi</b></p>	<p><b>Mileage by Town By Sheet</b></p> <p>ETE - I091-0000S 9.0 of 177.432</p> <p><b>Total Mileage: 9.0 mi</b></p>	<p><b>DISTRICT</b></p>	<p><b>TOWN</b></p> <p>ETE</p>	<p><b>Date: 05/21/14</b></p> <p><b>12 of 20</b> TWN mileage: 99.0 to 108.0</p>	<p><b>ROUTE</b></p> <p>I-91</p> <p>ETE mileage: 99.0 to 108.0</p>
---	---	--	---------------------------------------	--	-----------------------------------	---	--	---	------------------------	-------------------------------	--	---