



Route Log Progress Chart

DRAFT

Please Note: Errors and Omissions May Exist.
Contact the VTrans Mapping Unit with questions or concerns.

DISTRICT	TOWN	ROUTE
	ETE	I-89

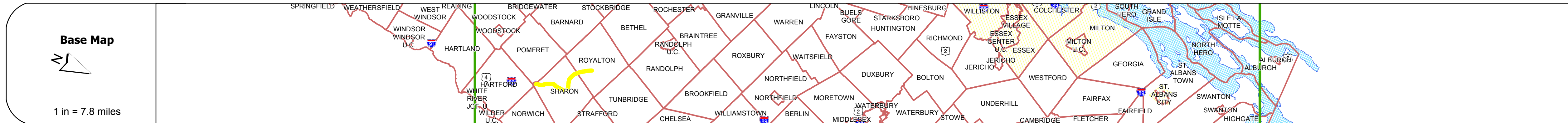
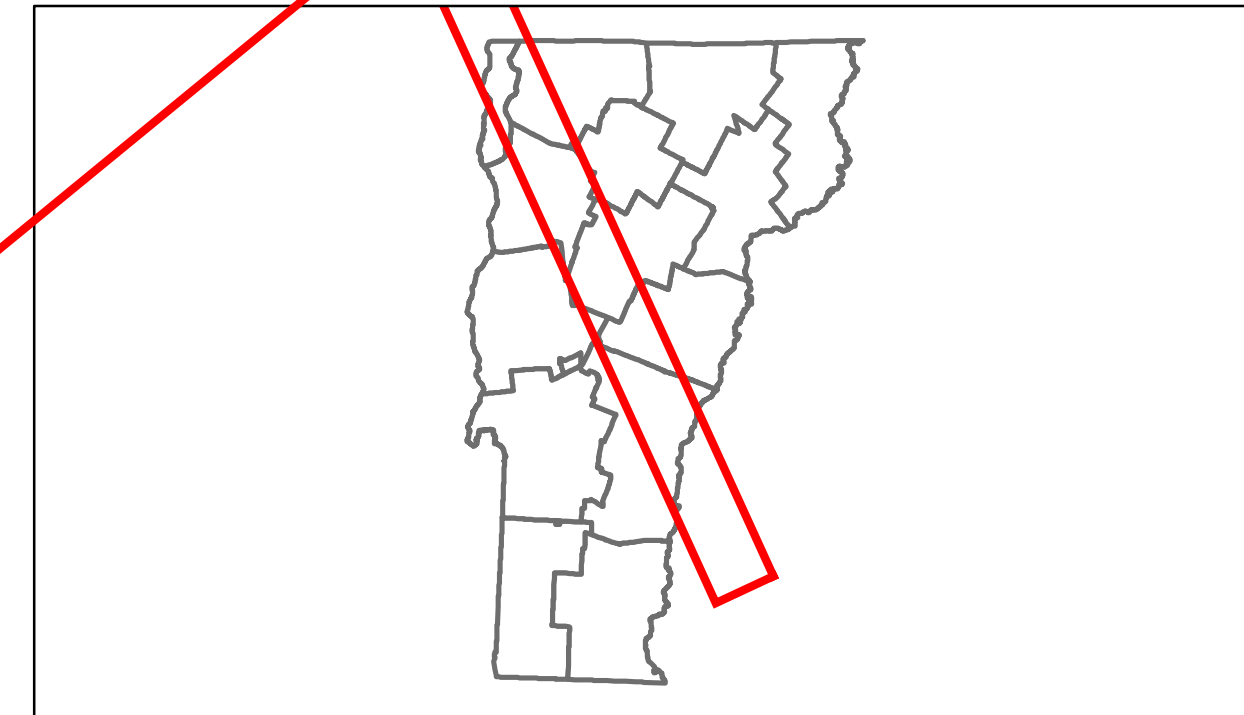

Stick Diagram

- Town Boundary
- Village/UC Boundaries
- District Boundaries
- State/Town Highway Change
- Divided Highway Limits
- Ghost Section Boundary
- FAU Limits
- Streams
- Town Center
- Primary Structures
- Secondary Structures
- Stations (Feet)
- Railroad Crossings
- Divided State Highway
- State Highway
- Divided Class 1 Town Highway
- Class 1 Town Highway

Scale: 1 INCH = 2000 FEET

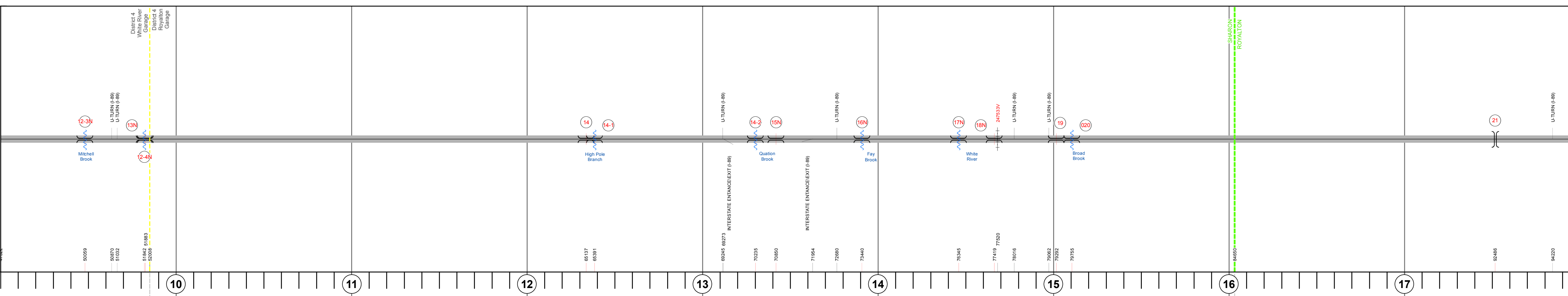

DESCRIPTION BLOCK

<p>Culvert 12-3N: Culvert - 1968 Structure No. 300089123N14171 Length: 12' Under Clearance: 13.58' Facility Carried: I89 Bridge Type: CGMPP Features Intersected: MITCHELL BROOK Maintenance: State</p>	<p>Culvert 12-4N: Culvert - 1968 Structure No. 300089124N14171 Length: 6' Under Clearance: 6.0' Facility Carried: I89 Bridge Type: ACCGMP Features Intersected: BROOK Maintenance: State</p>	<p>Culvert 13N: Culvert - 1968 Structure No. 30008913N14171 Length: 17' Under Clearance: 14.58' Facility Carried: I89 Bridge Type: CGMPP Features Intersected: LAND ACCESS ROAD Maintenance: State</p>	<p>Culvert 14: Culvert - 1968 Structure No. 20008901414172 Length: 21' Under Clearance: 14.08' Facility Carried: I 00089 ML Bridge Type: REF CONC BOX Features Intersected: I 89 OVER TH NO 11 Maintenance/Ownership: State</p>	<p>Culvert 14-1: Culvert - 1968 Structure No. 30008914-114171 Length: 10' Under Clearance: 10.0' Facility Carried: I89 Bridge Type: CGMPP Features Intersected: HIGH POLE BROOK Maintenance: State</p>	<p>Culvert 14-2: Culvert - 1968 Structure No. 30008914-214171 Length: 12' Under Clearance: 13.0' Facility Carried: I89 Bridge Type: CGMPP Features Intersected: QUATION BROOK Maintenance: State</p>	<p>Bridge 15N: Stringer/multi-beam or girder - 1968 Structure No. 200089015N14172 Length: 172' Width: 38.0' Under Clearance: 16.83' Facility Carried: I 00089 ML Bridge Type: 3 SP ROLLED BEAM Features Intersected: I 89 OVER VT 132 Surface: Bituminous Maintenance/Ownership: State</p>	<p>Bridge 16N: Stringer/multi-beam or girder - 1968 Structure No. 200089016N14172 Length: 356' Width: 30.0' Under Clearance: 49.0' Facility Carried: I 00089 ML Bridge Type: 4 SP CONT ROLLED BM Features Intersected: I 89 OVER TH17+FAY BK Surface: Bituminous Maintenance/Ownership: State</p>	<p>Bridge 17N: Stringer/multi-beam or girder - 1968 Structure No. 200089017N14172 Length: 834' Width: 30.0' Under Clearance: 83.0' Facility Carried: I 00089 ML Bridge Type: 4 SP CONT WELDED GIR Features Intersected: I 89 OVER VT14+WHT RV Surface: Bituminous Maintenance/Ownership: State</p>	<p>Bridge 18N: Stringer/multi-beam or girder - 1968 Structure No. 200089018N14172 Length: 236' Width: 30.0' Under Clearance: 17.83' Facility Carried: I 00089 ML Bridge Type: 4 SP ROLLED BEAM Features Intersected: I 89 OVER TH 3 + NECR Surface: Bituminous Maintenance/Ownership: State</p>	<p>Bridge 19: Culvert - 1968 Structure No. 200089001914172 Length: 21' Under Clearance: 14.0' Facility Carried: I 00089 ML Bridge Type: REF CONC BOX Features Intersected: I 89 OVER TH NO 4 Maintenance/Ownership: State</p>	<p>Bridge 20: Culvert - 1969 Structure No. 300089002014171 Length: 20' Under Clearance: 14.0' Facility Carried: I89 Bridge Type: RC ARCH Features Intersected: BROAD BROOK Maintenance: State</p>	<p>Bridge 21: Stringer/multi-beam or girder - 1968 Structure No. 201460D2114161 Length: 301' Height: 0.0' Weight Limit: 0 Facility Carried: TR 00013 Bridge Type: 4 SP CONT ROLLED BM Features Intersected: I 89 UNDER TH NO 13</p>
--	---	---	--	---	---	---	--	---	--	--	--	--

Road Widths	Travellane	Roadway	Lane Count	Base	Subbase

Curves	3			3.333	2
--------	---	--	--	-------	---

Grades	-3	+4.7	-5	+4.5	-4.6	+5	-4.1	+4
--------	----	------	----	------	------	----	------	----

Historic Projects	2005: AC IM 089-1(51)	1986: IR 089-1(2)	1968: I 89-1(7) C3	1968: I 89-1(7) C4	1969: I 89-1(36) C1	1969: I 89-1(36) C2	1969: I 89-1(37)	1969: I 89-1(8) C1	2009: IM 089-1(52)	2012: IM 089-1(53)	2009: IM 089-1(54)
-------------------	-----------------------	-------------------	--------------------	--------------------	---------------------	---------------------	------------------	--------------------	--------------------	--------------------	--------------------

Maintenance Garage	District 4 - White River Garage	District 4 - Royalton Garage
--------------------	---------------------------------	------------------------------

Traffic Counters		567086			567087
------------------	--	--------	--	--	--------

Functional Class					
------------------	--	--	--	--	--

Speed Zone					
------------	--	--	--	--	--

ADT Counts	2012	16500			15100
2011		17000			15000
2010		17500			14800
2009		17500			14500
2008		17500			14200

Crash Locations	2012																	
2011																		
2010																		
2009																		
2008																		

<p>Historic Projects</p> <ul style="list-style-type: none"> Retreatment Resurface Unknown Bituminous Mix Skimpy Mix Bituminous Seal Gravel Surface Treated Gravel Plant Mix Reclaimed Base and Bituminous Concrete Concrete 	<p>Functional Class</p> <ul style="list-style-type: none"> 1 2 3 4 5 6 7 8 9 10 11 12 13 14 15 16 17 18 19 <p>Speed Zones</p> <ul style="list-style-type: none"> 25 30 35 40 45 50 55 60 65 	<p>Curves</p> <ul style="list-style-type: none"> Left Right <p>Grades</p> <ul style="list-style-type: none"> grade up grade down 	<p>Road Widths</p> <p>(ft)</p>	<p>Traffic Counters</p> <p>(counter ID)</p>	<p>Crash Locations</p> <ul style="list-style-type: none"> Fatal Injury Property Damage Only Unknown Crash Type 	<p>Mileage by Functional Class By Sheet</p> <p>89-1 1 - Rural - Principal Arterial - Interstate 9.000</p> <p>Total Mileage: 9.000 mi</p>	<p>Mileage by Town By Sheet</p> <p>ETE - I089-0000 9.0 of 130.254</p> <p>Total Mileage: 9.0 mi</p>
---	---	--	---------------------------------------	--	---	--	--

DISTRICT	TOWN	Date: 05/21/14	ROUTE
	ETE	2 of 15	I-89
		TWN mileage: 9.0 to 18.0	ETE mileage: 9.0 to 18.0

For More Information Contact - Vermont Agency of Transportation, Policy, Planning and Intermodal Development Division - Mapping Unit, 1 National Life Drive, Montpelier, VT 05633-5001 Telephone: 802-828-2600.