



# Route Log Progress Chart

**DRAFT**

Please Note: Errors and Omissions May Exist.  
Contact the VTrans Mapping Unit with questions or concerns.

DISTRICT	TOWN	ROUTE
	ETE	I-89

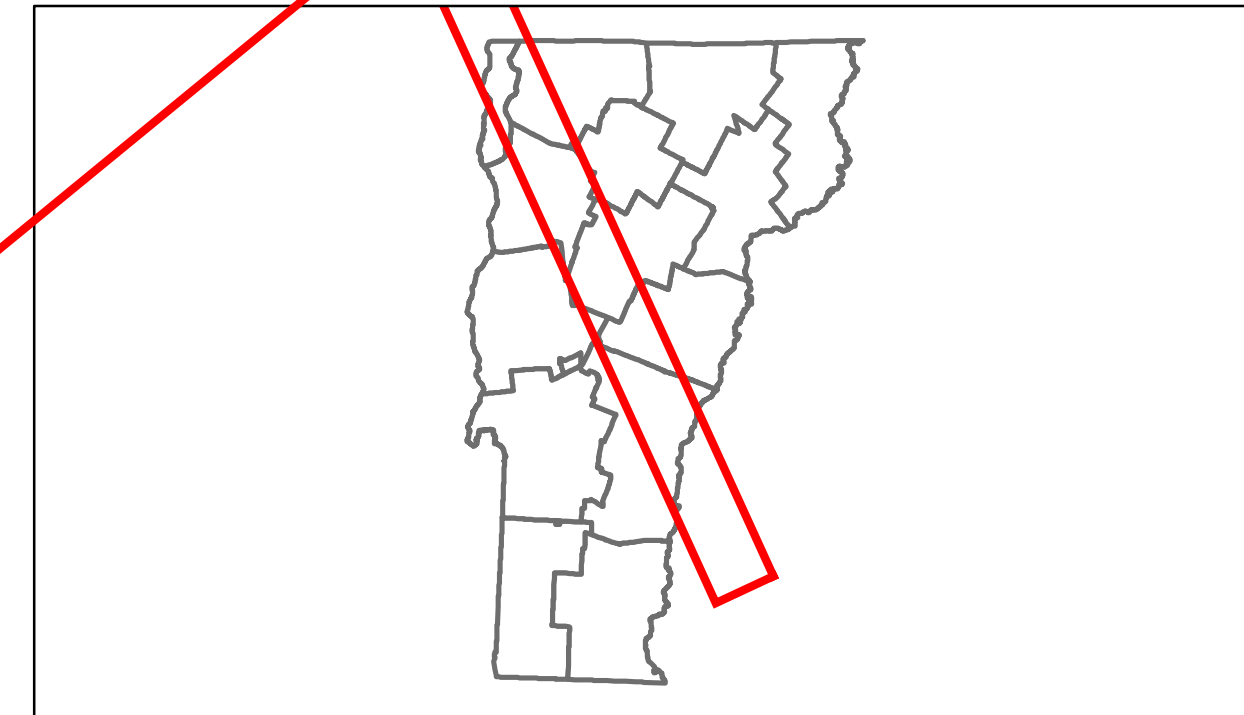

**Base Map**

1 in = 7.8 miles

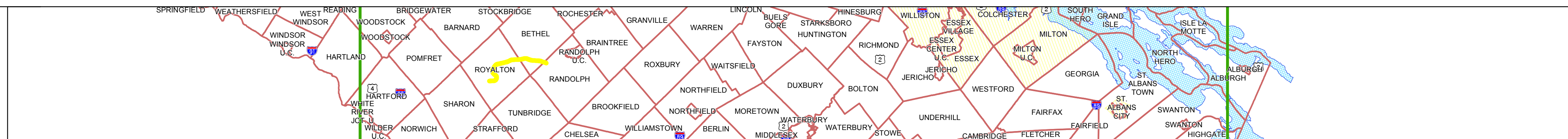

**Stick Diagram**

- Town Boundary
- Village/UC Boundaries
- District Boundaries
- State/Town Highway Change
- Divided Highway Limits
- Ghost Section Boundary
- FAU Limits
- Streams
- Town Center
- Primary Structures
- Secondary Structures
- Stations (Feet)
- Railroad Crossings
- Divided State Highway
- State Highway
- Divided Class 1 Town Highway
- Class 1 Town Highway

Scale: 1 INCH = 2000 FEET

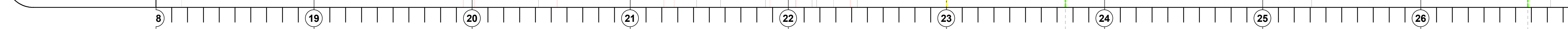
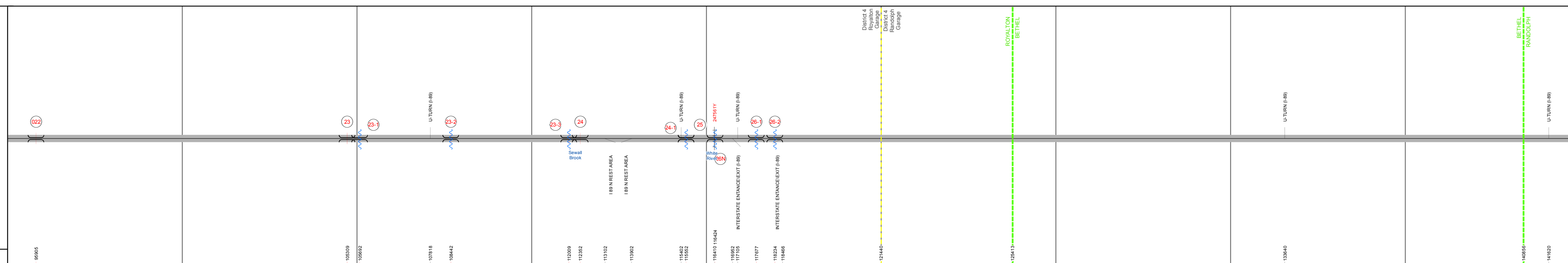

Travellane	Roadway	Lane Count	Base	Subbase

Curves	Grades
3.3, 2.2, 3.0, 1.3, 2, 3, 2	-5, -4.4, -5, +5, +3.7, -4.1, +5, -3.6, -3.3

**Historic Projects**

2009: IM 089-1(54)	2009: IM 089-1(55)	2007: IM 089-1(52)
1978: 89-1(49)	1972: 1 89-1(43)	1977: 1 89-1(47)
1969: 1 89-1(8) C/1	1969: 1 89-1(8) C/2	1970: 1 89-1(35)
		1970: 1 89-1(8)

**Maintenance Garage**

District 4 - Royalton Garage	District 4 - Randolph Garage
------------------------------	------------------------------

**Traffic Counters**

50001
-------

**Functional Class**

1 - Rural - Principal Arterial - Interstate
---

**Speed Zone**

--

**AADT Counts**

Year	Count
2012	15100
2011	15000
2010	14800
2009	14500
2008	14200

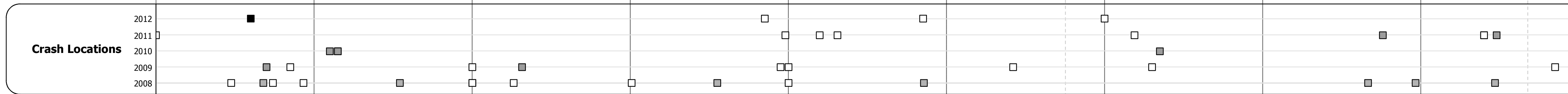

**DESCRIPTION BLOCK**

<p><b>Culvert 22:</b> Culvert - 1969 Structure No. 30008902214161 Length: 14' Under Clearance: 12.0' Facility Carried: 189 Bridge Type: RC BOX Features Intersected: LAND ACCESS ROAD Maintenance: State</p>	<p><b>Bridge 26-2:</b> Culvert - 1969 Structure No. 30008926-214161 Length: 6' Under Clearance: 6.0' Facility Carried: 189 Bridge Type: CGMPP Features Intersected: BROOK Maintenance: State</p>
<p><b>Culvert 23:</b> Culvert - 1968 Structure No. 20008902314162 Length: 21' Under Clearance: 14.08' Facility Carried: 1 00089 ML Bridge Type: REF CONC BOX Features Intersected: 1 89 OVER TH NO 36 Maintenance/Ownership: State</p>	
<p><b>Culvert 23-1:</b> Culvert - 1969 Structure No. 30008923-114161 Length: 6' Under Clearance: 6.0' Facility Carried: 189 Bridge Type: CGMPP Features Intersected: BROOK Maintenance: State</p>	
<p><b>Culvert 23-2:</b> Culvert - 1969 Structure No. 30008923-214161 Length: 8' Under Clearance: 10.0' Facility Carried: 189 Bridge Type: RC BOX Features Intersected: BROOK Maintenance: State</p>	
<p><b>Culvert 23-3:</b> Culvert - 1969 Structure No. 30008923-314161 Length: 12' Under Clearance: 10.0' Facility Carried: 189 Bridge Type: RC BOX Features Intersected: BROOK Maintenance: State</p>	
<p><b>Culvert 24:</b> Culvert - 1968 Structure No. 20008902414162 Length: 21' Under Clearance: 14.08' Facility Carried: 1 00089 ML Bridge Type: REF CONC BOX Features Intersected: 1 89 OVER TH NO 6 Maintenance/Ownership: State</p>	
<p><b>Culvert 25:</b> Culvert - 1968 Structure No. 20008902514162 Length: 21' Under Clearance: 14.08' Facility Carried: 1 00089 ML Bridge Type: REF CONC BOX Features Intersected: 1 89 OVER TH NO 35 Maintenance/Ownership: State</p>	
<p><b>Culvert 24-1:</b> Culvert - 1969 Structure No. 30008924-114161 Length: 10' Under Clearance: 6.42' Facility Carried: 189 Bridge Type: RC BOX Features Intersected: CATTLE PASS Maintenance: State</p>	
<p><b>Bridge 26N:</b> Stringer/multi-beam or girder - 1968 Structure No. 200089026N14162 Length: 917' Width: 30.0' Under Clearance: 17.5' Facility Carried: 1 00089 ML Bridge Type: 6 SP CONT GIRDER Features Intersected: 1 89 OVER WR+NECR-107 Surface: Bituminous Maintenance/Ownership: State</p>	
<p><b>Culvert 26-1:</b> Culvert - 1969 Structure No. 30008926-114161 Length: 6' Under Clearance: 6.0' Facility Carried: 189 Bridge Type: CGMPP Features Intersected: BROOK Maintenance: State</p>	

<p><b>Historic Projects</b></p> <ul style="list-style-type: none"> <li>Retreatment</li> <li>Resurface</li> <li>Unknown</li> <li>Bituminous Mix</li> <li>Skimny Mix</li> <li>Bituminous Seal</li> </ul>	<p><b>Functional Class</b></p> <ul style="list-style-type: none"> <li>1 - Rural - Principal Arterial - Interstate</li> <li>2 - Rural - Minor Arterial</li> <li>3 - Rural - Collector</li> <li>4 - Rural - Local</li> <li>5 - Urban - Principal Arterial</li> <li>6 - Urban - Minor Arterial</li> <li>7 - Urban - Collector</li> <li>8 - Urban - Local</li> <li>9 - Urban - Residential</li> <li>10 - Urban - Business</li> <li>11 - Urban - Industrial</li> <li>12 - Urban - Other</li> <li>13 - Urban - Other</li> <li>14 - Urban - Other</li> <li>15 - Urban - Other</li> <li>16 - Urban - Other</li> <li>17 - Urban - Other</li> <li>18 - Urban - Other</li> <li>19 - Urban - Other</li> </ul>	<p><b>Curves</b></p> <ul style="list-style-type: none"> <li>Left</li> <li>Right</li> </ul>	<p><b>Grades</b></p> <ul style="list-style-type: none"> <li>grade up</li> <li>grade down</li> </ul>	<p><b>Road Widths</b></p> <p>(ft)</p>	<p><b>Traffic Counters</b></p> <p>(counter ID)</p>	<p><b>AADT</b></p> <p>(count)</p>	<p><b>Crash Locations</b></p> <ul style="list-style-type: none"> <li>Fatal</li> <li>Injury</li> <li>Property Damage Only</li> <li>Unknown Crash Type</li> </ul>	<p><b>Mileage by Functional Class By Sheet</b></p> <p>89-1 1 - Rural - Principal Arterial - Interstate 9.000</p>	<p><b>Mileage by Town By Sheet</b></p> <p>ETE - I089-0000 9.0 of 130.254</p>	<p><b>DISTRICT</b></p>	<p><b>TOWN</b></p> <p>ETE</p>	<p><b>Date: 05/21/14</b></p>	<p><b>ROUTE</b></p> <p>I-89</p> <p>ETE mileage: 18.0 to 27.0</p>
								<p><b>Total Mileage: 9.000 mi</b></p>	<p><b>Total Mileage: 9.0 mi</b></p>	<p><b>3 of 15</b></p>	<p><b>TWN mileage: 18.0 to 27.0</b></p>		

For More Information Contact - Vermont Agency of Transportation, Policy, Planning and Intermodal Development Division - Mapping Unit, 1 National Life Drive, Montpelier, VT 05633-5001 Telephone: 802-828-2600.