



# Route Log Progress Chart

**DRAFT**

Please Note: Errors and Omissions May Exist.  
Contact the VTrans Mapping Unit with questions or concerns.

DISTRICT	TOWN	ROUTE
1	POWNAI	VT-346

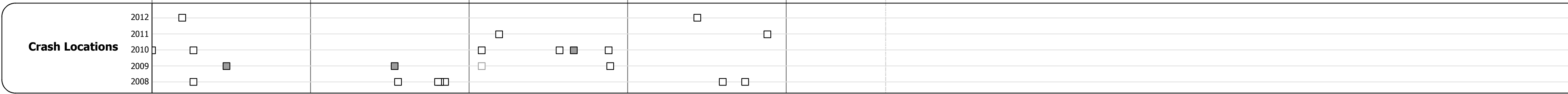
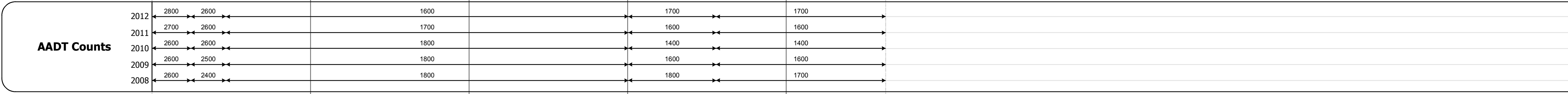
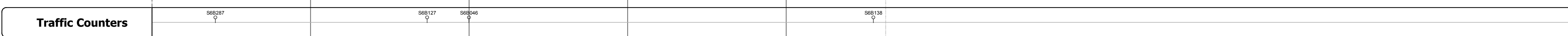
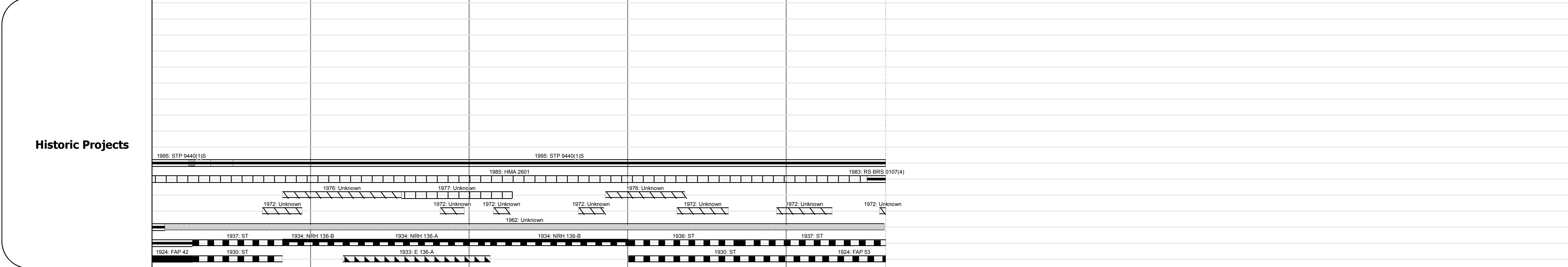
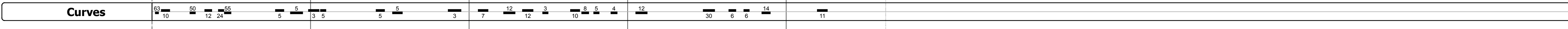
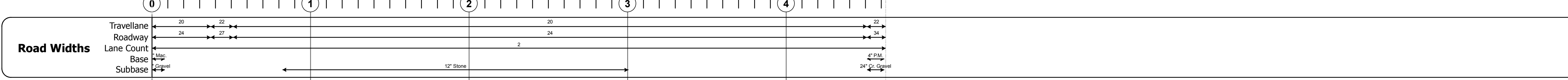
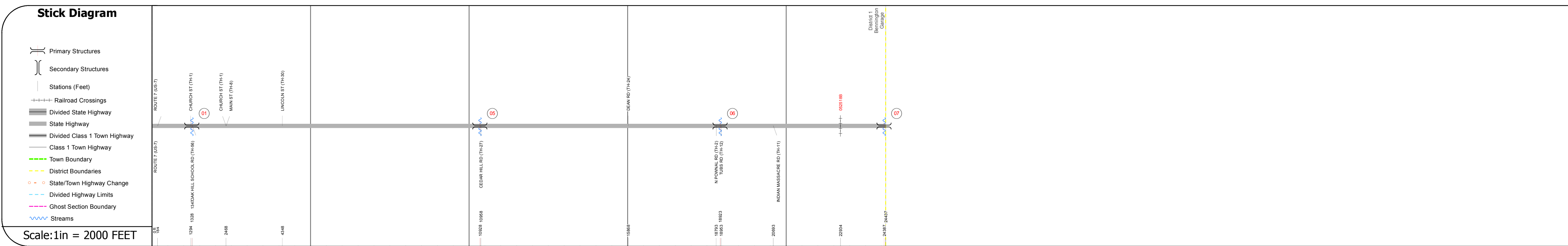
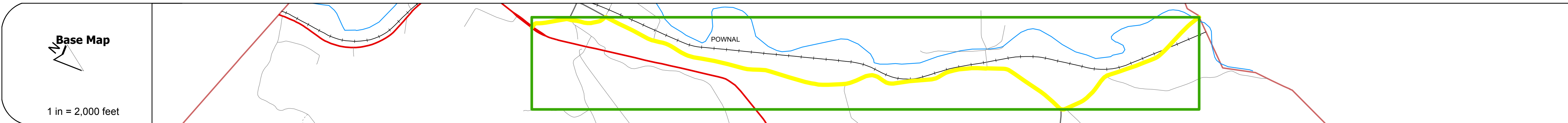
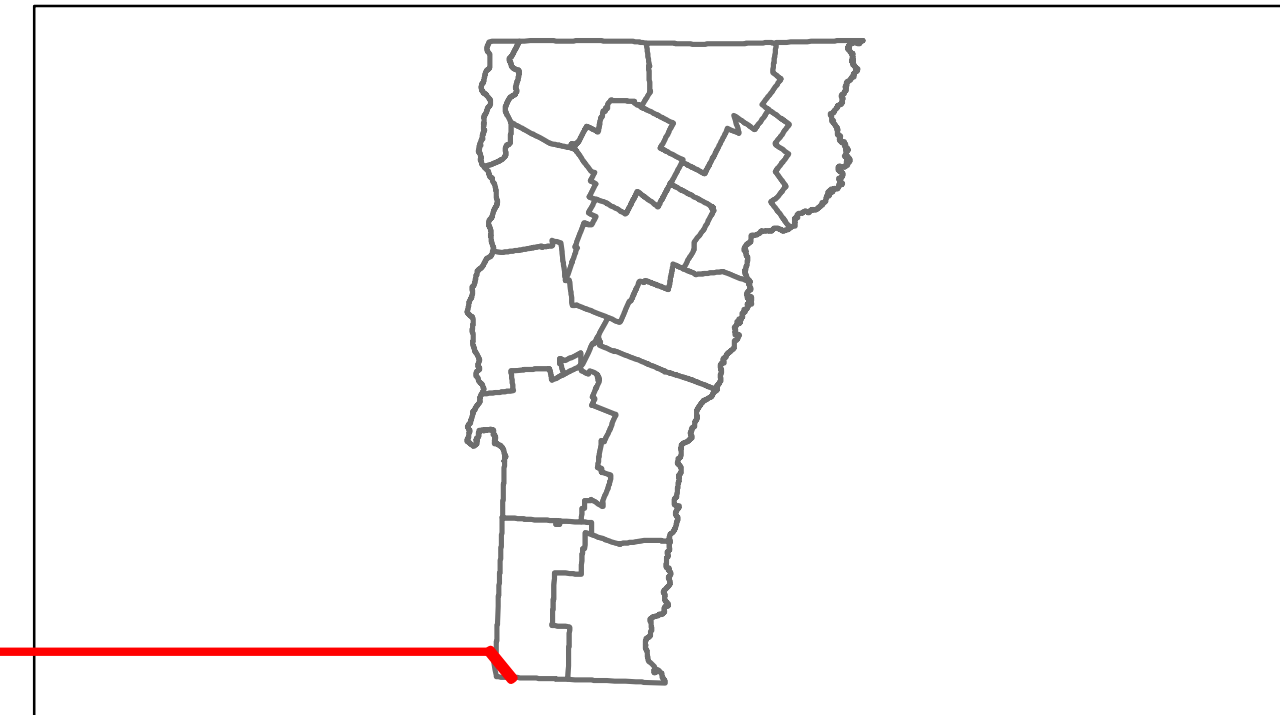

## DESCRIPTION BLOCK

**Culvert 1:**  
Culvert - 2007  
Structure No. 300107000102081  
Length: 9'  
Width: 29.2'  
Under Clearance: 6.0'  
Facility Carried: VT346  
Bridge Type: PRECAST SEG. BOX  
Features Intersected: LADD BROOK  
Maintenance: State

**Culvert 5:**  
Culvert - 1919  
Structure No. 300107000502081  
Length: 16'  
Under Clearance: 9.0'  
Facility Carried: VT346  
Bridge Type: RC BOX  
Features Intersected: BROOK  
Maintenance: State

**Bridge 6:**  
Girder and floorbeam system - 1910  
Structure No. 200107000602082  
Length: 29'  
Width: 22.5'  
Facility Carried: VT 00346 ML  
Bridge Type: ENC STL IBM/FBM/SLAB  
Features Intersected: BROOK  
Surface: Bituminous  
Maintenance/Ownership: State

**Bridge 7:**  
Stinger/multi-beam or girder - 1983  
Structure No. 200107000702082  
Length: 219'  
Width: 39.0'  
Facility Carried: VT 00346 ML  
Bridge Type: ZSPN CONT CURVED GIR  
Features Intersected: HOOSIC RIVER  
Surface: Bituminous  
Maintenance/Ownership: State

<b>Historic Projects</b> Retreatment, Resurface, Unknown, Bituminous Mix, Skippy Mix, Bituminous Seal, Bituminous Concrete, Surface Treated Gravel, Plant Mix, Reclaimed Base and Bituminous Concrete, Concrete	<b>Functional Class</b> 1, 2, 3, 4, 5, 6, 7, 8, 9, 10, 11, 12, 13, 14, 15, 16, 17, 18, 19	<b>Curves</b> curve left, curve right	<b>Road Widths</b> (ft)	<b>Traffic Counters</b> (counter ID)	<b>AADT</b> (count)	<b>Crash Locations</b> Fatal, Injury, Property Damage Only, Unknown Crash Type	<b>Mileage by Functional Class By Sheet</b> 0107 7 - Rural - Major collector 4.628	<b>Mileage by Town By Sheet</b> POWNAI - v346-0208 4.628 of 4.628	<b>DISTRICT</b> 1	<b>TOWN</b> POWNAI	<b>Date:</b> 11/16/13	<b>ROUTE</b> VT-346 ETE mileage: 0.0 to 4.628
<b>Total Mileage: 4.628 mi</b>						<b>Total Mileage: 4.628 mi</b>						

For More Information Contact - Vermont Agency of Transportation, Policy, Planning and Intermodal Development Division - Mapping Unit, 1 National Life Drive, Montpelier, VT 05633-5001 Telephone: 802-828-2600.