



Route Log Progress Chart

DRAFT

Please Note: Errors and Omissions May Exist.
Contact the VTrans Mapping Unit with questions or concerns.

DISTRICT	TOWN	ROUTE
8	GRAND ISLE	VT-314

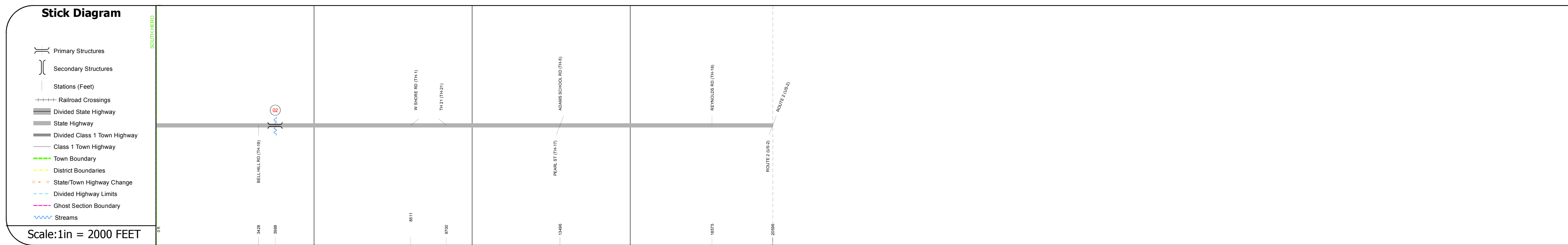
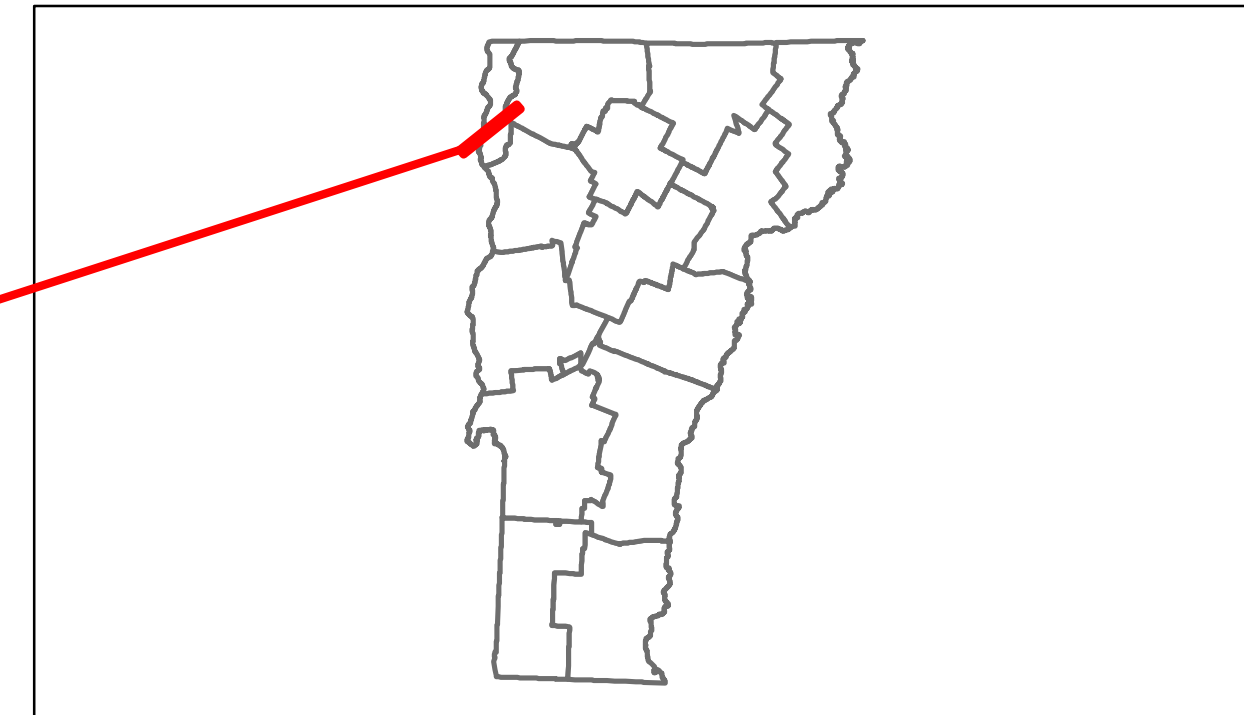

DESCRIPTION BLOCK

Culvert 2:
Culvert - 1948
Structure No. 300273000207021
Length: 9'
Under Clearance: 6.0'
Facility Carried: VT314
Bridge Type: CONCRETE BOX
Features Intersected: DRY BROOK
Maintenance: State

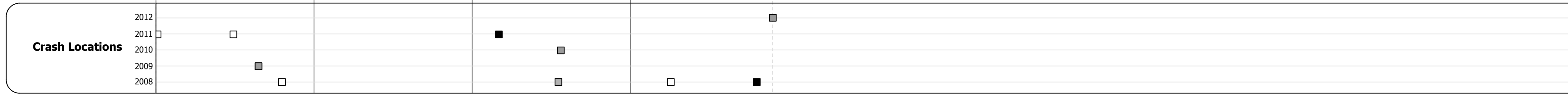
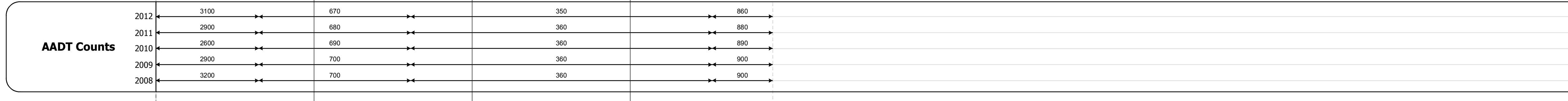
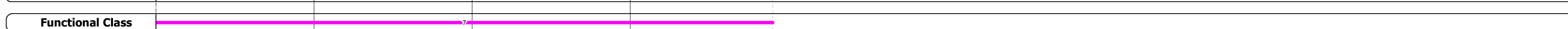
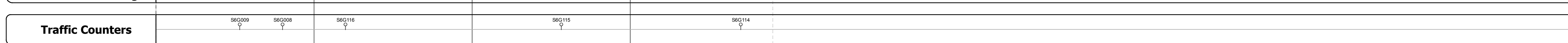
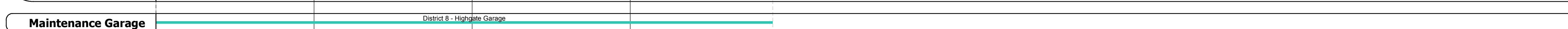
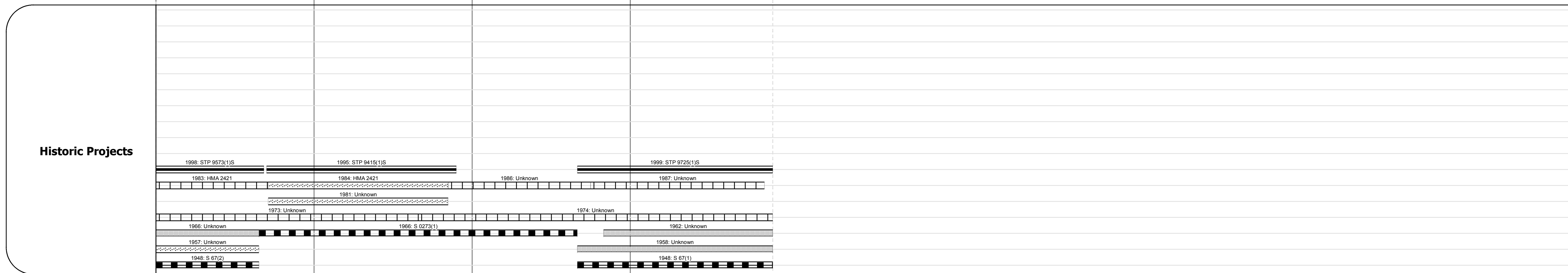
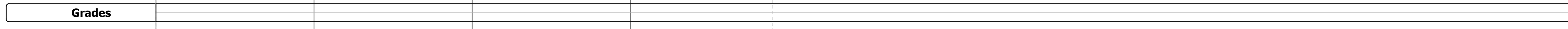
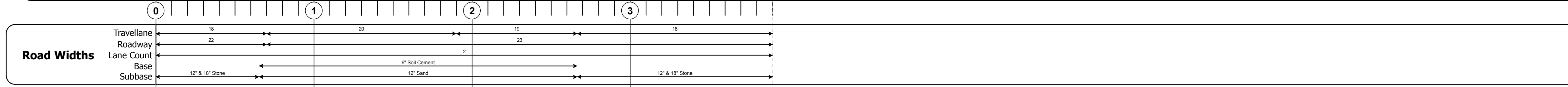

Historic Projects Retreatment, Resurface, Unknown, Bituminous Mix, Skippy Mix, Bituminous Seal, Bituminous Concrete, Surface Treated Gravel, Plant Mix, Reclaimed Base and Bituminous Concrete, Concrete	Functional Class 1, 2, 3, 4, 5, 6, 7, 8, 9, 10, 11, 12, 13, 14, 15, 16, 17, 18, 19	Curves curve left, curve right	Road Widths (ft)	AADT (count)	Mileage by Functional Class By Sheet 0273 7 - Rural - Major collector 3.901	Mileage by Town By Sheet GRAND ISLE - V314-0702 3.901 of 3.901	DISTRICT 8	TOWN GRAND ISLE	Date: 11/16/13	ROUTE VT-314 ETE mileage: 1.592 to 5.493
					Total Mileage: 3.901 mi	Total Mileage: 3.901 mi	1 of 1 TWN mileage: 0.0 to 3.901			