



Route Log Progress Chart

DRAFT

Please Note: Errors and Omissions May Exist.
Contact the VTrans Mapping Unit with questions or concerns.

DISTRICT	TOWN	ROUTE
8	SWANTON	VT-78

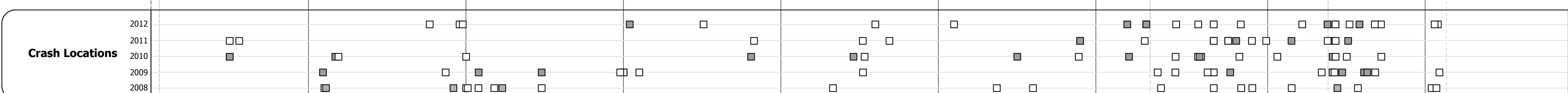
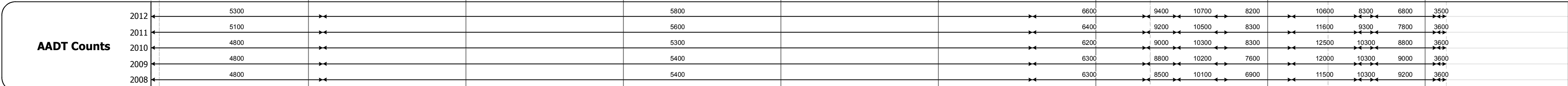
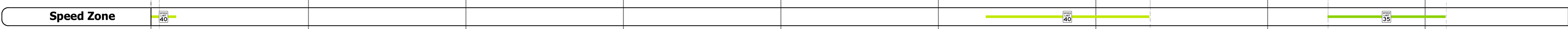
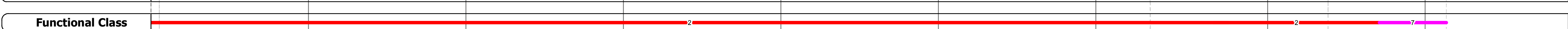
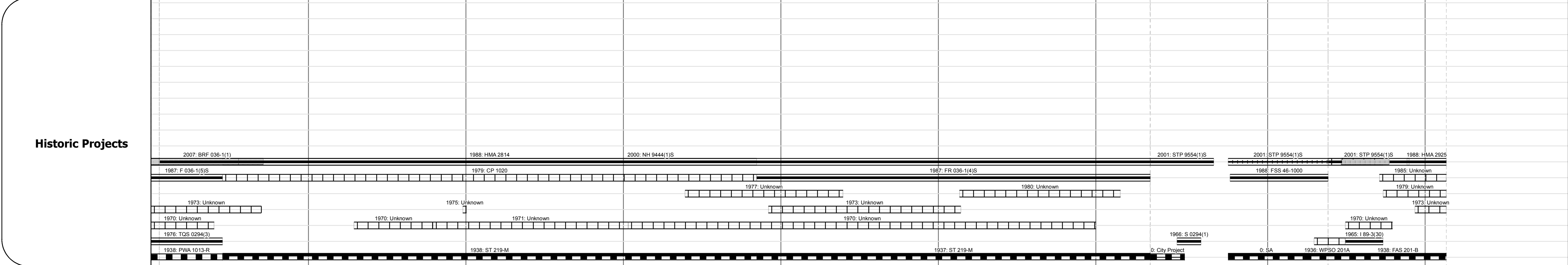
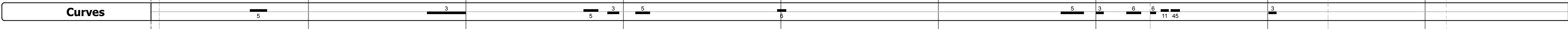
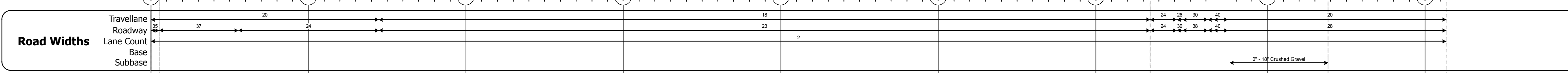
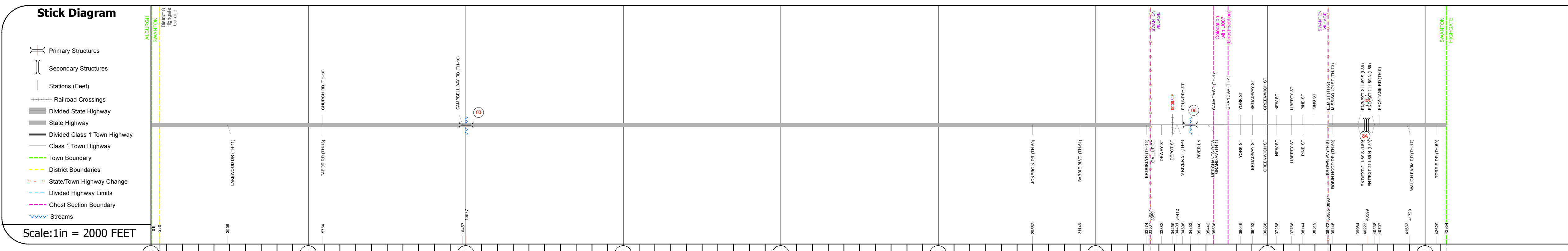
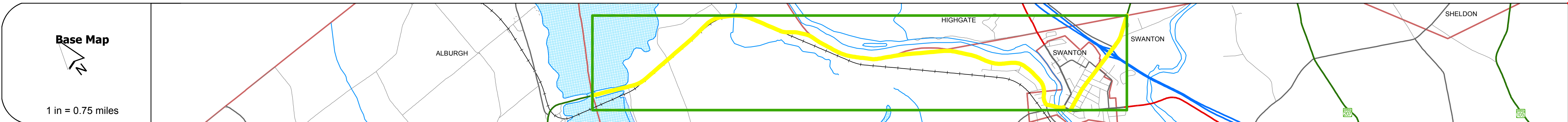
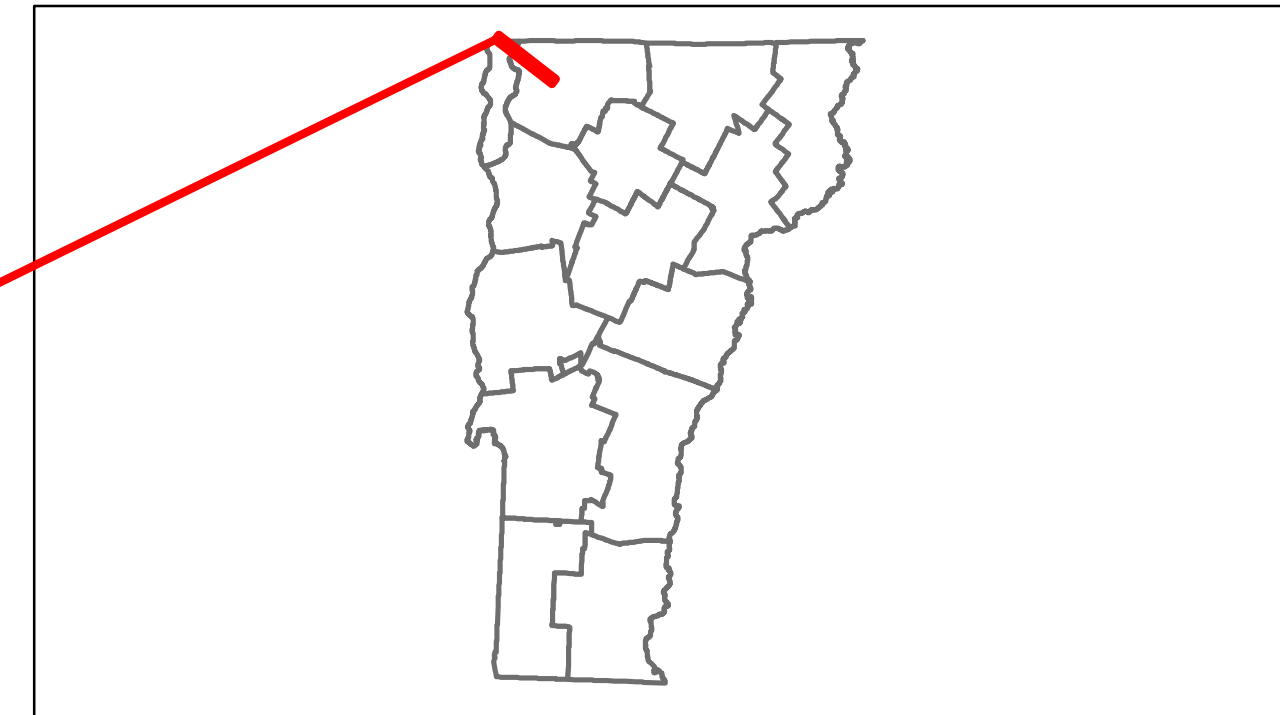

DESCRIPTION BLOCK

Culvert 3:
Culvert - 1975
Structure No. 300036000306151
Length: 14'
Under Clearance: 8.42'
Facility Carried: VT78
Bridge Type: CGMPPA
Features Intersected: CHARCOAL CREEK
Maintenance: State

Bridge 6:
Stringer/multi-beam or girder - 1966
Structure No. 200036000606152
Length: 302'
Width: 40.0'
Facility Carried: VT 00078 ML
Bridge Type: CONT. ROLLED BEAM
Features Intersected: MISSISQUOI RIVER
Surface: Bituminous
Maintenance/Ownership: Town

Bridge 8A:
Stringer/multi-beam or girder - 1964
Structure No. 20008908506152
Length: 162'
Height: 0.0'
Weight Limit: 0
Facility Carried: 1 00089 ML
Bridge Type: 3 SPAN ROLLED BEAM
Features Intersected: 1.89 OVER VT 78

Bridge 8:
Stringer/multi-beam or girder - 1964
Structure No. 20008908606152
Length: 162'
Height: 0.0'
Weight Limit: 0
Facility Carried: 1 00089 ML
Bridge Type: 3 SPAN ROLLED BEAM
Features Intersected: 1.89 OVER VT 78

Historic Projects Retreatment, Resurface, Unknown, Bituminous Mix, Skinny Mix, Bituminous Seal, Concrete, Gravel, Surface Treated Gravel, Plant Mix, Reclaimed Base and Bituminous Concrete, Concrete	Functional Class 1, 2, 3, 4, 5, 6, 7, 8, 9, 10, 11, 12, 13, 14, 15, 16, 17, 18, 19	Curves curve left, curve right	Road Widths (ft)	Traffic Counters (counter ID)	AADT (count)	Crash Locations Fatal, Injury, Property Damage Only, Unknown Crash Type	Mileage by Functional Class By Sheet 036-1 2 - Rural - Principal Arterial 7.709 0296 7 - Rural - Major Collector 0.425	Mileage by Town By Sheet SWANTON - V078-0615 8.135 of 8.135 Ghost Section - US-7 (5.872 to 5.781) 0.091	DISTRICT 8	TOWN SWANTON	Date: 11/15/13	ROUTE VT-78 ETE mileage: 3.333 to 11.468
Total Mileage: 8.135 mi							Total Mileage: 8.135 mi					

For More Information Contact - Vermont Agency of Transportation, Policy, Planning and Intermodal Development Division - Mapping Unit, 1 National Life Drive, Montpelier, VT 05633-5001 Telephone: 802-828-2600.