



Route Log Progress Chart

DRAFT

Please Note: Errors and Omissions May Exist.
Contact the VTrans Mapping Unit with questions or concerns.

DISTRICT	TOWN	ROUTE
6	EAST MONTPELIER	Min-6303

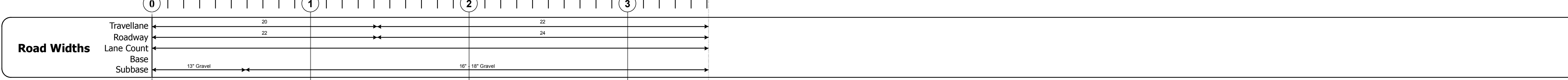
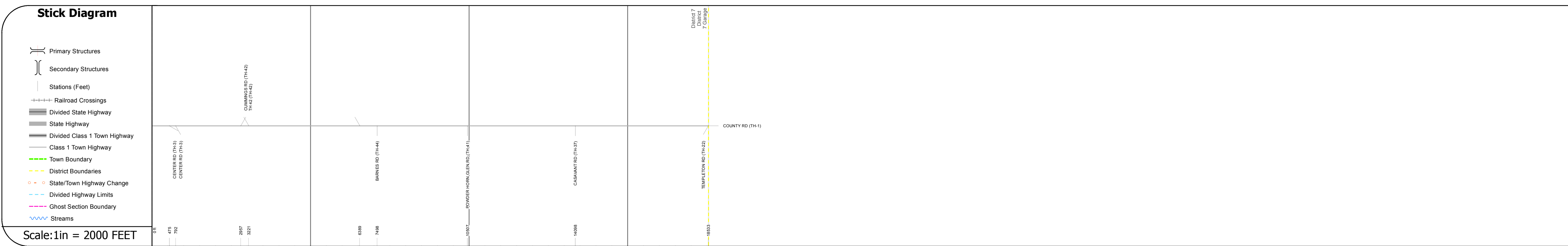
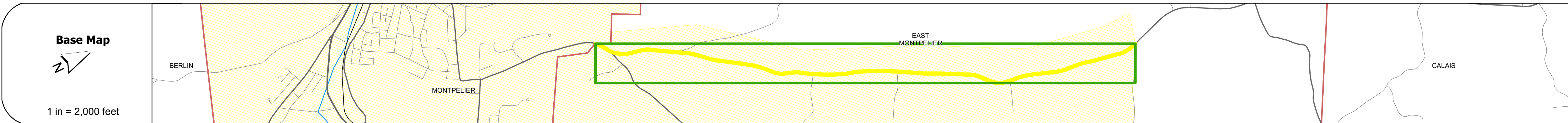
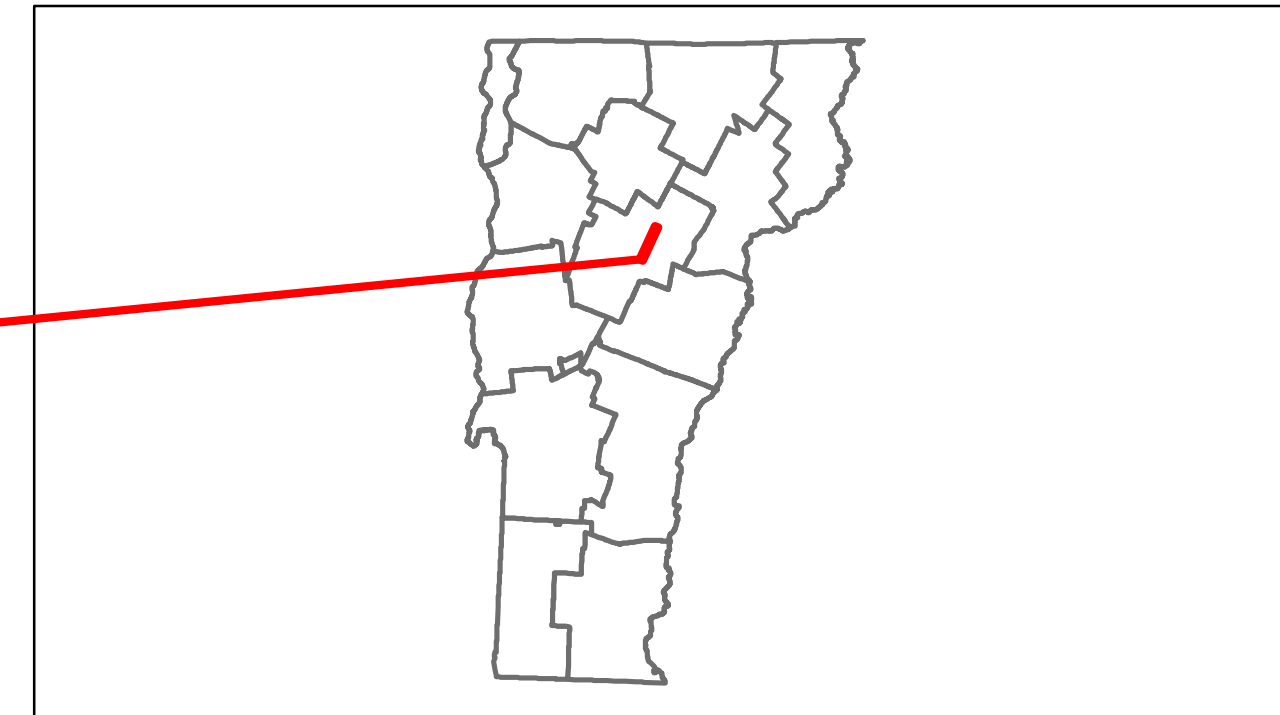

Curves

Grades

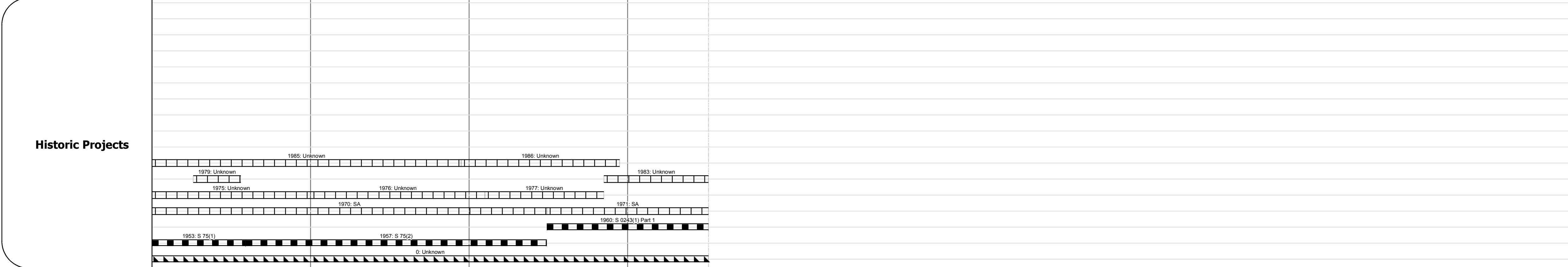

Maintenance Garage
(Not State Maintained)

Traffic Counters
96W440, 96W321

Functional Class
16

Speed Zone

ADT Counts
2012: 1300
2011: 1300
2010: 1300
2009: 1300
2008: 1400

Crash Locations
2012:
2011:
2010:
2009:
2008:

DESCRIPTION BLOCK

Historic Projects Retreatment, Resurface, Unknown, Bituminous Mix, Skippy Mix, Bituminous Seal, Bituminous Concrete, Surface Treated Gravel, Plant Mix, Reclaimed Base and Bituminous Concrete, Concrete	Functional Class 1-19, 6-16 Speed Zones 25, 30, 35, 40, 45, 50, 55, 60, 65	Curves curve left, curve right Grades grade up, grade down	Road Widths (ft) Traffic Counters (counter ID)	AAADT (count) Crash Locations Fatal, Injury, Property Damage Only, Unknown Crash Type	Mileage by Functional Class By Sheet 6303 16 - Urban - Minor Arterial 3.510 Total Mileage: 3.510 mi	Mileage by Town By Sheet EAST MONTPELIER - s63031207 3.51 of 3.51 Total Mileage: 3.51 mi	DISTRICT 6	TOWN EAST MONTPELIER	Date: 11/15/13 1 of 1 TWN mileage: 0.0 to 3.51	ROUTE Min-6303 ETE mileage: 0.0 to 3.51
--	---	---	---	--	---	--	----------------------	--------------------------------	--	--