



Route Log Progress Chart

DRAFT

Please Note: Errors and Omissions May Exist.
Contact the VTrans Mapping Unit with questions or concerns.

DISTRICT	TOWN	ROUTE
5	BURLINGTON	Urb-5026

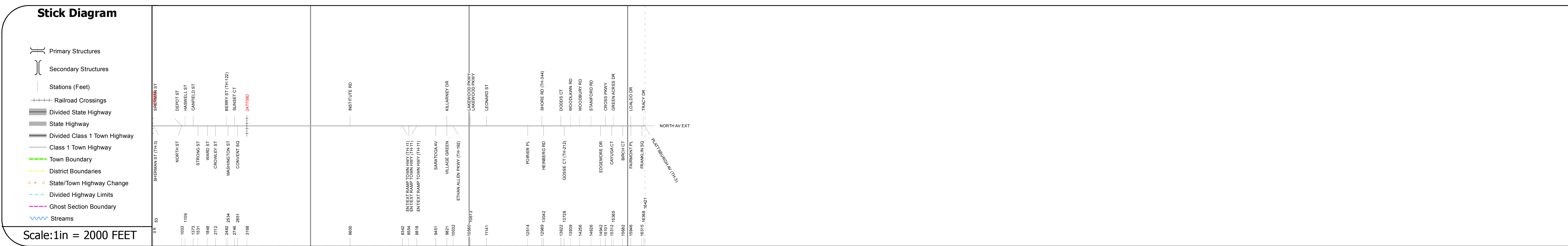
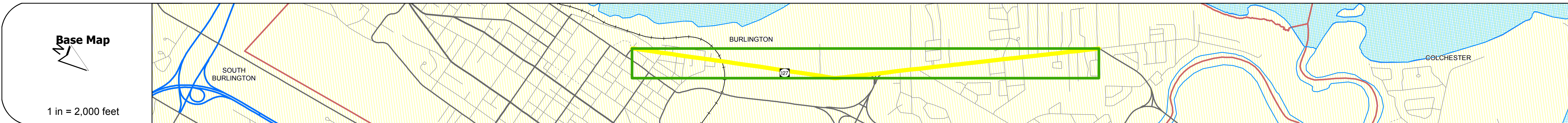
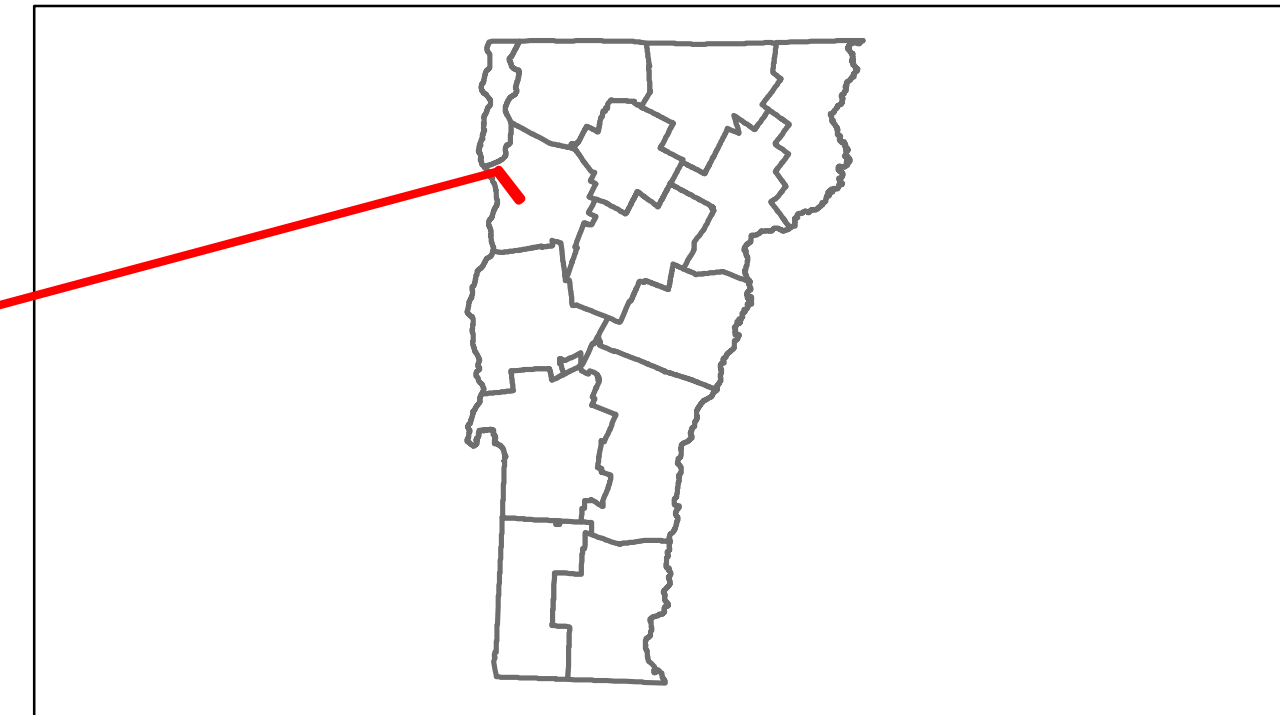

DESCRIPTION BLOCK

Road Widths	Travellane	36	35	46	44	38	52	44	40	43	37	40
	Roadway	36	35	47	45	40	52	44	40	43	37	40
	Lane Count											
	Base											
	Subbase											

Curves	
---------------	--

Grades	
---------------	--

Historic Projects	
	<p>1985: M 5000(11)S</p> <p>1985: Unknown</p> <p>1980: Unknown</p> <p>0: Unknown</p>

Maintenance Garage	(Not State Maintained)
---------------------------	------------------------

Traffic Counters	<p>860045</p> <p>860152</p> <p>860291</p> <p>860151</p> <p>860348</p>
-------------------------	---

Functional Class	16
-------------------------	----

Speed Zone	
-------------------	--

AADT Counts	<p>2012: 10300, 11000, 11600, 9500, 15400, 13200, 13600, 10700</p> <p>2011: 10400, 11100, 11700, 9600, 15500, 13300, 13700, 10800</p> <p>2010: 10400, 11100, 11700, 9600, 15500, 13300, 13700, 10800</p> <p>2009: 10400, 11100, 11700, 9600, 15500, 13300, 13700, 10800</p> <p>2008: 11100, 11200, 11700, 10300, 16700, 13600, 14000, 11000</p>
--------------------	---

Crash Locations	<p>2012: [Crash symbols]</p> <p>2011: [Crash symbols]</p> <p>2010: [Crash symbols]</p> <p>2009: [Crash symbols]</p> <p>2008: [Crash symbols]</p>
------------------------	--

Historic Projects Retreatment, Resurface, Unknown, Bituminous Mix, Skippy Mix, Bituminous Seal, Bituminous Concrete, Concrete	Functional Class 1, 2, 6, 11, 12, 14, 17, 19	Curves curve left, curve right	Road Widths (ft)	Traffic Counters (counter ID)	AADT (count)	Crash Locations Fatal, Injury, Property Damage Only, Unknown Crash Type	Mileage by Functional Class By Sheet 5026 16 - Urban - Minor Arterial 3.110	Mileage by Town By Sheet BURLINGTON - S50260403 3.11 of 3.11	DISTRICT 5	TOWN BURLINGTON	Date: 11/15/13	ROUTE Urb-5026 ETE mileage: 0.0 to 3.11
						Total Mileage: 3.110 mi	Total Mileage: 3.11 mi					