



Route Log Progress Chart

DRAFT

Please Note: Errors and Omissions May Exist.
Contact the VTrans Mapping Unit with questions or concerns.

DISTRICT	TOWN	ROUTE
7	DANVILLE	Min-0752

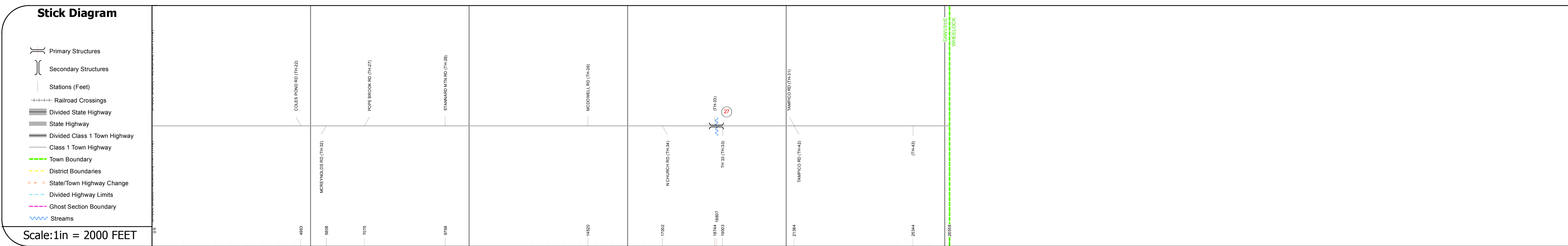
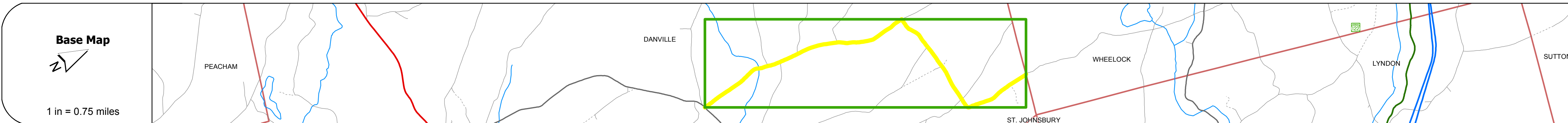
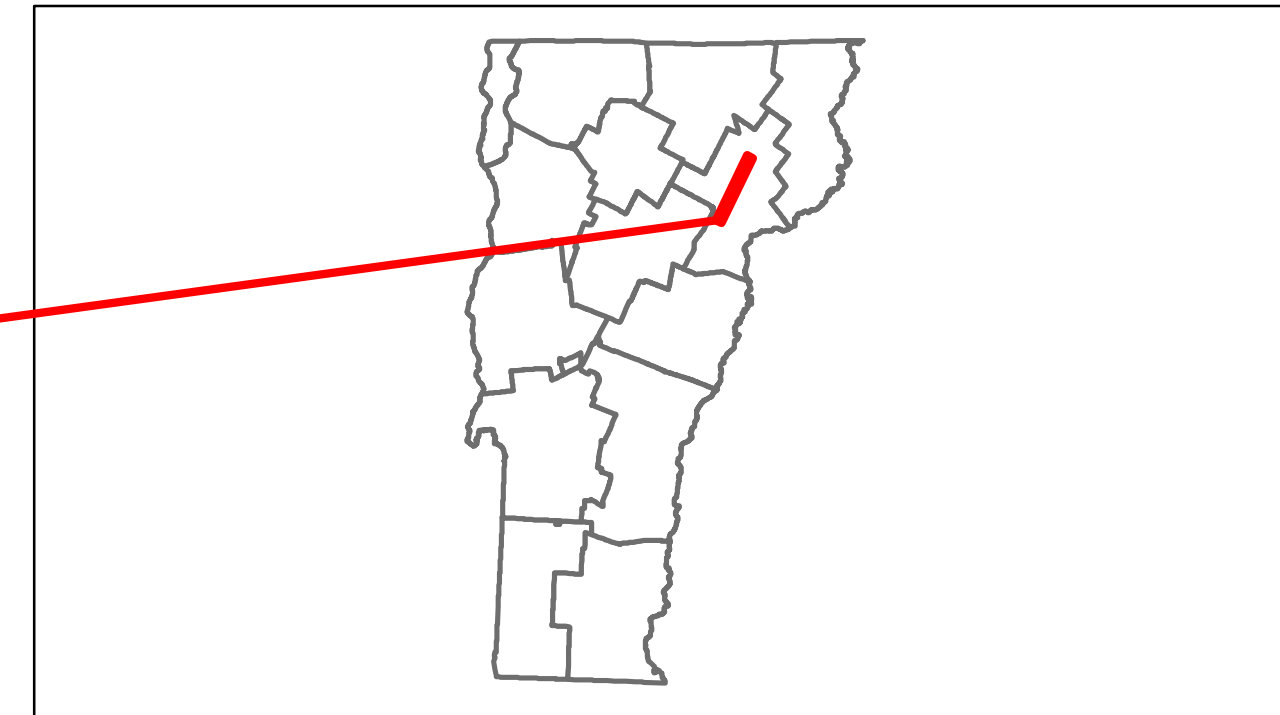

DESCRIPTION BLOCK	
Culvert 27:	
Culvert - 2005	
Structure No. 100303002703031	
Length: 25'	
Weight Limit: 0	
Facility Carried: C3030	
Bridge Type: PRECAST CONC ARCH	
Features Intersected: HOUGHTON BROOK	
Maintenance/Ownership: Town	

0	1	2	3	4	5
Road Widths Travellane Roadway Lane Count Base Subbase					
Curves					
Grades					
Historic Projects					
Maintenance Garage (Not State Maintained)					
Traffic Counters 8627H REC CAT 8627HC					
Functional Class 8					
Speed Zone					
AADT Counts 2012 2011 2010 2009 2008					
Crash Locations 2012 2011 2010 2009 2008					

Historic Projects Retreatment Resurface Unknown Bituminous Mix Skirny Mix Bituminous Seal Gravel Surface Treated Gravel Plant Mix Reclaimed Base and Bituminous Concrete Concrete	Functional Class 1 2 3 4 5 6 7 8 9 10 11 12 13 14 15 16 17 18 19 Speed Zones 25 30 35 40 45 50 55 60 65	Curves - curve left - curve right Grades - grade up - grade down	Road Widths (ft) Traffic Counters (counter ID)	AADT (count) Crash Locations ■ Fatal ■ Injury □ Property Damage Only □ Unknown Crash Type	Mileage by Functional Class By Sheet 0752 8 - Rural - Minor collector 5.030 Total Mileage: 5.030 mi	Mileage by Town By Sheet DANVILLE - S07520303 5.03 of 5.03 Total Mileage: 5.03 mi	DISTRICT 7	TOWN DANVILLE	Date: 11/15/13 1 of 1 TWN mileage: 0.0 to 5.03	ROUTE Min-0752 ETE mileage: 0.0 to 5.03
---	--	---	---	---	---	---	----------------------	-------------------------	---	--