



Route Log Progress Chart

DRAFT

Please Note: Errors and Omissions May Exist.
Contact the VTrans Mapping Unit with questions or concerns.

DISTRICT	TOWN	ROUTE
6	DUXBURY	Min-0708

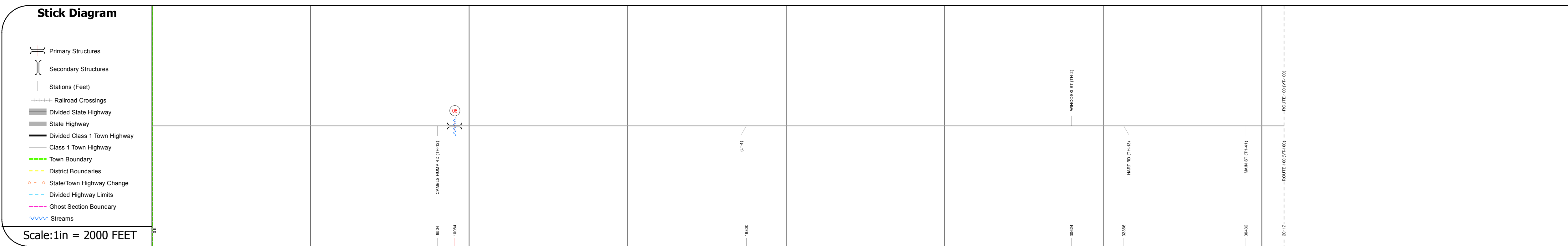
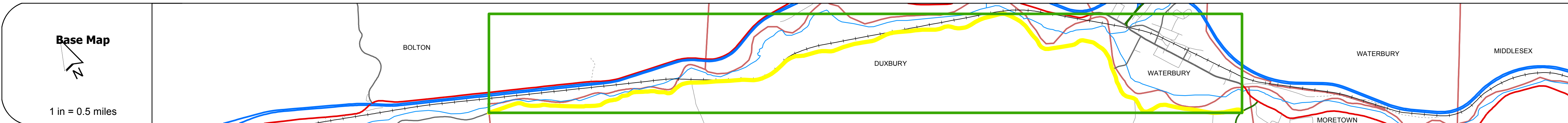
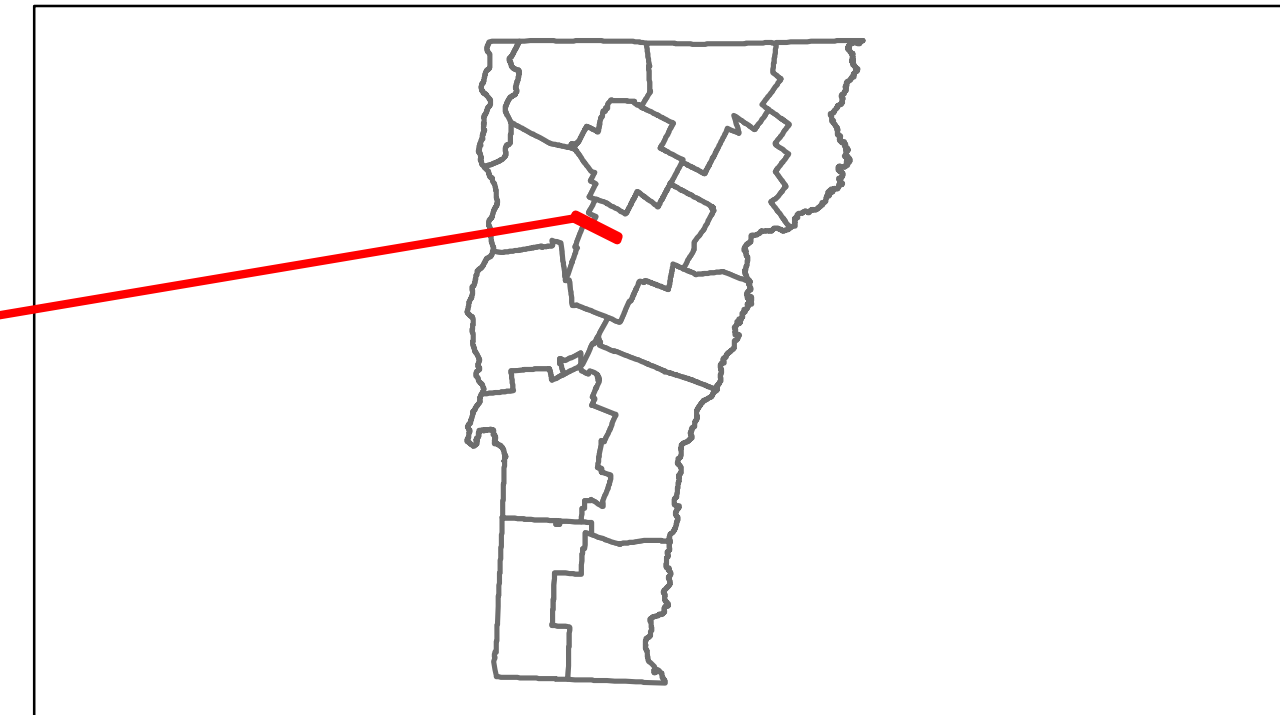

DESCRIPTION BLOCK	
<p>Bridge 6: Stringer/multi-beam or girder - 1997 Structure No. 101206000612061 Length: 54' Width: 23.2' Facility Carried: C2001 Bridge Type: STEEL BEAM Features Intersected: RIDLEY BROOK Surface: Bituminous Maintenance/Ownership: Town</p>	

	0	1	2	3	4	5	6	7
Road Widths Travellane Roadway Lane Count Base Subbase								
Curves								
Grades								
Historic Projects								
Maintenance Garage								
Traffic Counters			SRW272	SRW273		SRW352	SRW350	SRW700
Functional Class					8			
Speed Zone								
AADT Counts	2012							
	2011							
	2010							
	2009							
	2008							
Crash Locations	2012							
	2011	■						
	2010							
	2009		□					
	2008				□			

Historic Projects Retreatment, Resurface, Unknown, Bituminous Mix, Skirny Mix, Bituminous Seal, Gravel, Surface Treated Gravel, Plant Mix, Reclaimed Base and Bituminous Concrete, Concrete	Functional Class 1, 2, 6, 7, 8, 11, 12, 14, 16, 17, 19	Curves curve left, curve right	Road Widths (ft)	Traffic Counters (counter ID)	AADT (count)	Crash Locations Fatal, Injury, Property Damage Only, Unknown Crash Type	Mileage by Functional Class By Sheet 0708 8 - Rural - Minor collector 7.140	Mileage by Town By Sheet DUXBURY - S07081206 7.14 of 7.14	DISTRICT 6	TOWN DUXBURY	Date: 11/15/13	ROUTE Min-0708 ETE mileage: 7.54 to 14.68
						Total Mileage: 7.140 mi	Total Mileage: 7.14 mi	1 of 1 TWN mileage: 0.0 to 7.14				