



Route Log Progress Chart

DRAFT

Please Note: Errors and Omissions May Exist.
Contact the VTrans Mapping Unit with questions or concerns.

DISTRICT	TOWN	ROUTE
5	RICHMOND	Min-0708

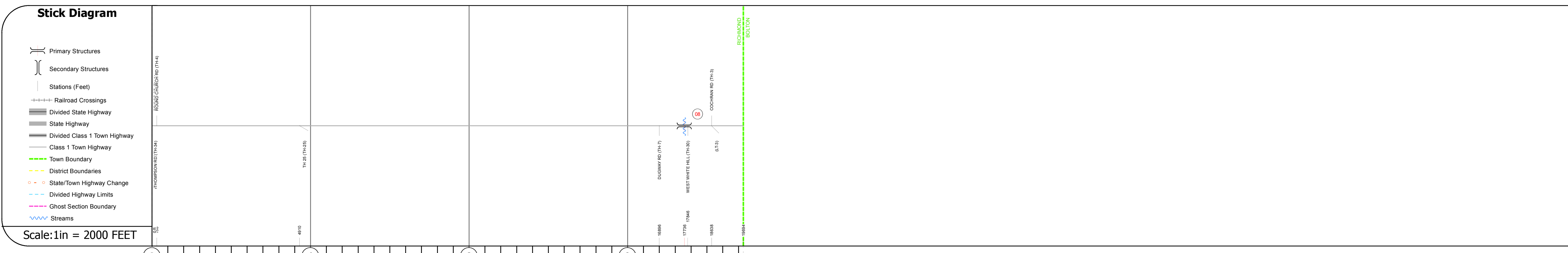
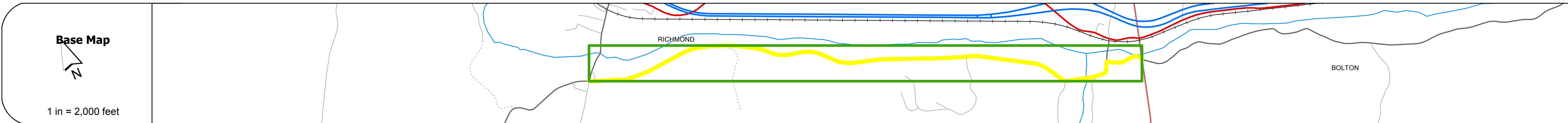
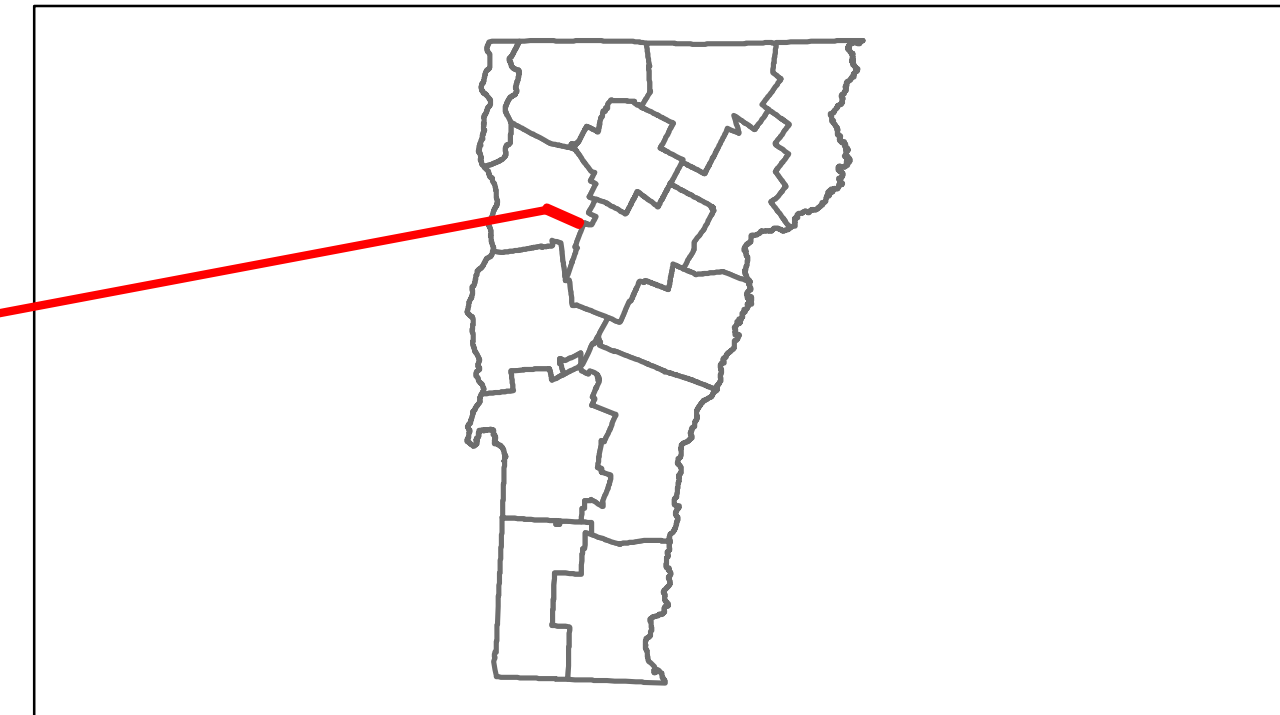

DESCRIPTION BLOCK

Bridge 8:
 Stringer/multi-beam or girder - 1937
 Structure No: 100411000804111
 Length: 136'
 Width: 27.2'
 Weight Limit: 12
 Facility Carried: C2003
 Bridge Type: 2- SP CONT ROLLED BM
 Features Intersected: HUNTINGTON RIVER
 Surface: Bituminous
 Maintenance/Ownership: Town

Road Widths	Travellane			
	Roadway			
	Lane Count			
	Base			
	Subbase			
Curves				
Grades				
Historic Projects				
Maintenance Garage		(Not State Maintained)		
Traffic Counters	860206		860350	
Functional Class	8			
Speed Zone				
AADT Counts	2012			
	2011			
	2010			
	2009			
	2008			
Crash Locations	2012			
	2011			
	2010			
	2009			
	2008			

Historic Projects Retreatment, Resurface, Unknown, Bituminous Mix, Skirny Mix, Bituminous Seal, Gravel, Surface Treated Gravel, Plant Mix, Reclaimed Base and Bituminous Concrete, Concrete	Functional Class 1-19 Speed Zones 25, 30, 35, 40, 45, 50, 55, 60, 65	Curves - curve left, - curve right Grades - grade up, - grade down	Road Widths (ft) Traffic Counters (counter ID)	AADT (count) Crash Locations Fatal, Injury, Property Damage Only, Unknown Crash Type	Mileage by Functional Class By Sheet 0708 8 - Rural - Minor collector 3.730	Mileage by Town By Sheet RICHMOND - S07080411 3.73 of 3.73	DISTRICT 5	TOWN RICHMOND	Date: 11/15/13 1 of 1 TWN mileage: 0.0 to 3.73	ROUTE Min-0708 ETE mileage: 0.0 to 3.73
					Total Mileage: 3.730 mi					