



# Route Log Progress Chart

**DRAFT**

Please Note: Errors and Omissions May Exist.  
Contact the VTrans Mapping Unit with questions or concerns.

DISTRICT	TOWN	ROUTE
6	WAITSFIELD	Min-0682

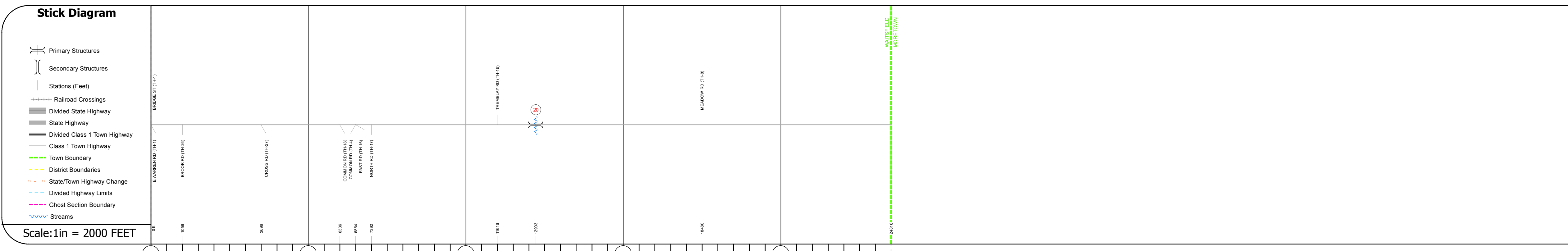
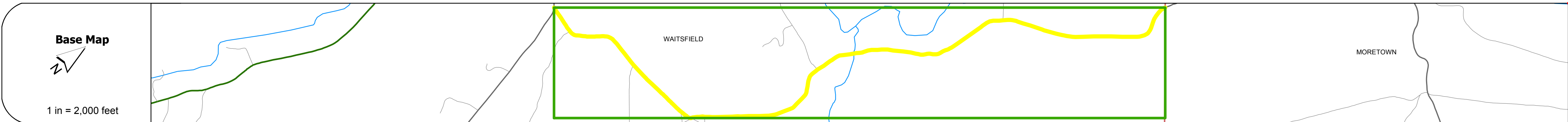
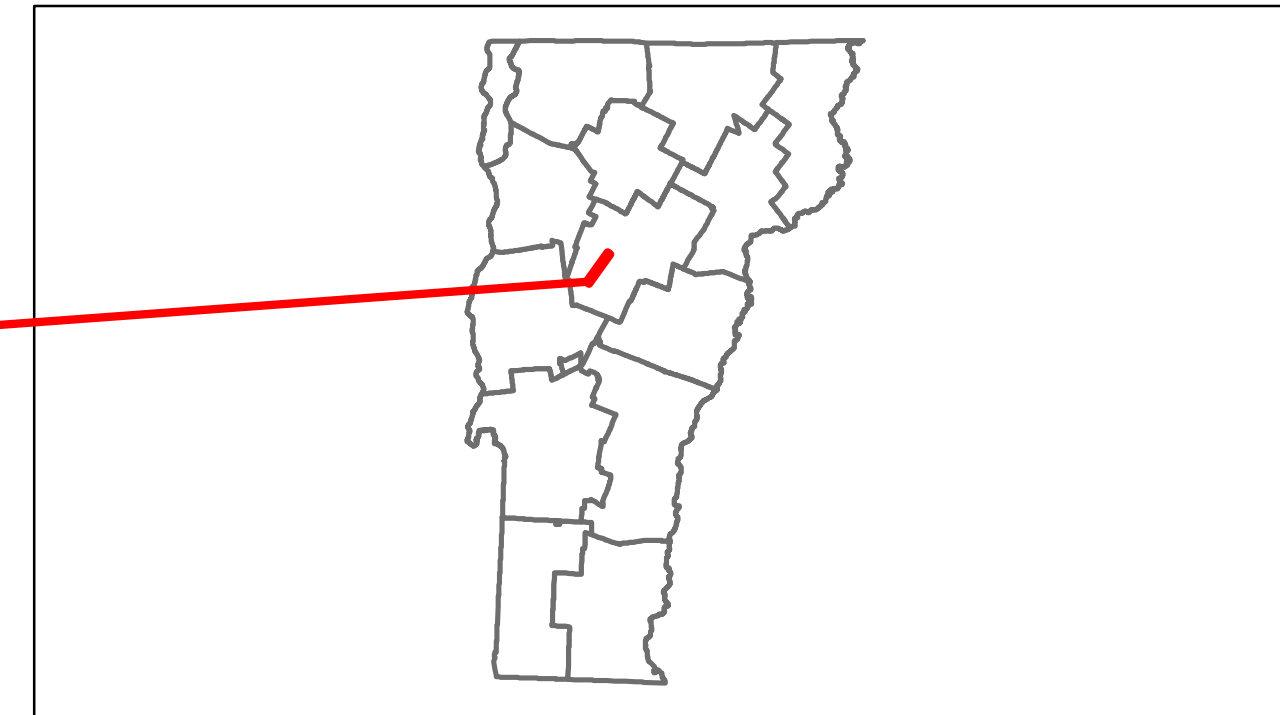

DESCRIPTION BLOCK
<p><b>Bridge 20:</b>            Girder and floorbeam system - 1872            Structure No: 101216002012161            Length: 52'            Height: 9.58'            Width: 13.5'            Weight Limit: 10            Facility Carried: C2003            Bridge Type: STL BMKING POST CB            Features Intersected: PINE BROOK            1            Covered: PINE BROOK            Surface: Timber            Maintenance/Ownership: Town</p>

Road Widths	Curves	Grades	Historic Projects	Maintenance Garage	Traffic Counters	Functional Class	Speed Zone	ADT Counts	Crash Locations										
<table border="1"> <tr><td>Travellane</td><td></td></tr> <tr><td>Roadway</td><td></td></tr> <tr><td>Lane Count</td><td></td></tr> <tr><td>Base</td><td></td></tr> <tr><td>Subbase</td><td></td></tr> </table>	Travellane		Roadway		Lane Count		Base		Subbase				<p>2005 BHC 1446(33)</p>	(Not State Maintained)	<p>SRV331</p> <p>SRV355</p> <p>SRV399</p>	8			
Travellane																			
Roadway																			
Lane Count																			
Base																			
Subbase																			

<b>Historic Projects</b> Retreatment, Resurface, Unknown, Bituminous Mix, Skirny Mix, Bituminous Seal, Bituminous Concrete, Surface Treated Gravel, Plant Mix, Reclaimed Base and Bituminous Concrete, Concrete	<b>Functional Class</b> 1, 2, 6, 7, 8, 11, 12, 14, 16, 17, 19	<b>Curves</b> curve left, curve right	<b>Road Widths</b> (ft)	<b>Traffic Counters</b> (counter ID)	<b>Crash Locations</b> Fatal, Injury, Property Damage Only, Unknown Crash Type	<b>Mileage by Functional Class By Sheet</b> 0682 8 - Rural - Minor collector 4.700	<b>Mileage by Town By Sheet</b> WAITSFIELD - S06821216 4.7 of 4.7	<b>DISTRICT</b> 6	<b>TOWN</b> WAITSFIELD	<b>Date:</b> 11/15/13	<b>ROUTE</b> Min-0682 ETE mileage: 0.0 to 4.7
						<b>Total Mileage:</b> 4.700 mi	<b>Total Mileage:</b> 4.7 mi				