



# Route Log Progress Chart

**DRAFT**

Please Note: Errors and Omissions May Exist.  
Contact the VTrans Mapping Unit with questions or concerns.

DISTRICT	TOWN	ROUTE
5	RIPTON	Min-0640

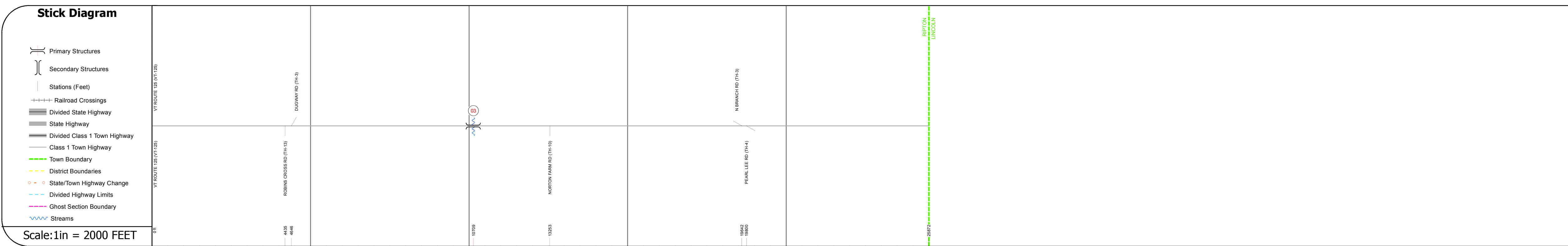
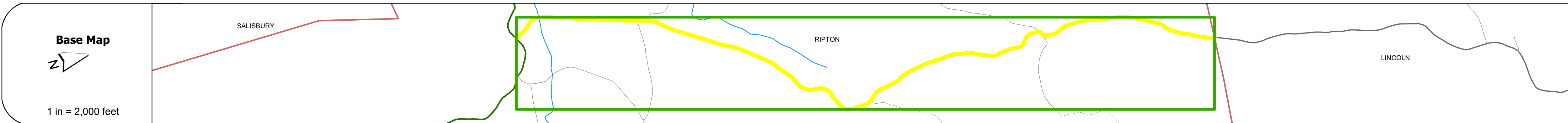
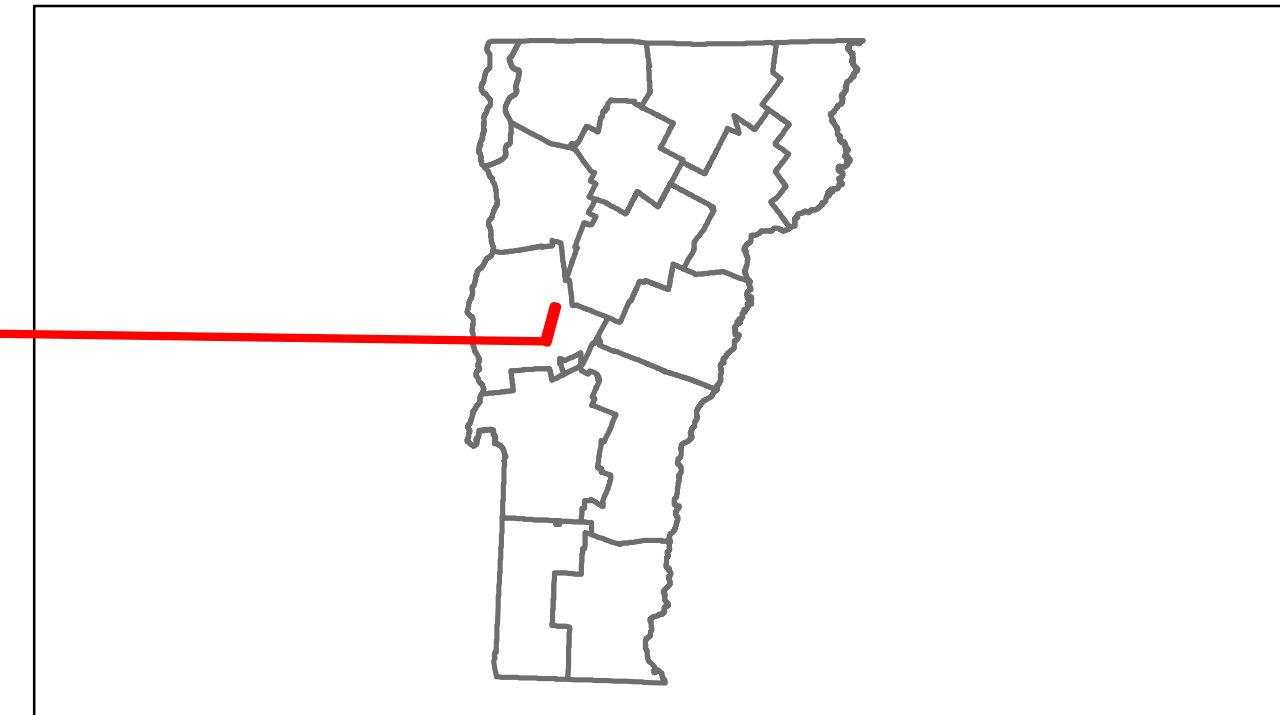

## DESCRIPTION BLOCK

**Bridge 3:**  
Stringer/multi-beam or girder - 1934  
Structure No. 100116000301161  
Length: 74'  
Width: 19.7'  
Facility Carried: C2001  
Bridge Type: ROLLED BEAM  
Features Intersected: N. BR. MIDDLEBURY R.  
Surface: Bituminous  
Maintenance/Ownership: Town

<b>Road Widths</b>	Travellane				
	Roadway				
	Lane Count				
	Base				
	Subbase				
<b>Curves</b>					
<b>Grades</b>					
<b>Historic Projects</b>					
<b>Maintenance Garage</b>			(Not State Maintained)		
<b>Traffic Counters</b>	SEAYAS		SEAZBY		
<b>Functional Class</b>	8				
<b>Speed Zone</b>					
<b>AADT Counts</b>	2012				
	2011				
	2010				
	2009				
	2008				
<b>Crash Locations</b>	2012				
	2011				
	2010				
	2009				
	2008				

<b>Historic Projects</b> Retreatment, Resurface, Unknown, Bituminous Mix, Skirny Mix, Bituminous Seal, Gravel, Surface Treated Gravel, Plant Mix, Reclaimed Base and Bituminous Concrete, Concrete	<b>Functional Class</b> 1-19, Speed Zones 25-65	<b>Curves</b> curve left, curve right	<b>Road Widths</b> Traffic Counters	<b>AADT</b> Crash Locations: Fatal, Injury, Property Damage Only, Unknown Crash Type	<b>Mileage by Functional Class By Sheet</b> 0640 8 - Rural - Minor collector 4.900	<b>Mileage by Town By Sheet</b> RIPTON - S06400116 4.9 of 4.9	<b>DISTRICT</b> 5	<b>TOWN</b> RIPTON	<b>Date:</b> 11/15/13	<b>ROUTE</b> Min-0640
					<b>Total Mileage: 4.900 mi</b>					