



# Route Log Progress Chart

**DRAFT**

Please Note: Errors and Omissions May Exist.  
Contact the VTrans Mapping Unit with questions or concerns.

DISTRICT	TOWN	ROUTE
5	SALISBURY	Min-0628

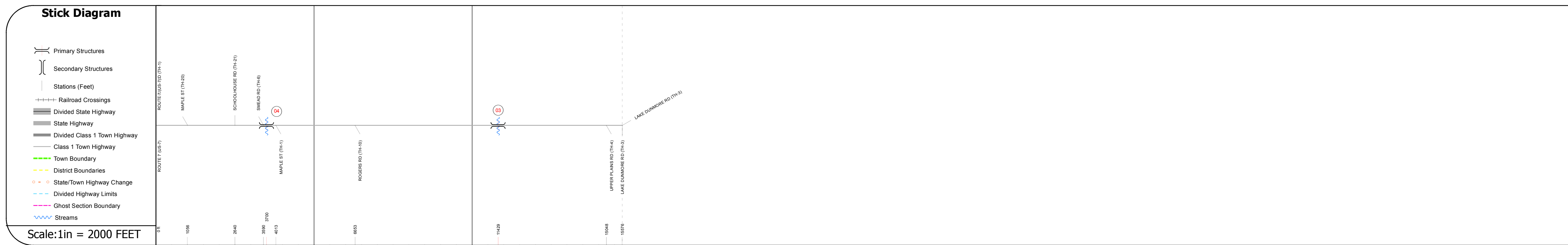
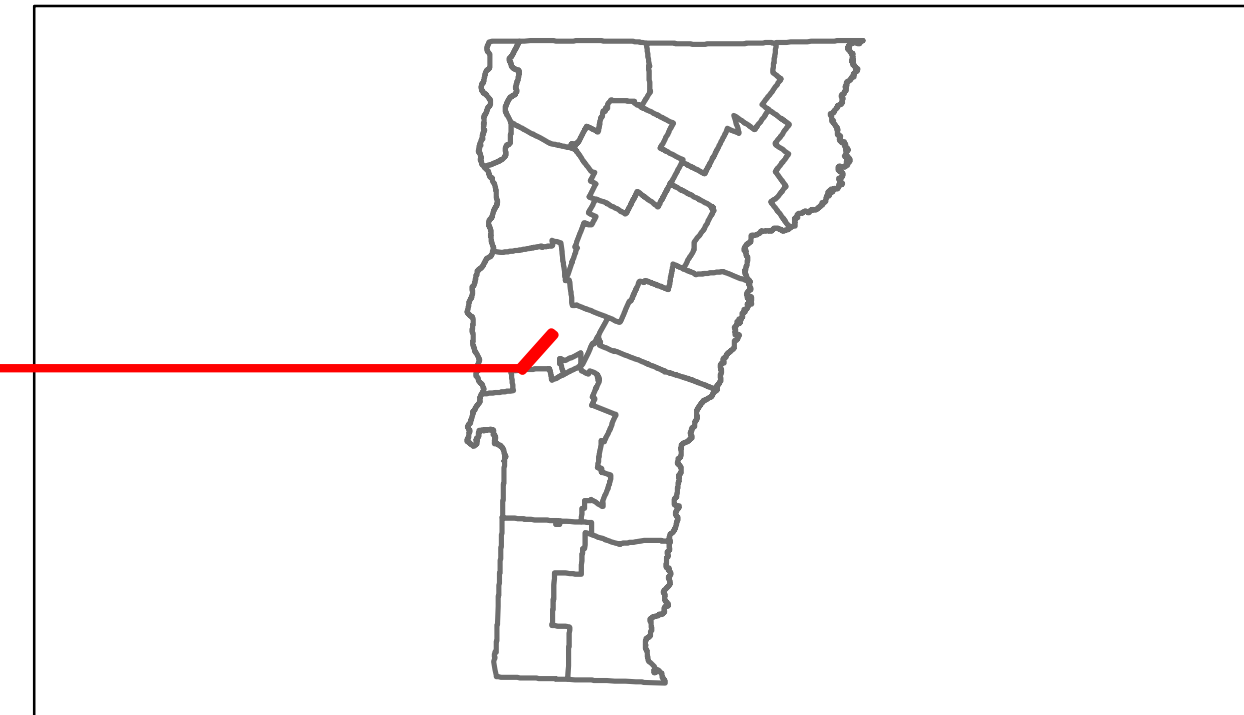

## DESCRIPTION BLOCK

**Bridge 4:**  
Tee Beam - 1919  
Structure No. 100117000401171  
Length: 26'  
Width: 26.5'  
Facility Carried: C2001  
Bridge Type: CONCRETE T-BEAM  
Features Intersected: LEICESTER RIVER  
Surface: Bituminous  
Maintenance/Ownership: Town

**Bridge 3:**  
Slab - 1928  
Structure No. 100117000301171  
Length: 23'  
Width: 21.4'  
Facility Carried: C2004  
Bridge Type: CONCRETE SLAB  
Features Intersected: LEICESTER RIVER  
Surface: Bituminous  
Maintenance/Ownership: Town

<b>Road Widths</b>	Travellane		
	Roadway		
	Lane Count		
	Base		
	Subbase		

<b>Curves</b>			
---------------	--	--	--

<b>Grades</b>			
---------------	--	--	--

<b>Historic Projects</b>			
--------------------------	--	--	--

<b>Maintenance Garage</b>	(Not State Maintained)		
---------------------------	------------------------	--	--

<b>Traffic Counters</b>	SEAXBI	SEAXBI	SEAXBI
-------------------------	--------	--------	--------

<b>Functional Class</b>	8		
-------------------------	---	--	--

<b>Speed Zone</b>			
-------------------	--	--	--

<b>ADT Counts</b>	2012		
	2011		
	2010		
	2009		
	2008		

<b>Crash Locations</b>	2012		
	2011		
	2010		
	2009		
	2008		

<b>Historic Projects</b> Retreatment, Resurface, Unknown, Bituminous Mix, Skippy Mix, Bituminous Seal, Gravel, Surface Treated Gravel, Plant Mix, Reclaimed Base and Bituminous Concrete, Concrete	<b>Functional Class</b> 1, 2, 3, 4, 5, 6, 7, 8, 9, 10, 11, 12, 13, 14, 15, 16, 17, 18, 19	<b>Curves</b> - curve left, - curve right	<b>Road Widths</b> (ft)	<b>Traffic Counters</b> (counter ID)	<b>Crash Locations</b> Fatal, Injury, Property Damage Only, Unknown Crash Type	<b>Mileage by Functional Class By Sheet</b> 0628 8 - Rural - Minor collector 2.950	<b>Mileage by Town By Sheet</b> SALISBURY - S06280117 2.95 of 2.95	<b>DISTRICT</b> 5	<b>TOWN</b> SALISBURY	<b>Date:</b> 11/15/13	<b>ROUTE</b> Min-0628
						<b>Total Mileage: 2.950 mi</b>					