



Route Log Progress Chart

DRAFT

Please Note: Errors and Omissions May Exist.
Contact the VTrans Mapping Unit with questions or concerns.

DISTRICT	TOWN	ROUTE
3	KILLINGTON	Min-0604

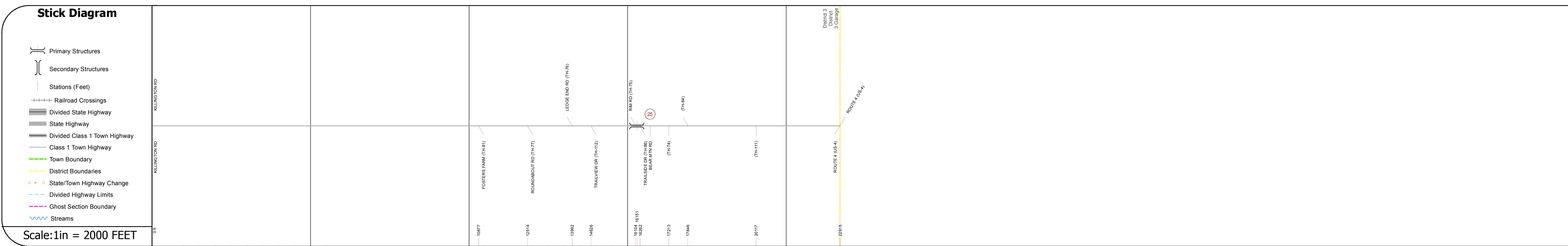
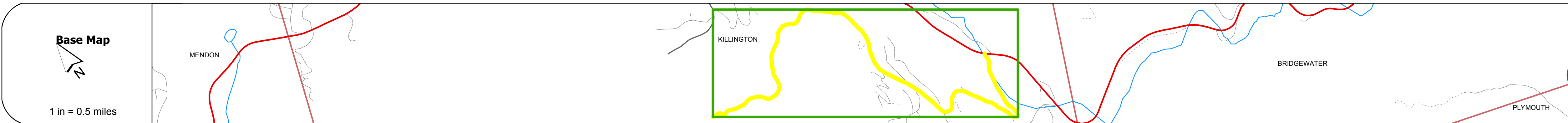
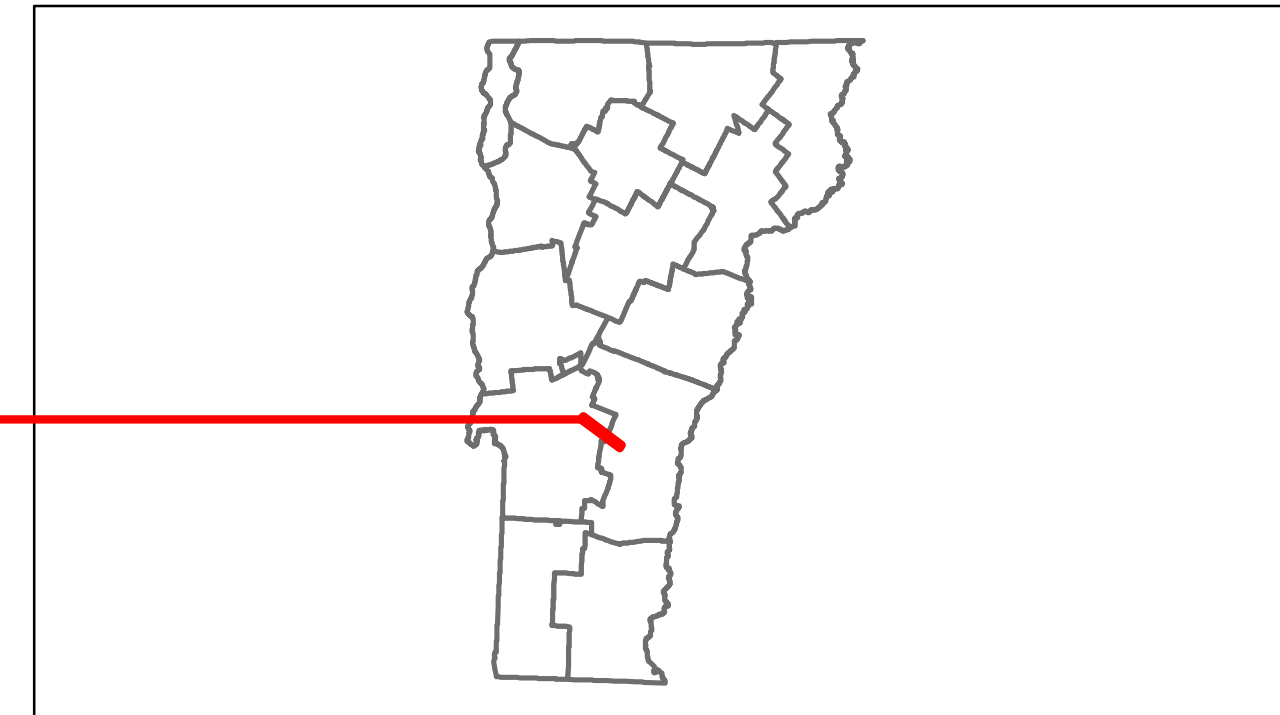

DESCRIPTION BLOCK

Bridge 25:
 Stringer/multi-beam or girder - 1987
 Structure No. 101121002511211
 Length: 43'
 Height: 0.0'
 Facility Carried: PEDESTRIAN
 Bridge Type: STEEL BM W TIMBER DK
 Features Intersected: SKI TRAIL OV TH15

Road Widths	Travellane								
	Roadway								
	Lane Count								
	Base								
	Subbase								
Curves									
Grades									
Historic Projects									
Maintenance Garage									
Traffic Counters									
Functional Class				8					
Speed Zone									
AADT Counts	2012								
	2011								
	2010								
	2009								
	2008								
Crash Locations	2012								
	2011								
	2010								
	2009								
	2008								

Historic Projects Retreatment, Resurface, Unknown, Bituminous Mix, Skirny Mix, Bituminous Seal, Gravel, Surface Treated Gravel, Plant Mix, Reclaimed Base and Bituminous Concrete, Concrete	Functional Class 1, 2, 3, 4, 5, 6, 7, 8, 9, 10, 11, 12, 13, 14, 15, 16, 17, 18, 19	Curves curve left, curve right	Road Widths (ft)	Traffic Counters (counter ID)	AADT (count)	Crash Locations Fatal, Injury, Property Damage Only, Unknown Crash Type	Mileage by Functional Class By Sheet 0604 8 - Rural - Minor collector 4.340	Mileage by Town By Sheet KILLINGTON - S06041121 4.34 of 4.34	DISTRICT 3	TOWN KILLINGTON	Date: 11/15/13	ROUTE Min-0604 ETE mileage: 0.0 to 4.34
							Total Mileage: 4.340 mi					