



Route Log Progress Chart

DRAFT

Please Note: Errors and Omissions May Exist.
Contact the VTrans Mapping Unit with questions or concerns.

DISTRICT	TOWN	ROUTE
3	BENSON	Min-0592

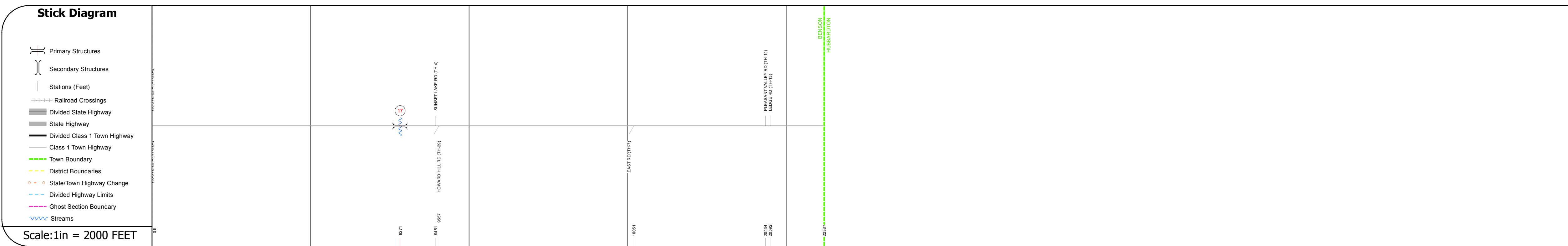
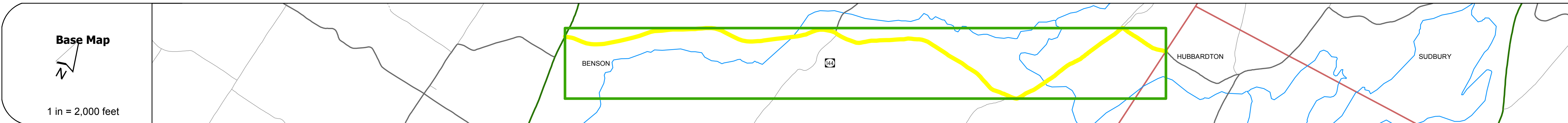
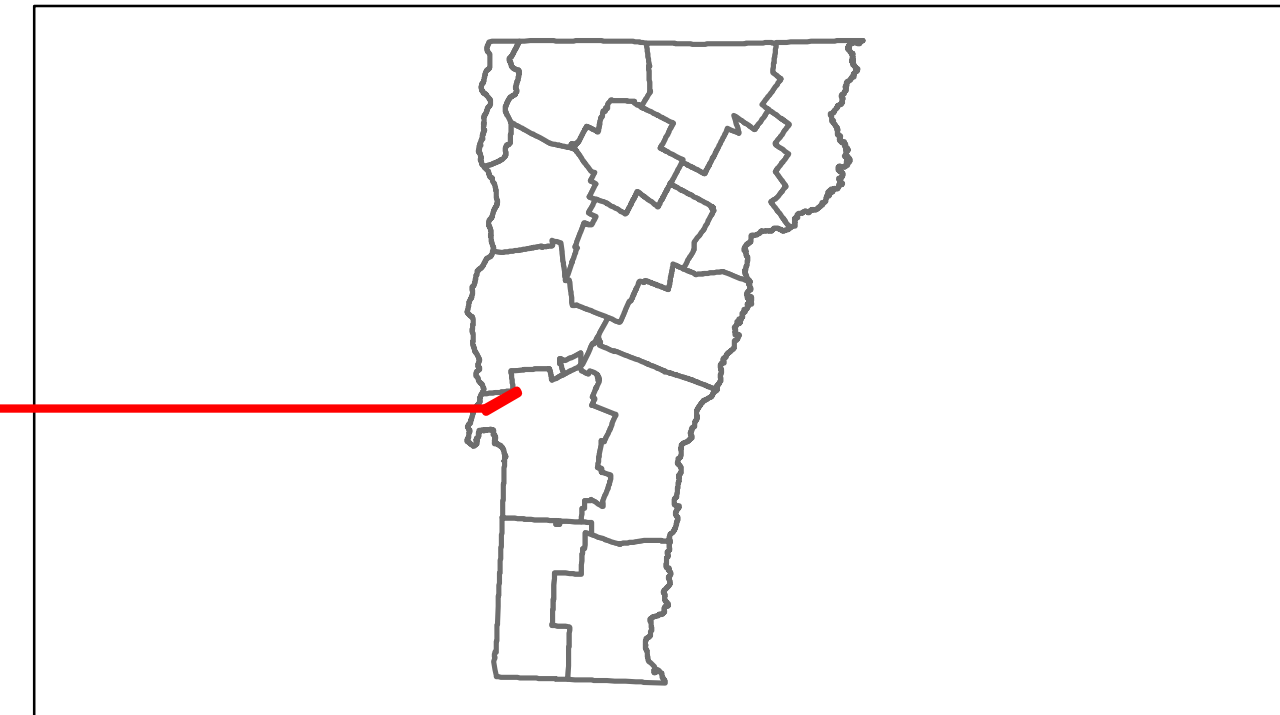

DESCRIPTION BLOCK

Bridge 17:
 Stringer/multi-beam or girder - 1939
 Structure No. 101101001711011
 Length: 49'
 Width: 21.8'
 Facility Carried: C2002
 Bridge Type: GALV ROLLED BEAM
 Features Intersected: HUBBARDTON RIVER
 Maintenance/Ownership: Town

Road Widths	Travellane				
	Roadway				
	Lane Count				
	Base				
	Subbase				
Curves					
Grades					
Historic Projects					
Maintenance Garage		(Not State Maintained)			
Traffic Counters	568433	568434	568435		
Functional Class	8				
Speed Zone					
AADT Counts	2012				
	2011				
	2010				
	2009				
	2008				
Crash Locations	2012				
	2011				
	2010				
	2009				
	2008				

Historic Projects Retreatment, Resurface, Unknown, Bituminous Mix, Skirny Mix, Bituminous Seal, Gravel, Surface Treated Gravel, Plant Mix, Reclaimed Base and Bituminous Concrete, Concrete	Functional Class 1, 2, 3, 4, 5, 6, 7, 8, 9, 10, 11, 12, 13, 14, 15, 16, 17, 18, 19	Curves curve left, curve right	Road Widths (ft)	AADT (count)	Mileage by Functional Class By Sheet 0592 8 - Rural - Minor collector 4.240	Mileage by Town By Sheet BENSON - S05921101 4.24 of 4.24	DISTRICT 3	TOWN BENSON	Date: 11/15/13	ROUTE Min-0592
					Crash Locations Fatal, Injury, Property Damage Only, Unknown Crash Type	Total Mileage: 4.240 mi	Total Mileage: 4.24 mi	1 of 1 TWN mileage: 0.0 to 4.24	ETE mileage: 0.0 to 4.24	ETE mileage: 0.0 to 4.24