



Route Log Progress Chart

DRAFT

Please Note: Errors and Omissions May Exist.
Contact the VTrans Mapping Unit with questions or concerns.

DISTRICT	TOWN	ROUTE
3	PLYMOUTH	Min-0584

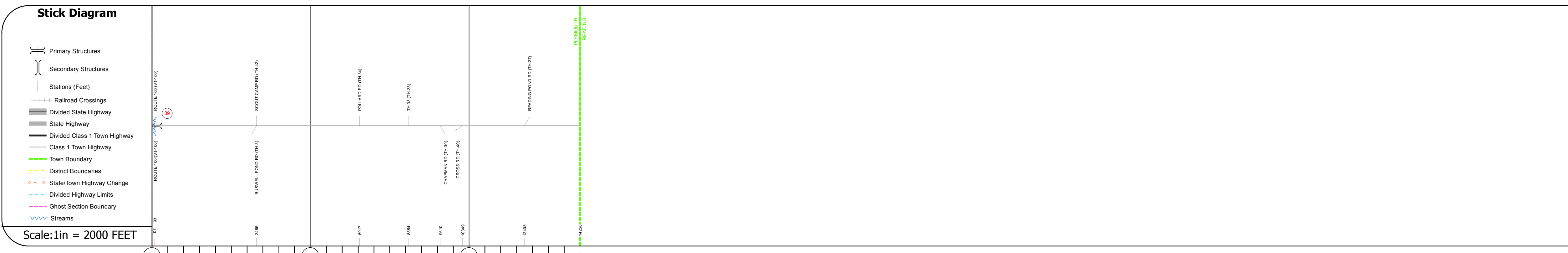
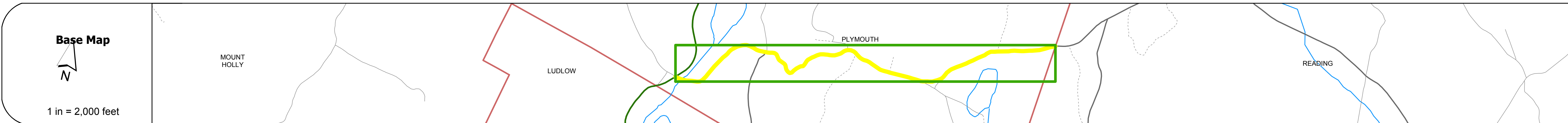
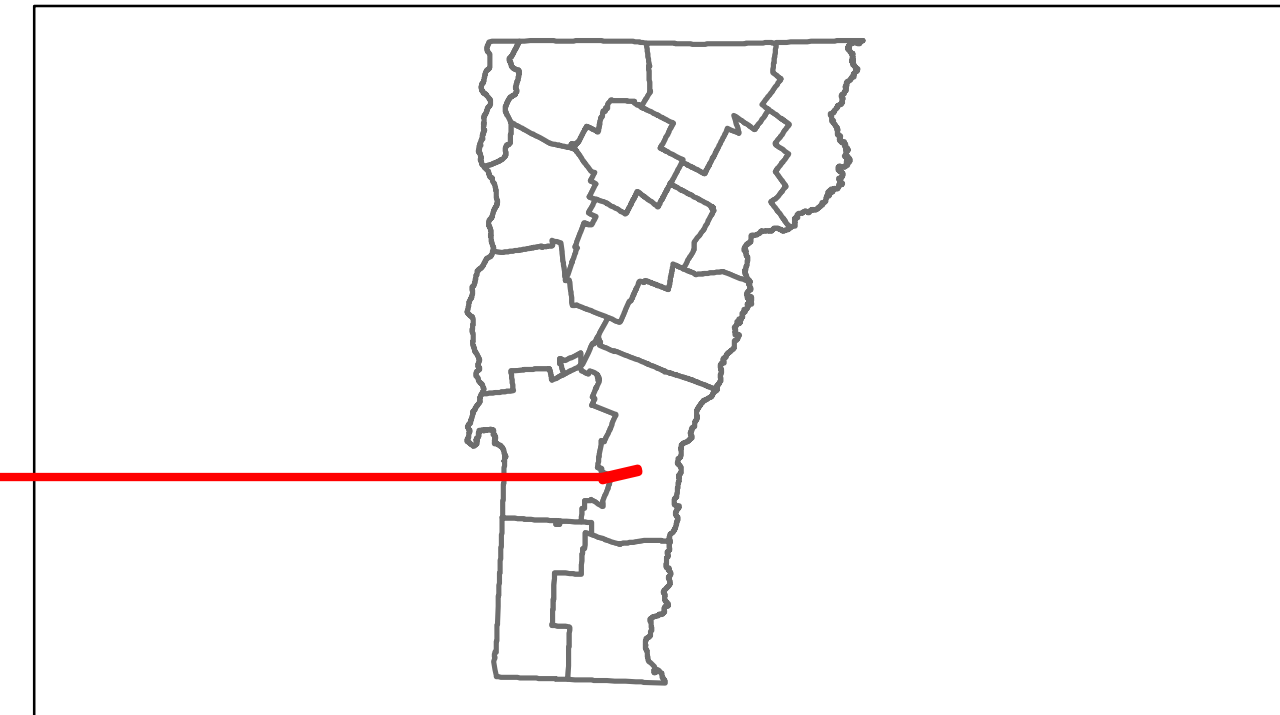

DESCRIPTION BLOCK

Bridge 39:
Tee Beam - 1928
Structure No: 101412003914121
Length: 54'
Width: 22.5'
Weight Limit: 0
Facility Carried: C2002
Bridge Type: CONCRETE T-BEAM
Features Intersected: BLACK RIVER
Surface: Bituminous
Maintenance/Ownership: Town

Road Widths	Travellane Roadway Lane Count Base Subbase			
Curves				
Grades				
Historic Projects				
Maintenance Garage		(Not State Maintained)		
Traffic Counters		SEV352 SEV388		
Functional Class		8		
Speed Zone				
AADT Counts	2012 2011 2010 2009 2008			
Crash Locations	2012 2011 2010 2009 2008			

Historic Projects Retreatment Resurface Unknown Bituminous Mix Skirny Mix Bituminous Seal Bituminous Concrete Surface Treated Gravel Plant Mix Reclaimed Base and Bituminous Concrete Concrete	Functional Class 1 2 3 4 5 6 7 8 9 10 11 12 13 14 15 16 17 18 19 Speed Zones 25 30 35 40 45 50 55 60 65	Curves - curve left - curve right Grades - grade up - grade down	Road Widths (ft) Traffic Counters (counter ID)	AADT (count) Crash Locations Fatal Injury Property Damage Only Unknown Crash Type	Mileage by Functional Class By Sheet 0584 8 - Rural - Minor collector 2.700 Total Mileage: 2.700 mi	Mileage by Town By Sheet PLYMOUTH - S05841412 2.7 of 2.7 Total Mileage: 2.7 mi	DISTRICT 3	TOWN PLYMOUTH	Date: 11/15/13 1 of 1 TWN mileage: 0.0 to 2.7	ROUTE Min-0584 ETE mileage: 0.0 to 2.7
--	--	---	---	---	---	--	----------------------	-------------------------	--	---