



Route Log Progress Chart

DRAFT

Please Note: Errors and Omissions May Exist.
Contact the VTrans Mapping Unit with questions or concerns.

DISTRICT	TOWN	ROUTE
2	DUMMERSTON	Min-0530

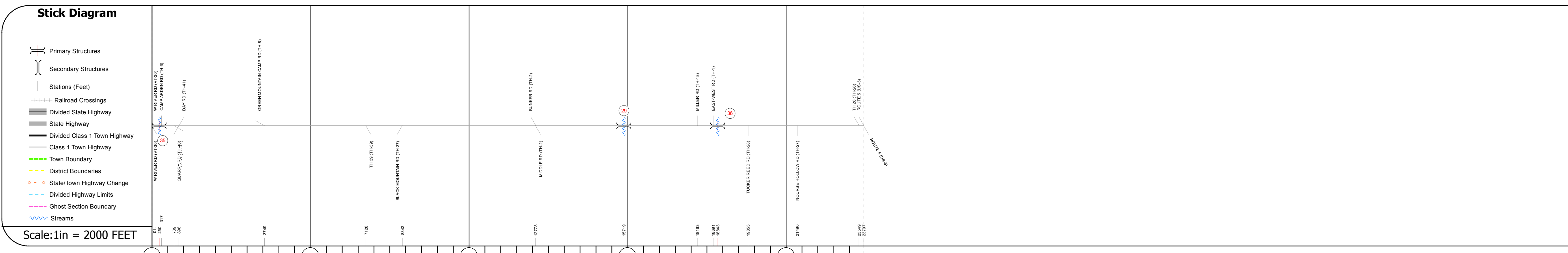
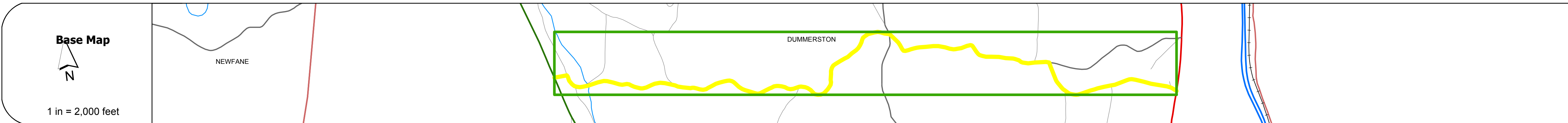
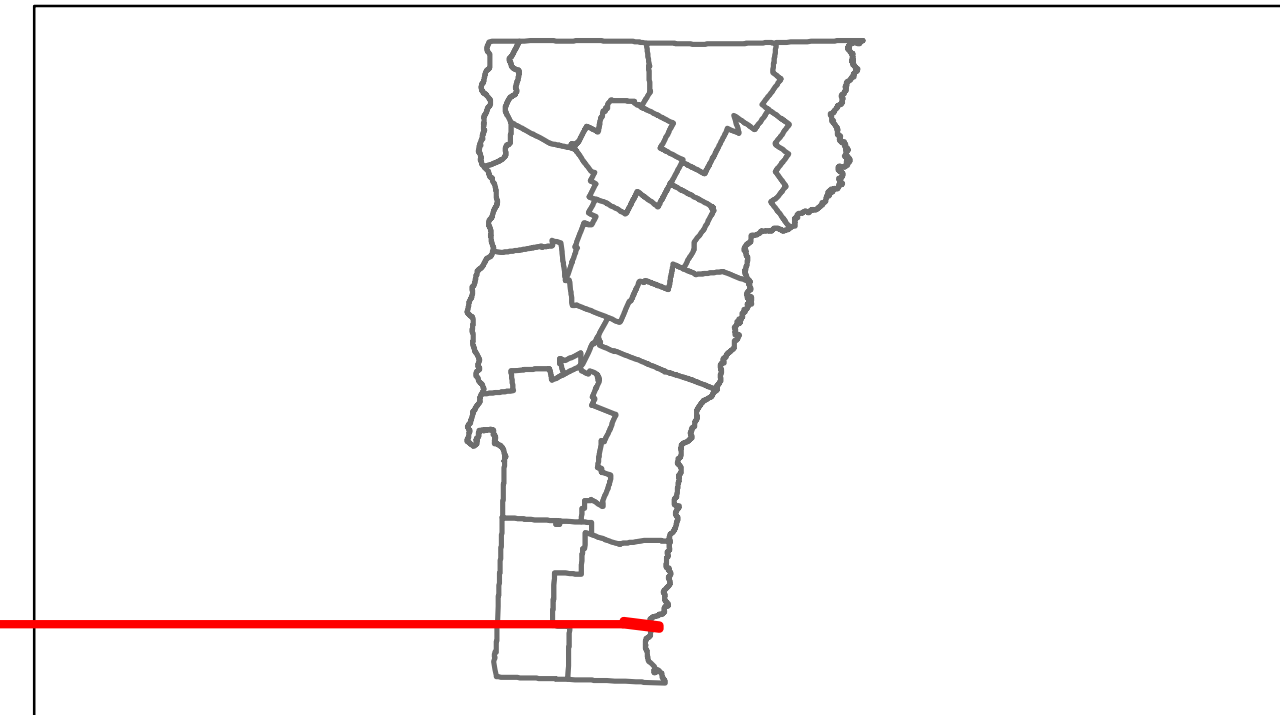

Road Widths	Travellane	Roadway	Lane Count	Base	Subbase

Curves					

Grades					

Historic Projects					

Maintenance Garage					
			(Not State Maintained)		

Traffic Counters	SEX240	SEX349	SEX416	SEX447	SEX347	SEX346

Functional Class					
			8		

Speed Zone					

AADT Counts	2012				
	2011				
	2010				
	2009				
	2008				

Crash Locations	2012				
	2011				
	2010				
	2009				
	2008				

DESCRIPTION BLOCK
<p>Bridge 35: Truss - thru - 1872 Structure No. 101305003513051 Length: 269' Height: 11.53' Width: 12.0' Weight Limit: 10 Facility Carried: C2001 Bridge Type: 2SPN TOWN LATTICE CB Features Intersected: WEST RIVER 1 Covered: WEST RIVER Surface: Timber Maintenance/Ownership: Town</p> <p>Bridge 29: Stringer/multi-beam or girder - 1935 Structure No. 101305002913051 Length: 46' Width: 21.0' Weight Limit: 10 Facility Carried: C2001 Bridge Type: ROLLED BEAM Features Intersected: SALMON BROOK Surface: Bituminous Maintenance/Ownership: Town</p> <p>Bridge 36: Tee Beam - 1937 Structure No. 101305003613051 Length: 117' Width: 21.0' Weight Limit: 10 Facility Carried: C2001 Bridge Type: 2 SP CONCRETE T-BEAM Features Intersected: SALMON BROOK Surface: Bituminous Maintenance/Ownership: Town</p>

Historic Projects	Functional Class	Curves	Road Widths	AADT	Mileage by Functional Class By Sheet	Mileage by Town By Sheet	DISTRICT	TOWN	Date: 11/15/13	ROUTE
<ul style="list-style-type: none"> Retreatment Resurface Unknown Bituminous Mix Skinny Mix Bituminous Seal Gravel Surface Treated Gravel Plant Mix Reclaimed Base and Bituminous Concrete Concrete 	<ul style="list-style-type: none"> 1 2 6 7 8 11 12 14 16 17 19 	<ul style="list-style-type: none"> curve left curve right 	<ul style="list-style-type: none"> (ft) 	<ul style="list-style-type: none"> (count) 	0530 8 - Rural - Minor collector 4.490	DUMMERSTON - S05301305 4.49 of 4.49	2	DUMMERSTON	1 of 1 TWN mileage: 0.0 to 4.49	Min-0530 ETE mileage: 0.0 to 4.49
Total Mileage: 4.490 mi						Total Mileage: 4.49 mi				