



# Route Log Progress Chart

**DRAFT**

Please Note: Errors and Omissions May Exist.  
Contact the VTrans Mapping Unit with questions or concerns.

DISTRICT	TOWN	ROUTE
6	WOLCOTT	Maj-0324

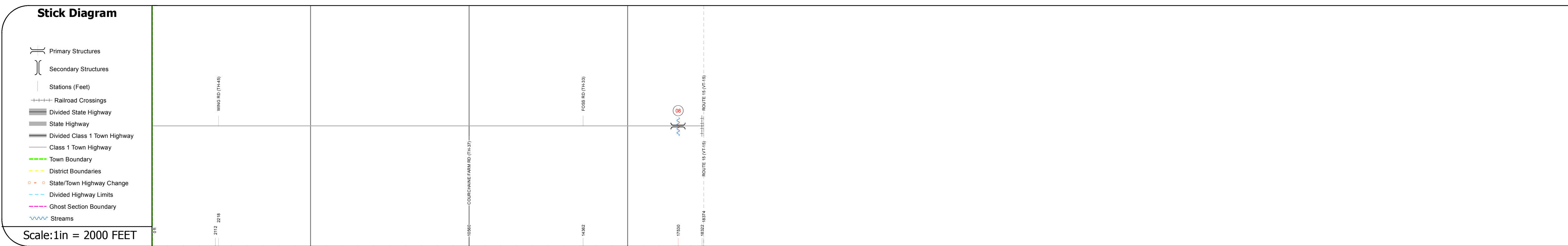
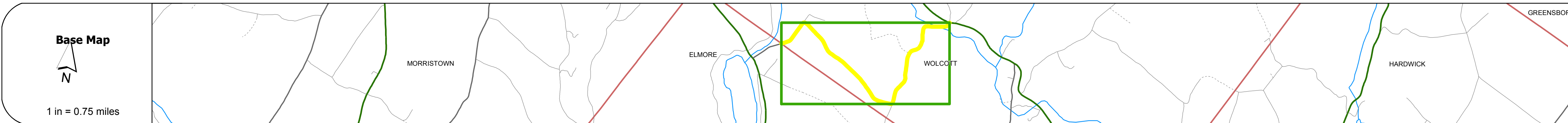
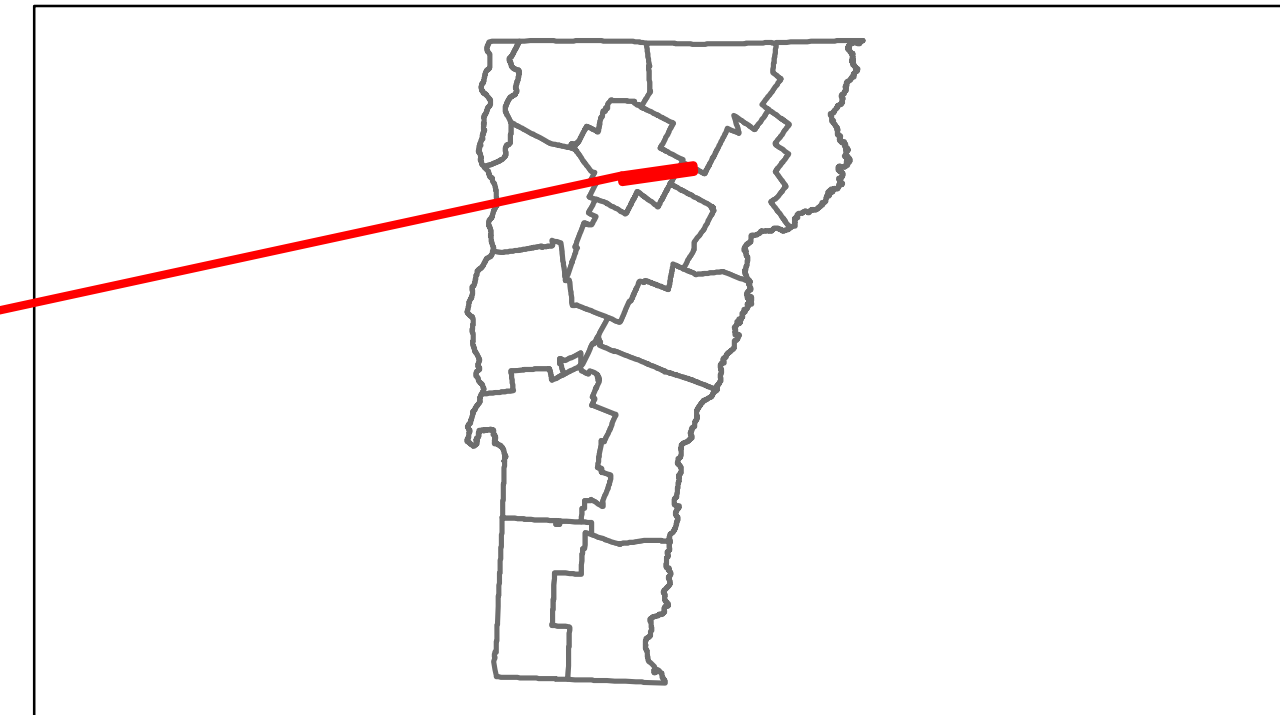

## DESCRIPTION BLOCK

**Bridge 8:**  
 Stringer/multi-beam or girder - 1984  
 Structure No. 10081000808101  
 Length: 102'  
 Width: 26.7'  
 Weight Limit: 0  
 Facility Carried: C2004  
 Bridge Type: WELDED GIRDER  
 Features Intersected: LAMOILLE RIVER  
 Maintenance/Ownership: Town

<b>Road Widths</b>	Travellane: 20 Roadway: 20 Lane Count: 2 Base: 2 Subbase: 2
<b>Curves</b>	
<b>Grades</b>	
<b>Historic Projects</b>	
<b>Maintenance Garage</b>	(Not State Maintained)
<b>Traffic Counters</b>	SHL 187
<b>Functional Class</b>	7
<b>Speed Zone</b>	
<b>ADT Counts</b>	2012: 490 2011: 490 2010: 480 2009: 470 2008: 450
<b>Crash Locations</b>	2012: 1 Fatal, 1 Property Damage Only 2011: 1 Injury, 1 Unknown Crash Type 2010: 1 Injury, 1 Unknown Crash Type 2009: 1 Injury, 1 Unknown Crash Type 2008: 1 Injury, 1 Unknown Crash Type

<b>Historic Projects</b> Retirement, Resurface, Unknown, Bituminous Mix, Skirny Mix, Bituminous Seal, Gravel, Surface Treated Gravel, Plant Mix, Reclaimed Base and Bituminous Concrete, Concrete	<b>Functional Class</b> 1, 2, 3, 4, 5, 6, 7, 8, 9, 10, 11, 12, 13, 14, 15, 16, 17, 18, 19	<b>Curves</b> curve left, curve right	<b>Road Widths</b> (ft)	<b>ADT</b> (count)	<b>Mileage by Functional Class By Sheet</b> 0324 7 - Rural - Major collector 3.480	<b>Mileage by Town By Sheet</b> WOLCOTT - S03240810 3.48 of 3.48	<b>DISTRICT</b> 6	<b>TOWN</b> WOLCOTT	<b>Date:</b> 11/15/13	<b>ROUTE</b> Maj-0324
					<b>Crash Locations</b> Fatal, Injury, Property Damage Only, Unknown Crash Type	<b>Total Mileage:</b> 3.480 mi				