



Route Log Progress Chart

DRAFT

Please Note: Errors and Omissions May Exist.
Contact the VTrans Mapping Unit with questions or concerns.

DISTRICT	TOWN	ROUTE
9	LOWELL	Maj-0308

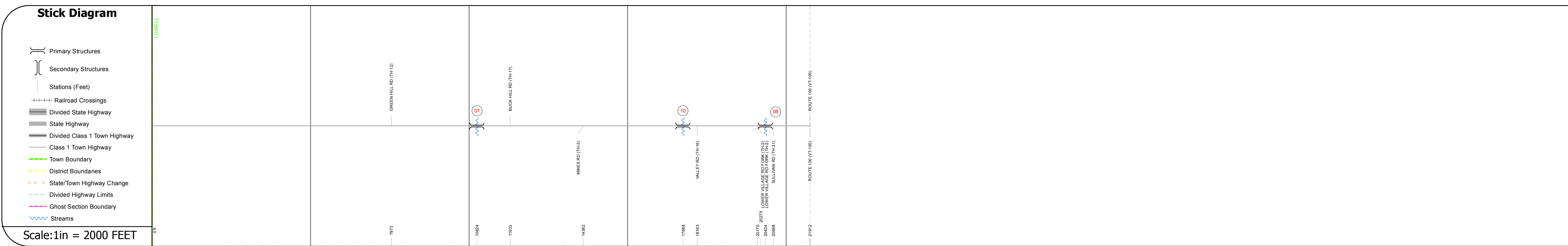
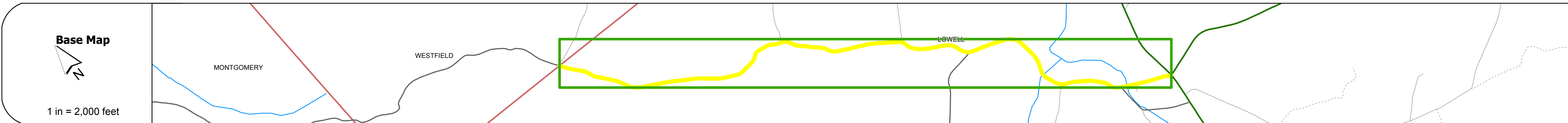
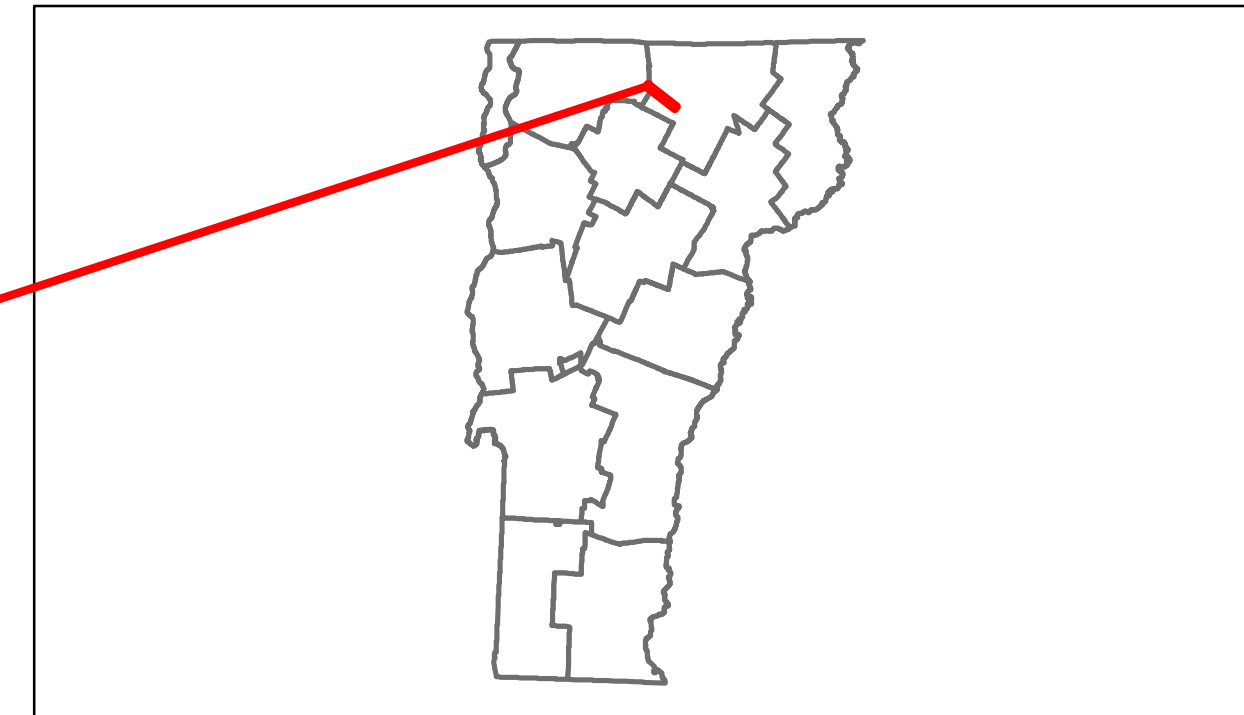

DESCRIPTION BLOCK

Bridge 7:
Tee Beam - 1928
Structure No. 200308000710132
Length: 31'
Width: 20.8'
Facility Carried: TR 01 FAS 308
Bridge Type: CONCRETE T-BEAM
Features Intersected: NOTCH BROOK
Surface: Gravel
Maintenance/Ownership: Town

Bridge 10:
Tee Beam - 1923
Structure No. 200308001010132
Length: 38'
Width: 17.5'
Facility Carried: TR 01 FAS 308
Bridge Type: CONCRETE T-BEAM
Features Intersected: BURGESS BROOK
Surface: Bituminous
Maintenance/Ownership: Town

Bridge 8:
Tee Beam - 1929
Structure No. 200308000810132
Length: 54'
Width: 25.0'
Facility Carried: TR 01 FAS 308
Bridge Type: CONCRETE T-BEAM
Features Intersected: EAST BROOK
Surface: Bituminous
Maintenance/Ownership: Town

Road Widths	Travellane	20	22	24
	Roadway	20	22	24
	Lane Count			
	Base			
	Subbase			

Curves				
---------------	--	--	--	--

Grades				
---------------	--	--	--	--

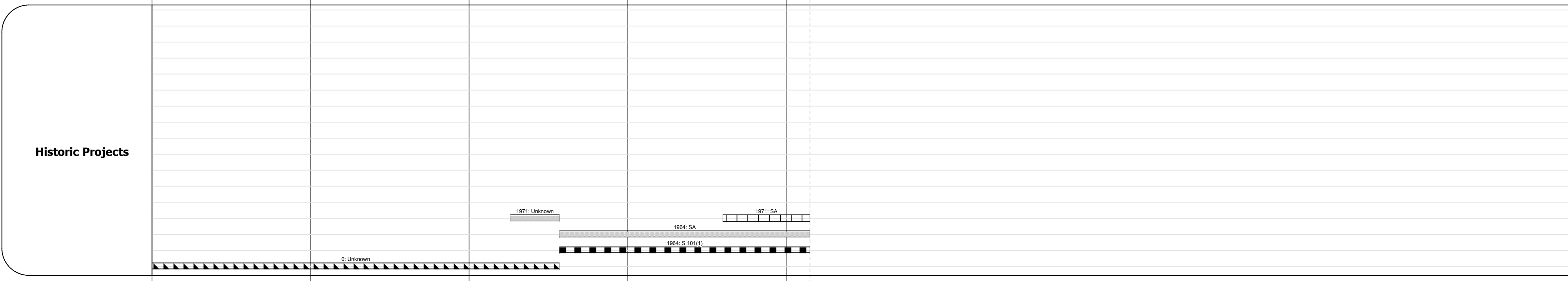

Maintenance Garage				
---------------------------	--	--	--	--

Traffic Counters	S6P132	S6P364	S6P367	
-------------------------	--------	--------	--------	--

Functional Class	7			
-------------------------	---	--	--	--

Speed Zone				
-------------------	--	--	--	--

ADT Counts	2012	170	880	670
	2011	170	670	660
	2010	170	640	640
	2009	170	620	620
	2008	170	590	600

Crash Locations	2012			
	2011			
	2010			
	2009			
	2008			

Historic Projects Retreatment, Resurface, Unknown, Bituminous Mix, Skippy Mix, Bituminous Seal, Bituminous Concrete, Surface Treated Gravel, Plant Mix, Reclaimed Base and Bituminous Concrete, Concrete	Functional Class 1, 2, 3, 4, 5, 6, 7, 8, 9, 10, 11, 12, 13, 14, 15, 16, 17, 18, 19	Curves curve left, curve right	Road Widths (ft)	ADT (count)	Mileage by Functional Class By Sheet 0308 7 - Rural - Major collector 4.150	Mileage by Town By Sheet LOWELL - S03081013 4.15 of 4.15	DISTRICT 9	TOWN LOWELL	Date: 11/14/13	ROUTE Maj-0308 ETE mileage: 6.32 to 10.47	
Total Mileage: 4.150 mi						Total Mileage: 4.15 mi					