



Route Log Progress Chart

DRAFT

Please Note: Errors and Omissions May Exist.
Contact the VTrans Mapping Unit with questions or concerns.

DISTRICT	TOWN	ROUTE
9	GREENSBORO	Maj-0255

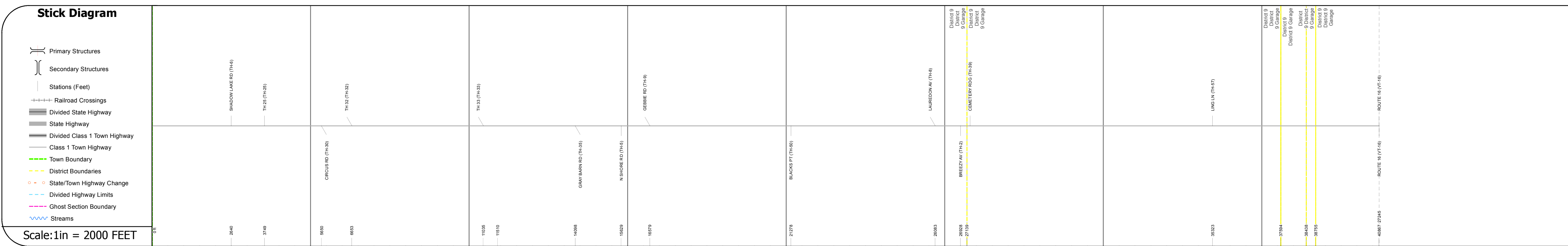
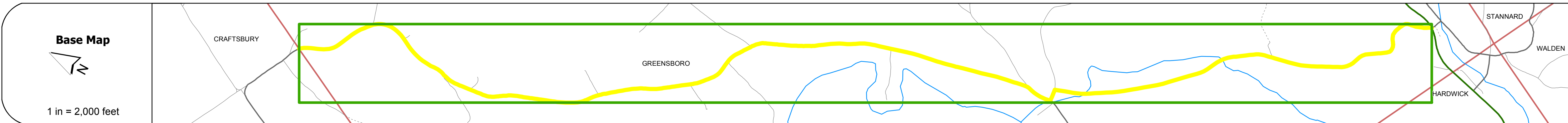
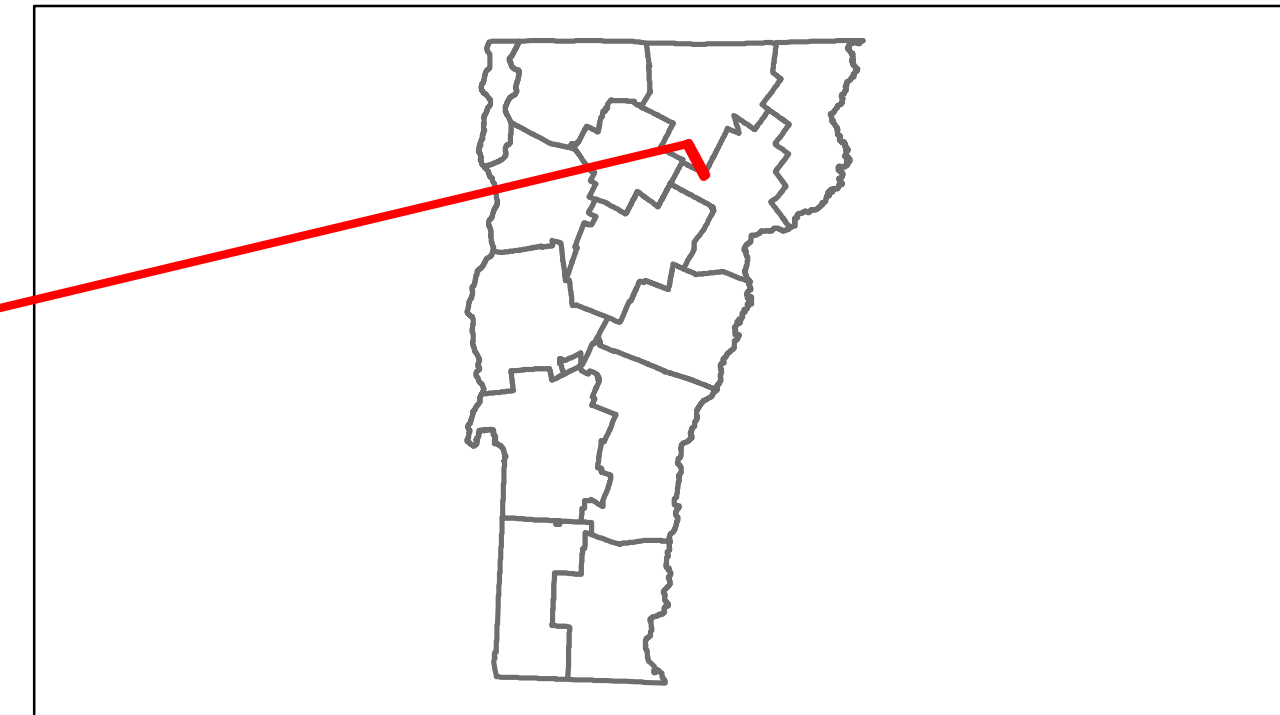

DESCRIPTION BLOCK

Road Widths	Travellane Roadway Lane Count Base Subbase	20 24 26 24			
Curves					
Grades					
Historic Projects		<p>1979: Unknown</p> <p>1963: SA</p> <p>1960: S 0255(1)</p> <p>1972: SA</p> <p>1965: Unknown</p> <p>1975: Unknown</p> <p>1963: SA</p> <p>1977: Unknown</p> <p>1968: SA</p> <p>1966: SA</p> <p>1971: SA</p> <p>1965: SA</p> <p>1966: S 238(1)</p> <p>1962: SA</p> <p>1968: SA</p> <p>1966: SA</p> <p>1971: SA</p> <p>1965: SA</p> <p>1969: FAS 21.A</p>			
Maintenance Garage		(Not State Maintained)			
Traffic Counters		S6P2AM S6P347 S6P345 S6P251 S6P220W S6P342 S6P2AL			
Functional Class		7			
Speed Zone					
AADT Counts	2012 2011 2010 2009 2008	610 600 620 650 670	640 630 660 680 710	1500 1300 1500 1300 1500 1300 1500 1300 1500 1300	660 650 660 670 680
Crash Locations	2012 2011 2010 2009 2008				

Historic Projects Retreatment Resurface Unknown Bituminous Mix Skippy Mix Bituminous Seal Bituminous Concrete Surface Treated Gravel Macadam Cold Plant and Bituminous Concrete Concrete Gravel Plant Mix Reclaimed Base and Bituminous Concrete	Functional Class 1 2 3 4 5 6 7 8 9 10 11 12 13 14 15 16 17 18 19 Speed Zones 25 30 35 40 45 50 55 60 65	Curves - curve left - curve right Grades - grade up - grade down	Road Widths (ft) Traffic Counters (counter ID)	AADT (count) Crash Locations ■ Fatal □ Injury □ Property Damage Only □ Unknown Crash Type	Mileage by Functional Class By Sheet 0255 7 - Rural - Major collector 7.740 Total Mileage: 7.740 mi	Mileage by Town By Sheet GREENSBORO - S02551009 7.74 of 7.74 Total Mileage: 7.74 mi	DISTRICT 9	TOWN GREENSBORO	Date: 11/14/13 1 of 1 TWN mileage: 0.0 to 7.74	ROUTE Maj-0255 ETE mileage: 2.18 to 9.92
---	--	---	---	---	---	---	----------------------	---------------------------	--	---

For More Information Contact - Vermont Agency of Transportation, Policy, Planning and Intermodal Development Division - Mapping Unit, 1 National Life Drive, Montpelier, VT 05633-5001 Telephone: 802-828-2600.