



# Route Log Progress Chart

**DRAFT**

Please Note: Errors and Omissions May Exist.  
Contact the VTrans Mapping Unit with questions or concerns.

DISTRICT	TOWN	ROUTE
7	CONCORD	Maj-0218

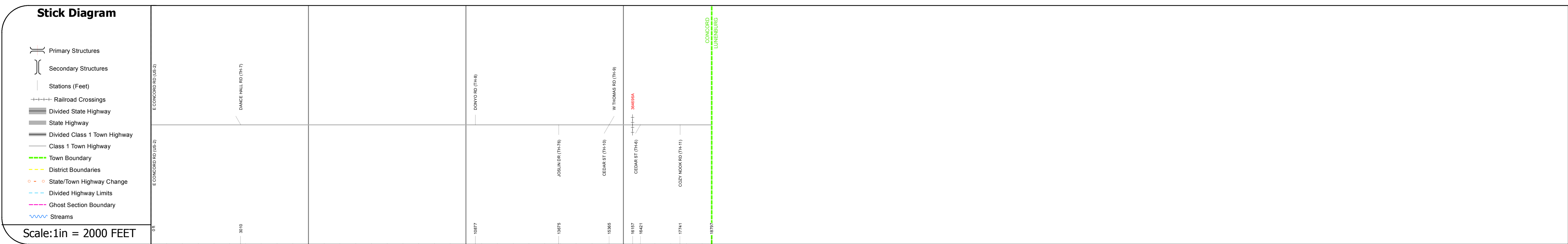
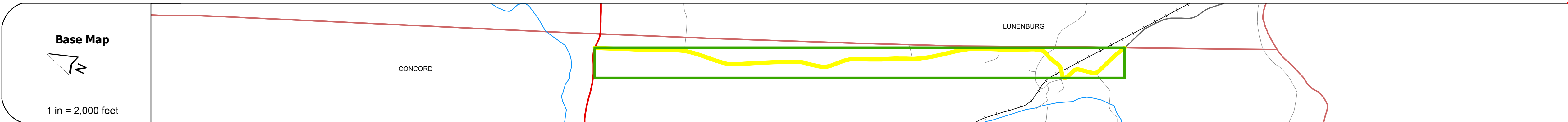
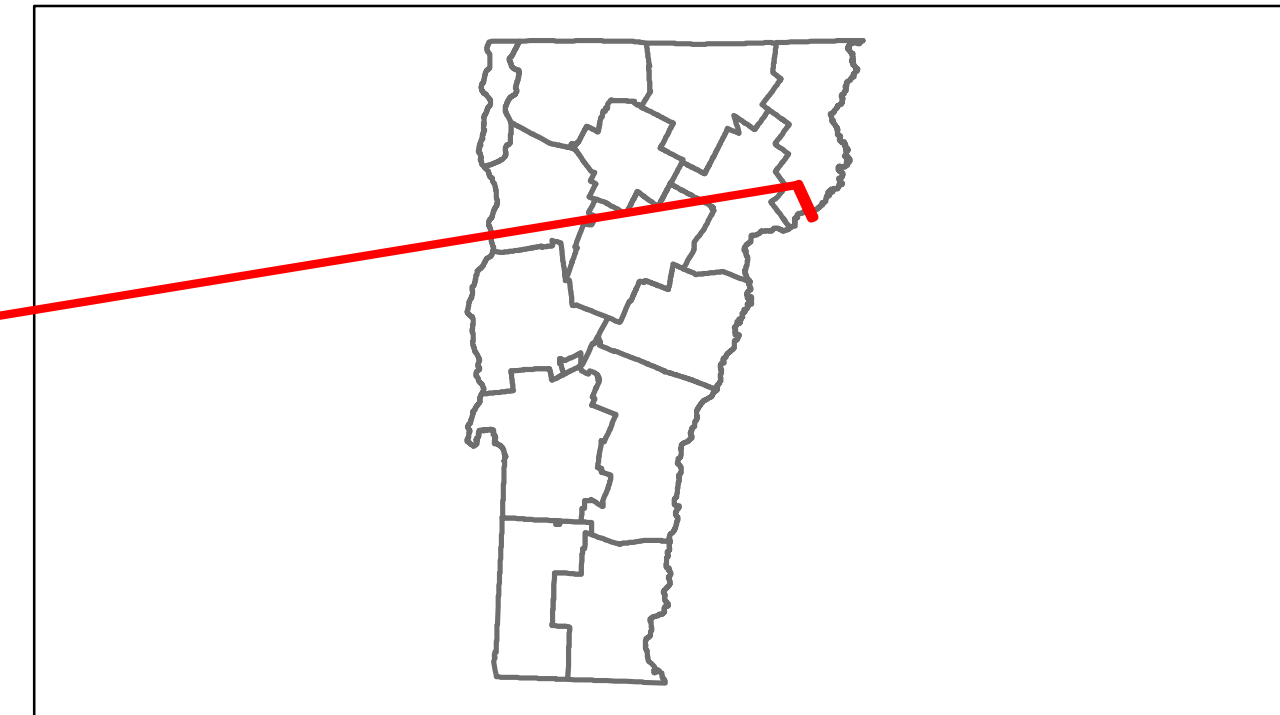

## DESCRIPTION BLOCK

<b>Road Widths</b>	Travellane	22
Roadway	26	
Lane Count		
Base		
Subbase		

<b>Curves</b>	
---------------	--

<b>Grades</b>	
---------------	--

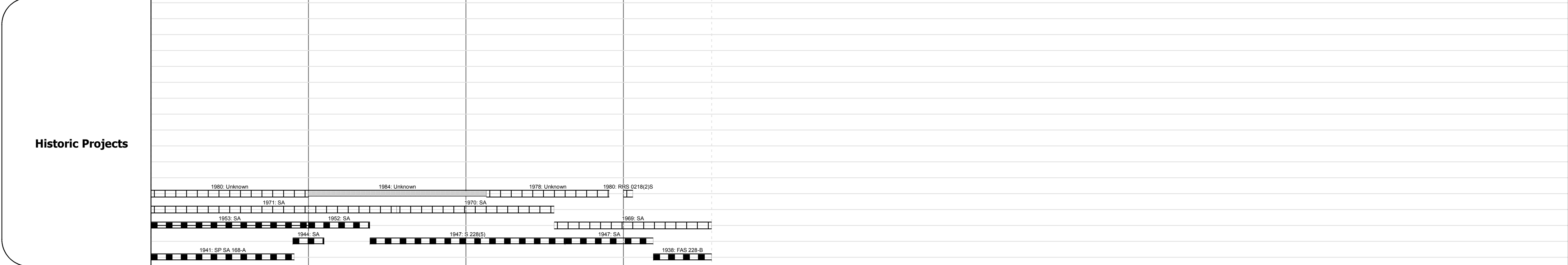

<b>Maintenance Garage</b>	(Not State Maintained)
---------------------------	------------------------

<b>Traffic Counters</b>	SEZ2AE, SEZ308, SEZ7BT, SEZ7BU
-------------------------	--------------------------------

<b>Functional Class</b>	7
-------------------------	---

<b>Speed Zone</b>	
-------------------	--

<b>AADT Counts</b>	2012: 460	360
2011: 460	360	
2010: 480	400	
2009: 510	440	
2008: 530	480	

<b>Crash Locations</b>	2012	
2011		
2010	□	
2009		
2008	■	■

<b>Historic Projects</b> Retirement, Resurface, Unknown, Bituminous Mix, Skippy Mix, Bituminous Seal, Gravel, Surface Treated Gravel, Plant Mix, Reclaimed Base and Bituminous Concrete, Concrete	<b>Functional Class</b> 1, 2, 3, 4, 5, 6, 7, 8, 9, 10, 11, 12, 13, 14, 15, 16, 17, 18, 19	<b>Curves</b> curve left, curve right	<b>Road Widths</b> (ft)	<b>AADT</b> (count)	<b>Mileage by Functional Class By Sheet</b> 0218 7 - Rural - Major collector 3.560	<b>Mileage by Town By Sheet</b> CONCORD - S02180507 3.56 of 3.56	<b>DISTRICT</b> 7	<b>TOWN</b> CONCORD	<b>Date:</b> 11/14/13	<b>ROUTE</b> Maj-0218 ETE mileage: 0.0 to 3.56
<b>Total Mileage: 3.560 mi</b>						<b>Total Mileage: 3.56 mi</b>				

For More Information Contact - Vermont Agency of Transportation, Policy, Planning and Intermodal Development Division - Mapping Unit, 1 National Life Drive, Montpelier, VT 05633-5001 Telephone: 802-828-2600.