



Route Log Progress Chart

DRAFT

Please Note: Errors and Omissions May Exist.
Contact the VTrans Mapping Unit with questions or concerns.

| | | |
|----------|-----------|----------|
| DISTRICT | TOWN | ROUTE |
| 5 | HINESBURG | Maj-0199 |

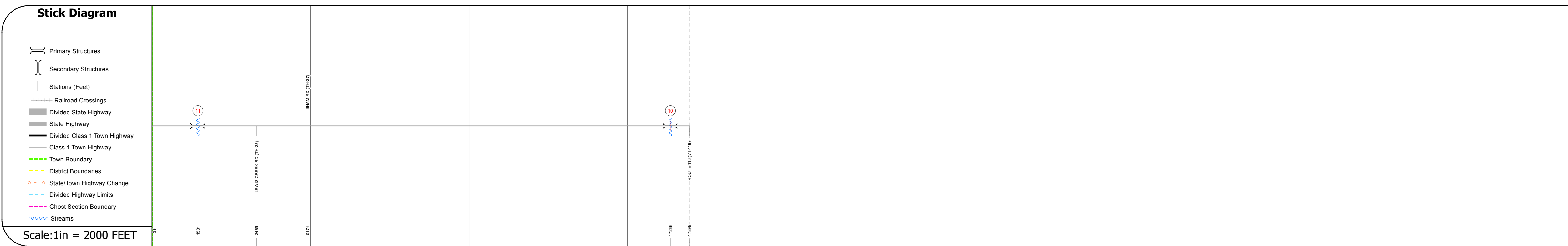
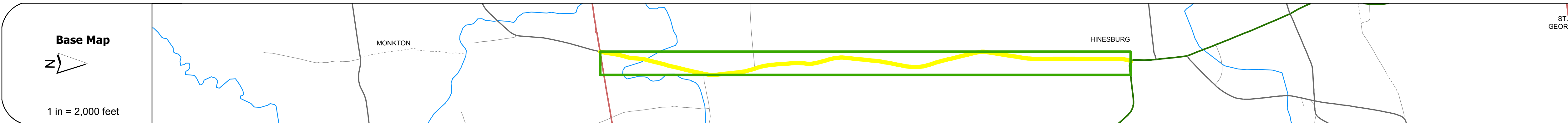
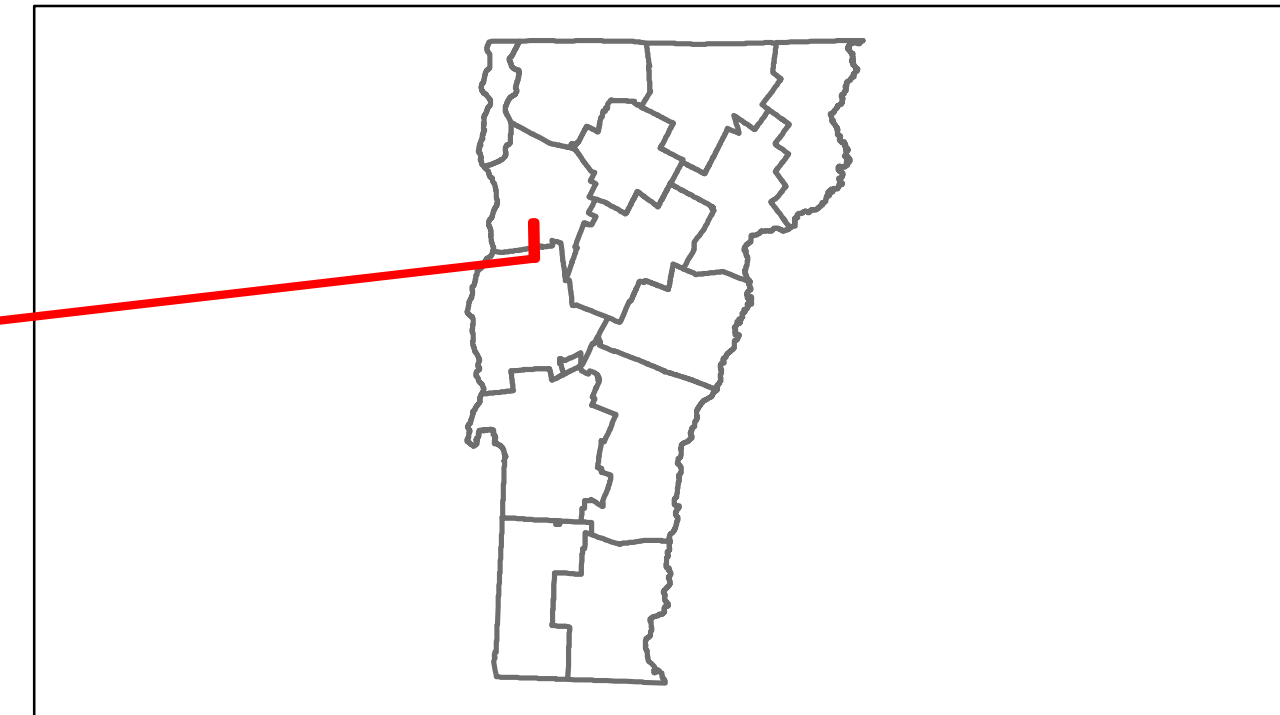

DESCRIPTION BLOCK

Bridge 11:
Stringer/multi-beam or girder - 1940
Structure No: 200199001104072
Length: 84'
Width: 30.0'
Facility Carried: TR 04 FAS 199
Bridge Type: ROLLED BEAM
Features Intersected: LEWIS CREEK
Maintenance/Ownership: Town

Bridge 10:
Stringer/multi-beam or girder - 2011
Structure No: 200199001004072
Length: 62'
Width: 29.0'
Facility Carried: TR 04 FAS 199
Bridge Type: ROLLED BEAM
Features Intersected: LAPLATTE RIVER
Surface: Bituminous
Maintenance/Ownership: Town

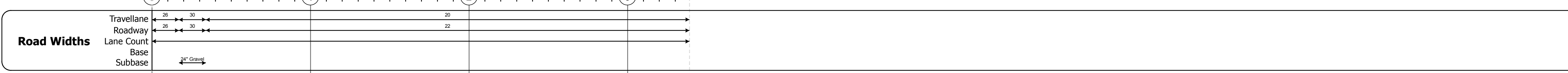

| Curves | |
|--------|--|
|--------|--|

| Grades | |
|--------|--|
|--------|--|

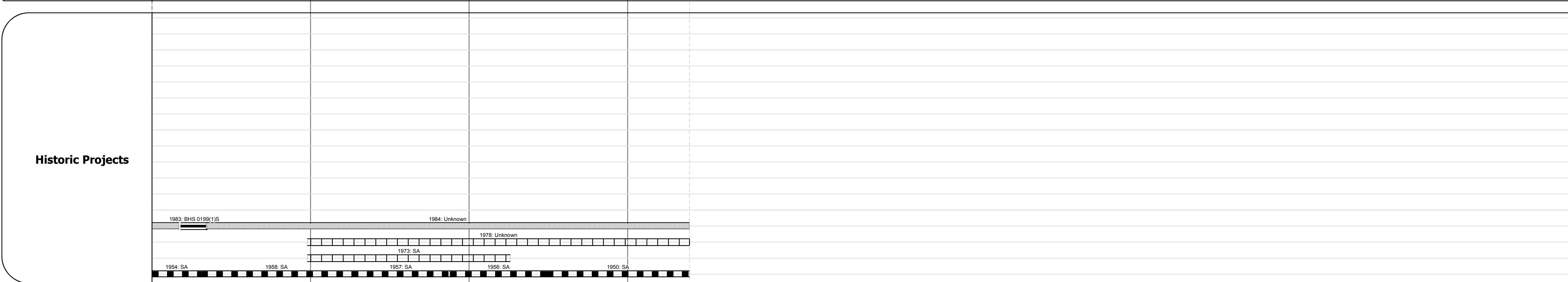

| Maintenance Garage | |
|--------------------|--|
|--------------------|--|

| Traffic Counters | 903911 |
|------------------|--------|
|------------------|--------|

| Functional Class | 7 |
|------------------|---|
|------------------|---|

| Speed Zone | |
|------------|--|
|------------|--|

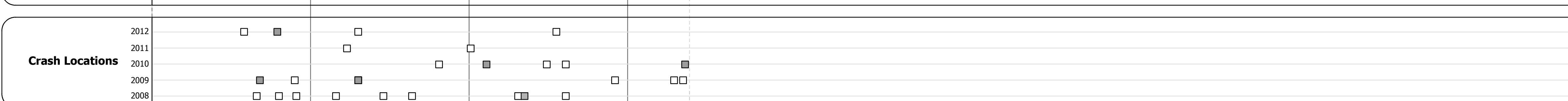
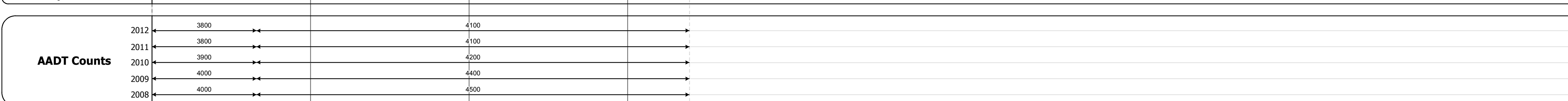

| | | | | | | | | | | |
|---|--|--|----------------------------|------------------------|---|---|---|--------------------------|-----------------------|---|
| Historic Projects Retirement, Resurface, Unknown, Bituminous Mix, Skippy Mix, Bituminous Seal, Bituminous Concrete, Concrete, Gravel, Surface Treated Gravel, Plant Mix, Reclaimed Base and Bituminous Concrete, Concrete | Functional Class 1, 2, 6, 7, 8, 11, 12, 14, 16, 17, 19 | Curves curve left, curve right | Road Widths (ft) | AADT (count) | Mileage by Functional Class By Sheet 0199 7 - Rural - Major collector 3.390 | Mileage by Town By Sheet HINESBURG - S01990407 3.39 of 3.39 | DISTRICT 5 | TOWN HINESBURG | Date: 11/14/13 | ROUTE Maj-0199 ETE mileage: 10.74 to 14.13 |
| | | | | | Total Mileage: 3.390 mi | Total Mileage: 3.39 mi | 1 of 1 TWN mileage: 0.0 to 3.39 | | | |