



Route Log Progress Chart

DRAFT

Please Note: Errors and Omissions May Exist.
Contact the VTrans Mapping Unit with questions or concerns.

DISTRICT	TOWN	ROUTE
4	STRAFFORD	Maj-0177

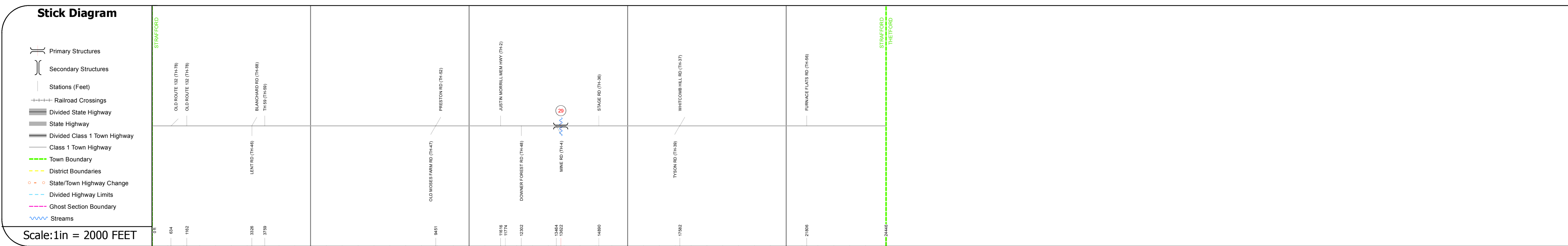
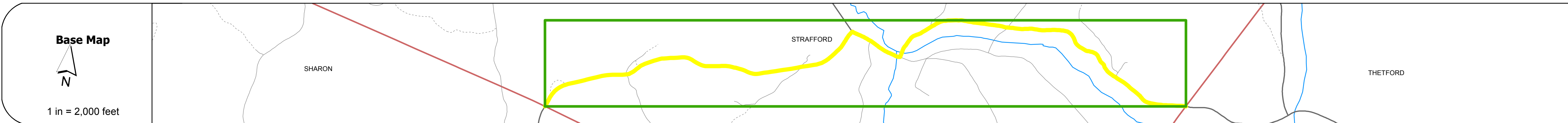
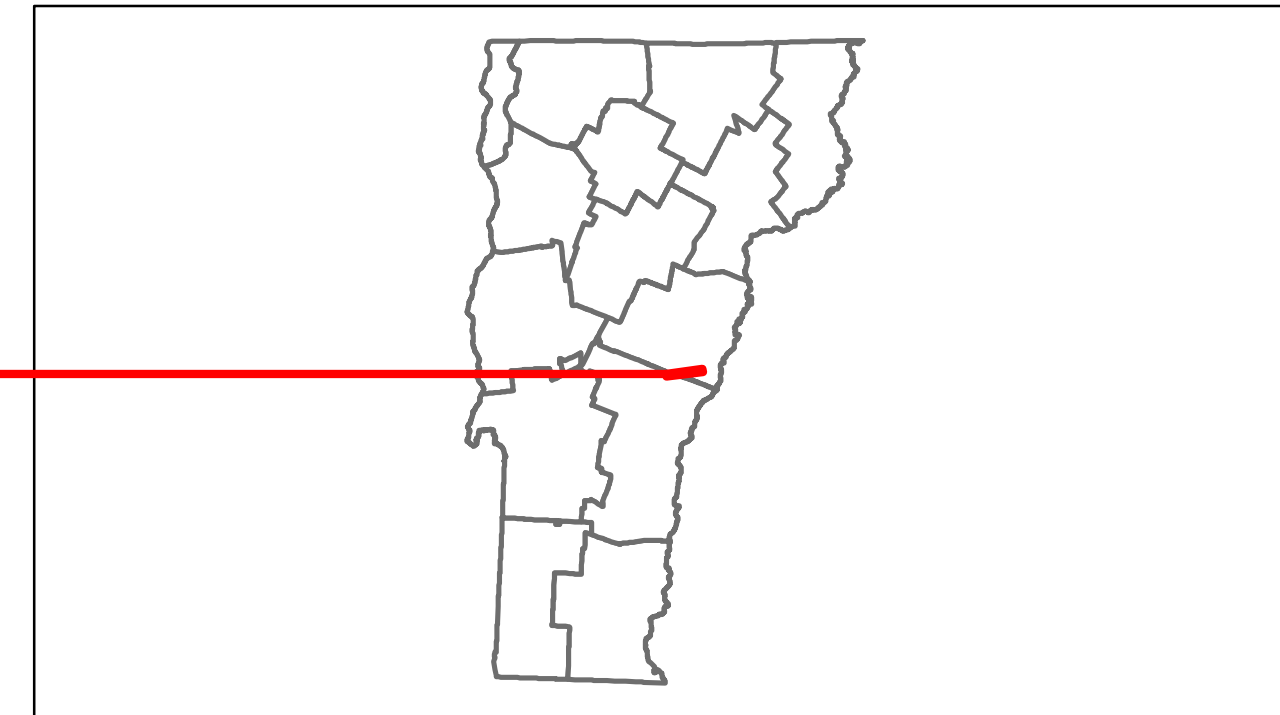

DESCRIPTION BLOCK

Bridge 29:
Tee Beam - 1923
Structure No. 200177002909102
Length: 52'
Width: 20.6'
Weight Limit: 0
Facility Carried: TR 01 FAS 177
Bridge Type: CONCRETE T-BEAM
Features Intersected: W BR. OMPOMPANOOSUC RIV.
Surface: Bituminous
Maintenance/Ownership: Town

Road Widths	Travellane	22
Roadway	30	
Lane Count	2	
Base	18" Gravel	
Subbase		

Curves	
---------------	--

Grades	
---------------	--

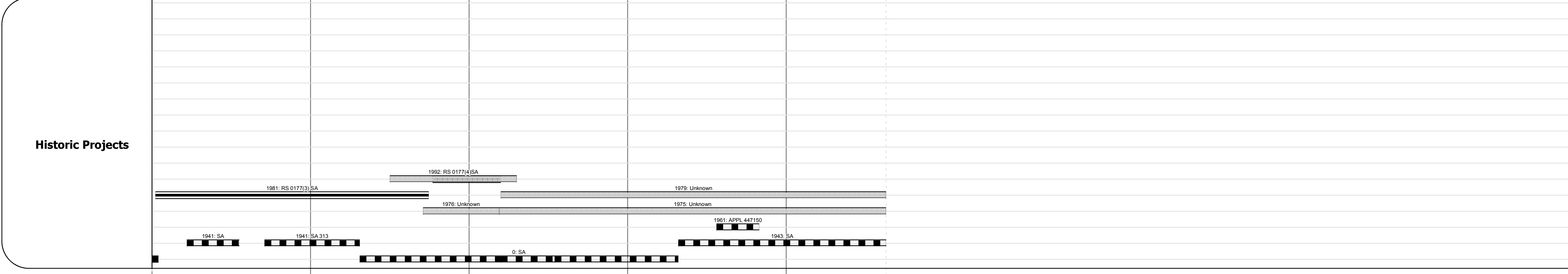

Maintenance Garage	
---------------------------	--

Traffic Counters	SEN381	SEN34E	SEN181
-------------------------	--------	--------	--------

Functional Class	7
-------------------------	---

Speed Zone	
-------------------	--

AADT Counts	2012	890	870
	2011	880	860
	2010	880	870
	2009	880	870
	2008	880	880

Crash Locations	2012	
	2011	
	2010	
	2009	
	2008	

Historic Projects Retreatment, Resurface, Unknown, Bituminous Mix, Skippy Mix, Bituminous Seal, Bituminous Concrete, Surface Treated Gravel, Plant Mix, Reclaimed Base and Bituminous Concrete, Concrete	Functional Class 1-19, 6-16 Speed Zones 25, 30, 35, 40, 45, 50, 55, 60, 65	Curves curve left, curve right Grades grade up, grade down	Road Widths (ft) Traffic Counters (counter ID)	AADT (count) Crash Locations Fatal, Injury, Property Damage Only, Unknown Crash Type	Mileage by Functional Class By Sheet 0177 7 - Rural - Major collector 4.630 Total Mileage: 4.630 mi	Mileage by Town By Sheet STRAFFORD - S01770910 4.63 of 4.63 Total Mileage: 4.63 mi	DISTRICT 4	TOWN STRAFFORD	Date: 11/14/13 1 of 1 TWN mileage: 0.0 to 4.63	ROUTE Maj-0177 ETE mileage: 9.09 to 13.72
--	---	---	---	---	---	--	----------------------	--------------------------	--	--