



Route Log Progress Chart

DRAFT

Please Note: Errors and Omissions May Exist.
Contact the VTrans Mapping Unit with questions or concerns.

DISTRICT	TOWN	ROUTE
3	PITTSFORD	Maj-0165

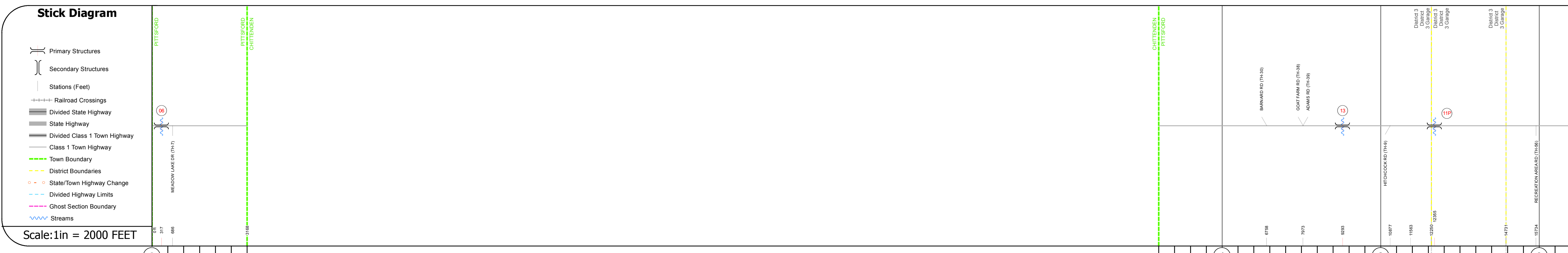
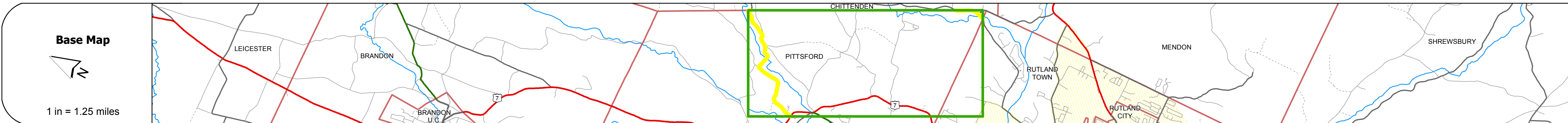
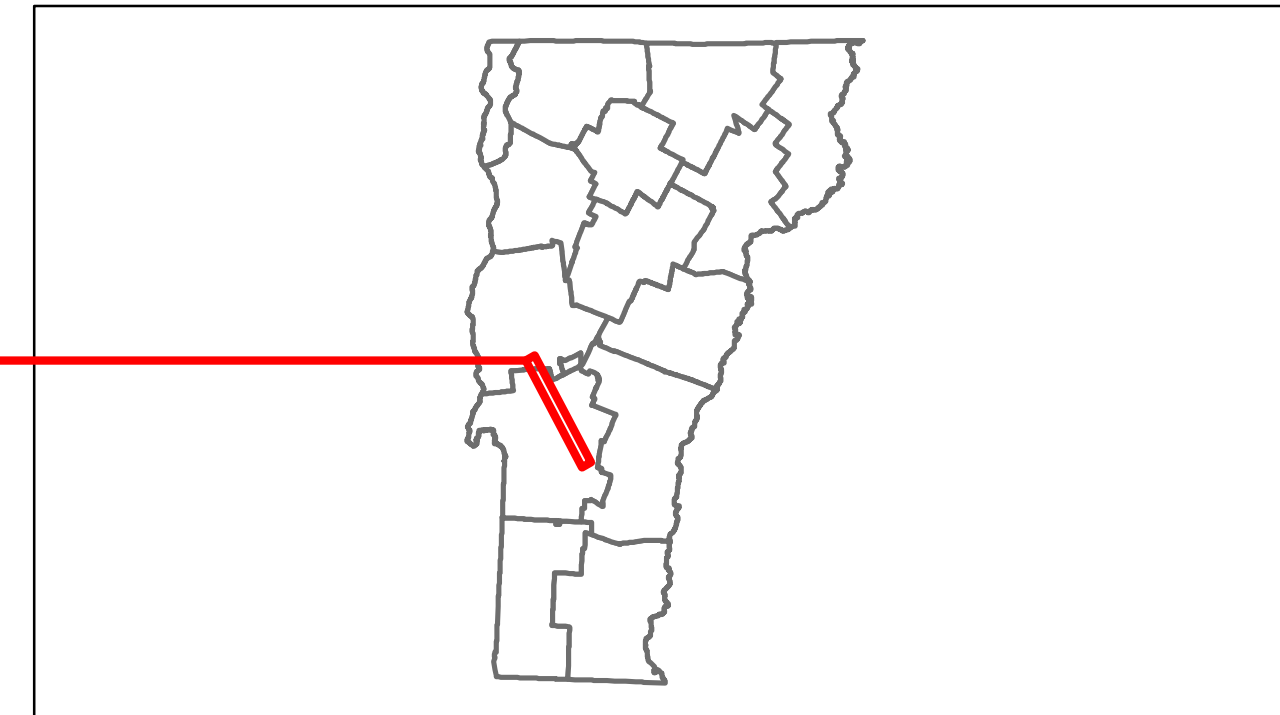

Road Widths	Travellane	Roadway	Lane Count	Base	Subbase
	20	22			

Curves	Grades

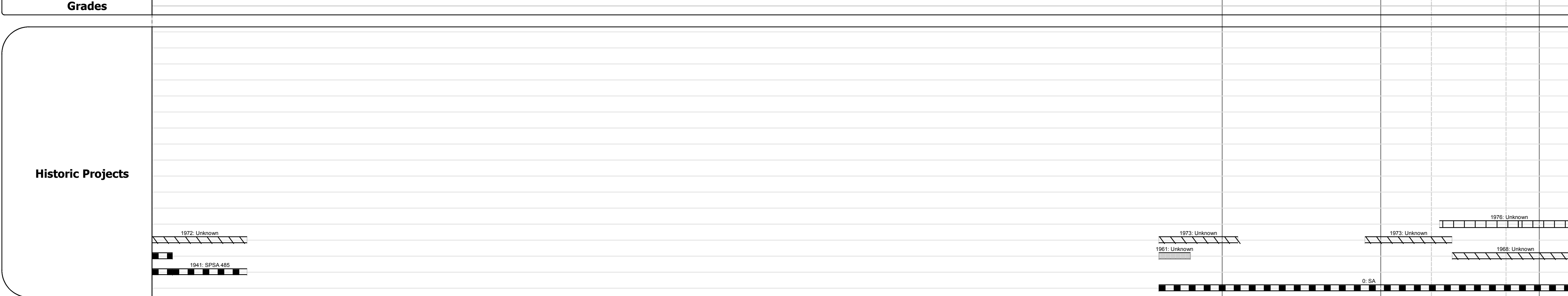

Maintenance Garage
(Not State Maintained)

Traffic Counters
566027, 566341, 566340

Functional Class
7

Speed Zone

AADT Counts	2012	2011	2010	2009	2008
	1500 ← 2500 →	1500 ← 2500 →	1500 ← 2500 →	1500 ← 2500 →	1500 ← 2500 →

Crash Locations	2012	2011	2010	2009	2008

DESCRIPTION BLOCK

Culvert 6:
Culvert - 1948
Structure No. 200165000611162
Length: 21'
Weight Limit: 0
Facility Carried: TR 04 FAS 165
Bridge Type: REINFORCED CONC BOX
Features Intersected: EAST CREEK
Maintenance/Ownership: Town

Bridge 13:
Stringer/multi-beam or girder - 1947
Structure No. 200165001311162
Length: 75'
Width: 24.7'
Weight Limit: 0
Facility Carried: TR 03 FAS 165
Bridge Type: ROLLED BEAM
Features Intersected: FURNACE BROOK
Surface: Bituminous
Maintenance/Ownership: Town

Bridge 11P:
Stringer/multi-beam or girder - 1947
Structure No. 200165011P11162
Length: 49'
Width: 20.8'
Weight Limit: 0
Facility Carried: TR 03 FAS 165
Bridge Type: ROLLED BEAM
Features Intersected: LITTLE BROOK
Surface: Bituminous
Maintenance/Ownership: Town

Historic Projects	Functional Class	Curves	Road Widths	AADT	Mileage by Functional Class By Sheet	Mileage by Town By Sheet	DISTRICT	TOWN	Date: 11/14/13	ROUTE
Retreatment, Resurface, Unknown, Bituminous Mix, Skippy Mix, Bituminous Seal, Bituminous Concrete, Surface Treated Gravel, Plant Mix, Reclaimed Base and Bituminous Concrete, Concrete	1-19, Speed Zones 25-65	grade up, grade down	(ft), Traffic Counters (counter ID)	Fatal, Injury, Property Damage Only, Unknown Crash Type	0165 7 - Rural - Major collector 9.000	PITTSFORD - S01651116 9.0 of 9.15	3	PITTSFORD	1 of 2 TWN mileage: 0.0 to 9.0	Maj-0165 ETE mileage: 2.19 to 11.34
					Total Mileage: 9.000 mi	Total Mileage: 9.0 mi				

For More Information Contact - Vermont Agency of Transportation, Policy, Planning and Intermodal Development Division - Mapping Unit, 1 National Life Drive, Montpelier, VT 05633-5001 Telephone: 802-828-2600.