



Route Log Progress Chart

DRAFT

Please Note: Errors and Omissions May Exist.
Contact the VTrans Mapping Unit with questions or concerns.

DISTRICT	TOWN	ROUTE
3	ORWELL	Maj-0156

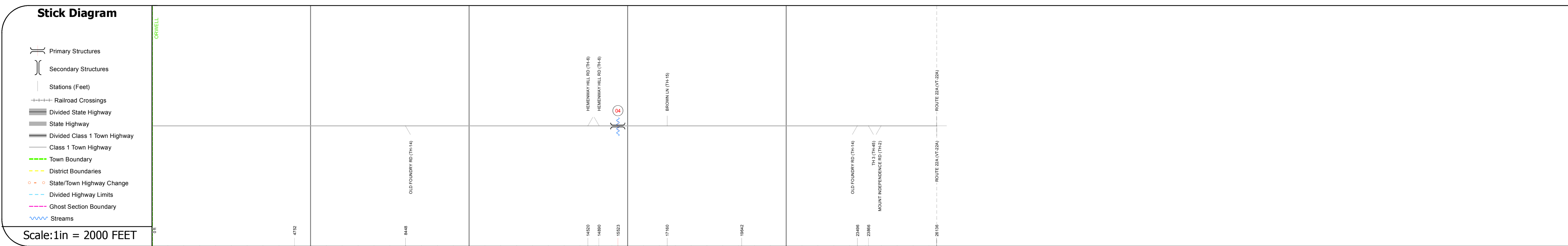
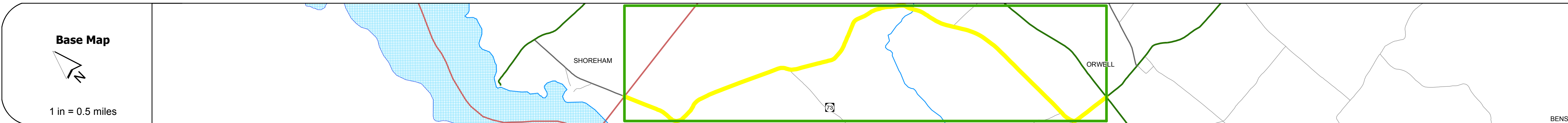
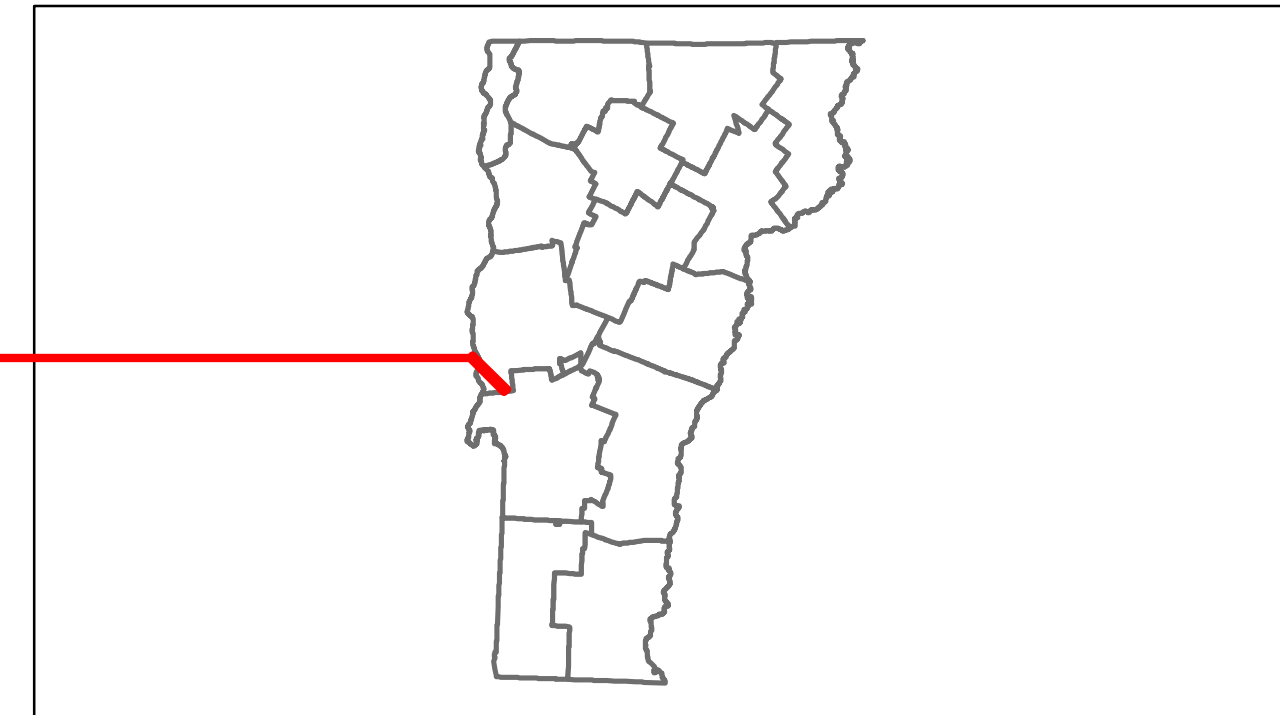

DESCRIPTION BLOCK

Bridge 4:
Stringer/multi-beam or girder - 1946
Structure No. 200156000401142
Length: 74'
Width: 20.8'
Weight Limit: 0
Facility Carried: TR 03 FAS 156
Bridge Type: ROLLED BEAM
Features Intersected: NORTH FORK CREEK
Surface: Bituminous
Maintenance/Ownership: Town

Road Widths	Travellane	20
	Roadway	22
	Lane Count	
	Base	
	Subbase	

Curves	
---------------	--

Grades	
---------------	--

Historic Projects	<p>1880 Unknown</p> <p>0 SA</p> <p>Unknown</p>
--------------------------	--

Maintenance Garage	(Not State Maintained)
---------------------------	------------------------

Traffic Counters	58A378
-------------------------	--------

Functional Class	7
-------------------------	---

Speed Zone	
-------------------	--

AADT Counts	2012	320	460	820
	2011	320	460	810
	2010	320	450	800
	2009	310	450	790
	2008	310	440	770

Crash Locations	2012	
	2011	
	2010	
	2009	
	2008	

Historic Projects Retreatment, Resurface, Unknown, Bituminous Mix, Skirny Mix, Bituminous Seal, Gravel, Surface Treated Gravel, Plant Mix, Reclaimed Base and Bituminous Concrete, Concrete	Functional Class 1, 2, 3, 4, 5, 6, 7, 8, 9, 10, 11, 12, 13, 14, 15, 16, 17, 18, 19	Curves curve left, curve right	Road Widths (ft)	Traffic Counters (counter ID)	AADT (count)	Crash Locations Fatal, Injury, Property Damage Only, Unknown Crash Type	Mileage by Functional Class By Sheet 0156 7 - Rural - Major collector 4.950	Mileage by Town By Sheet ORWELL - S01560114 4.95 of 4.95	DISTRICT 3	TOWN ORWELL	Date: 11/14/13	ROUTE Maj-0156 ETE mileage: 0.9 to 5.85
						Total Mileage: 4.950 mi		Total Mileage: 4.95 mi		1 of 1 TWN mileage: 0.0 to 4.95		