



# Route Log Progress Chart

**DRAFT**

Please Note: Errors and Omissions May Exist.  
Contact the VTrans Mapping Unit with questions or concerns.

DISTRICT	TOWN	ROUTE
2	GRAFTON	Maj-0125

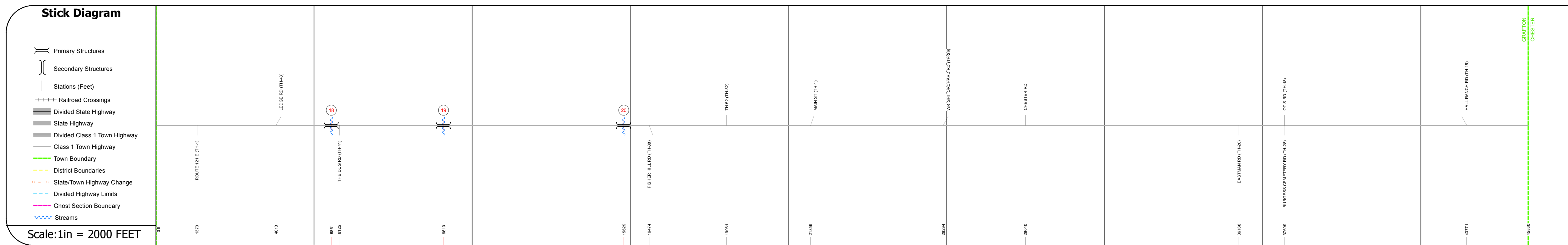
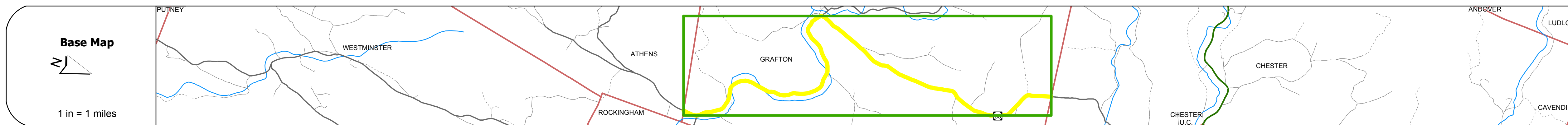
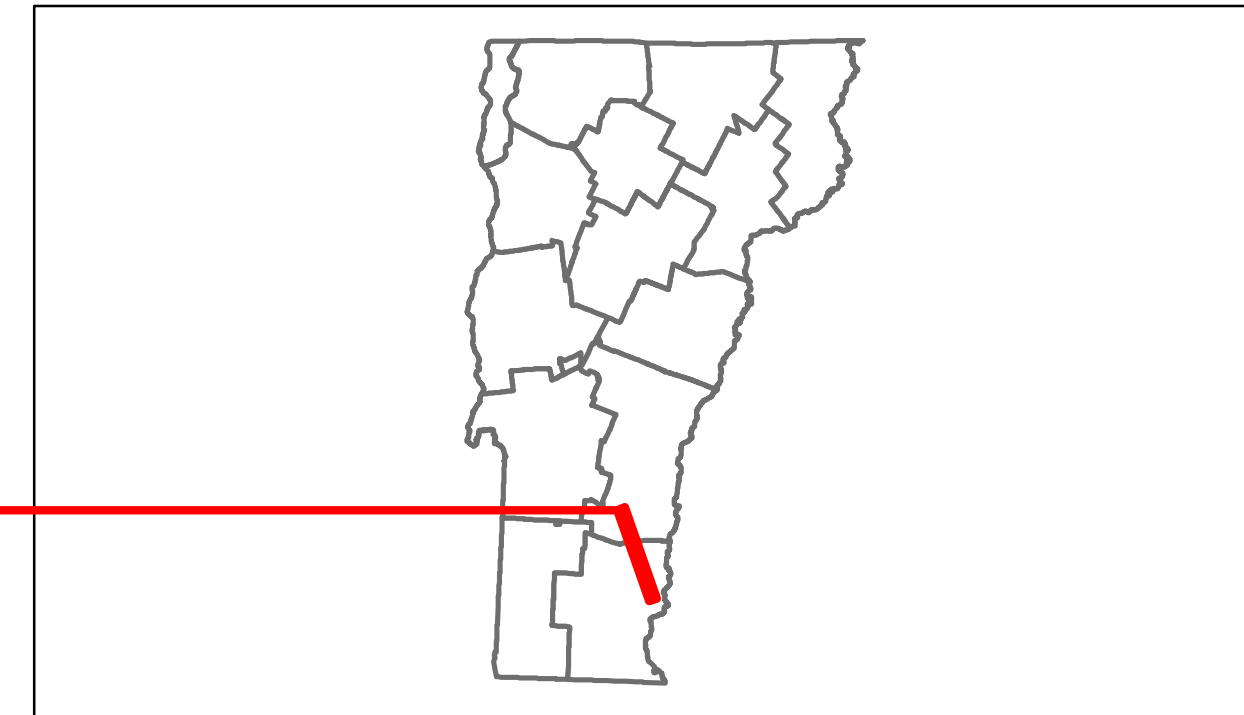

## DESCRIPTION BLOCK

**Bridge 18:**  
Stringer/multi-beam or girder - 1997  
Structure No. 200125001813062  
Length: 125'  
Width: 26.8'  
Facility Carried: TR 01 FAS 125  
Bridge Type: WELDED CURVED GIRDER  
Features Intersected: SAXTONS RIVER  
Surface: Bituminous  
Maintenance/Ownership: Town

**Bridge 19:**  
Stringer/multi-beam or girder - 1939  
Structure No. 200125001913062  
Length: 166'  
Width: 24.2'  
Facility Carried: TR 01 FAS 125  
Bridge Type: 2 SPN CONT ROLLED BM  
Features Intersected: SAXTONS RIVER  
Surface: Bituminous  
Maintenance/Ownership: Town

**Bridge 20:**  
Stringer/multi-beam or girder - 1937  
Structure No. 200125002013062  
Length: 191'  
Width: 30.0'  
Facility Carried: TR 01 FAS 125  
Bridge Type: 3 SPAN ROLLED BEAM  
Features Intersected: SAXTONS RIVER  
Surface: Bituminous  
Maintenance/Ownership: Town

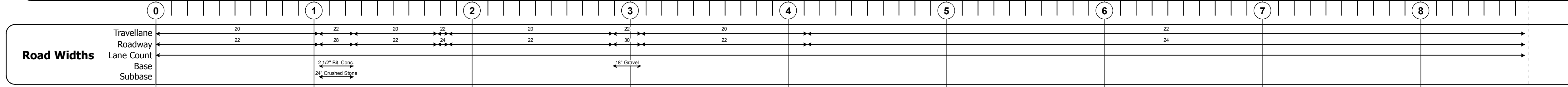

Curves	
Grades	

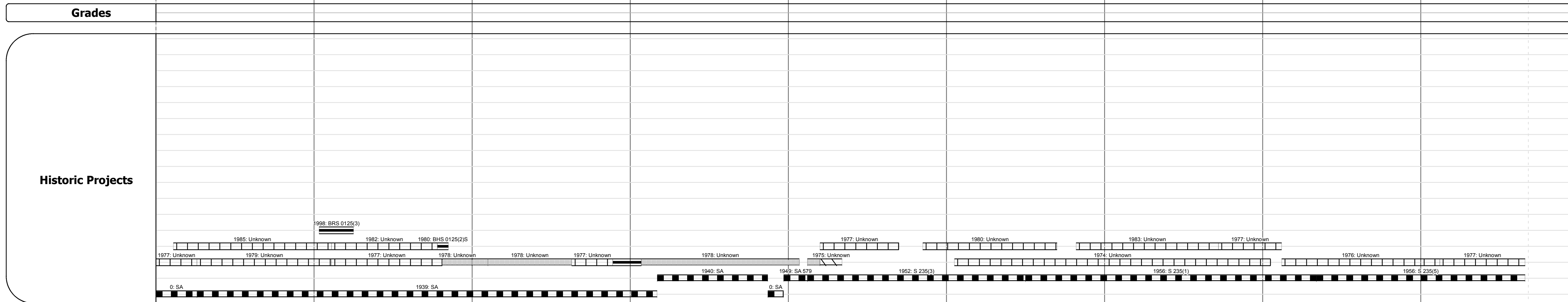

Maintenance Garage	
--------------------	--

Traffic Counters	86307	86308
------------------	-------	-------

Functional Class	7
------------------	---

Speed Zone	
------------	--

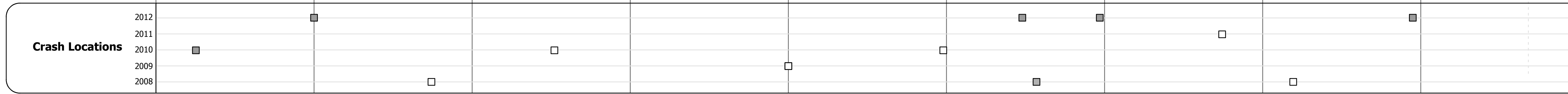
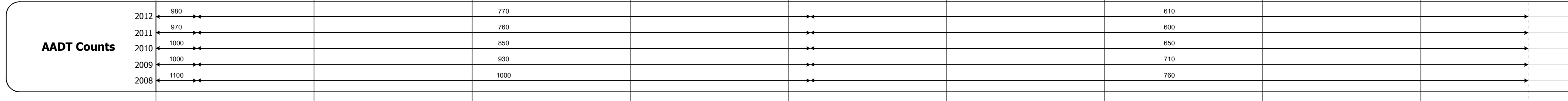

<b>Historic Projects</b> Retreatment, Resurface, Unknown, Bituminous Mix, Skippy Mix, Bituminous Seal, Bituminous Concrete, Surface Treated Gravel, Plant Mix, Reclaimed Base and Bituminous Concrete, Concrete	<b>Functional Class</b> 1, 2, 3, 4, 5, 6, 7, 8, 9, 10, 11, 12, 13, 14, 15, 16, 17, 18, 19	<b>Curves</b> curve left, curve right	<b>Road Widths</b> (ft)	<b>Traffic Counters</b> (counter ID)	<b>AADT</b> (count)	<b>Crash Locations</b> Fatal, Injury, Property Damage Only, Unknown Crash Type	<b>Mileage by Functional Class By Sheet</b> 0125 7 - Rural - Major collector 8.660	<b>Mileage by Town By Sheet</b> GRAFTON - S01251306 8.68 of 8.68	<b>DISTRICT</b> 2	<b>TOWN</b> GRAFTON	<b>Date:</b> 11/14/13	<b>ROUTE</b> Maj-0125 ETE mileage: 9.93 to 18.61
							<b>Total Mileage:</b> 8.680 mi	<b>Total Mileage:</b> 8.68 mi	<b>1 of 1</b> TWN mileage: 0.0 to 8.68			

For More Information Contact - Vermont Agency of Transportation, Policy, Planning and Intermodal Development Division - Mapping Unit, 1 National Life Drive, Montpelier, VT 05633-5001 Telephone: 802-828-2600.