



Route Log and Progress Chart

DRAFT

Please Note: Errors and Omissions May Exist.
Contact the VTrans Mapping Section with questions or concerns.

DISTRICT	TOWN	ROUTE
4	TUNBRIDGE	VT-110

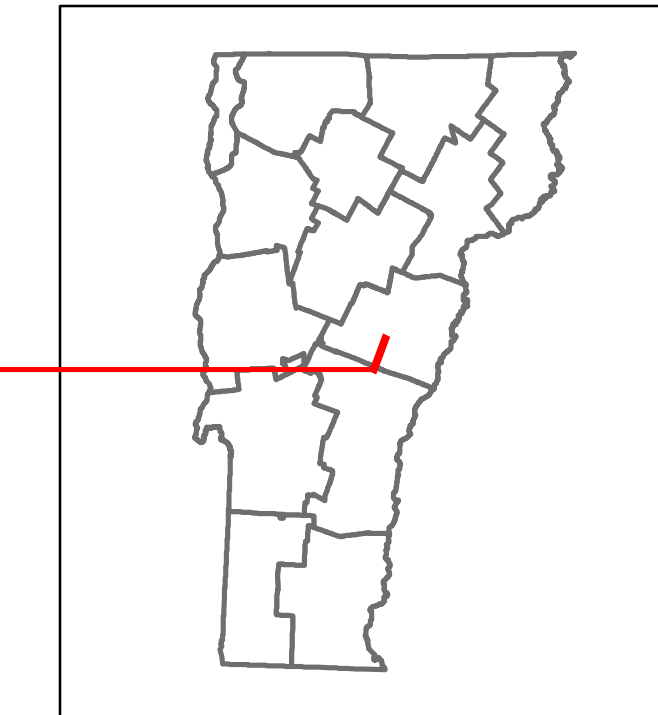

Base Map

1 in = 2,000 feet

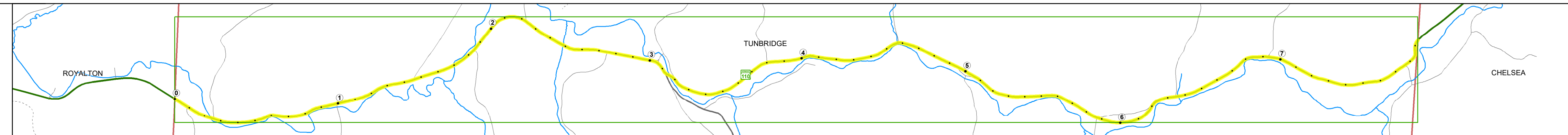

Stick Diagram

- Town Center
- Intersecting State Routes (excl. ramps/approaches)
- Other Intersecting Highways, Ramps, Approaches
- Railroad Crossings
- Primary Structures
- Secondary Structures
- Divided State Highway
- State Highway
- Divided Town Highway
- Town Highway
- Streams (Hydraulic Structure)
- Town Boundary
- District Boundaries
- State/Town Highway Change
- Divided Highway Limits
- Ghost Section Boundary
- Federal Urban Area Limits

Scale: 1 INCH = 2,000 FEET

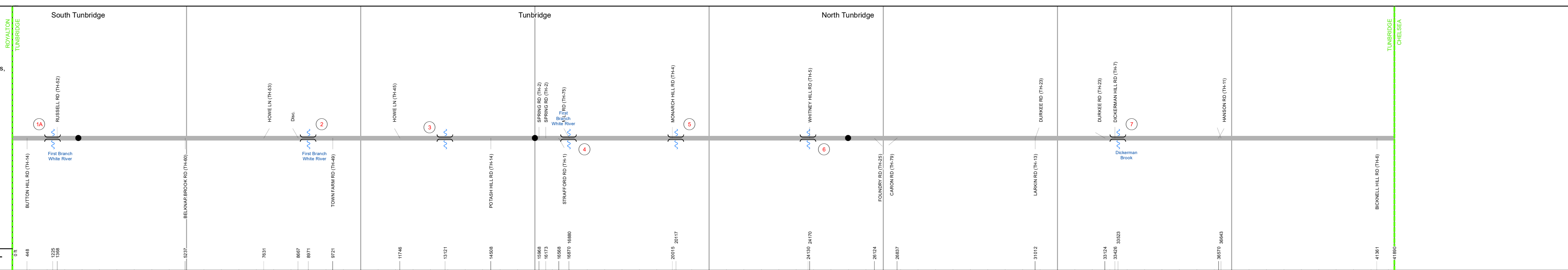

Road Widths

Travellane
Roadway
Lane Count
Base
Subbase

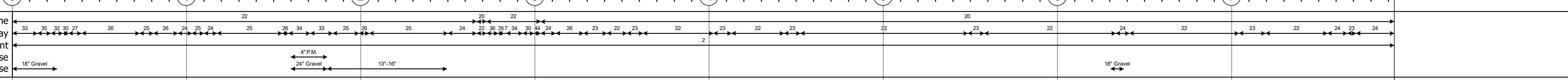

Curves

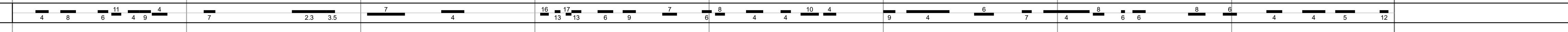

Grades

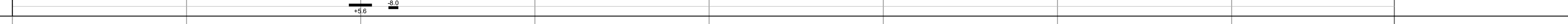

Guardrails

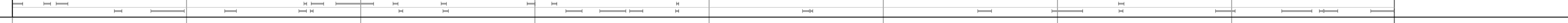

Rumblestrips

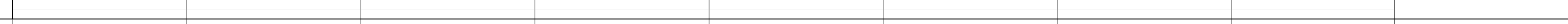

Speed Zone

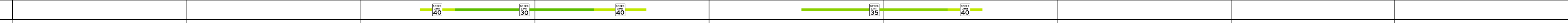

Curves: Head-on, FTC6



Curves: Overturn, FTC7



Curves: Run-off Road, FTC8

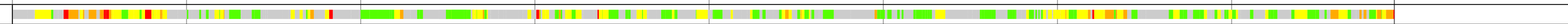

Curves: Fixed Object, FTC9



Curves: Night Run-off Road, FTC10



Interstate: Overturn, FTC11



Tangents: Head-on, FTC12



Tangents: Overturn, FTC13



Tangents: Run-off Road, FTC14



Risk

- Primary Risk
- High Risk
- Medium Risk
- Low Risk
- Minimal Risk
- Not a Focus Facility

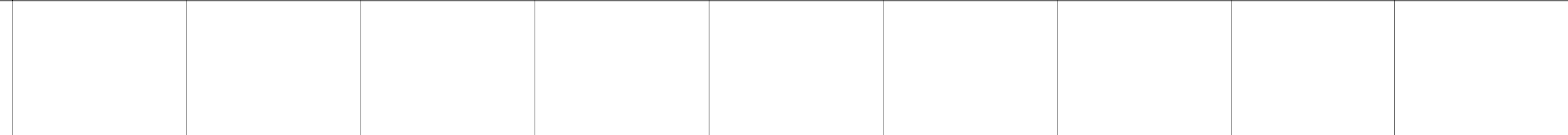

AAADT

2022	1972	4320	1275	1399
2021	2387	4164	1265	1434
2020	2107	1752	1398	4164
2019	2488	2069	1650	4916
2018	2500	3200	2000	1700

STRUCTURE DESCRIPTIONS

Bridge 1A:
Stringer/multi-beam or girder - 1932
Structure No. 200169001A09132
Length: 148'
Height: 100.0'
Width: 33.0'
Weight Limit: 0
Facility Carried: VT 00110 ML
Structure Type: 2 SPAN ROLLED BEAM
Features Intersected: 1ST BRANCH WHITE R.
Surface: Bituminous
Inspection Date: 7/2021
Maintenance/Ownership: State

Bridge 2:
Stringer/multi-beam or girder - 1987
Structure No. 200169000209132
Length: 123'
Height: 100.0'
Width: 33.0'
Weight Limit: 0
Facility Carried: VT 00110 ML
Structure Type: WELDED PLATE GIRDER
Features Intersected: 1ST BRANCH WHITE R.
Surface: Bituminous
Inspection Date: 7/2021
Maintenance/Ownership: State

Bridge 3:
Culvert - 1958
Structure No. 300169000309131
Length: 11'
Under Clearance: 7.0'
Weight Limit: 0
Facility Carried: VT110
Structure Type: CGMPPA
Features Intersected: BROOK
Inspection Date: 11/2018
Maintenance: State

Bridge 4:
Stringer/multi-beam or girder - 2007
Structure No. 200169000409132
Length: 184'
Height: 100.0'
Width: 27.0'
Weight Limit: 0
Facility Carried: VT 00110 ML
Structure Type: 2 SP CNT WLD GIRDER
Features Intersected: 1ST BRANCH WHITE R.
Surface: Bituminous
Inspection Date: 7/2021
Maintenance/Ownership: State

Bridge 5:
Culvert - 1922
Structure No. 300169000509131
Length: 9'
Under Clearance: 1.0'
Weight Limit: 0
Facility Carried: VT110
Structure Type: RC BOX
Features Intersected: BROOK
Inspection Date: 11/2018
Maintenance: State

Bridge 6:
Slab - 1932
Structure No. 300169000609131
Length: 18'
Width: 26.0'
Under Clearance: 6.0'
Weight Limit: 0
Facility Carried: VT110
Structure Type: CONCRETE SLAB
Features Intersected: BROOK
Surface: Bituminous
Inspection Date: 11/2018
Maintenance: State

Bridge 7:
Slab - 1978
Structure No. 300169000709131
Length: 19'
Width: 34.0'
Under Clearance: 10.0'
Weight Limit: 0
Facility Carried: VT110
Structure Type: CONCRETE SLAB
Features Intersected: DICKERMAN BROOK
Surface: Bituminous
Inspection Date: 11/2018
Maintenance: State

Historic Projects

- Unknown
- Retreatment
- Resurface
- Bituminous Mix
- Skinny Mix
- Bituminous Seal

Functional Class

- 1 - Interstate
- 2 - Other Freeways and Expressways
- 3 - Principal Arterial
- 4 - Minor Arterial
- 5 - Major Collector
- 6 - Minor Collector

Speed Zones

- 25
- 30
- 35
- 40
- 45
- 50
- 55
- 60
- 65

Curves

- Left (degrees)
- Right (degrees)

Grades

- grade up (percent)
- grade down (percent)

Road Widths

(ft)

Traffic Counters

- Continuous (CTC)
- Weigh-In-Motion (WIM)
- Short-Term, Scheduled
- Short-Term, Unscheduled

AAADT

(AADT)

Crash Locations

- Fatal
- Injury
- Property Damage Only
- Unknown Crash Type

High Crash Locations (HCL's)

Sections (& Intersections)

- 1 - 100 (1 - 10)
- 101 - 200 (11 - 20)
- 201 - 300 (21 - 30)
- 301 - 400 (31 - 40)
- 401 - 800 (41 - 113)

Mileage by Functional Class By Sheet

0169	5 - Major Collector	7.934
------	---------------------	-------

Page Total Mileage: 7.934 mi

Mileage by Town By Sheet

TUNBRIDGE - v110-0913	7.934 of 7.934
-----------------------	----------------

Page Total Mileage: 7.934 mi

DISTRICT	TOWN	Date: 04/10/24	ROUTE
4	TUNBRIDGE	1 of 1 TWN mileage: 0.0 to 7.934	VT-110 ETE mileage: 2.32 to 10.254