



# Route Log and Progress Chart

**DRAFT**

Please Note: Errors and Omissions May Exist.  
Contact the VTrans Mapping Section with questions or concerns.

DISTRICT	TOWN	ROUTE
3	WELLS	VT-31

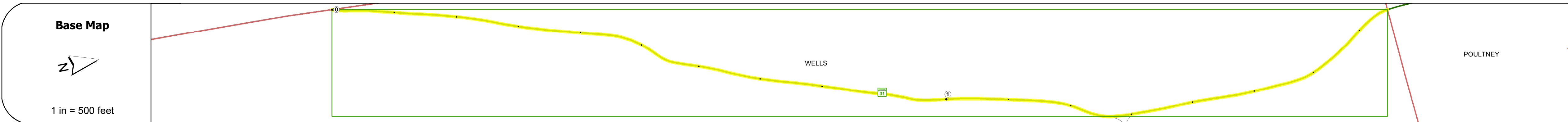
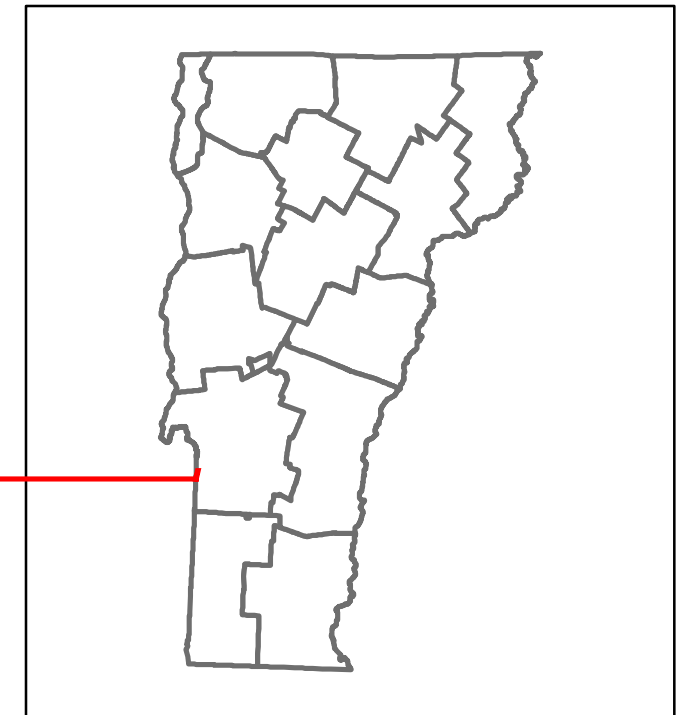

## STRUCTURE DESCRIPTIONS

<b>Road Widths</b>	Travellane: 22, 22, 22, 24, 22 Roadway: 22, 22, 22, 24, 22 Lane Count: 2 Base Subbase
<b>Curves</b>	17, 9, 15, 5, 7, 4, 9, 8, 0
<b>Grades</b>	+6.0, -6.0, -2.0, +10.0
<b>Guardrails</b>	
<b>Rumblestrips</b>	
<b>Speed Zone</b>	45
<b>Curves: Head-on, FTC6</b>	
<b>Curves: Overturn, FTC7</b>	
<b>Curves: Run-off Road, FTC8</b>	
<b>Curves: Fixed Object, FTC9</b>	
<b>Curves: Night Run-off Road, FTC10</b>	
<b>Interstate: Overturn, FTC11</b>	
<b>Tangents: Head-on, FTC12</b>	
<b>Tangents: Overturn, FTC13</b>	
<b>Tangents: Run-off Road, FTC14</b>	

<b>Risk</b>	Primary Risk (Black) High Risk (Red) Medium Risk (Orange) Low Risk (Yellow) Minimal Risk (Green) Not a Focus Facility (Grey)
<b>AAADT</b>	2022: 1603 2021: 838 2020: 739 2019: 872 2018: 870

<b>Historic Projects</b> Unknown, Retreatment, Resurface, Bituminous Mix, Skiny Mix, Bituminous Seal, Surface Treated Gravel, Plant Mix, Reclaimed Base and Bituminous Concrete, Concrete, Gravel	<b>Functional Class</b> 1 - Interstate System, 2 - Other Freeways and Expressways, 3 - Principal Arterial, 4 - Minor Arterial, 5 - Major Collector, 6 - Minor Collector	<b>Curves</b> Left (degrees), Right (degrees), Grades (percent) grade up, (percent) grade down	<b>Traffic Counters</b> Continuous (CTC), Weigh-In-Motion (WIM), Short-Term, Scheduled, Short-Term, Unscheduled	<b>Crash Locations</b> Fatal, Injury, Property Damage Only, Unknown Crash Type, High Crash Locations (HCL's)	<b>Mileage by Functional Class By Sheet</b> 0145 5 - Major Collector 1.756	<b>Mileage by Town By Sheet</b> WELLS - v031-1126 1.756 of 1.756	<b>DISTRICT</b> 3	<b>TOWN</b> WELLS	<b>Date:</b> 04/03/24	<b>ROUTE</b> VT-31
					<b>Page Total Mileage:</b> 1.756 mi	<b>Page Total Mileage:</b> 1.756 mi	<b>1 of 1</b> TWN mileage: 0.0 to 1.756	ETE mileage: 0.0 to 1.756		

For More Information Contact - Vermont Agency of Transportation, Policy, Planning and Intermodal Development Division - Mapping Section, 219 North Main Street, Barre, VT 05641 Telephone: 802-828-2600.