



# Route Log and Progress Chart

**DRAFT**

Please Note: Errors and Omissions May Exist.  
Contact the VTrans Mapping Section with questions or concerns.

DISTRICT	TOWN	ROUTE
1	WOODFORD	VT-9

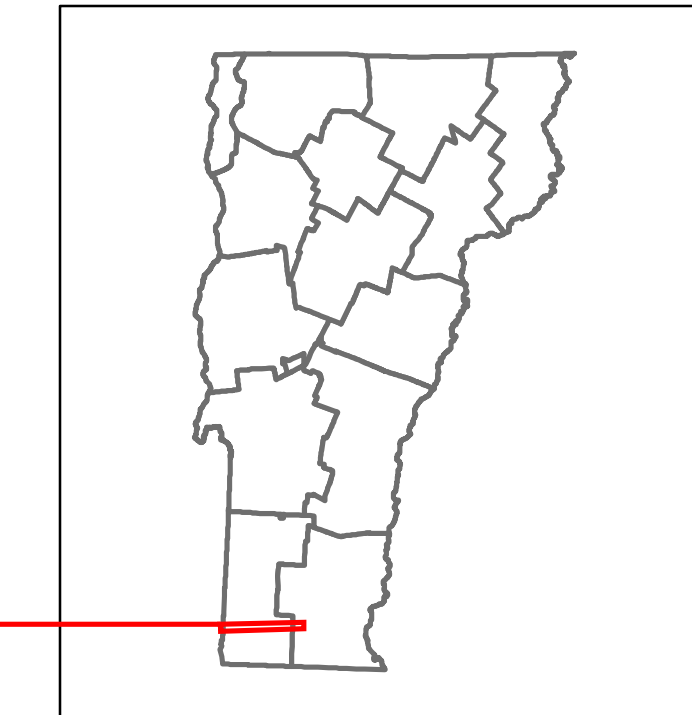

**Base Map**

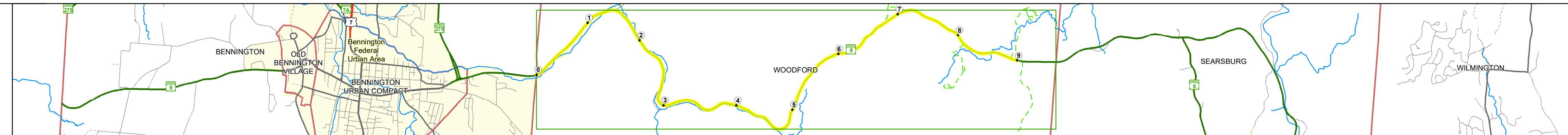

**Stick Diagram**

- Town Center
- Intersecting State Routes (excl. ramps/approaches)
- Other Intersecting Highways, Ramps, Approaches
- Railroad Crossings
- Primary Structures
- Secondary Structures
- Divided State Highway
- State Highway
- Divided Town Highway
- Town Highway
- Streams (Hydraulic Structure)
- Town Boundary
- District Boundaries
- State/Town Highway Change
- Divided Highway Limits
- Ghost Section Boundary
- Federal Urban Area Limits

Scale: 1 INCH = 2,000 FEET

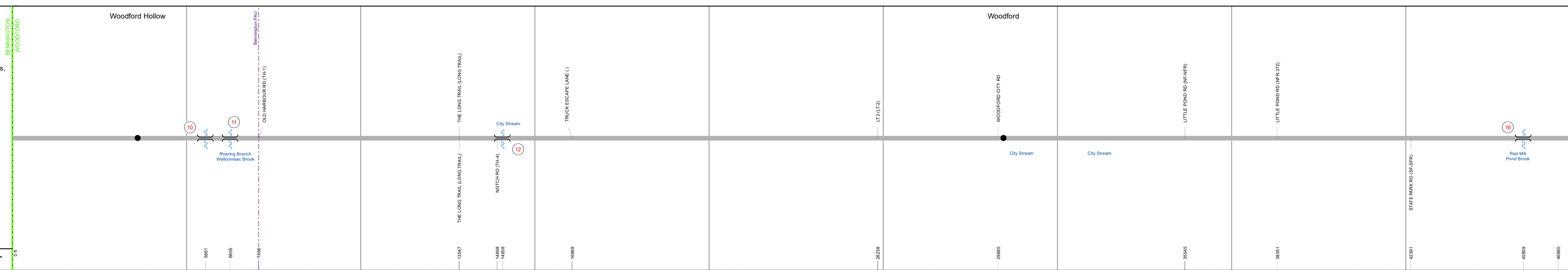

### Road Widths

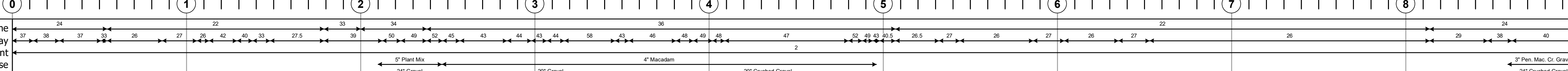

### Curves

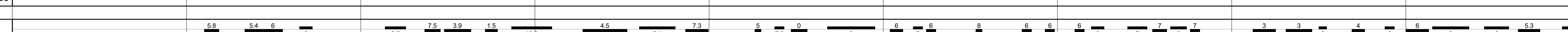

### Grades

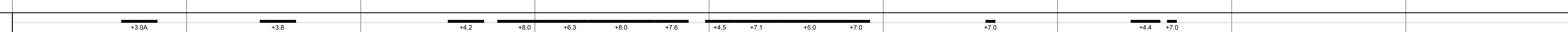

### Guardrails



### Rumblestrips



### Speed Zone

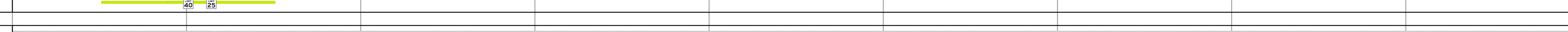

### Curves: Head-on, FTC6

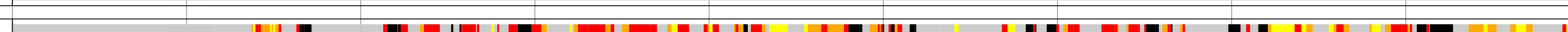

### Curves: Overtake, FTC7

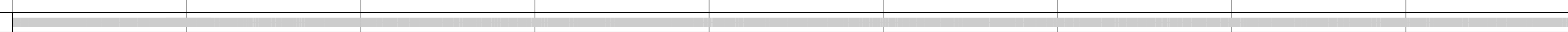

### Curves: Run-off Road, FTC8

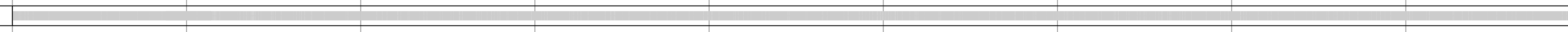

### Curves: Fixed Object, FTC9

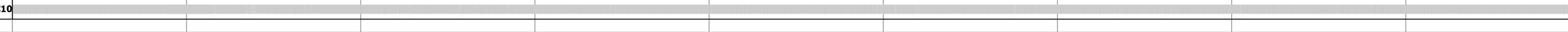

### Curves: Night Run-off Road, FTC10

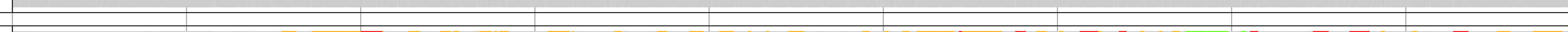

### Interstate: Overtake, FTC11



### Tangents: Head-on, FTC12

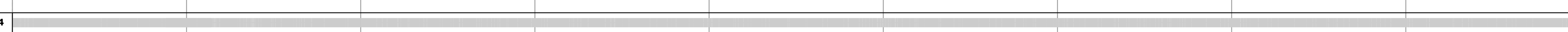

### Tangents: Overtake, FTC13



### Tangents: Run-off Road, FTC14

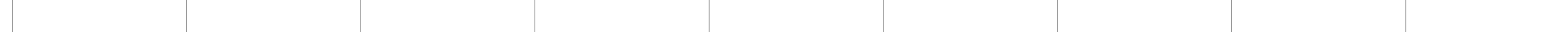

**Risk**

- Primary Risk
- High Risk
- Medium Risk
- Low Risk
- Minimal Risk
- Not a Focus Facility



**AAADT**

2022	4644	3973	4346
2021	4607	3941	4312
2020	3951	3478	3806
2019	4801	4106	4494
2018	4800	4100	4500

### STRUCTURE DESCRIPTIONS

**Bridge 10:**  
Slab - 1925  
Structure No. 300010001002171  
Length: 10'  
Under Clearance: 4.0'  
Weight Limit: 0  
Facility Carried: VT09  
Structure Type: CONCRETE SLAB  
Features Intersected: RELIEF STRUCTURE  
Surface: Bituminous  
Inspection Date: 10/2020  
Maintenance: State

**Bridge 11:**  
Stringer/multi-beam or girder - 2007  
Structure No. 200010001102172  
Length: 279'  
Height: 100.0'  
Width: 43.0'  
Weight Limit: 0  
Facility Carried: VT 09 ML  
Structure Type: 3 SP CONT PLT GIRDER  
Features Intersected: ROARING BRANCH  
Surface: Bituminous  
Inspection Date: 8/2021  
Maintenance/Ownership: State

**Bridge 12:**  
Stringer/multi-beam or girder - 1959  
Structure No. 200010001202172  
Length: 237'  
Height: 100.0'  
Width: 43.0'  
Weight Limit: 0  
Facility Carried: VT 09 ML  
Structure Type: 3 SPAN ROLLED BEAM  
Features Intersected: CITY STREAM  
Surface: Bituminous  
Inspection Date: 6/2021  
Maintenance/Ownership: State

**Bridge 16:**  
Culvert - 1932  
Structure No. 300010001602171  
Length: 13'  
Under Clearance: 6.0'  
Weight Limit: 0  
Facility Carried: VT09  
Structure Type: RC BOX  
Features Intersected: RED MILL POND OUTLET  
Inspection Date: 10/2020  
Maintenance: State

<p><b>Historic Projects</b></p> <ul style="list-style-type: none"> <li>Unknown</li> <li>Retreatment</li> <li>Resurface</li> <li>Bituminous Mix</li> <li>Skinny Mix</li> <li>Bituminous Seal</li> </ul>	<p><b>Functional Class</b></p> <ul style="list-style-type: none"> <li>1 - Interstate System</li> <li>2 - Other Freeways and Expressways</li> <li>3 - Principal Arterial</li> <li>4 - Minor Arterial</li> <li>5 - Major Collector</li> <li>6 - Minor Collector</li> </ul>	<p><b>Curves</b></p> <ul style="list-style-type: none"> <li>Left (degrees)</li> <li>Right (degrees)</li> </ul> <p><b>Grades</b></p> <ul style="list-style-type: none"> <li>Left (percent) grade up</li> <li>Right (percent) grade down</li> </ul>	<p><b>Traffic Counters</b></p> <ul style="list-style-type: none"> <li>Continuous (CTC)</li> <li>Weight-In-Motion (WIM)</li> <li>Short-Term, Scheduled</li> <li>Short-Term, Unscheduled</li> </ul>	<p><b>Crash Locations</b></p> <ul style="list-style-type: none"> <li>Fatal</li> <li>Injury</li> <li>Property Damage Only</li> <li>Unknown Crash Type</li> </ul> <p><b>High Crash Locations (HCL's)</b></p> <p>Sections (&amp; Intersections)</p> <ul style="list-style-type: none"> <li>1 - 100 (1 - 10)</li> <li>101 - 200 (11 - 20)</li> <li>201 - 300 (21 - 30)</li> <li>301 - 400 (31 - 40)</li> <li>401 - 800 (41 - 113)</li> </ul>	<p><b>Mileage by Functional Class By Sheet</b></p> <p>010-1 3 - Other Principal Arterial 9.000</p>	<p><b>Mileage by Town By Sheet</b></p> <p>WOODFORD - V009-0217 9.0 of 9.575</p>	<p><b>DISTRICT</b></p> <p>1</p>	<p><b>TOWN</b></p> <p>WOODFORD</p>	<p><b>Date: 04/02/24</b></p>	<p><b>ROUTE</b></p> <p>VT-9</p> <p>ETE mileage: 6.869 to 15.869</p>
--	--	---	---	--	--	---	---------------------------------	------------------------------------	------------------------------	---