



Route Log and Progress Chart

DRAFT

Please Note: Errors and Omissions May Exist.
Contact the VTrans Mapping Section with questions or concerns.

DISTRICT	TOWN	ROUTE
4	HARTFORD	US-5

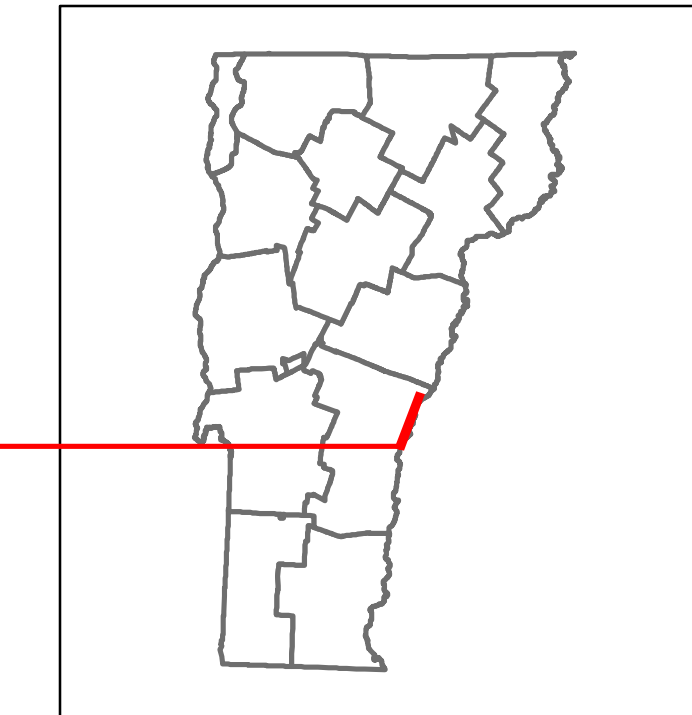

Base Map

1 in = 0.6 miles

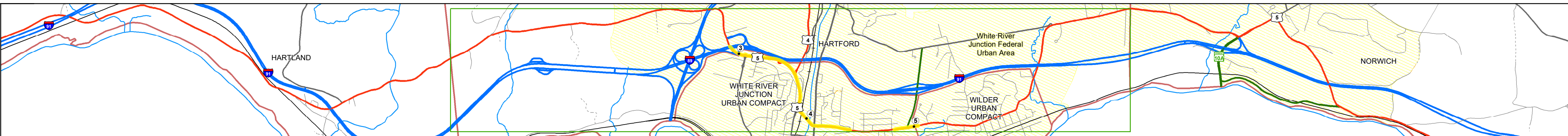

Stick Diagram

- Town Center
- Intersecting State Routes (excl. ramps/approaches)
- Other Intersecting Highways, Ramps, Approaches
- Railroad Crossings
- Primary Structures
- Secondary Structures
- Divided State Highway
- State Highway
- Divided Town Highway
- Town Highway
- Streams (Hydraulic Structure)
- Town Boundary
- District Boundaries
- State/Town Highway Change
- Divided Highway Limits
- Ghost Section Boundary
- Federal Urban Area Limits

Scale: 1 INCH = 2,000 FEET

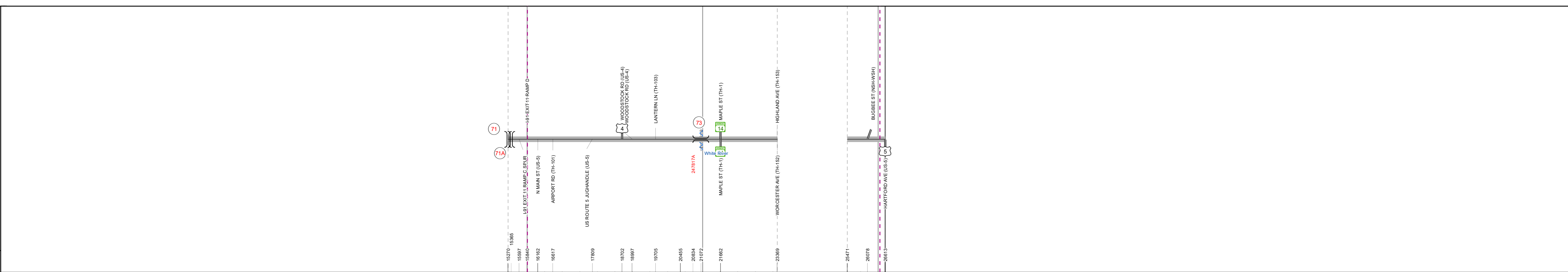

STRUCTURE DESCRIPTIONS

Unknown 71:
Unknown
Structure No. 200091043S14082
Structure Type: Unknown

Unknown 71A:
Unknown
Structure No. 200091043N14082
Structure Type: Unknown

Bridge 73:
Stringer/multi-beam or girder - 1968
Structure No. 200113007314082
Length: 979'
Height: 100.0'
Width: 57.0'
Under Clearance: 23.0'
Weight Limit: 0
Facility Carried: US 05 ML
Structure Type: 6 SP CONT WLD GIRDER
Features Intersected: US 5 OVER WHI R + NECRR
Surface: Bituminous
Inspection Date: 7/2021
Maintenance/Ownership: State

Road Widths

Travellane	Roadway	Lane Count	Base	Subbase
15	24	24	24	24
16	28	28	28	28
17	28	28	28	28
18	28	28	28	28
19	28	28	28	28
20	28	28	28	28
21	28	28	28	28
22	28	28	28	28
23	28	28	28	28
24	28	28	28	28
25	28	28	28	28
26	28	28	28	28
27	28	28	28	28
28	28	28	28	28
29	28	28	28	28
30	28	28	28	28
31	28	28	28	28

Curves

7	10	8	5	4	4
---	----	---	---	---	---

Grades

8	17.5	4
---	------	---

Guardrails

8	17.5	4
---	------	---

Rumblestrips

8	17.5	4
---	------	---

Speed Zone

8	17.5	4
---	------	---

Curves: Head-on, FTC6

8	17.5	4
---	------	---

Curves: Overtake, FTC7

8	17.5	4
---	------	---

Curves: Run-off Road, FTC8

8	17.5	4
---	------	---

Curves: Fixed Object, FTC9

8	17.5	4
---	------	---

Curves: Night Run-off Road, FTC10

8	17.5	4
---	------	---

Interstate: Overtake, FTC11

8	17.5	4
---	------	---

Tangents: Head-on, FTC12

8	17.5	4
---	------	---

Tangents: Overtake, FTC13

8	17.5	4
---	------	---

Tangents: Run-off Road, FTC14

8	17.5	4
---	------	---

Risk

- Primary Risk
- High Risk
- Medium Risk
- Low Risk
- Minimal Risk
- Not a Focus Facility

AAADT

2022	57223725
2021	6375674
2020	5601563
2019	8915568
2018	

<p>Historic Projects</p> <ul style="list-style-type: none"> Unknown Retreatment Resurface Bituminous Mix Skinny Mix Bituminous Seal 	<p>Functional Class</p> <ul style="list-style-type: none"> 1 - Interstate System 2 - Other 3 - Principal Arterial 4 - Minor Arterial 5 - Major Collector 6 - Minor Collector 	<p>Curves</p> <ul style="list-style-type: none"> Left (degrees) Right (degrees) 	<p>Grades</p> <ul style="list-style-type: none"> Left (percent) Right (percent) 	<p>Traffic Counters</p> <ul style="list-style-type: none"> Continuous (CTC) Weight-In-Motion (WIM) Short-Term, Scheduled Short-Term, Unscheduled 	<p>Crash Locations</p> <ul style="list-style-type: none"> Fatal Injury Property Damage Only Unknown Crash Type 	<p>Mileage by Functional Class By Sheet</p> <table border="1"> <tr> <td>020-2</td> <td>4 - Minor Arterial</td> <td>0.560</td> </tr> <tr> <td>0113</td> <td>5 - Major Collector</td> <td>1.190</td> </tr> </table>	020-2	4 - Minor Arterial	0.560	0113	5 - Major Collector	1.190	<p>Mileage by Town By Sheet</p> <table border="1"> <tr> <td>HARTFORD - U005-1408S</td> <td>1.75 of 1.75</td> </tr> </table>	HARTFORD - U005-1408S	1.75 of 1.75	<p>DISTRICT</p> <p>4</p>	<p>TOWN</p> <p>HARTFORD</p>	<p>Date: 02/14/24</p>	<p>ROUTE</p> <p>US-5</p> <p>ETE mileage: 73.732 to 75.266 75.664 to 75.88</p>
020-2	4 - Minor Arterial	0.560																	
0113	5 - Major Collector	1.190																	
HARTFORD - U005-1408S	1.75 of 1.75																		
						<p>Page Total Mileage: 1.750 mi</p>	<p>Page Total Mileage: 1.75 mi</p>	<p>1 of 1</p> <p>TWN mileage: 2.892 to 4.642</p>											

For More Information Contact - Vermont Agency of Transportation, Policy, Planning and Intermodal Development Division - Mapping Section, 219 North Main Street, Barre, VT 05641 Telephone: 802-828-2600.