

DISTRICT	TOWN	ROUTE
8	ALBURGH	US-2

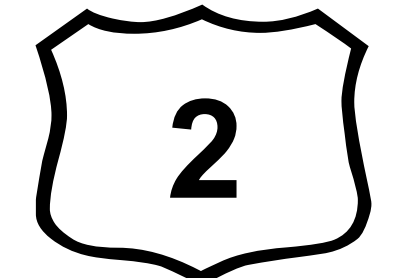

Base Map

1 in = 1.2 miles

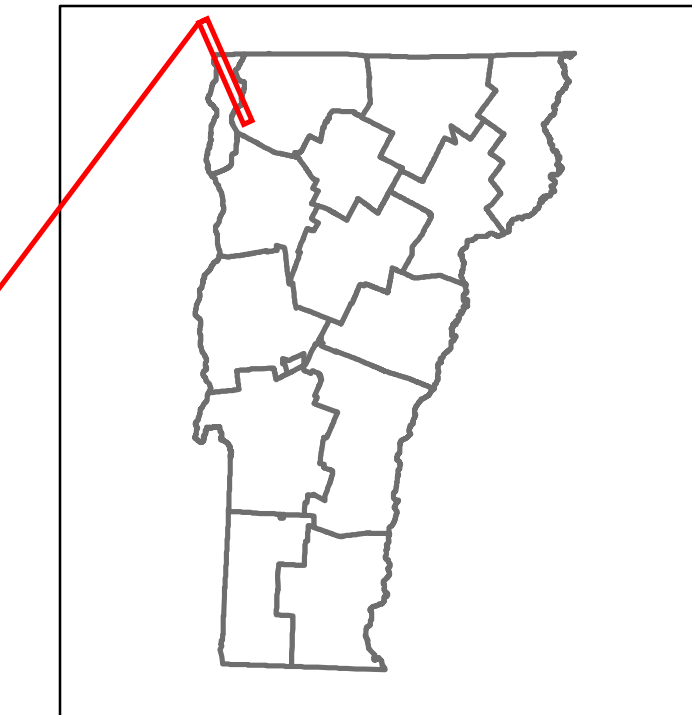
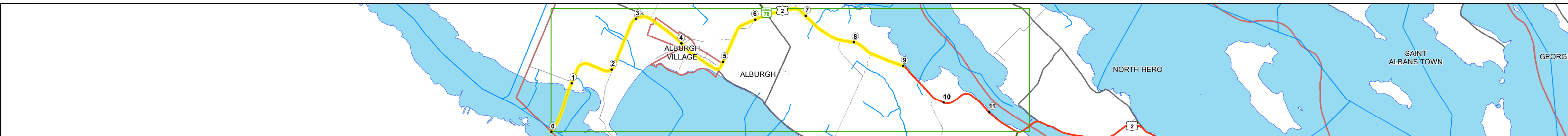

Stick Diagram

- Town Center
- Intersecting State Routes (excl. ramps/approaches)
- Other Intersecting Highways, Ramps, Approaches
- Railroad Crossings
- Primary Structures
- Secondary Structures
- Divided State Highway
- State Highway
- Divided Town Highway
- Town Highway
- Streams (Hydraulic Structure)
- Town Boundary
- District Boundaries
- State/Town Highway Change
- Divided Highway Limits
- Ghost Section Boundary
- Federal Urban Area Limits

Scale: 1 INCH = 2,000 FEET

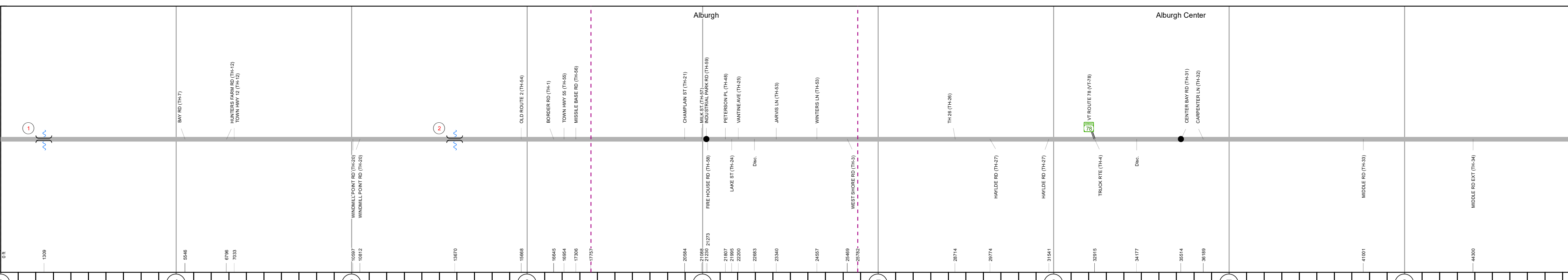

STRUCTURE DESCRIPTIONS

Bridge 1:
Stringer/multi-beam or girder - 1987
Structure No: 200028000107012
Length: 4052'
Height: 100.0'
Width: 40.0'
Weight Limit: 0
Facility Carried: US 02 ML
Structure Type: 2S SPAN CONT GIRDER
Features Intersected: LAKE CHAMPLAIN
Surface: Bituminous
Inspection Date: 7/2023
Maintenance/Ownership: State

Bridge 2:
Culvert - 1937
Structure No: 300028000207011
Length: 13'
Under Clearance: 3.0'
Weight Limit: 0
Facility Carried: US2
Structure Type: RC BOX
Features Intersected: BROOK
Inspection Date: 11/2015
Maintenance: State

Road Widths	Travellane	24	40	26	42	30	22	28
Roadway								
Lane Count								
Base								
Subbase		18" Gravel	3" Crushed Rock	18" Ledge Rock	8" - 12"	3" Crushed Rock	10" - 12"	

Curves	7	8	4.5	12.5	2		
Grades							
Guardrails							
Rumblestrips							
Speed Zone			45	55	50	40	40
Curves: Head-on, FTC6							
Curves: Overturn, FTC7							
Curves: Run-off Road, FTC8							
Curves: Fixed Object, FTC9							
Curves: Night Run-off Road, FTC10							
Interstate: Overturn, FTC11							
Tangents: Head-on, FTC12							
Tangents: Overturn, FTC13							
Tangents: Run-off Road, FTC14							

Risk	Primary Risk	High Risk	Medium Risk	Low Risk	Minimal Risk	Not a Focus Facility
ADT	2022	4204	4688	2086		
	2021	4171	4651	2069		
	2020	3681	3681	1826		
	2019	4846	4846	2156		
	2018	4200	4700	4900	5500	4900
				1900		2200

<p>Historic Projects</p> <ul style="list-style-type: none"> Unknown Retreatment Resurface Bituminous Mix Skinny Mix Bituminous Seal 	<p>Functional Class</p> <ul style="list-style-type: none"> 1 - Interstate System 2 - Other 3 - Principal Arterial 4 - Minor Arterial 5 - Major Collector 6 - Minor Collector 	<p>Curves</p> <ul style="list-style-type: none"> Left (degrees) Right (degrees) <p>Grades</p> <ul style="list-style-type: none"> grade up (percent) grade down (percent) 	<p>Traffic Counters</p> <ul style="list-style-type: none"> Continuous (CTC) Weight-In-Motion (WIM) Short-Term, Scheduled Short-Term, Unscheduled 	<p>Crash Locations</p> <ul style="list-style-type: none"> Fatal Injury Property Damage Only Unknown Crash Type <p>High Crash Locations (HCL's)</p> <p>Sections (& Intersections)</p> <ul style="list-style-type: none"> 1 - 100 (1 - 10) 101 - 200 (11 - 20) 201 - 300 (21 - 30) 301 - 400 (31 - 40) 401 - 800 (41 - 113) 	<p>Mileage by Functional Class By Sheet</p> <table border="1"> <tr> <td>028-1 3 - Other Principal Arterial</td> <td>6.234</td> </tr> <tr> <td>028-1 4 - Minor Arterial</td> <td>2.766</td> </tr> </table>	028-1 3 - Other Principal Arterial	6.234	028-1 4 - Minor Arterial	2.766	<p>Mileage by Town By Sheet</p> <table border="1"> <tr> <td>ALBURGH - U002-0701</td> <td>9.0 of 11.732</td> </tr> </table>	ALBURGH - U002-0701	9.0 of 11.732	<p>DISTRICT</p> <p>8</p>	<p>TOWN</p> <p>ALBURGH</p>	<p>Date: 02/14/24</p>	<p>ROUTE</p> <p>US-2</p> <p>ETE mileage: 0.0 to 9.0</p>
028-1 3 - Other Principal Arterial	6.234															
028-1 4 - Minor Arterial	2.766															
ALBURGH - U002-0701	9.0 of 11.732															
<p>Page Total Mileage: 9.000 mi</p>						<p>Page Total Mileage: 9.0 mi</p>		<p>1 of 2</p> <p>TWN mileage: 0.0 to 9.0</p>								