



Route Log Progress Chart

DRAFT

Please Note: Errors and Omissions May Exist. Contact the VTTrans Mapping Unit with questions or concerns.

DISTRICT	TOWN	ROUTE
8	RICHFORD	VT-105

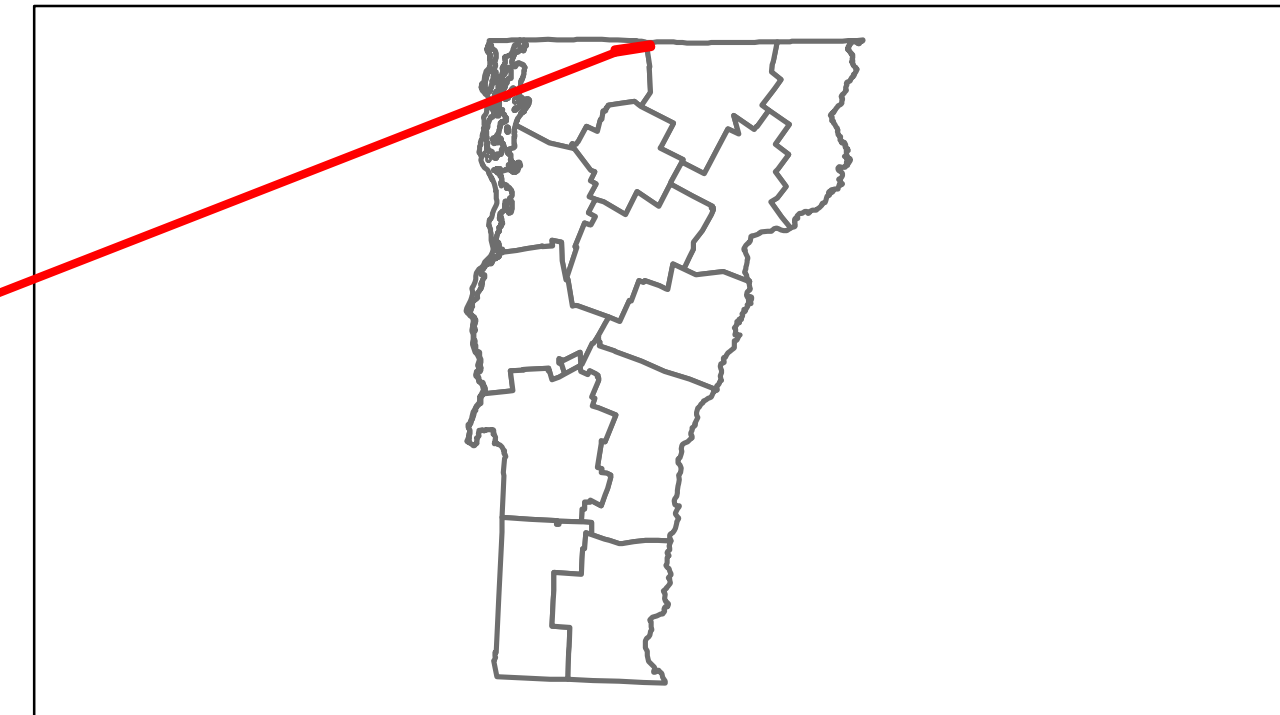

**Base Map**

1 in = 2,000 feet

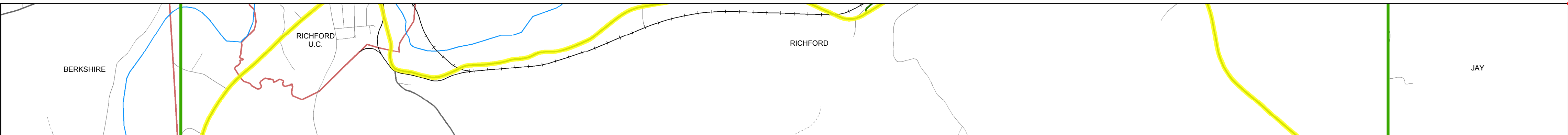

**Stick Diagram**

- Primary Structures
- Secondary Structures
- Stations (Feet)
- Divided State Highway
- State Highway
- Divided Class 1 Town Highway
- Class 1 Town Highway
- Railroad Crossings
- District Boundaries
- Village/UC Boundary
- Town Boundary
- Ghost Section Boundary
- State/Town Highway Change
- Divided Highway Limits
- Stream/Crossing Events

Scale: 1in = 2000 FEET

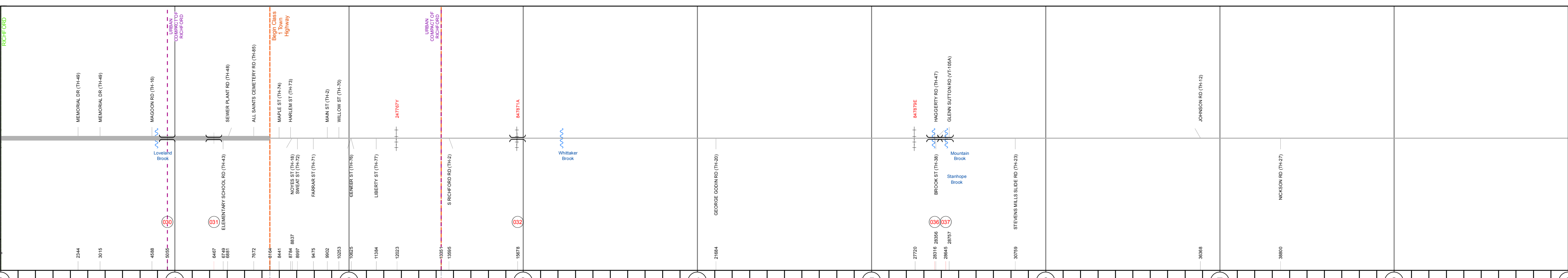

**Road Widths**

Travellane  
Roadway  
Lane Count  
Base  
Subbase

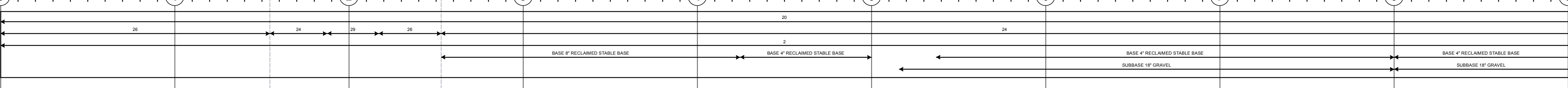

**Curves**

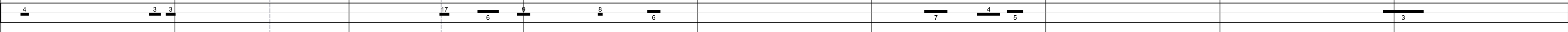

**Grades**

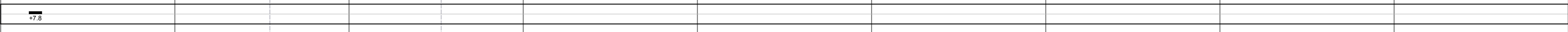

**Historic Projects**

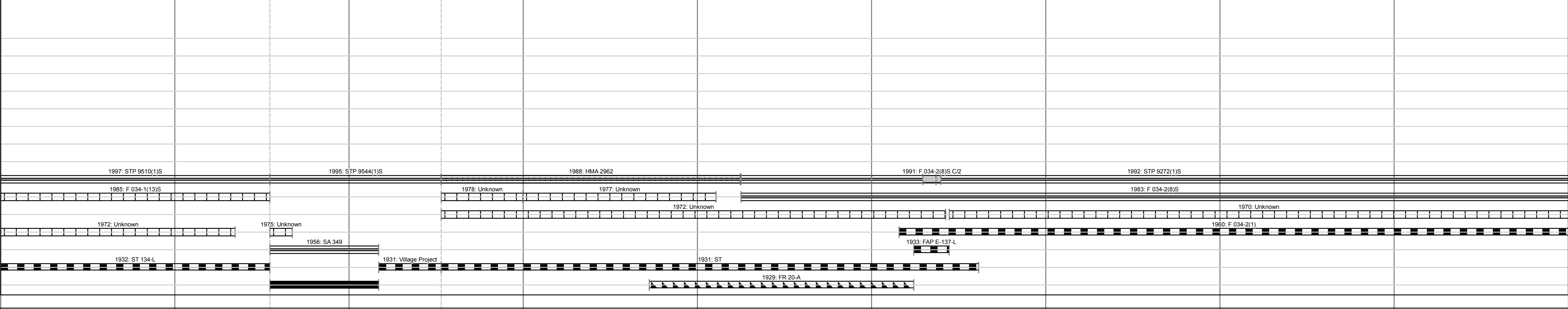

**Maintenance Garage**

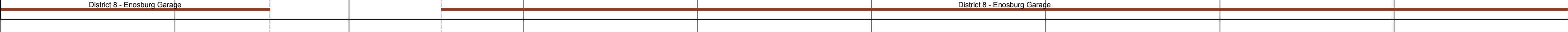

**Traffic Counters**



**Functional Class**

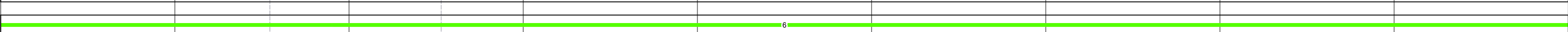

**Speed Zone**

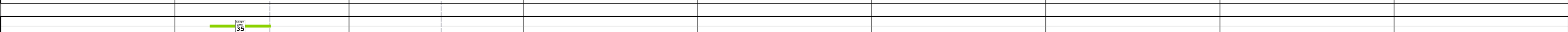

**AADT Counts**



**Crash Locations**



**DESCRIPTION BLOCK**

Bridge No. 30: Culvert - 1969  
Structure No. 300034003006111  
Length: 8' Under Clearance: 8.0'  
Facility Carried: VT105  
Bridge Type: ACCGMP  
Features Intersected: LOVELAND BROOK  
Maintenance: State

Bridge No. 31: Culvert - 1967  
Structure No. 300034003106111  
Length: 6' Under Clearance: 3.5'  
Facility Carried: VT105  
Bridge Type: ACCGMPA  
Features Intersected: BROOK  
Maintenance: State

Bridge No. 32: Stringer/multi-beam or girder - 1909  
Structure No. 200034003206112  
Length: 49', Height: 0.0' Facility Carried: RAILROAD  
Bridge Type: RIVETED TWO GIRDER  
Features Intersected: MAINE/MONTRL/ATLANTIC RR

Bridge No. 36: Tee Beam - 1930  
Structure No. 200034003606112  
Length: 42', Width: 35.2'  
Facility Carried: VT 00105 ML  
Bridge Type: CONCRETE T-BEAM  
Features Intersected: STANHOPE BROOK  
Surface: Bituminous  
Maintenance/Ownership: State

Bridge No. 37: Culvert - 1960  
Structure No. 300034003706111  
Length: 14' Under Clearance: 9.0'  
Facility Carried: VT105  
Bridge Type: CGMPPA  
Features Intersected: MOUNTAIN BROOK  
Maintenance: State

<p><b>Historic Projects</b></p> <ul style="list-style-type: none"> <li>Unknown</li> <li>Bituminous Mix</li> <li>Concrete</li> <li>Gravel</li> <li>Surface Treated Gravel</li> <li>Plant Mix</li> <li>Reclaimed Base and Bituminous Concrete</li> </ul>	<p><b>Functional Class</b></p> <p>1-19</p>	<p><b>Curves</b></p> <p>curve left curve right</p>	<p><b>Traffic Counters</b></p> <p>(counter ID)</p>	<p><b>Road Widths</b></p> <p>(ft)</p>	<p><b>AADT</b></p> <p>(count)</p>	<p><b>Crash Locations</b></p> <p>Fatal Property Damage Only Injury Unknown Crash Type</p>	<p><b>Mileage by Functional Class By Sheet</b></p> <p>034-2 6 - Rural - Minor Arterial 7.097 034-1 6 - Rural - Minor Arterial 1.903</p>	<p><b>Mileage by Town By Sheet</b></p> <p>RICHFORD - V105-0611 9.0 of 9.23</p>	<p><b>DISTRICT</b></p> <p>8</p>	<p><b>TOWN</b></p> <p>RICHFORD</p>	<p><b>1 of 2</b> mile 0.0 to mile 9.0</p> <p>Date: 04/09/13</p>	<p><b>ROUTE</b></p> <p>VT-105</p>
							<p><b>Total Mileage: 9.0 mi</b></p>					