

TOWN HWY. NO.	LENGTH IN MILES CLASS 3	LENGTH IN MILES CLASS 4		
4	2.69 (0.36)	61	0.62	
5	1.09 (0.18)	63	0.80	
6		64	0.95	
7	2.51 (0.16)	65	0.80	
8	0.11	66	1.25 (0.78)	
10	0.48	67	0.06 (0.06)	
11	0.61 (0.09)	68	0.33	
12	2.96 (1.55)	69	0.12	
13	0.24	70	0.60 (0.08)	
16	1.56	71		
17	1.90 (0.19)	72	0.16	
18	1.20	74	0.98	
19	0.21 (0.29)	75	1.88	
20	0.91 (1.94)	77	0.61	
21	0.84	78	0.25	
22	0.85	79	0.03	
23	2.92	80	0.17	
24	1.10	82		
25		83	0.04 (0.12)	
26	0.10	84	0.23	
28	0.35	85	0.20	
29	0.69 (0.19)	86	0.06	
30	0.98	87	0.38	
31	0.90	88	0.23	
32	0.52	89	0.04	
33	0.27	91	0.25	
34	0.56 (0.74)	92	0.17	
35	2.91	93		
36	1.70 (0.48)	94	0.13 (0.16)	
37	0.92 (0.60)	96	0.50	
38	0.13	97		
39	0.22 (1.33)	98	0.27 (0.07)	
40	0.75	99	0.28	
41		100	0.09 (0.20)	
42		102	0.24 (0.41)	
43	0.05	103	0.12	
44	0.45	104	0.14	
45	1.65	105	0.04	
46		106	0.33 (0.45)	
47	1.22	107	0.03	
48	0.60 (0.70)	108	0.09	
49	1.81	109	0.17	
50	0.16	110	0.19	
51		111	0.34 (0.11)	
52	0.89	114	0.17	
53	1.49	115	0.08	
54	1.87	116		
55	0.20	117	0.23 (0.27)	
56	0.78	118	0.27	
57	0.20	119		
58	0.15	120	0.13 (0.90)	
59	1.14	121	0.10 (0.10)	
60				
TOTAL		60.83	14.71	

MILEAGE SUMMARY

CLASS	LENGTH	TOTAL
CLASS 2		
TH-1	0.880	
TH-2	0.110	
TH-3	2.430	
TH-4	3.970	
TH-5	1.790	
TOTAL CLASS 2	9.180	
CLASS 3		
TOTAL CLASS 3	60.830	
TOTAL TOWN	70.010	
STATE HIGHWAY		
VT-12	3.298	
VT-106	6.553	
TOTAL STATE HIGHWAY	9.851	
US HIGHWAY		
US-4	8.074	
TOTAL US HIGHWAY	8.074	
TOTAL STATE	17.925	

TOTAL, TRAVELED HIGHWAYS, FEB. 10, 2008: 87.935
(Excludes Class 4 and Legal Trail Mileage)

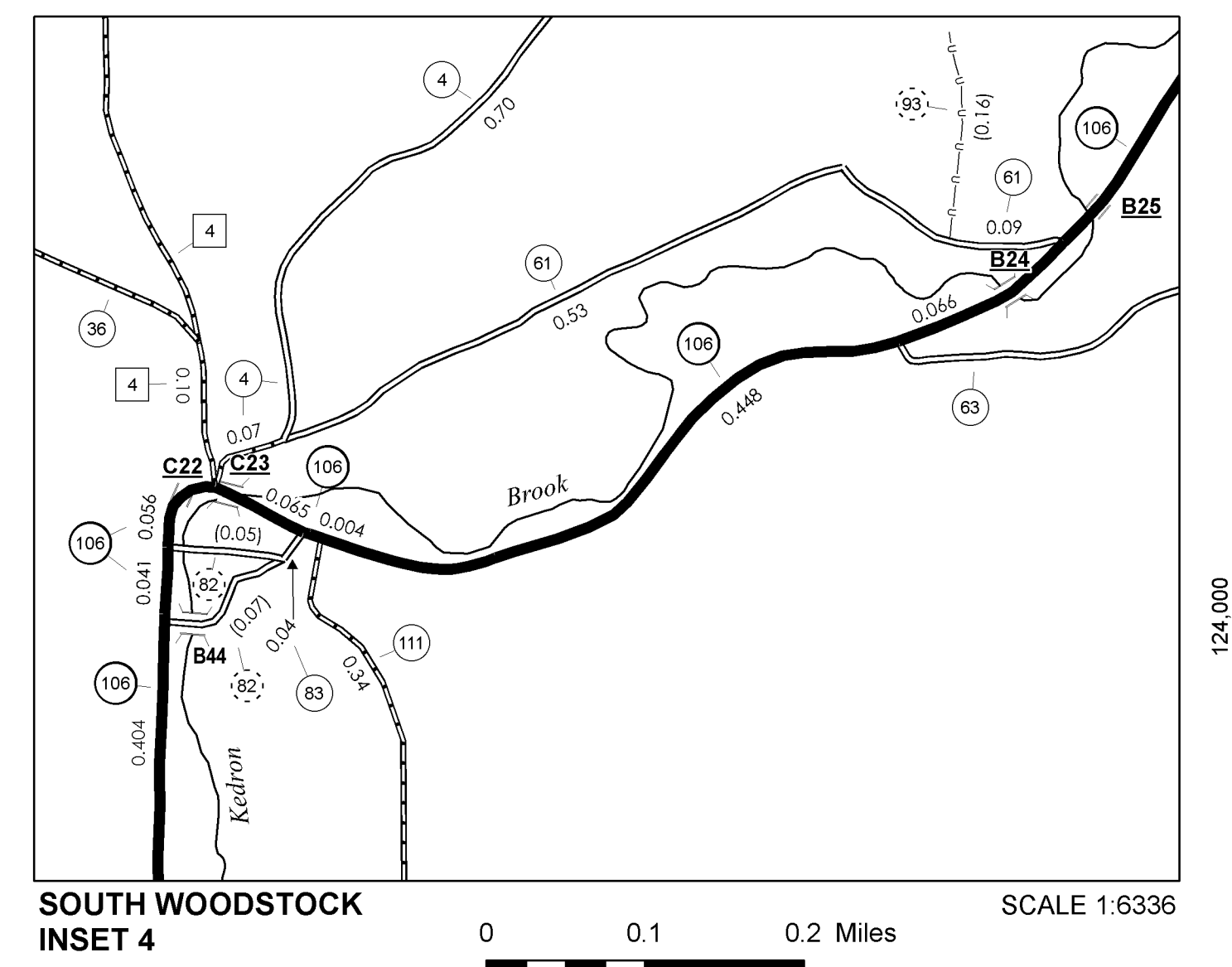
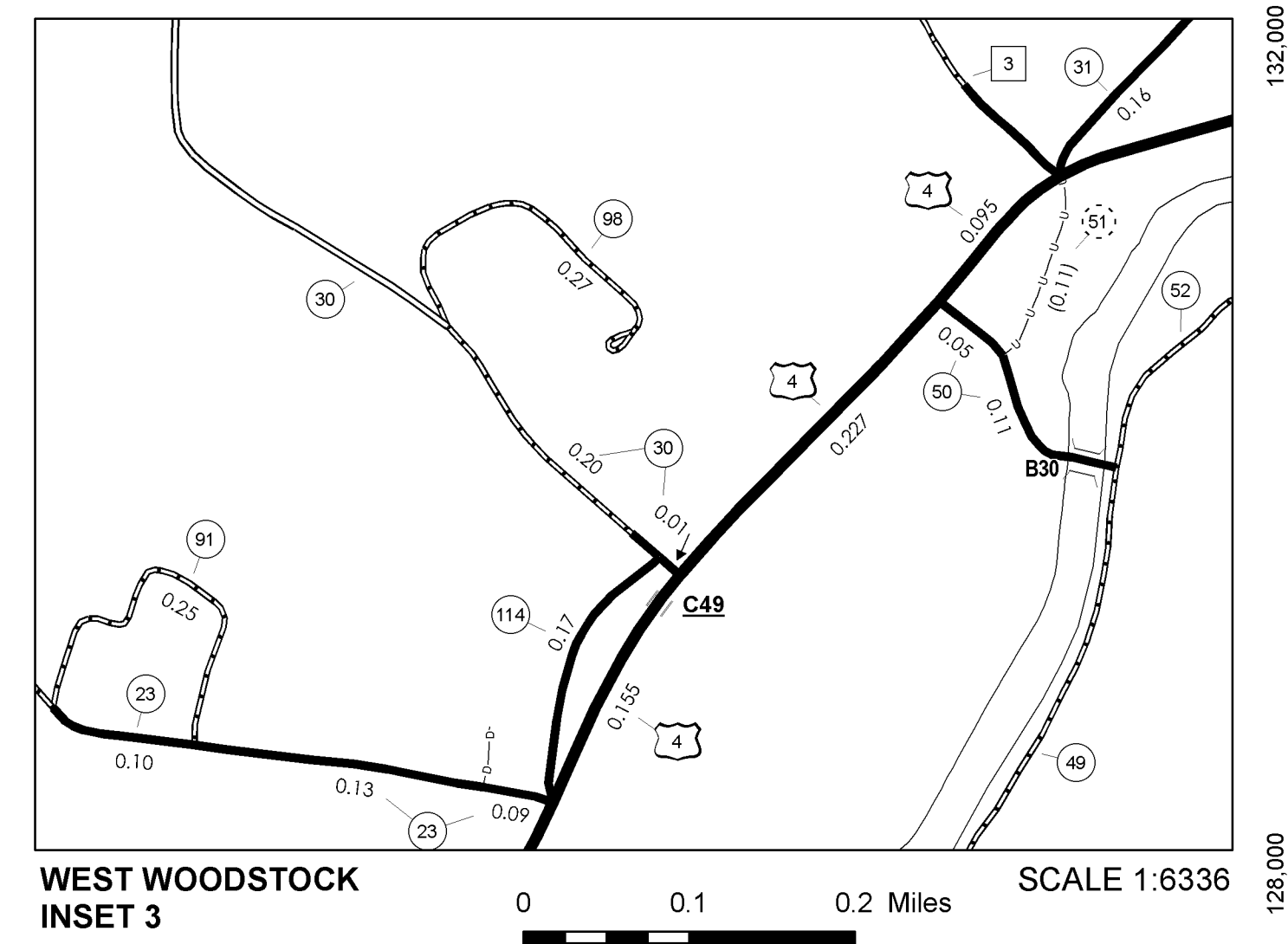
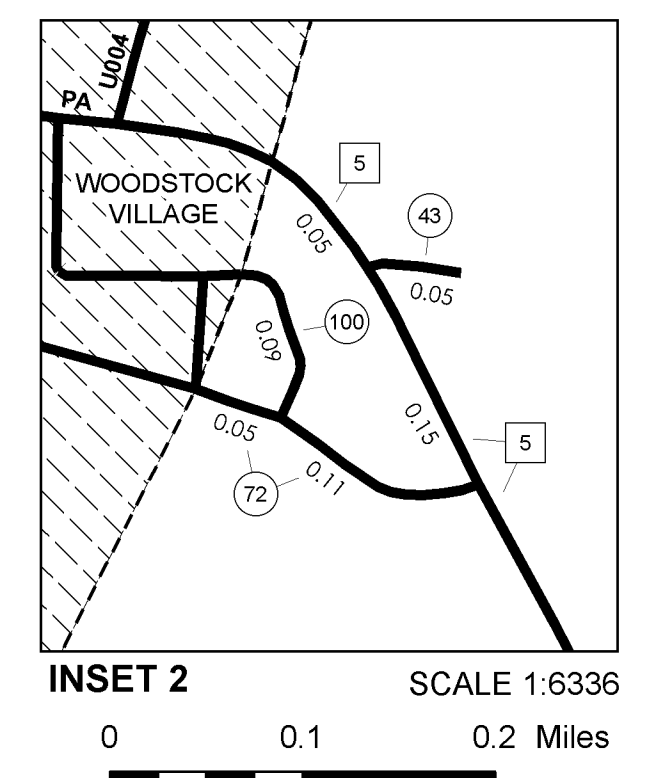
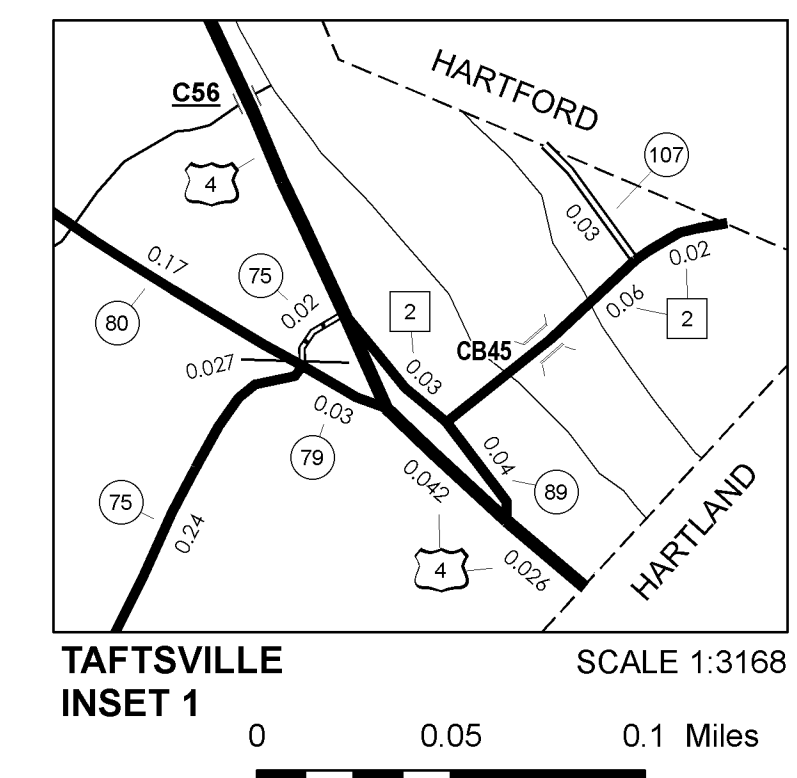

- HIGHWAYS**
- INTERSTATE
 - U.S. ROUTE
 - STATE ROUTE
 - CLASS 1
 - CLASS 2
 - CLASS 3
 - CLASS 4
 - LEGAL TRAIL
 - INTERSTATE OR DIVIDED HIGHWAY
 - STATE - HARD SURFACE OR PAVED
 - TOWN - HARD SURFACE OR PAVED
 - GRAVEL
 - SOIL OR GRADED AND DRAINED EARTH
 - UNIMPROVED OR PRIMITIVE
 - IMPASSABLE OR UNTRAVELED
 - LEGAL TRAIL
 - DISCONTINUED
 - HIGHWAY CLASS CHANGE
 - RAILROAD
- PUBLIC LAND**
- POLITICAL SUBDIVISIONS
 - STATE BOUNDARY
 - COUNTY BOUNDARY
 - TOWN BOUNDARY
 - VILLAGE BOUNDARY
 - URBAN COMPACT
 - OPEN WATER
 - STREAM OR BROOK
 - BRIDGE OR CULVERT
 - BRIDGE OR CULVERT GREATER THAN 20'
 - BRIDGE OR CULVERT 6' - 20'
 - STATE BRIDGE OR CULVERT IDENTIFIER
 - TOWN BRIDGE OR CULVERT IDENTIFIER
- FEDERAL CLASSIFICATION IDENTIFIER**
- FAU URBAN ARTERIAL OR COLLECTOR
 - MA MINOR ARTERIAL
 - MJC MAJOR COLLECTOR
 - MNC MINOR COLLECTOR
 - PA PRINCIPAL ARTERIAL

DISCLAIMER:
The untraveled highways (laid-out town highways), discontinued highways, and legal trails shown herein are those of which the Agency of Transportation has record; others may exist.
Highway and bridge data by the Agency of Transportation, Policy & Planning Division. All other data from the Vermont Center for Geographic Information.

STRUCTURES - SURFACE WATER NOTE:
Town short structures (bridges or culverts from 6-feet to less than 20-feet) were not represented due to inconsistencies in the data.
The surface waters are from the Vermont Hydrological Dataset (VHD). Only the named streams are shown.

Vermont State Plane Coordinate System
North American Datum of 1983
SPCS Zone Identifier: 4400
Geodetic Reference System 80
4,000-meter grid, Easting - Northing

VERMONT
GENERAL HIGHWAY MAP
Town of Woodstock
WINDSOR COUNTY

Transportation District #4

Prepared by the
Vermont Agency of Transportation
Policy & Planning Division
in cooperation with
U.S. Department of Transportation
Federal Highway Administration

Mileage as of: February 10, 2008
Map generated: October, 2008

