

TOWN HWY. No.	LENGTH IN MILES CLASS 3	CLASS 4
3	1.37	
4	2.60	
5	2.24	
6	5.99	
7	0.10	(0.30)
8	1.08	
9	0.28	
10		(0.60)
11	0.40	
12	2.14	
13	0.50	(0.28)
14	0.28	(0.71)
15	0.09	
16	0.66	
17	0.35	
18	2.77	
19	1.54	
21	0.90	
22	0.40	
23	0.61	
24		(0.05)
25	0.45	
26	0.67	(0.31)
27	0.03	
28	1.53	
29	0.50	
30	1.90	
31	1.30	
32	0.47	
33	0.81	
34	0.85	
35	0.25	
36	0.84	
37	1.36	
38	0.88	
39	0.07	
40	0.78	
41	0.89	(0.16)
42	0.05	
43	0.04	
44	0.08	
47	0.04	
48		(0.07)
49	0.43	
50	0.16	
51	0.50	(0.85)
52	0.38	
53	0.90	
54	0.21	
56	0.43	
57		(0.89)
TOTAL	41.10	4.22

MILEAGE SUMMARY

CLASS 2	4.700	
TH-1	1.231	
TH-2		
TOTAL CLASS 2	5.931	
CLASS 3		
TOTAL CLASS 3	41.10	
TOTAL TOWN	47.031	
STATE HIGHWAY		
VT-44	5.044	
TOTAL STATE HIGHWAY	5.044	
TOTAL STATE	5.044	

TOTAL, TRAVELED HIGHWAYS, FEB. 10, 2014: 52.075
(Excludes Class 4, Legal Trail, and Unidentified Corridor Mileage)

TOWN HWY. No.

26	(0.01)
39	(0.11)
TOTAL	0.12

*The sections of the town highways listed above are legally Class 3, but have been deemed "Not Up To Standard" and are functionally Class 4 Town Highways

LEGAL TRAIL No.

1	(0.33)
TOTAL	0.33

- HIGHWAYS**
- INTERSTATE OR DIVIDED HIGHWAY
 - STATE - HARD SURFACE OR PAVED
 - TOWN - HARD SURFACE OR PAVED
 - U.S. ROUTE
 - STATE ROUTE
 - CLASS 1
 - CLASS 2
 - CLASS 3
 - CLASS 4
 - LEGAL TRAIL
 - INTERSTATE OR DIVIDED HIGHWAY
 - STATE - HARD SURFACE OR PAVED
 - TOWN - HARD SURFACE OR PAVED
 - GRAVEL
 - SOIL OR GRADED AND DRAINED EARTH
 - UNIMPROVED OR PRIMITIVE
 - IMPASSABLE OR UNTRAVELED
 - LEGAL TRAIL
 - DISCONTINUED
 - HIGHWAY CLASS CHANGE
 - RAILROAD
 - INACTIVE RAILROAD
 - NFR NATIONAL FOREST ROAD
 - SFH STATE FOREST HIGHWAY
 - P PARK AND RIDE
- POLITICAL SUBDIVISIONS**
- STATE BOUNDARY
 - COUNTY BOUNDARY
 - TOWN BOUNDARY
 - VILLAGE BOUNDARY
 - URBAN COMPACT BOUNDARY
 - WATER BODY
 - STREAM OR BROOK
- BRIDGE OR CULVERT**
- BRIDGE OR CULVERT > 20'
 - BRIDGE OR CULVERT 6' - 20'
 - VOBCIT BRIDGE
 - VOBCIT CULVERT > 6'
- B34 / C34 STATE BRIDGE OR CULVERT IDENTIFIER**
B34 / C34 TOWN BRIDGE OR CULVERT IDENTIFIER

- FEDERAL CLASSIFICATION IDENTIFIER**
- FAU URBAN ARTERIAL OR COLLECTOR
 - MA MINOR ARTERIAL
 - MJC MAJOR COLLECTOR
 - MNC MINOR COLLECTOR
 - PA PRINCIPAL ARTERIAL

DISCLAIMER:
The untraveled highways (laid-out town highways), discontinued highways, and legal trails hereon are those of which the Agency of Transportation has record; others may exist.

Highway and bridge data by the Agency of Transportation. Town short structures are drawn from the Vermont Online Bridge & Culvert Inventory Tool (VOBCIT) database. All other data from the Vermont Center for Geographic Information. Only named streams are shown.

Vermont State Plane Coordinate System
North American Datum of 1983
SPCS_Zone_Identifier: 4400
Geodetic Reference System 80
4,000-meter grid, Easting - Northing

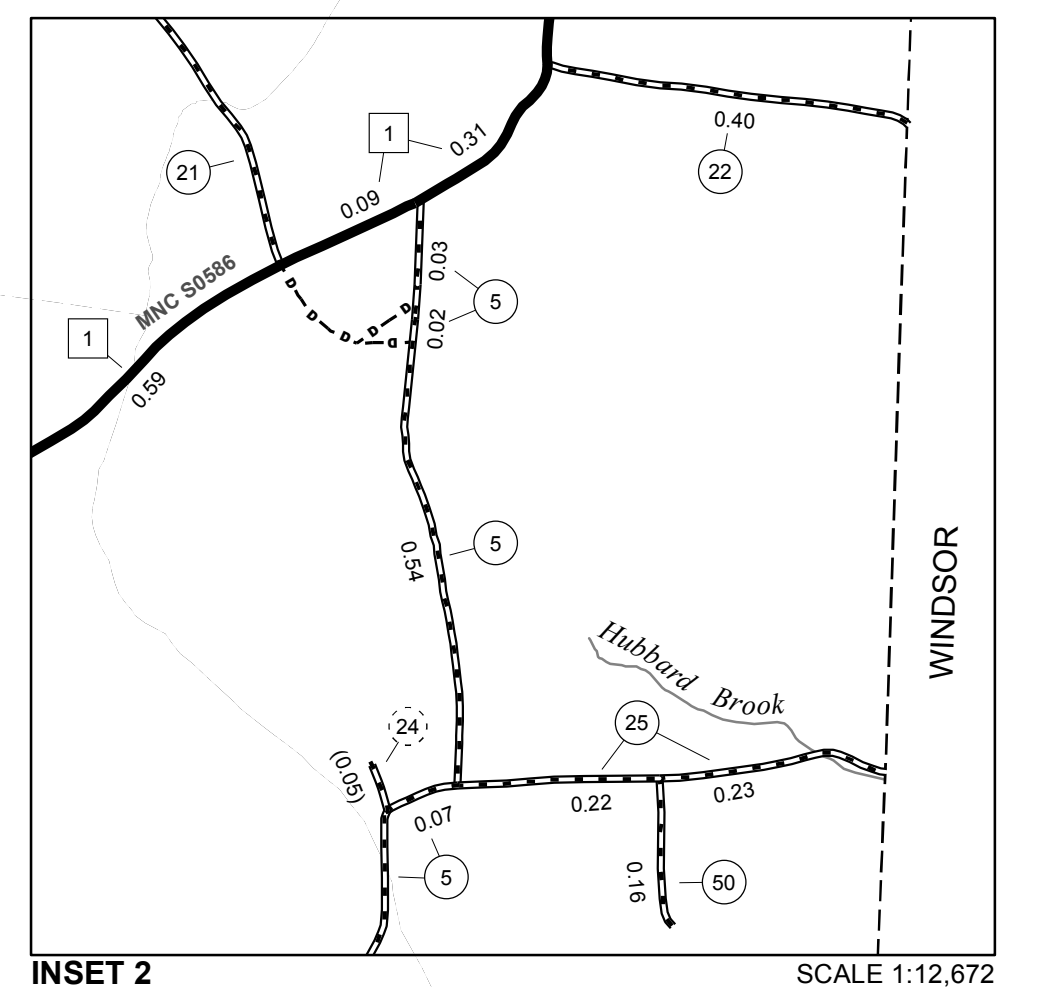

INSET 2 SCALE 1:12,672



INSET 2

BROWNSVILLE INSET 1

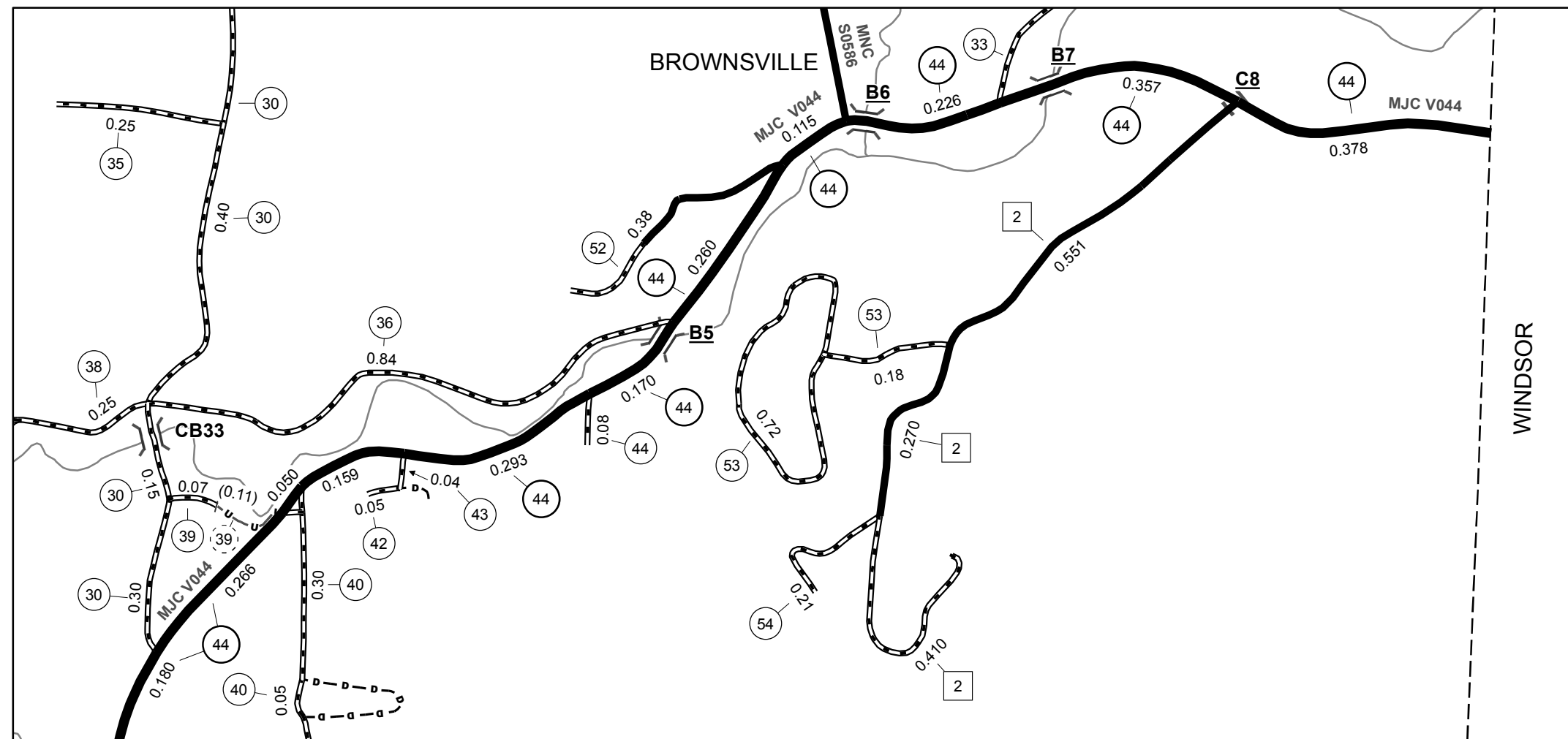

INSET 1 SCALE 1:12,672

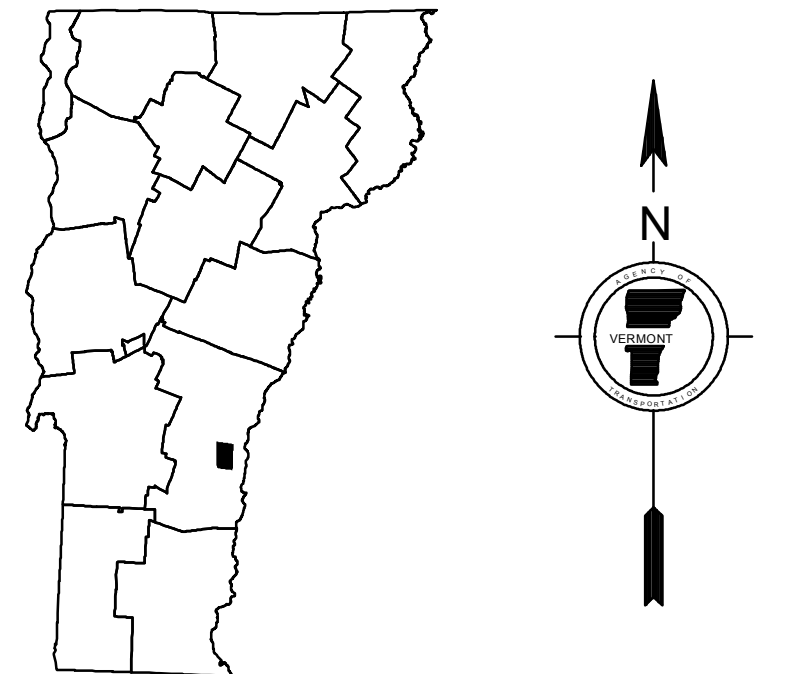

VERMONT GENERAL HIGHWAY MAP
Town of West Windsor

WINDSOR COUNTY
Transportation District #4
Prepared by the
Vermont Agency of Transportation
Division of Policy, Planning and Intermodal Development
in cooperation with
U.S. Department of Transportation
Federal Highway Administration

Mileage as of February 10, 2014
Map prepared October 07, 2014
SCALE 1:31,680

