

TOWN HWY. NO.	LENGTH IN MILES CLASS 3	CLASS 4
3	1.370	
4	2.600	
5	2.290	
6	5.990	
7	0.100	(0.300)
8	2.090	
9	0.280	
11	0.400	
12	2.270	(0.170)
13	0.500	(0.280)
14	0.280	(0.710)
15	0.090	
16	0.660	
17	0.350	
18	1.750	
19	1.540	
21	0.900	
22	0.400	
23	0.610	
24		(0.050)
25	0.450	
26	0.670	(0.310)
26		(0.010)
27	0.030	
28	1.530	
29	0.500	
30	1.900	
31	1.300	
32	0.470	
33	0.810	
34	0.850	
35	0.250	
36	0.840	
37	1.360	
38	0.880	
39	0.070	
39		(0.110)
40	0.600	(0.120)
41	0.890	(0.160)
42	0.110	
43	0.040	
52	0.380	
53	0.900	
54	0.210	
55	0.140	
56	0.430	
57		(0.890)
TOTAL	41.300	4.700

MILEAGE SUMMARY

CLASS 2			
TH-1	4.700		
TH-2	1.231		
TOTAL CLASS 2		5.931	
CLASS 3			
TOTAL CLASS 3	41.300		
TOTAL TOWN	47.231		
STATE HIGHWAY			
VT-44	5.044		
TOTAL STATE HIGHWAY		5.044	
TOTAL STATE		5.044	

TOTAL, TRAVELED HIGHWAYS, FEB. 10, 2007: 52.275
(Excludes Class 4 and Legal Trail Mileage)

* This portion of town highway is Class 3, but is functionally Class 4

HIGHWAYS

- INTERSTATE
- U.S. ROUTE
- STATE ROUTE
- CLASS 1
- CLASS 2
- CLASS 3
- CLASS 4
- LEGAL TRAIL
- INTERSTATE OR DIVIDED HIGHWAY
- STATE - HARD SURFACE OR PAVED
- TOWN - HARD SURFACE OR PAVED
- GRAVEL
- SOIL OR GRADED AND DRAINED EARTH
- UNIMPROVED OR PRIMITIVE
- IMPASSABLE OR UNTRAVELED
- LEGAL TRAIL
- DISCONTINUED
- HIGHWAY CLASS CHANGE
- RAILROAD

FEDERAL CLASSIFICATION IDENTIFIER
 FAU URBAN ARTERIAL OR COLLECTOR
 MA MINOR ARTERIAL
 MJC MAJOR COLLECTOR
 MNC MINOR COLLECTOR
 PA PRINCIPAL ARTERIAL

- PUBLIC LAND
- POLITICAL SUBDIVISIONS**
- STATE BOUNDARY
- COUNTY BOUNDARY
- TOWN BOUNDARY
- VILLAGE BOUNDARY
- URBAN COMPACT BOUNDARY
- WATER BODIES**
- OPEN WATER
- SWAMP
- STREAM OR BROOK
- BRIDGE OR CULVERT**
- BRIDGE OR CULVERT GREATER THAN 20'
- BRIDGE OR CULVERT 6' - 20'

B34 STATE BRIDGE IDENTIFIER
B34 TOWN BRIDGE IDENTIFIER

DISCLAIMER:

The untraveled highways (laid-out town highways), discontinued highways, and legal trails shown hereon are those of which the Agency of Transportation has record; others may exist.

Highway and bridge data by the Agency of Transportation, Policy & Planning Division. All other data from the Vermont Center for Geographic Information.

Vermont State Plane Coordinate System
 North American Datum of 1983
 SPCS_Zone_Identifier: 4400
 Geodetic Reference System 80
 4,000-meter grid, Easting - Northing

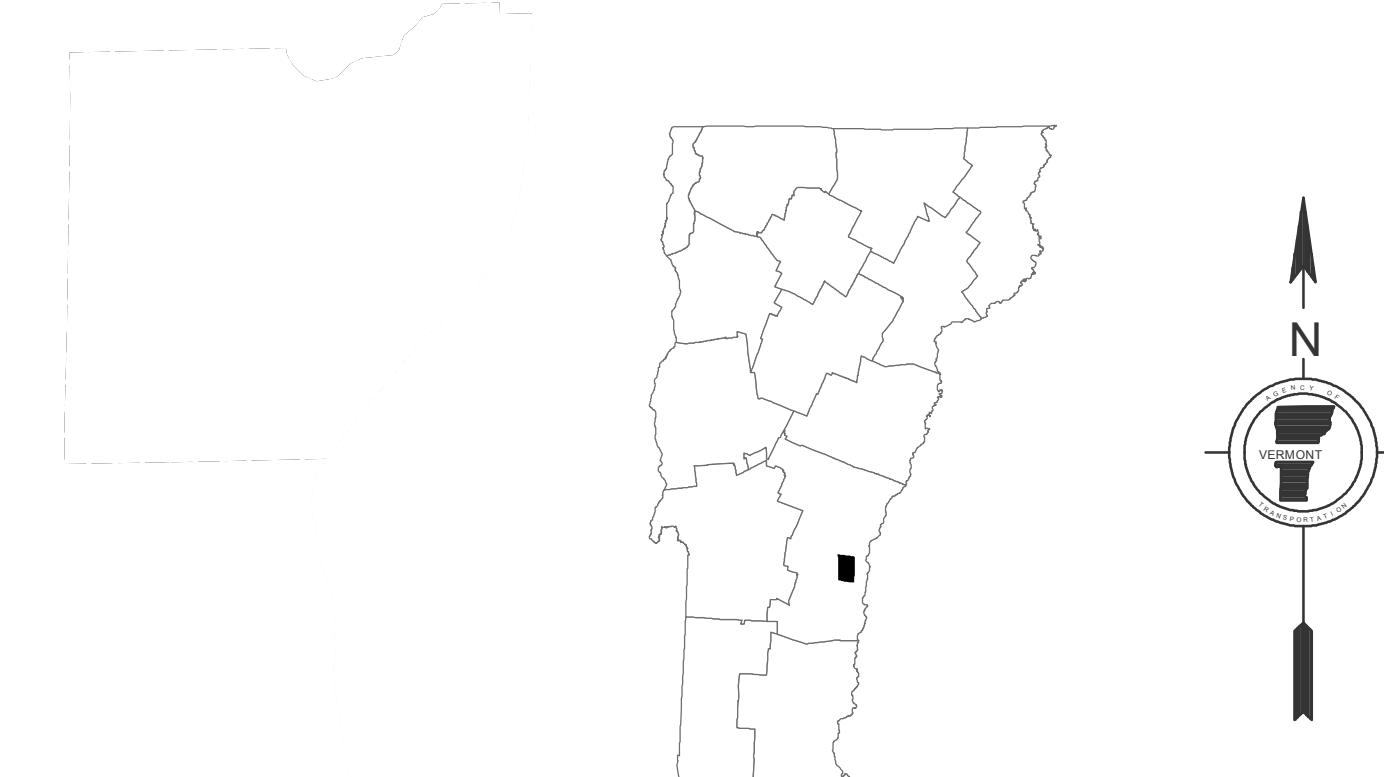
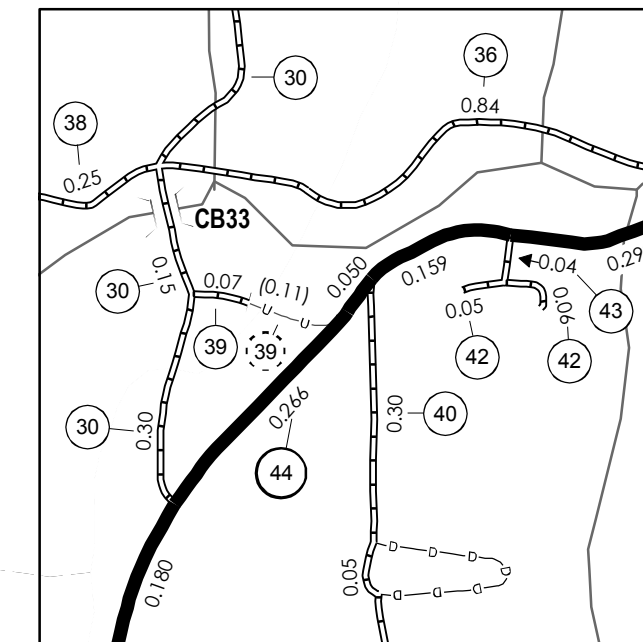
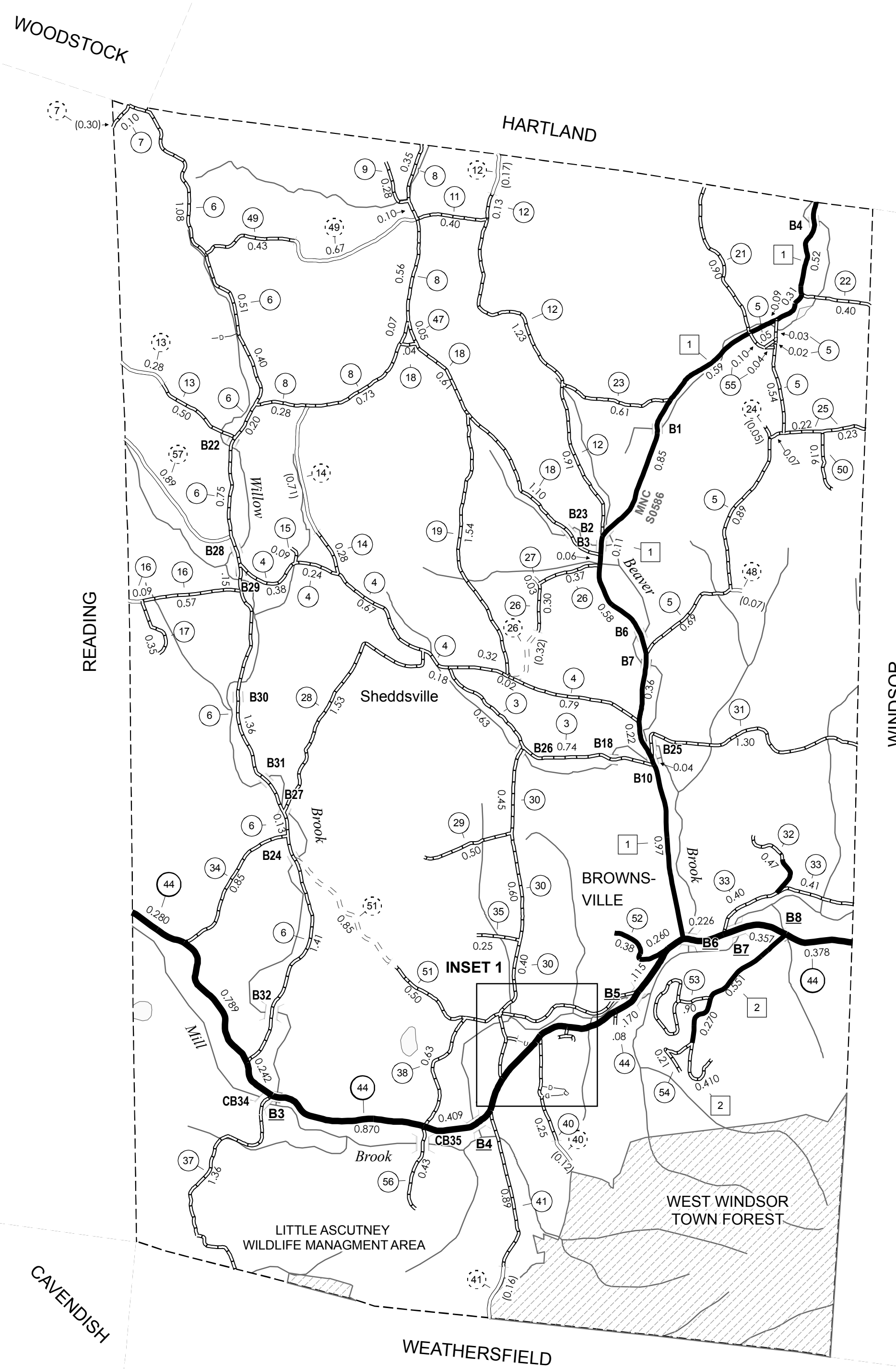

VERMONT
GENERAL HIGHWAY MAP
Town of West Windsor
 WINDSOR COUNTY

Transportation District #4

Prepared by the
 Vermont Agency of Transportation
 Policy & Planning Division
 in cooperation with
 U.S. Department of Transportation
 Federal Highway Administration

Mileage as of: Feb. 10, 2007
 Map generated: October, 2007

