

498,000

500,000

TOWN HWY. No.	LENGTH IN MILES CLASS 3	CLASS 4	TOWN ROAD NAME
17	0.05		CHURCH ST
20	0.13		UPPER FALLS RD
21	0.27		QUARRY RD
23	0.08		OLD CENTER ST
25	0.25		MAPLE ST
69	0.21		HIGH ST
TOTAL	0.99	0.00	

MILEAGE SUMMARY

CLASS 3	TOTAL CLASS 3	0.99
TOTAL TOWN	0.990	
STATE HIGHWAY VT-106	0.590	
TOTAL STATE HIGHWAY	0.590	
TOTAL STATE	0.59	

TOTAL, TRAVELED HIGHWAYS, FEB. 10, 2014: 1.580
 (Excludes Class 4, Legal Trail, and Unidentified Corridor Mileage)

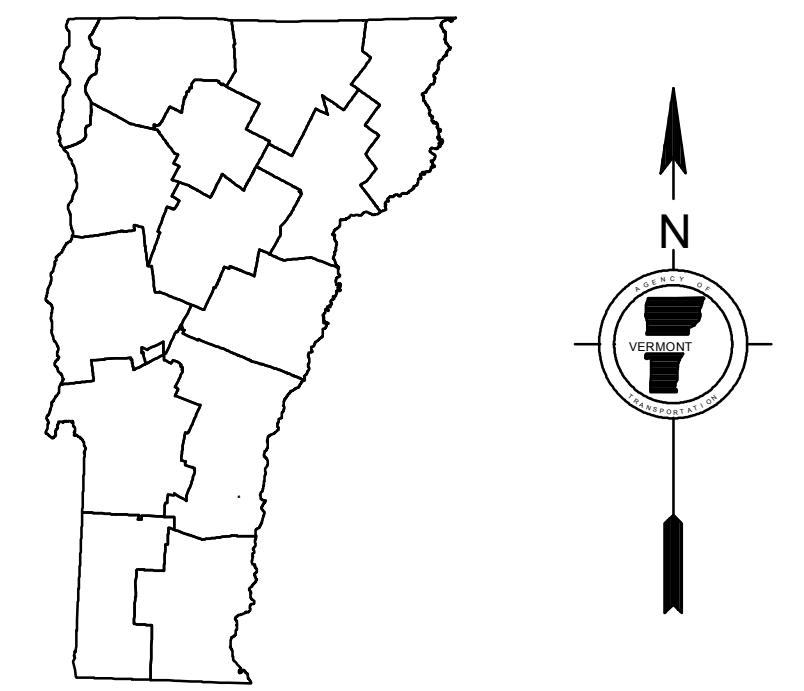
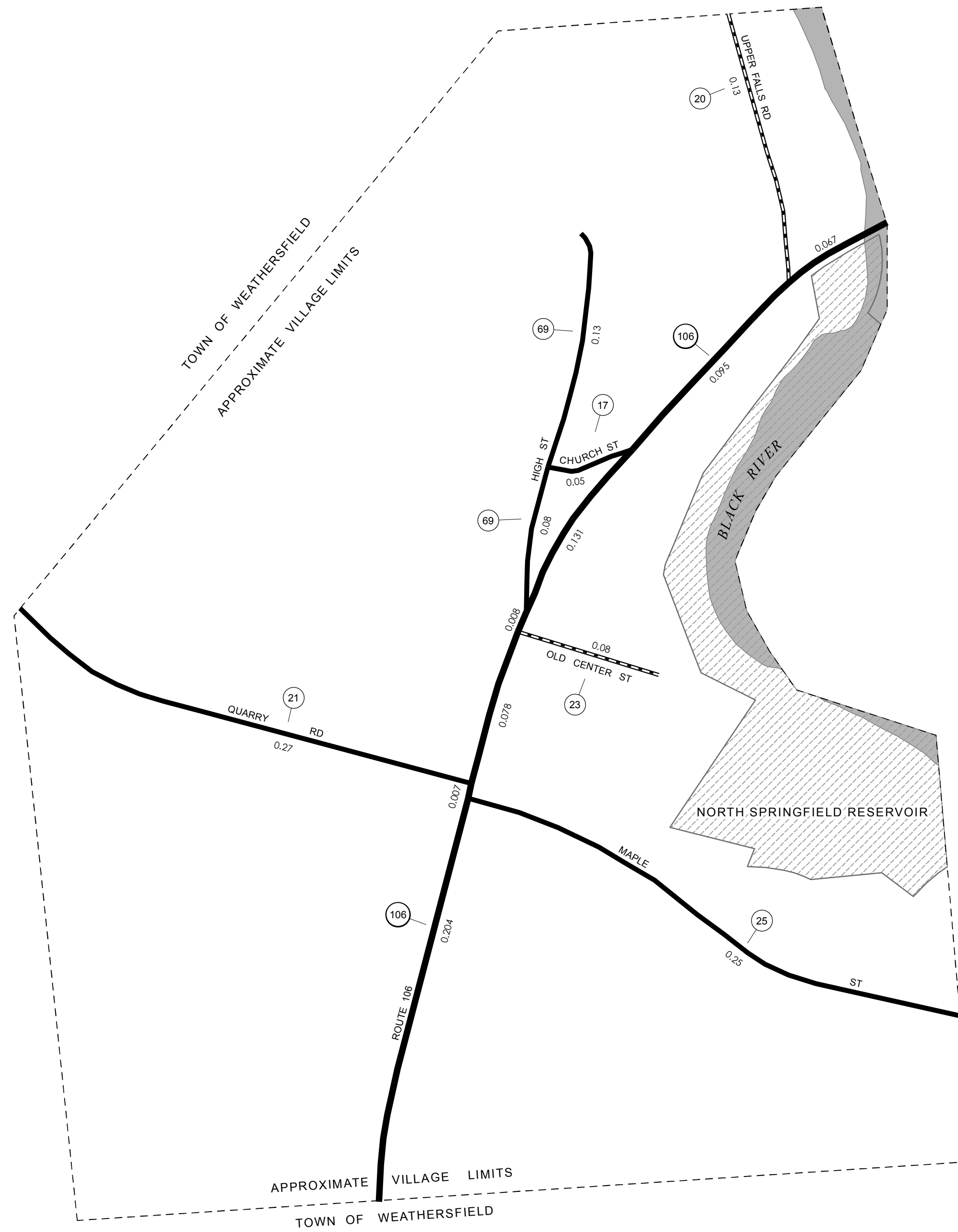

**VERMONT
 GENERAL HIGHWAY MAP
 Village of Perkinsville**

WINDSOR COUNTY

Transportation District #2

Prepared by the
 Vermont Agency of Transportation
 Division of Policy, Planning and Intermodal Development
 in cooperation with
 U.S. Department of Transportation
 Federal Highway Administration

Mileage as of February 10, 2014
 Map prepared October 03, 2014

SCALE 1:3,168

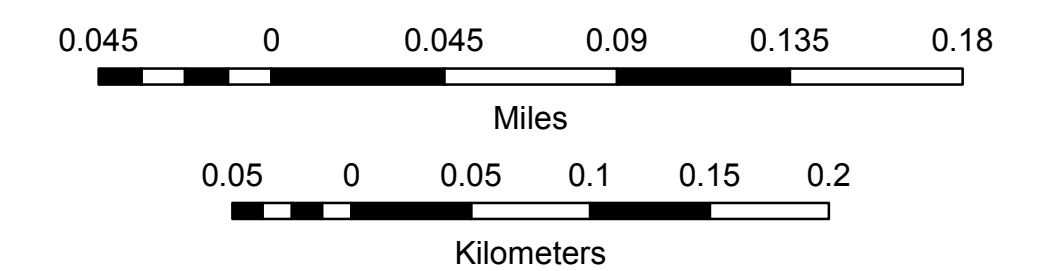

- | | | |
|-----------------|------------------------------------|---|
| HIGHWAYS | — INTERSTATE OR DIVIDED HIGHWAY | ■ PUBLIC LAND - GREEN MOUNTAIN NATIONAL FOREST |
| — INTERSTATE | — STATE - HARD SURFACE OR PAVED | ■ PUBLIC LAND - STATE/MUNICIPAL |
| — U.S. ROUTE | — TOWN - HARD SURFACE OR PAVED | POLITICAL SUBDIVISIONS |
| — STATE ROUTE | — GRAVEL | — STATE BOUNDARY |
| □ CLASS 1 | — SOIL OR GRADED AND DRAINED EARTH | — COUNTY BOUNDARY |
| □ CLASS 2 | — UNIMPROVED OR PRIMITIVE | — TOWN BOUNDARY |
| ○ CLASS 3 | — IMPASSABLE OR UNTRAVELED | — VILLAGE BOUNDARY |
| ○ CLASS 4 | — LEGAL TRAIL | — URBAN COMPACT BOUNDARY |
| ○ LEGAL TRAIL | — DISCONTINUED | — WATER BODY |
| | — HIGHWAY CLASS CHANGE | — STREAM OR BROOK |
| | — RAILROAD | BRIDGE OR CULVERT |
| | — INACTIVE RAILROAD | — BRIDGE OR CULVERT > 20' |
| | — NATIONAL FOREST ROAD | — BRIDGE OR CULVERT 6' - 20' |
| | — STATE FOREST HIGHWAY | ● VOBCIT BRIDGE |
| | — PARK AND RIDE | ● VOBCIT CULVERT > 6' |
| | | B34 / C34 STATE BRIDGE OR CULVERT IDENTIFIER |
| | | B34 / C34 TOWN BRIDGE OR CULVERT IDENTIFIER |

- FEDERAL CLASSIFICATION IDENTIFIER**
 FAU URBAN ARTERIAL OR COLLECTOR
 MA MINOR ARTERIAL
 MJC MAJOR COLLECTOR
 MNC MINOR COLLECTOR
 PA PRINCIPAL ARTERIAL

DISCLAIMER:
 The untraveled highways (laid-out town highways), discontinued highways, and legal trails hereon are those of which the Agency of Transportation has record; others may exist.

Highway and bridge data by the Agency of Transportation. Town short structures are drawn from the Vermont Online Bridge & Culvert Inventory Tool (VOBCIT) database. All other data from the Vermont Center for Geographic Information. Only named streams are shown.

Vermont State Plane Coordinate System
 North American Datum of 1983
 SPCS_Zone_Identifier: 4400
 Geodetic Reference System 80
 2,000-meter grid, Easting - Northing

498,000

500,000