

TOWN HWY. NO.	LENGTH IN MILES CLASS 3	CLASS 4	TOWN HWY. NO.	LENGTH IN MILES CLASS 3	CLASS 4
10	5.45		152	0.14	
11	2.89		153	0.47	
12	1.09		154	0.19	
13	0.98		155	0.16	
14	0.64		156	0.17	
15	1.88	(0.62)	157	0.06	
16	0.52		158	0.05	
17	0.14		159	0.12	
18	5.42		160	0.11	
19	1.20		161	0.11	
20	0.48		162	0.10	
21	1.15		163	0.13	
22	1.12	(0.69)	164	0.06	
23	0.15	(0.18)	165	0.01	
24	0.15		166	0.11	
25	0.52		167	0.14	
26	0.14		168	0.18	
27	0.49		169	0.18	
28	2.51		170	0.07	
29	0.25		171	0.35	
30	0.67		173	0.15	
31	0.25		174	0.05	
32	0.25		175	0.06	
33	0.33		176	0.08	
34	0.32		177	0.10	
35	0.11		178	0.12	
36	2.96		179	0.26	
37		(0.12)	180	0.12	
38	0.31		181	0.04	
39	0.30		182	0.20	
40	0.59		183	0.04	
41	0.25		184	0.08	
42	0.29		185	0.06	
43	2.10		186	1.02	
44	0.10		187	0.14	
45	0.27	(0.09)	188	1.89	
46	1.43	(0.42)	189	0.33	
47	1.76		190	0.34	
49	0.73		191	0.33	
50	0.18		192	0.23	
51	0.14	(0.51)	193	0.49	
52	1.72	(0.43)	194	0.32	
53	0.24	(1.96)	195	0.14	
54			196	0.14	
55	1.32		197	0.12	
56	0.44		198	0.08	
57	0.59		199	0.06	
58	0.67		200	0.14	
59	0.43		201	1.04	
60	1.60		202	0.27	
61	1.52	(0.25)	203	1.23	
62	0.36		204	0.12	
63	0.12		205	0.14	
64	0.30		206	0.11	
65	0.29		207	0.12	
66	0.43		208	0.36	
67		(0.12)	209	0.12	
68	0.54	(0.02)	210	0.31	
69	0.10		211	0.73	
70	0.99	(0.82)	212	0.12	
71	0.08		213	0.19	
72	0.31	(0.67)	214	0.10	
73	1.38		215	2.25	
74	0.34	(0.99)	217	0.28	
75	0.05		218	0.13	
75	0.05		219	0.56	
76	0.14	(0.45)	220	0.27	
77		(0.25)	221	0.94	
78	2.56	(0.42)	222	0.28	
79	0.39		223	0.78	
80	0.10		224	0.50	
81	0.53		225	2.83	
82	0.22		226	0.33	
83	0.11		227	0.20	
84	0.06		228	0.12	
85	0.09		229	0.53	
86	0.34		230	0.23	
87	0.22		231	0.20	
88	0.22		232	0.55	
89	0.06		233	0.17	
90	0.19		234	0.10	
91	0.42		235	0.79	
92	0.13	(0.26)	236	0.50	
93	0.20	(0.22)	237	0.20	
94	0.09		238	0.29	
95	0.08		239	0.16	
96	0.28		240	0.18	
97	0.06		241	0.12	
98	0.06	(0.07)	242	0.19	
99	0.06		243	0.63	
100	0.10		244	0.38	
101	1.03		245	0.14	
102	0.13		246	0.26	
103	0.48		247	0.34	
104	0.30		248	0.21	
105	0.41		249	0.09	
106	0.14		250	0.04	
107	0.13		251	0.08	
108	0.04		252	0.19	
109		(0.07)	253	0.06	
109		(0.10)	254	0.04	
110		(0.04)	255	0.05	
111	0.25		256	0.44	
112	0.08		257	0.05	
113	0.02	(0.11)	258	0.14	
114	0.07		259	0.25	
115	0.56		260	0.05	
116	0.32		261	0.27	
117	0.21		262	0.06	
118	0.07		263	0.09	
119	0.12		264	0.22	
120	0.04		265	0.38	
121	0.16		266	0.53	
122	0.11		267	0.08	
123	0.13		268	0.13	
124	0.15		269	0.50	
125	0.16		270	0.37	
126	0.15		271	0.10	
127	0.09		272	0.14	
128	0.04		273	0.24	
129	0.15		274	0.64	
130	0.03	(0.33)	275	0.29	
132	0.13		276	0.31	
133	0.13		277	0.11	
134	0.19		278	0.03	
135	0.22		279	0.09	
136	0.06		280	0.38	
137	0.16		281	0.12	
138	0.37		282	0.08	
139	0.04		283	0.08	
140	0.18	(0.02)	284	0.18	
141	0.17		285	0.23	
142	0.21		286	0.13	
143	0.18		287	0.40	
144	0.19		288	0.07	
145	0.04		289	0.17	
146	0.35		290	0.13	
147	0.25		291	0.28	
148	0.04		292	0.20	
149	0.15		293	0.09	
150	0.14		294	0.19	
151	0.05				

TOTAL 108.50 10.55

* This portion of town highway is Class 3, but is functionally Class 4

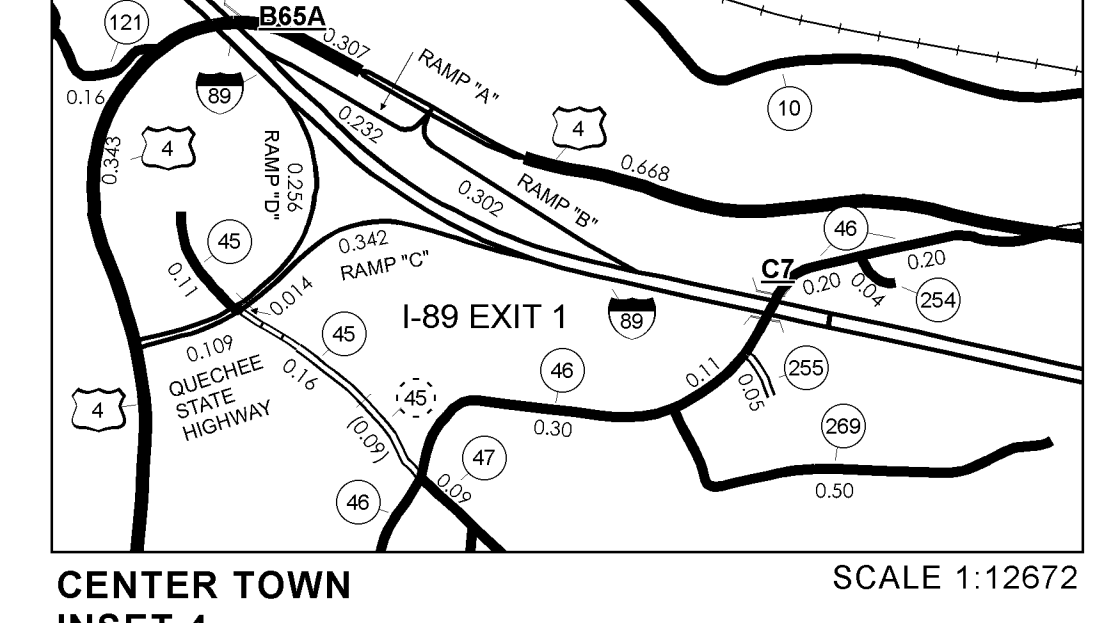
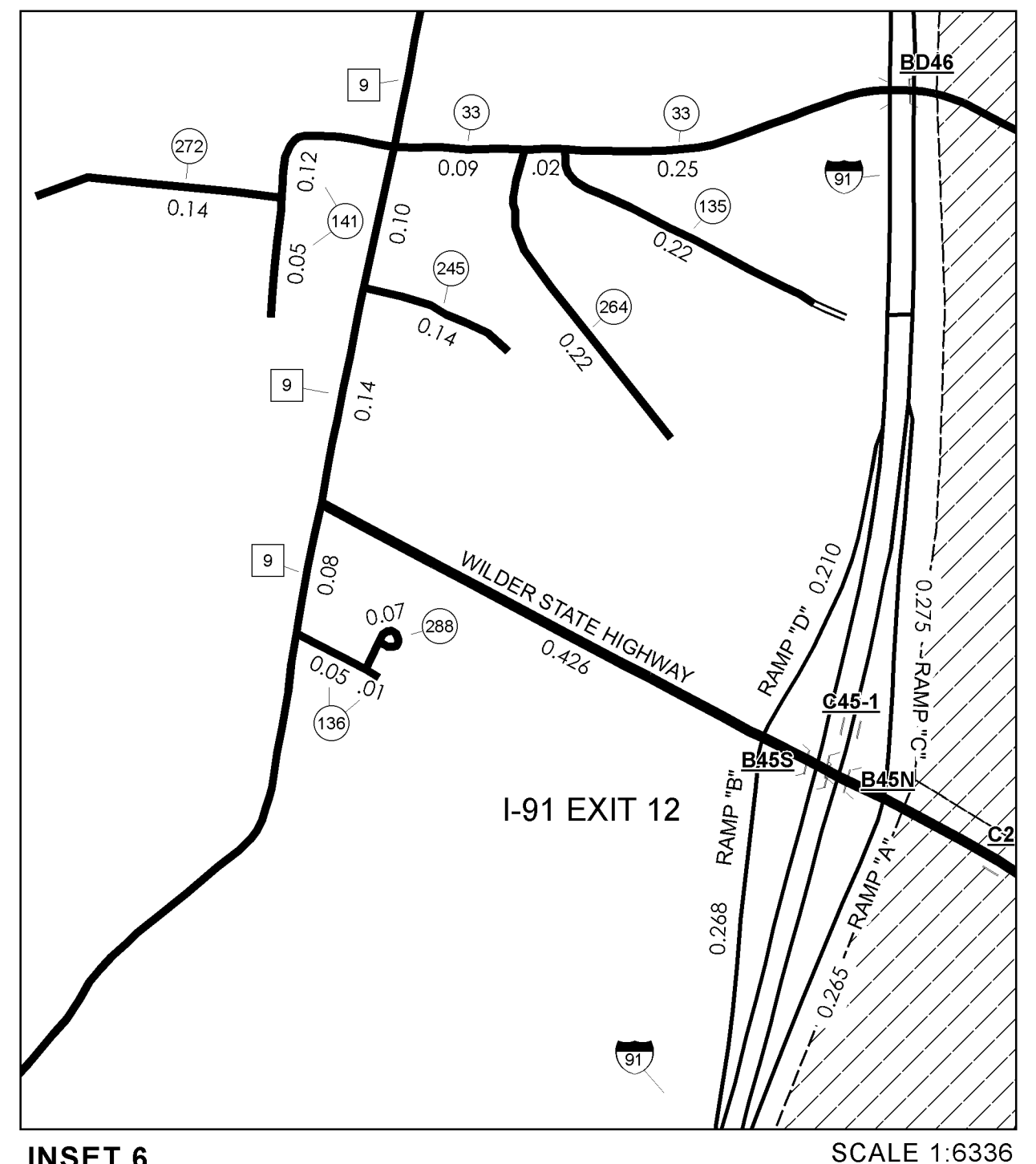
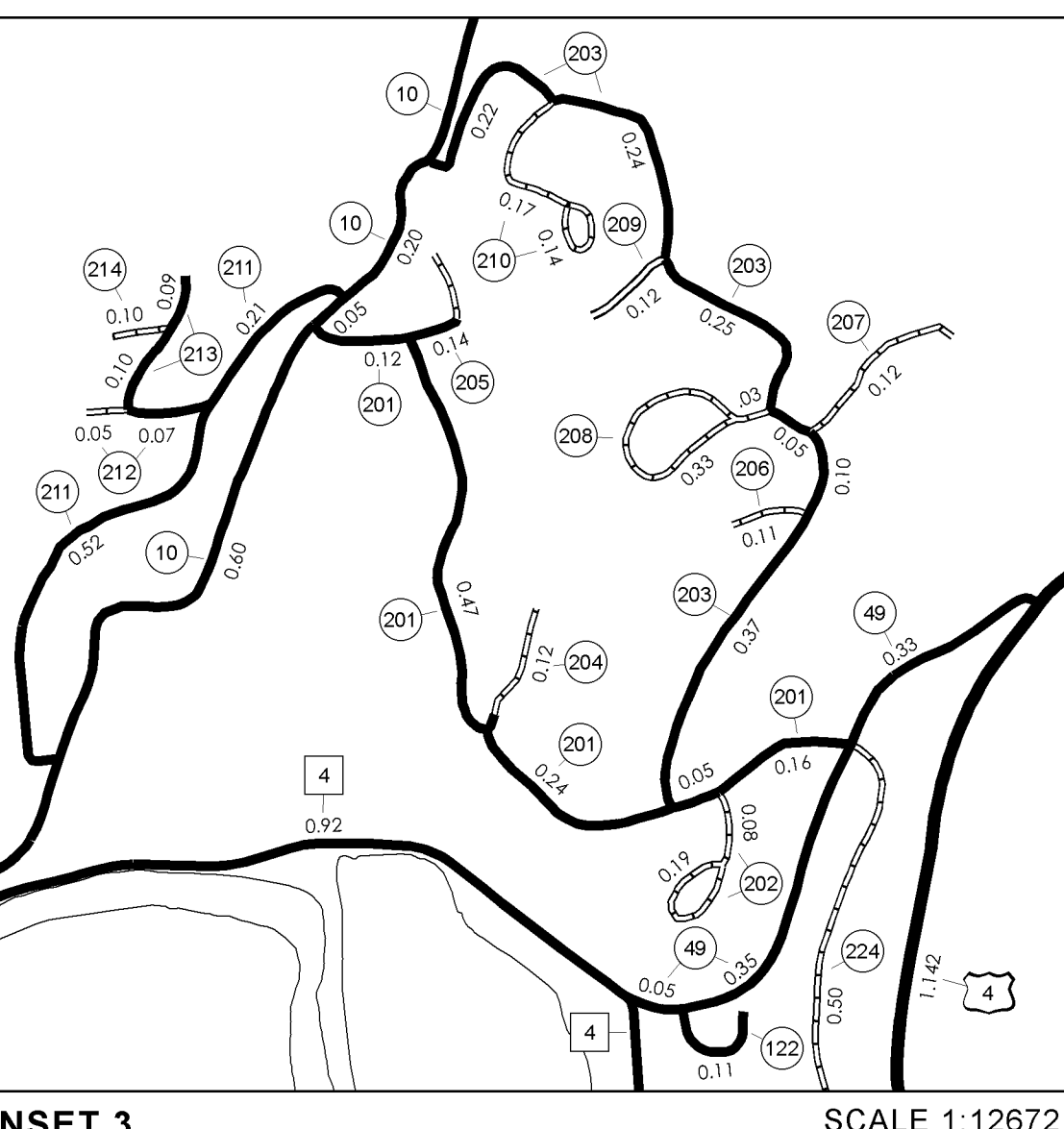
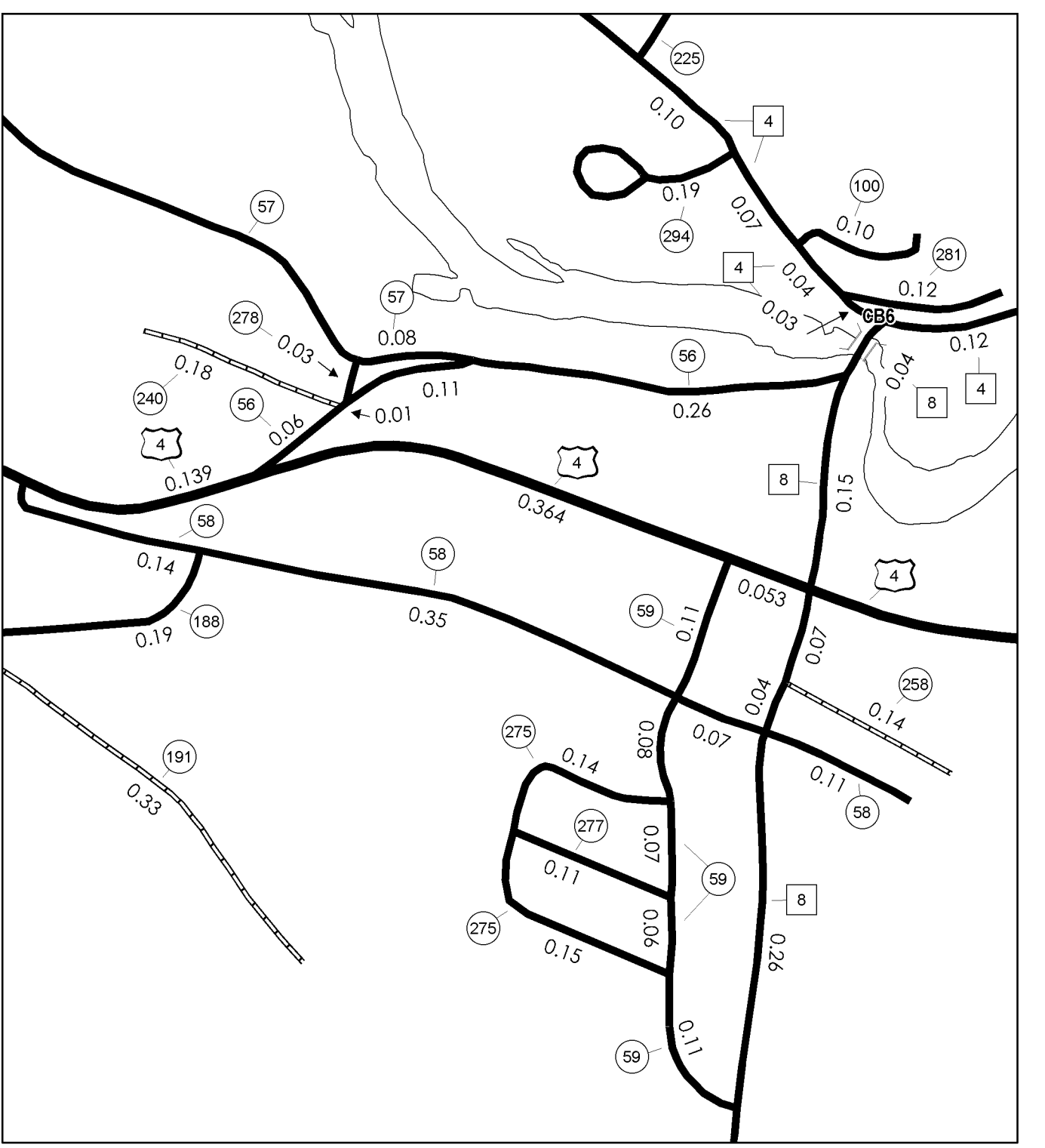
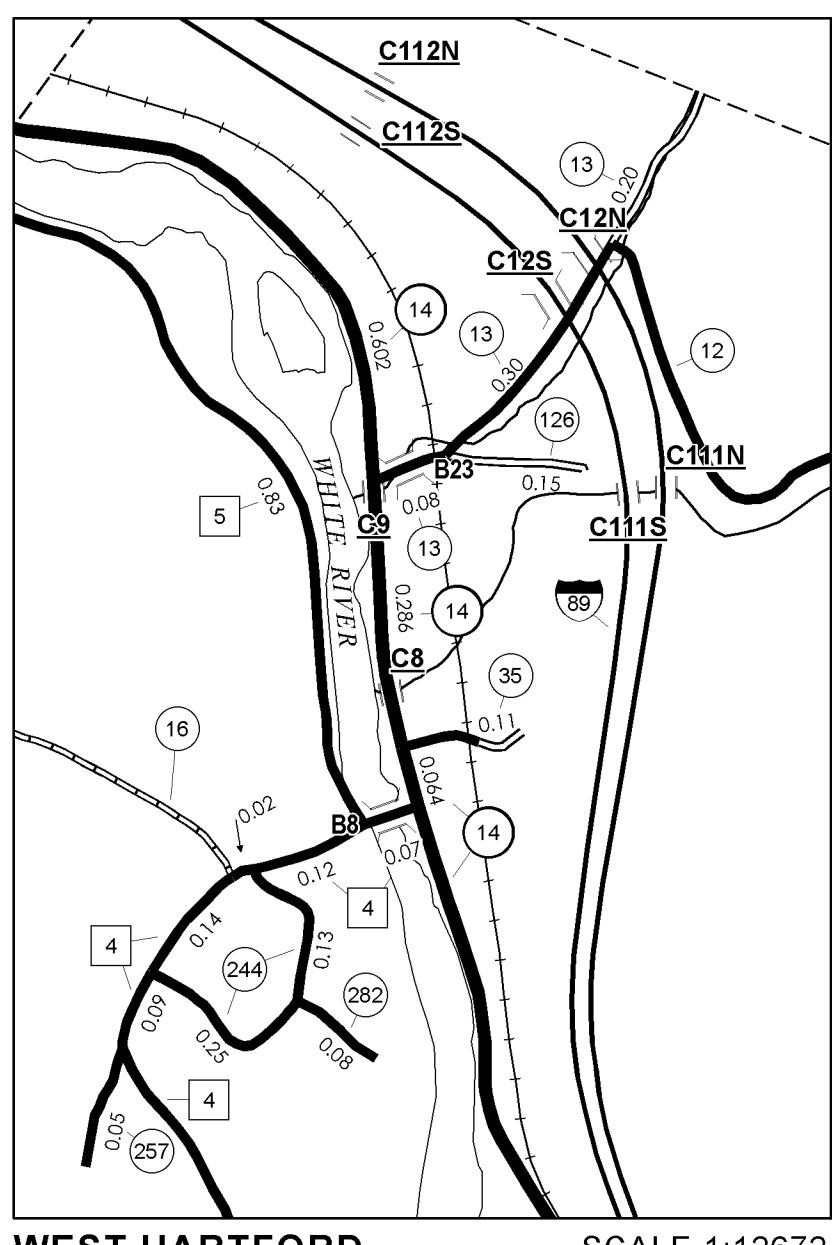

MILEAGE SUMMARY

CLASS 1		
TH-1	1,714	
TOTAL CLASS 1		1,714
CLASS 2		
TH-2	0,455	
TH-3	3,420	
TH-4	7,970	
TH-5	0,630	
TH-6	1,360	
TH-7	0,570	
TH-8	1,790	
TH-9	2,270	
TH-10	0,970	
TOTAL CLASS 2		19,635
CLASS 3		
TOTAL CLASS 3		108,500
TOTAL TOWN		129,849
STATE HIGHWAY		
VT-14	6,379	
QUECHEE STATE HIGHWAY	0,123	
WILDER STATE HIGHWAY	0,744	
TOTAL STATE HIGHWAY		7,246
US HIGHWAY		
US-4	9,354	
US-5	7,550	
TOTAL US HIGHWAY		16,904
US HIGHWAY - Ramp		
US-4	0,097	
TOTAL US HIGHWAY - Ramp		0,097
TOTAL STATE		24,247
INTERSTATE		
I-89	8,648	
I-91	6,465	
TOTAL INTERSTATE		15,113
INTERSTATE - Ramp		
I-89	1,132	
I-91	5,033	
TOTAL INTERSTATE - Ramp		6,165
TOTAL INTERSTATE		21,278

TOTAL, TRAVELED HIGHWAYS, FEB. 10, 2008: 175,374 (Excludes Class 4 and Legal Trail Mileage)

VERMONT GENERAL HIGHWAY MAP
Town of Hartford
 WINDSOR COUNTY
 Transportation District #4

Prepared by the
 Vermont Agency of Transportation
 Policy & Planning Division
 in cooperation with
 U.S. Department of Transportation
 Federal Highway Administration

Mileage as of: February 10, 2008
 Map generated: September, 2008

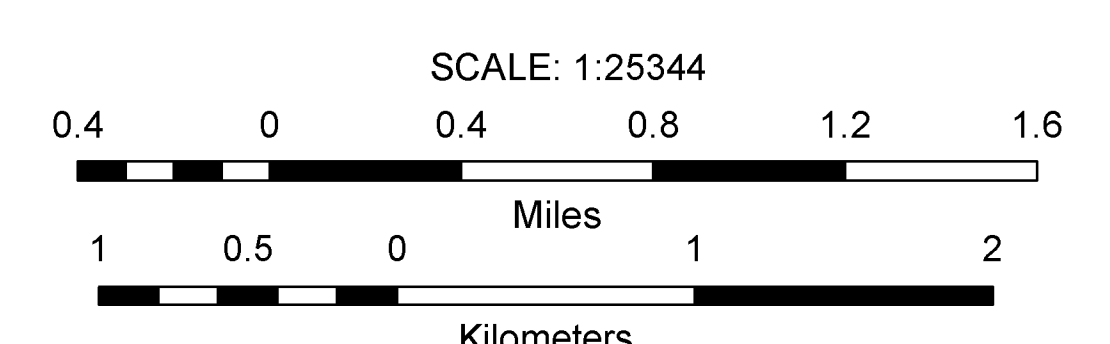

DISCLAIMER:
 The untraveled highways (laid-out town highways), discontinued highways, and legal trails shown hereon are those of which the Agency of Transportation has record; others may exist.
 Highway and bridge data by the Agency of Transportation, Policy & Planning Division. All other data from the Vermont Center for Geographic Information.

STRUCTURES - SURFACE WATER NOTE:
 Town short structures (bridges or culverts from 6-feet to less than 20-feet) were not represented due to inconsistencies in the data.
 The surface waters are from the Vermont Hydrological Dataset (VHD). Only the named streams are shown.

- HIGHWAYS**
- INTERSTATE
 - U.S. ROUTE
 - STATE ROUTE
 - CLASS 1
 - CLASS 2
 - CLASS 3
 - CLASS 4
 - LEGAL TRAIL
- POLITICAL SUBDIVISIONS**
- STATE BOUNDARY
 - COUNTY BOUNDARY
 - TOWN BOUNDARY
 - VILLAGE BOUNDARY
 - URBAN COMPACT
 - OPEN WATER
 - STREAM OR BROOK
- BRIDGE OR CULVERT**
- BRIDGE OR CULVERT GREATER THAN 20'
 - BRIDGE OR CULVERT 6' - 20'
 - B34 / C34 STATE BRIDGE OR CULVERT IDENTIFIER
 - B34 / C34 TOWN BRIDGE OR CULVERT IDENTIFIER
- FEDERAL CLASSIFICATION IDENTIFIER**
- FAU URBAN ARTERIAL OR COLLECTOR
 - MA MINOR ARTERIAL
 - MIC MAJOR COLLECTOR
 - MNC MINOR COLLECTOR
 - PA PRINCIPAL ARTERIAL