

**MILEAGE SUMMARY**

CLASS 2			
TH-1	4.830		
TH-2	5.100		
		TOTAL CLASS 2	9.930
CLASS 3		TOTAL CLASS 3	30.64
		<b>TOTAL TOWN</b>	<b>40.570</b>
STATE HIGHWAY			
VT-11	3.678		
VT-100	0.208		
		TOTAL STATE HIGHWAY	3.886
		<b>TOTAL STATE</b>	<b>3.886</b>

**TOTAL, TRAVELED HIGHWAYS, FEB. 10, 2014: 44.456**  
(Excludes Class 4, Legal Trail, and Unidentified Corridor Mileage)

TOWN HWY. No.	LENGTH IN MILES CLASS 3	TOWN HWY. No.	LENGTH IN MILES CLASS 4
4	1.00	34	1.90
5	0.45	35	0.60
6	0.24	36	2.28
7	0.65	37	1.18 (0.80)
8	0.40	38	0.07
9	1.07 (0.15)	39	0.68
10	0.43 (0.40)	40	0.07
11		41	0.08
12	3.30	43	0.69 (0.08)
13	0.86	44	0.61 (0.35)
14	0.48	45	0.12
15	0.50 (0.21)	46	
16	0.15	47	0.50
17	0.57	48	0.26
18	1.40 (1.26)	49	2.02
19	0.35	50	0.26
20	0.25 (0.09)	51	0.23
22	0.25	52	0.07
23	0.60	54	0.42
25	2.27	55	0.09
26	0.14	56	0.22
27	0.47 (0.08)	57	0.17
28	1.40	58	0.10
29	0.14	59	0.17
30	0.10	60	0.09
31	2.12 (0.05)	82	
32	0.08	83	0.48 (0.19)
33	0.35		
		<b>TOTAL</b>	<b>30.64 4.46</b>

TOWN HWY. No.	LENGTH IN MILES "NOT UP TO STANDARD"	LEGAL TRAIL No.	LENGTH IN MILES LEGAL TRAIL
9	(0.04)	1	(0.95)
19	(0.05)	2	(0.57)
32	(0.07)	3	(0.57)
		4	(2.38)
<b>TOTAL</b>	<b>0.16</b>	5	(0.99)
		6	(0.69)
		7	(0.14)
		8	(0.29)
		9	(0.25)
		10	(1.80)
		11	(0.13)
		12	(0.60)
		13	(0.43)
		14	(0.89)
		15	(0.76)
		16	(0.14)
		17	(0.50)
		18	(0.60)
		19	(0.27)
		20	(1.05)
		21	(0.20)
		22	(0.71)
		23	(0.69)
		24	(0.55)
		25	(0.54)
		26	(0.90)
		27	(1.27)
		<b>TOTAL</b>	<b>18.86</b>

\* The sections of the town highways listed above are legally Class 3, but have been deemed "Not Up To Standard" and are functionally Class 4 Town Highways

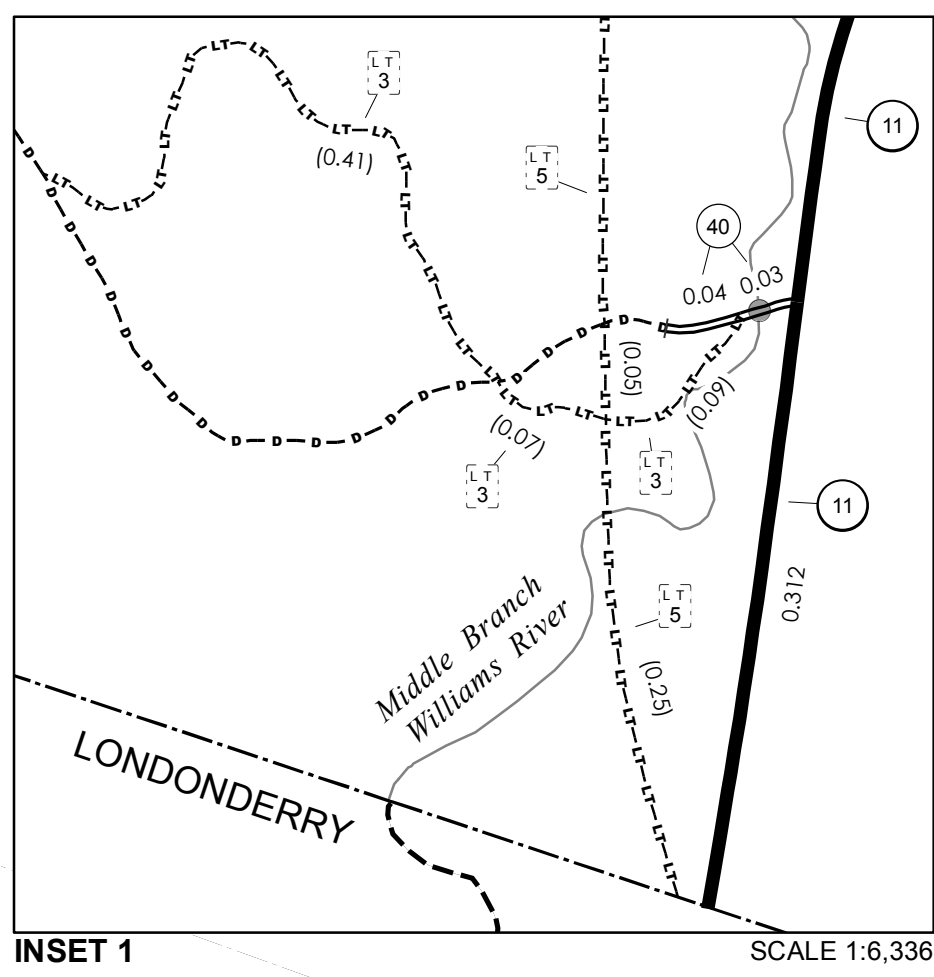

0 0.08 0.16 Miles

INSET 1

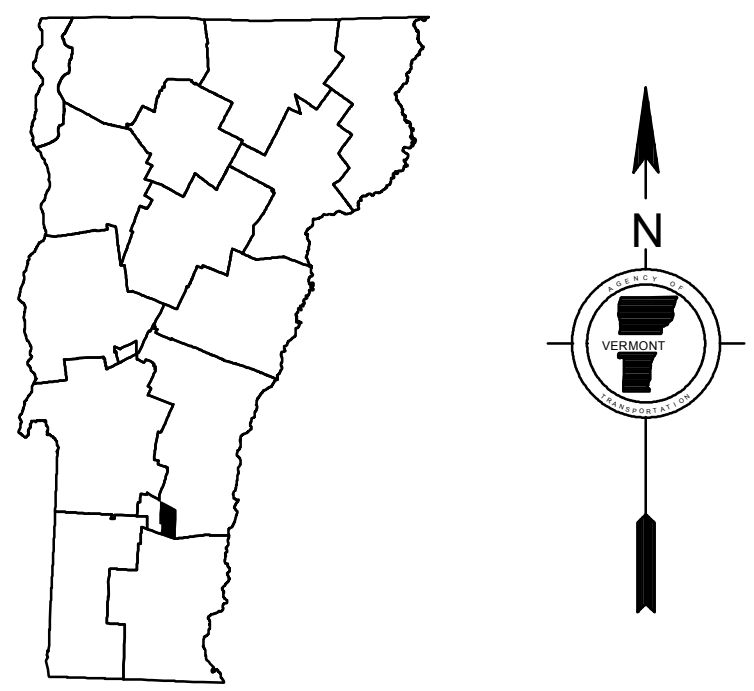

**VERMONT**  
**GENERAL HIGHWAY MAP**  
**Town of Andover**  
WINDSOR COUNTY  
Transportation District #2  
Prepared by the  
Vermont Agency of Transportation  
Division of Policy, Planning and Intermodal Development  
in cooperation with  
U.S. Department of Transportation  
Federal Highway Administration

Mileage as of February 10, 2014  
Map prepared October 06, 2014

SCALE 1:19,008

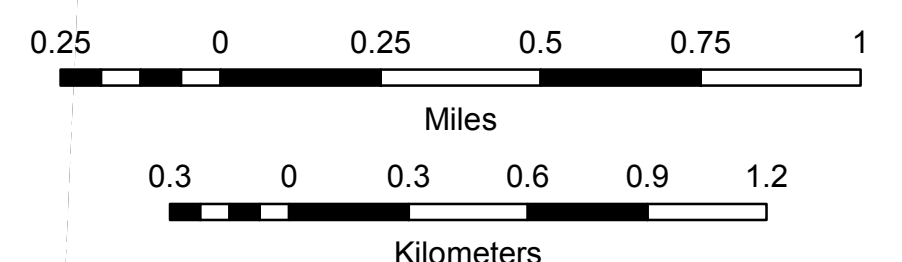

**DISCLAIMER:**  
The untraveled highways (laid-out town highways), discontinued highways, and legal trails herein are those of which the Agency of Transportation has record; others may exist.  
Highway and bridge data by the Agency of Transportation. Town short structures are drawn from the Vermont Online Bridge & Culvert Inventory Tool (VOBCIT) database. All other data from the Vermont Center for Geographic Information. Only named streams are shown.

Vermont State Plane Coordinate System  
North American Datum of 1983  
SPCS Zone Identifier: 4400  
Geodetic Reference System 80  
4,000-meter grid, Easting - Northing