

MILEAGE SUMMARY

| | | | |
|---------------|-------|---------------------|---------------|
| CLASS 2 | | | |
| TH-1 | 4.830 | | |
| TH-2 | 5.100 | | |
| | | TOTAL CLASS 2 | 9.930 |
| CLASS 3 | | | |
| | | TOTAL CLASS 3 | 30.64 |
| | | TOTAL TOWN | 40.570 |
| STATE HIGHWAY | | | |
| VT-11 | 3.678 | | |
| VT-100 | 0.208 | | |
| | | TOTAL STATE HIGHWAY | 3.886 |
| | | TOTAL STATE | 3.886 |

TOTAL, TRAVELED HIGHWAYS, FEB. 10, 2012: 44.456
(Excludes Class 4, Legal Trail, and Unidentified Corridor Mileage)

| TOWN HWY. No. | LENGTH IN MILES CLASS 3 | TOWN HWY. No. | LENGTH IN MILES CLASS 4 |
|---------------|-------------------------|---------------|-------------------------|
| 4 | 1.00 | 34 | 1.90 |
| 5 | 0.45 | 35 | 0.60 |
| 6 | 0.24 | 36 | 2.28 |
| 7 | 0.65 | 37 | 1.18 (0.80) |
| 8 | 0.40 | 38 | 0.07 |
| 9 | 1.07 (0.15) | 39 | 0.68 |
| 10 | 0.43 | 40 | 0.07 |
| 11 | (0.40) | 41 | 0.08 |
| 12 | 3.30 | 43 | 0.69 (0.08) |
| 13 | 0.86 | 44 | 0.35 (0.35) |
| 14 | 0.48 | 45 | 0.12 |
| 15 | 0.50 (0.21) | 46 | (0.32) |
| 16 | 0.15 | 47 | 0.50 |
| 17 | 0.57 | 48 | 0.26 |
| 18 | (1.26) | 49 | 2.02 |
| 19 | 0.35 (0.09) | 50 | 0.26 |
| 20 | 0.25 | 51 | 0.23 |
| 22 | 0.25 | 52 | 0.07 |
| 23 | 0.60 | 54 | 0.42 |
| 25 | 2.27 | 55 | 0.09 |
| 26 | 0.14 | 56 | 0.22 |
| 27 | 0.47 (0.08) | 57 | 0.17 |
| 28 | 1.40 | 58 | 0.10 |
| 29 | 0.14 | 59 | 0.17 |
| 30 | 0.10 | 60 | 0.09 |
| 31 | 2.12 (0.05) | 82 | (0.19) |
| 32 | 0.08 | 83 | (0.48) |
| 33 | 0.35 | | |
| | TOTAL | 30.64 | 4.46 |

| TOWN HWY. No. | LENGTH IN MILES "NOT UP TO STANDARD" | LEGAL TRAIL No. | LENGTH IN MILES LEGAL TRAIL |
|---------------|--------------------------------------|-----------------|-----------------------------|
| 9 | (0.04) | 1 | (0.95) |
| 19 | (0.05) | 2 | (0.57) |
| 32 | (0.07) | 3 | (0.57) |
| | | 4 | (2.38) |
| | | 5 | (0.99) |
| | | 6 | (0.69) |
| | | 7 | (0.14) |
| | | 8 | (0.29) |
| | | 9 | (0.25) |
| | | 10 | (1.80) |
| | | 11 | (0.13) |
| | | 12 | (0.60) |
| | | 13 | (0.43) |
| | | 14 | (0.89) |
| | | 15 | (0.76) |
| | | 16 | (0.14) |
| | | 17 | (0.50) |
| | | 18 | (0.60) |
| | | 19 | (0.27) |
| | | 20 | (1.05) |
| | | 21 | (0.20) |
| | | 22 | (0.71) |
| | | 23 | (0.69) |
| | | 24 | (0.55) |
| | | 25 | (0.54) |
| | | 26 | (0.90) |
| | | 27 | (1.27) |
| | TOTAL | 18.86 | |

* The sections of the town highways listed above are legally Class 3, but have been deemed "Not Up To Standard" and are functionally Class 4 Town Highways

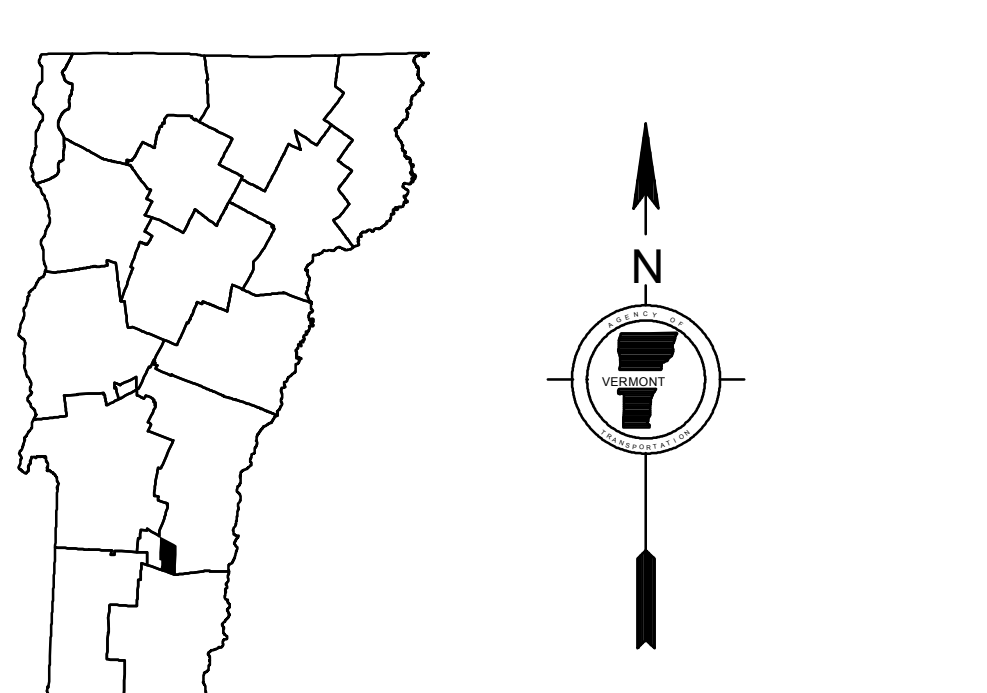
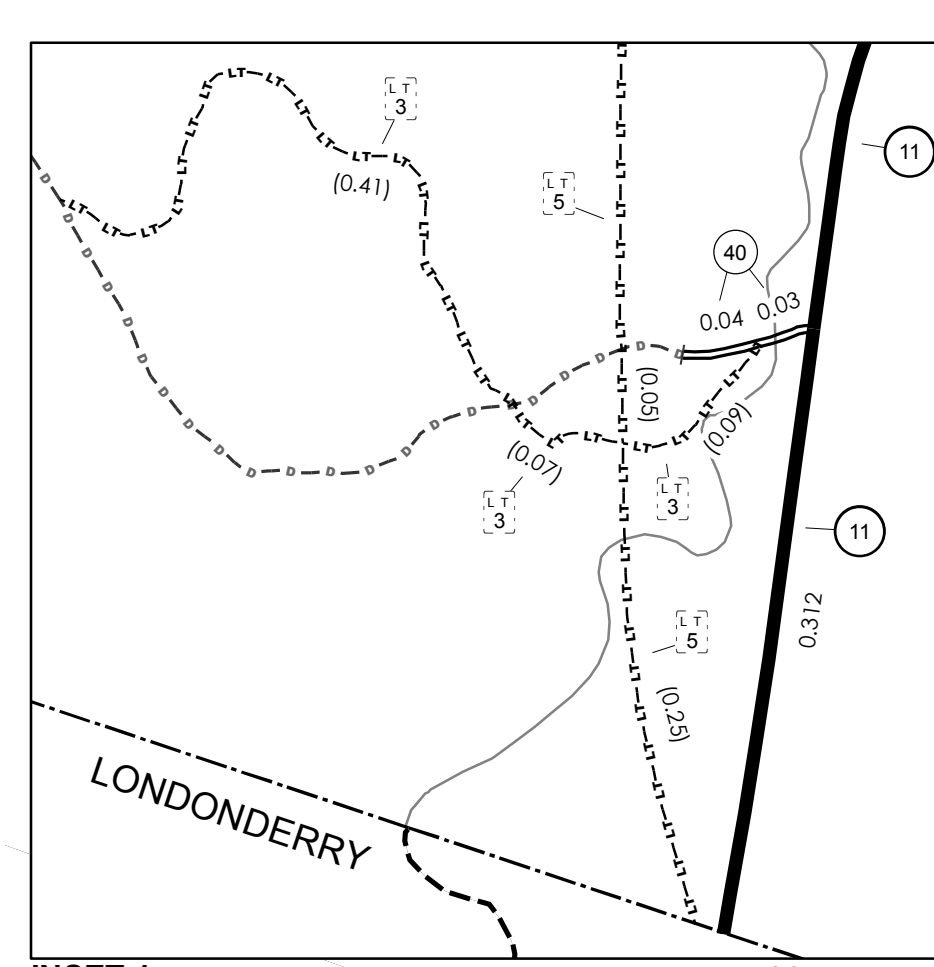

VERMONT
GENERAL HIGHWAY MAP
Town of Andover
WINDSOR COUNTY
Transportation District #2
Prepared by the
Vermont Agency of Transportation
Division of Policy, Planning and Intermodal Development
in cooperation with
U.S. Department of Transportation
Federal Highway Administration

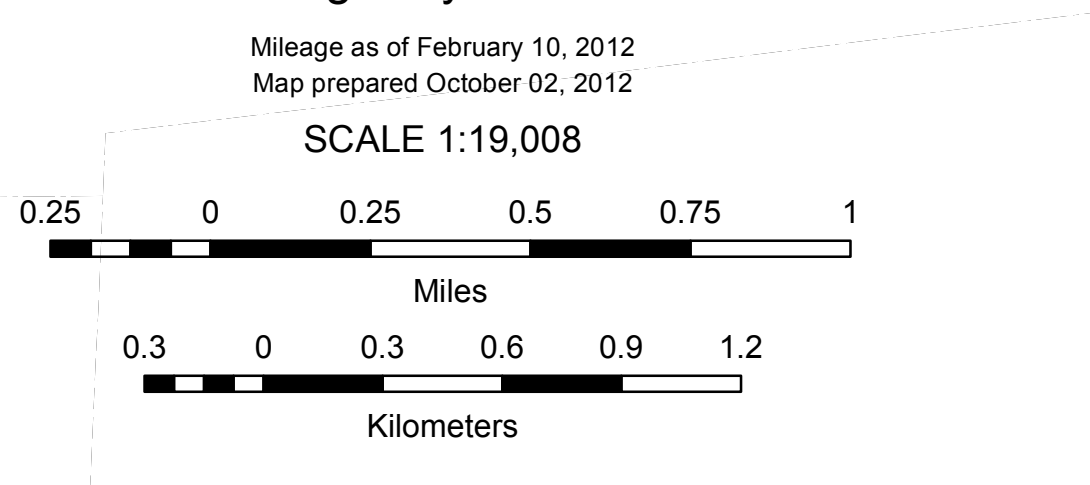

DISCLAIMER:
The untraveled highways (laid-out town highways), discontinued highways, and legal trails hereon are those of which the Agency of Transportation has record; others may exist.

Highway and bridge data by the Agency of Transportation. All other data from the Vermont Center for Geographic Information. Only named streams are shown.

Vermont State Plane Coordinate System
North American Datum of 1983
SPCS Zone Identifier: 4400
Geodetic Reference System 80
4,000-meter grid, Easting - Northing