

TOWN HWY. No.	CLASS 3	CLASS 4	TOWN HWY. No.	CLASS 3	CLASS 4
4	1.84		42	0.14	
5	0.80		43	0.66	
6	2.14		44	0.12	
7	1.58		45	0.07	
9		(0.65)	46	0.14	
10	1.54		47	0.25	
11	0.92		48	0.08	
12	0.08	(0.27)	49	1.51	
13	0.29	(1.04)	50	0.21	
14	0.42	(0.78)	51	0.28	
15	0.12		52	0.84	
16	0.53		53	0.21	
17	0.55		54	0.57	
18	3.28		55	0.14	
20	2.83		56	0.57	
21	0.11		57	0.46	
22	0.39	(0.66)	58	0.21	
23		(0.40)	59	0.55	
24	1.01		60	0.46	
25	0.78		61	0.26	
26	1.74	(0.46)	62	0.19	
27	0.11		63	0.28	
29	0.12		64	0.20	
30	2.55		65	0.09	
31	0.45		67	0.10	
32		(1.94)	68	0.43	
33	1.70		69	0.20	
34	1.53		70	0.05	
36	0.29		71		(0.06)
37	0.10		72	0.71	
38	0.10		73	0.54	
39	1.49		74	0.18	
41	0.09		TOTAL	40.18	6.26

LEGAL TRAIL No.	LENGTH IN MILES	TOWN HWY. No.	LENGTH IN MILES "NOT UP TO STANDARD"
1	(0.64)	46	(0.07)
2	(1.72)	TOTAL	0.07
TOTAL	2.36		

MILEAGE SUMMARY			
CLASS 2			
TH-1	1.210		
TH-2	5.150		
TOTAL CLASS 2		6.360	
CLASS 3			
TOTAL CLASS 3		40.18	
TOTAL TOWN		46.540	
STATE HIGHWAY			
VT-100	7.373		
TOTAL STATE HIGHWAY		7.373	
TOTAL STATE		7.373	

**TOTAL, TRAVELED HIGHWAYS, FEB. 10, 2026: 53.913**  
(Excludes Class 4 and Legal Trail Mileage)

- HIGHWAYS**
- INTERSTATE OR DIVIDED HIGHWAY
  - STATE - HARD SURFACE OR PAVED
  - TOWN - HARD SURFACE OR PAVED
  - GRAVEL
  - SOIL OR GRADED AND DRAINED EARTH
  - UNIMPROVED OR PRIMITIVE
  - IMPASSABLE OR UNTRAVELED
  - LEGAL TRAIL
  - DISCONTINUED
  - HIGHWAY CLASS CHANGE
  - RAILROAD
  - INACTIVE RAILROAD
  - PUBLIC LAND - NATIONAL FOREST
  - PUBLIC LAND - STATE/MUNICIPAL
  - NFR NATIONAL FOREST ROAD
  - ACE ARMY CORPS OF ENGINEERS
  - USGH UNITED STATES GOV. HWY.

- POLITICAL SUBDIVISIONS**
- STATE BOUNDARY
  - COUNTY BOUNDARY
  - TOWN BOUNDARY
  - VILLAGE BOUNDARY
  - URBAN COMPACT BOUNDARY
  - WATER BODY
  - STREAM OR BROOK
- BRIDGE OR CULVERT**
- BRIDGE OR CULVERT > 20'
  - BRIDGE OR CULVERT 6' - 20'
  - BIKE PATH STRUCTURE
  - VTCULVERTS BRIDGE
  - VTCULVERTS CULVERT > 6'
- FEDERAL CLASSIFICATION IDENTIFIER**
- MA MINOR ARTERIAL
  - MJC MAJOR COLLECTOR
  - MNC MINOR COLLECTOR
  - PA PRINCIPAL ARTERIAL

**DISCLAIMER:**  
 The untraveled highways (laid-out town highways), discontinued highways, and legal trails hereon are those of which the Agency of Transportation has record, others may exist.

Highway and bridge data by the Agency of Transportation. Town short structures drawn from the VTCULVERTS (formerly VOBCIT) online database. All other data from the Vermont Open Geodata Portal. Only named streams shown.

Accessibility Statement: The Agency of Transportation is committed to ensuring accessibility and digital accessibility for all. If you need language assistance, reasonable accommodation, or alternative format, please email johnathan.croft@vermont.gov.

Vermont State Plane Coordinate System  
 North American Datum of 1983  
 SPCS\_Zone\_Identifier: 4400  
 Geodetic Reference System 80  
 4,000-meter grid, Easting - Northing

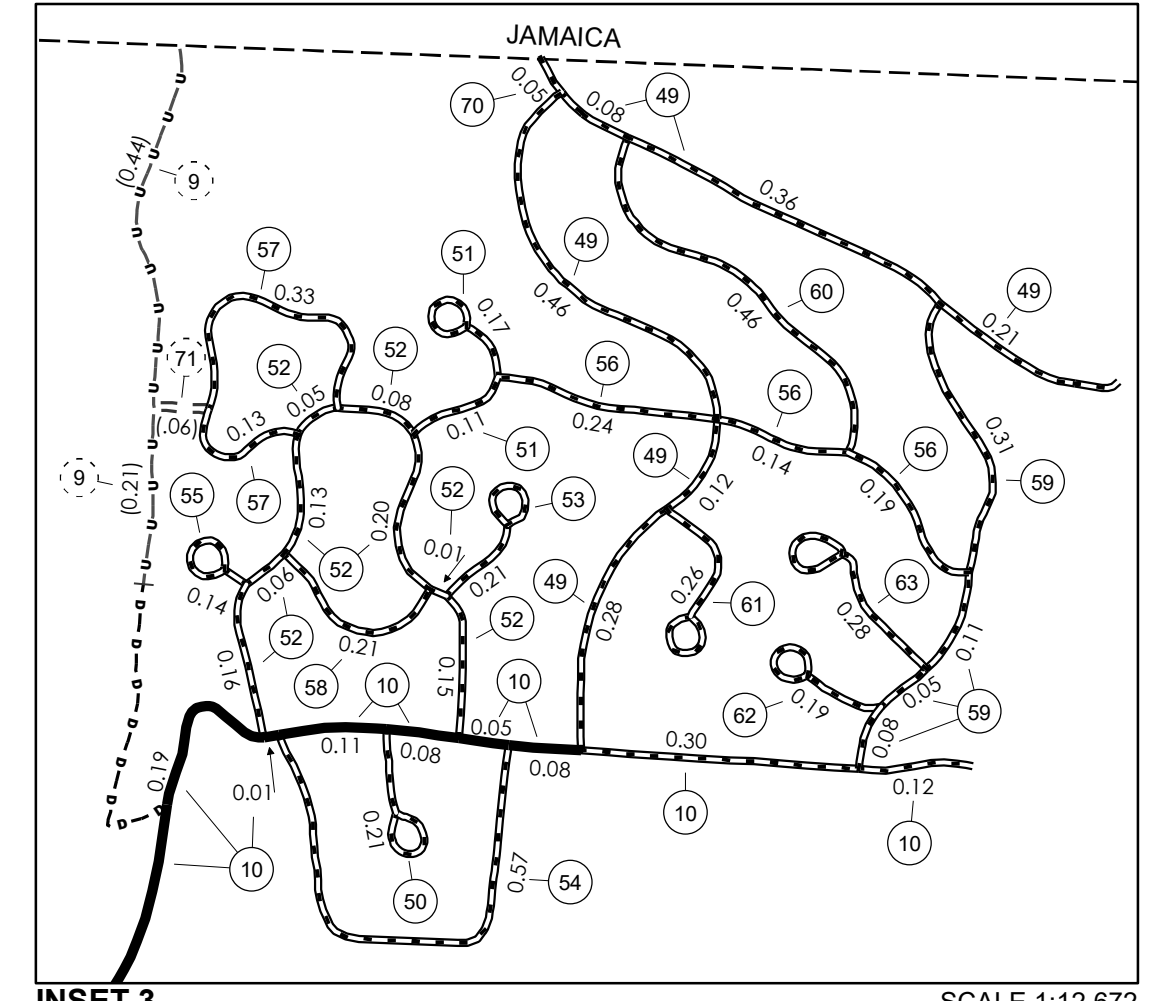

0 0.15 0.3 Miles

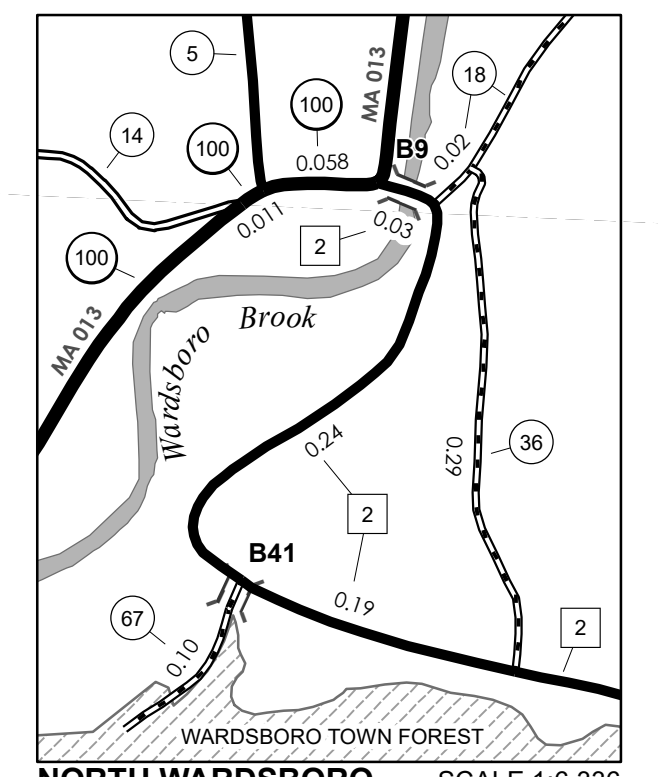

0 0.08 0.16 Miles

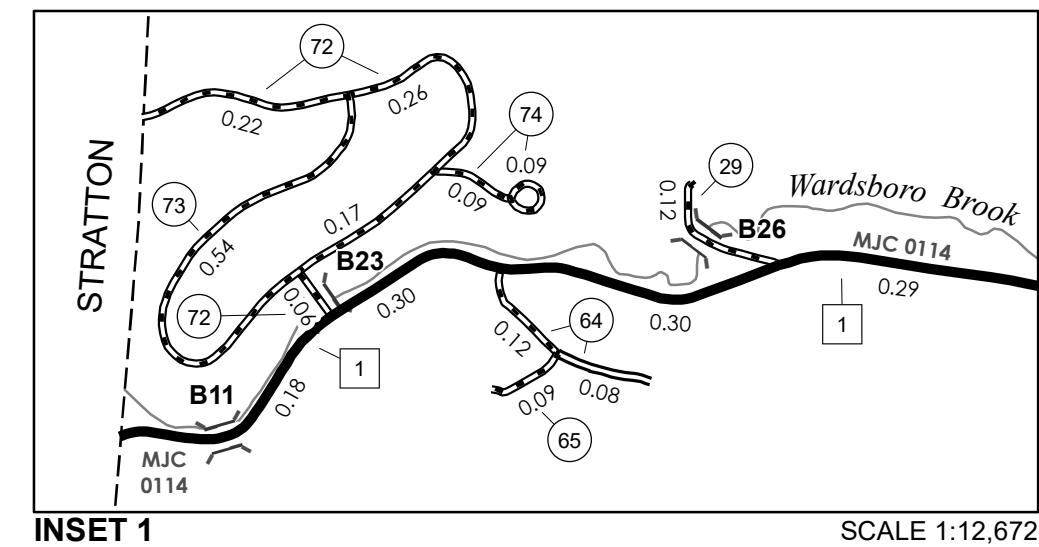

0 0.15 0.3 Miles

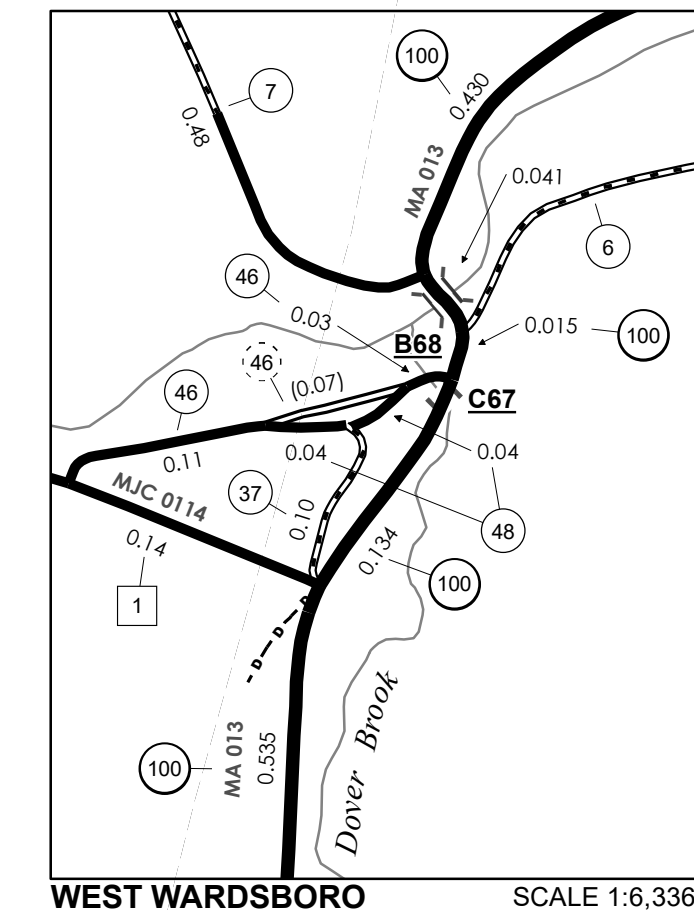

0 0.08 0.16 Miles

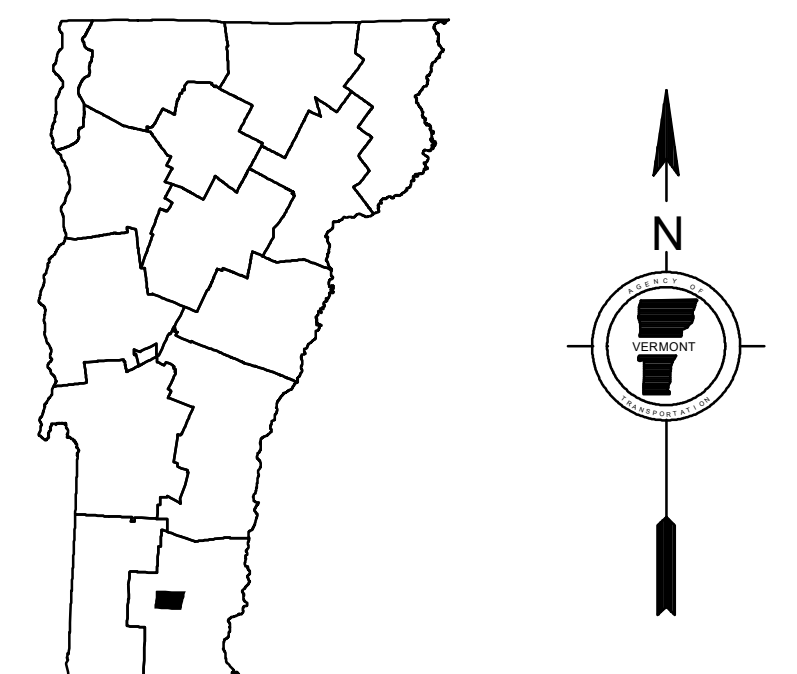

**VERMONT GENERAL HIGHWAY MAP**  
**Town of Wardsboro**  
 WINDHAM COUNTY  
 Transportation District #2  
 Prepared by the Vermont Agency of Transportation Highway Division in cooperation with U.S. Department of Transportation Federal Highway Administration

