

TOWN HWY. No.	LENGTH IN MILES CLASS 3	LENGTH IN MILES CLASS 4	TOWN HWY. No.	LENGTH IN MILES CLASS 3	LENGTH IN MILES CLASS 4
4	1.84		41	0.09	
5	0.80		42	0.14	
6	2.14		43	0.66	
7	1.58		44	0.12	
9		(0.65)	45	0.07	
10	1.54		46	0.22	
11	0.92		47	0.25	
12	0.08	(0.27)	48	0.08	
13	0.29	(1.04)	49	1.51	
14	0.42	(0.78)	50	0.21	
15	0.12		51	0.28	
16	0.53		52	0.84	
17	0.55		53	0.21	
18	3.28		54	0.57	
20	2.83		55	0.14	
21	0.11		56	0.57	
22	0.39	(0.66)	57	0.46	
23		(0.40)	58	0.21	
24	1.01		59	0.55	
25	0.78		60	0.46	
26	1.74	(0.46)	61	0.26	
27	0.11		62	0.19	
29	0.12		63	0.28	
30	2.55		64	0.20	
31	0.45		65	0.09	
32		(1.94)	67	0.10	
33	1.70		68	0.43	
34	1.53		69	0.20	
35		(0.25)	70	0.05	
36	0.29		71		(0.06)
37	0.10		72	0.71	
38	0.10		73	0.54	
39	1.49		74	0.18	
40	0.03		TOTAL	40.29	6.51

LEGAL TRAIL No.	LENGTH IN MILES LEGAL TRAIL
1	(0.64)
2	(1.72)
TOTAL	2.36

MILEAGE SUMMARY	
CLASS 2	
TH-1	1.210
TH-2	5.150
TOTAL CLASS 2	6.360
CLASS 3	
TOTAL CLASS 3	40.29
TOTAL TOWN	46.650
STATE HIGHWAY VT-100	7.373
TOTAL STATE HIGHWAY	7.373
TOTAL STATE	7.373

TOTAL, TRAVELED HIGHWAYS, FEB. 10, 2014: 54.023
 (Excludes Class 4, Legal Trail, and Unidentified Corridor Mileage)

- HIGHWAYS**
- INTERSTATE OR DIVIDED HIGHWAY
 - INTERSTATE
 - U.S. ROUTE
 - STATE ROUTE
 - CLASS 1
 - CLASS 2
 - CLASS 3
 - CLASS 4
 - LEGAL TRAIL
- GRVEL
- SOIL OR GRADED AND DRAINED EARTH
- UNIMPROVED OR PRIMITIVE
- IMPASSABLE OR UNTRAVELED
- LEGAL TRAIL
- DISCONTINUED
- HIGHWAY CLASS CHANGE
- RAILROAD
- INACTIVE RAILROAD
- NFR NATIONAL FOREST ROAD
- SFH STATE FOREST HIGHWAY
- P PARK AND RIDE

- PUBLIC LAND - GREEN MOUNTAIN NATIONAL FOREST
- PUBLIC LAND - STATE/MUNICIPAL
- POLITICAL SUBDIVISIONS**
- STATE BOUNDARY
 - COUNTY BOUNDARY
 - TOWN BOUNDARY
 - VILLAGE BOUNDARY
 - URBAN COMPACT BOUNDARY
 - WATER BODY
 - STREAM OR BROOK
- BRIDGE OR CULVERT**
- BRIDGE OR CULVERT > 20'
 - BRIDGE OR CULVERT 6' - 20'
 - VOBICIT BRIDGE
 - VOBICIT CULVERT > 6'
- B34 / C34 STATE BRIDGE OR CULVERT IDENTIFIER**
- B34 / C34 TOWN BRIDGE OR CULVERT IDENTIFIER**

- FEDERAL CLASSIFICATION IDENTIFIER**
- FAU URBAN ARTERIAL OR COLLECTOR
 - MA MINOR ARTERIAL
 - MJC MAJOR COLLECTOR
 - MNC MINOR COLLECTOR
 - PA PRINCIPAL ARTERIAL

DISCLAIMER:
 The untraveled highways (laid-out town highways), discontinued highways, and legal trails hereon are those of which the Agency of Transportation has record; others may exist.

Highway and bridge data by the Agency of Transportation. Town short structures are drawn from the Vermont Online Bridge & Culvert Inventory Tool (VOBCIT) database. All other data from the Vermont Center for Geographic Information. Only named streams are shown.

Vermont State Plane Coordinate System
 North American Datum of 1983
 SPCS_Zone_Identifier: 4400
 Geodetic Reference System 80
 4,000-meter grid, Easting - Northing

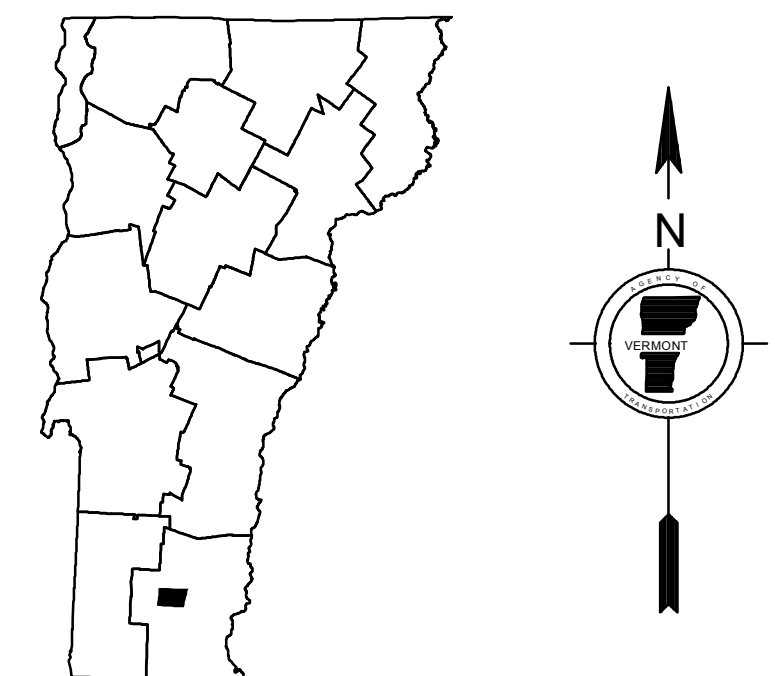
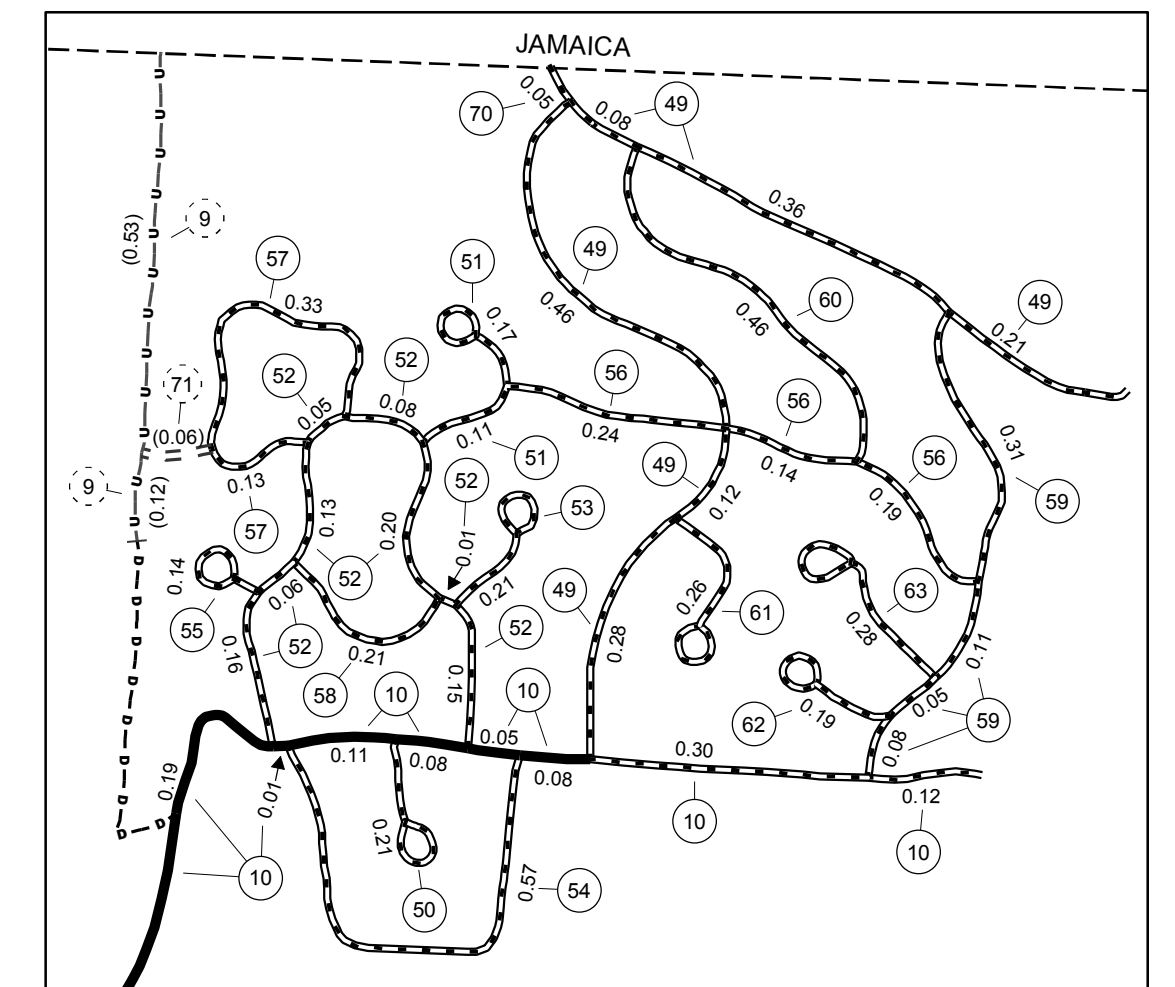
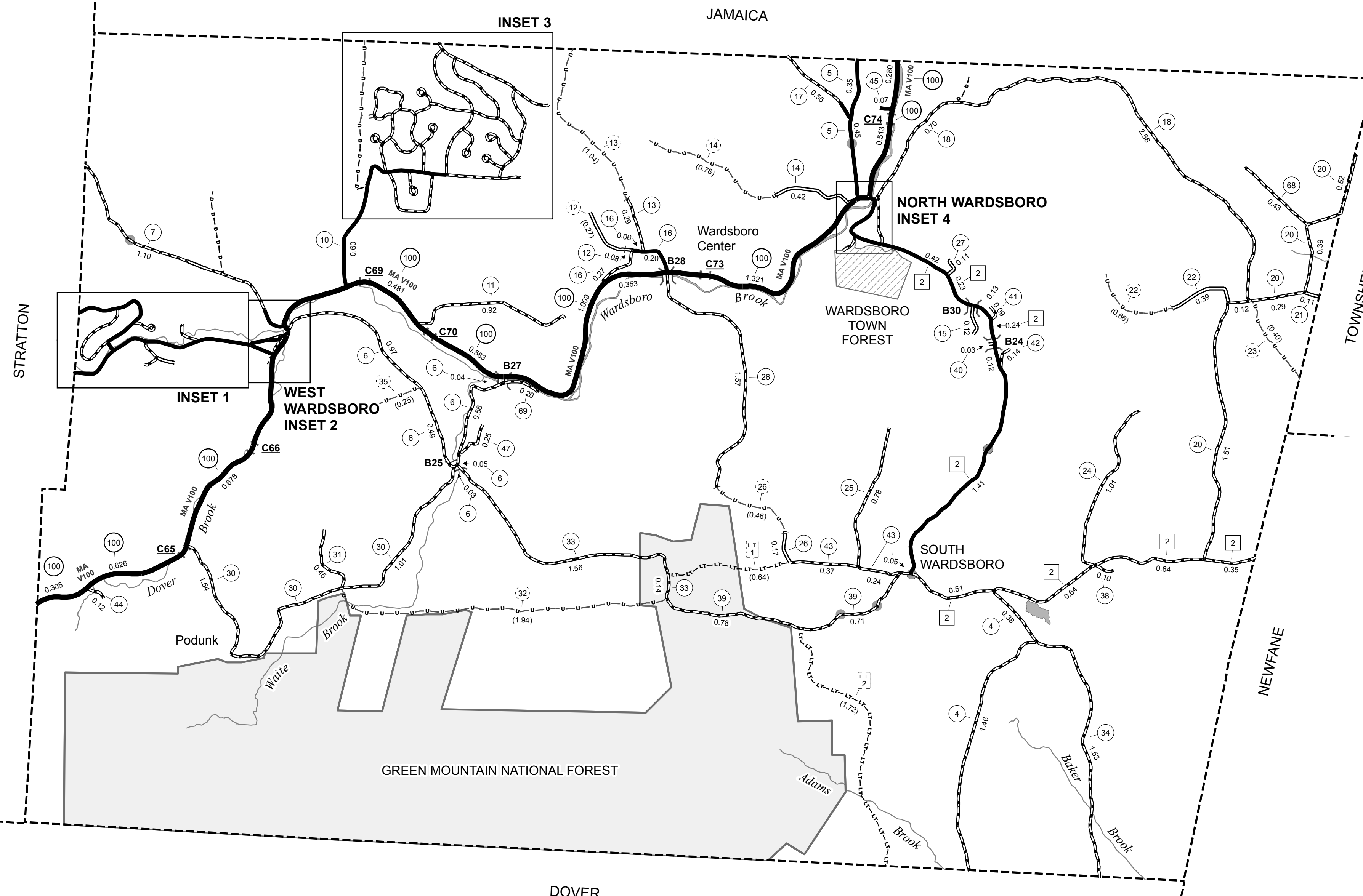

VERMONT
GENERAL HIGHWAY MAP
Town of Wardsboro

WINDHAM COUNTY
 Transportation District #2

Prepared by the
 Vermont Agency of Transportation
 Division of Policy, Planning and Intermodal Development
 in cooperation with
 U.S. Department of Transportation
 Federal Highway Administration

Mileage as of February 10, 2014
 Map prepared October 07, 2014

SCALE 1:25,344

