

TOWN HWY. NO.	CLASS 3	CLASS 4	LENGTH IN MILES	LEGAL TRAIL NO.	LENGTH IN MILES
4	1.840		40	0.030	
5	0.800		41	0.090	1 (0.640)
6	2.140		42	0.140	2 (1.720)
7	1.580		43	0.660	
8	0.210		44	0.120	
9		(0.240)	45	0.070	
10	1.540	(0.650)	46	0.220	
11	0.920		47	0.250	
12	0.080	(0.270)	48	0.080	
13	0.290	(1.040)	49	1.510	
14	0.420	(0.780)	50	0.210	
15	0.120		51	0.280	
16	0.530		52	0.840	
17	0.550		53	0.210	
18	3.280		54	0.570	
20	2.830		56	0.570	
21	0.110		57	0.460	
22	0.390	(0.660)	58	0.210	
23		(0.400)	59	0.550	
24	1.010		60	0.460	
25	0.780		61	0.260	
26	1.670	(0.530)	62	0.190	
27	0.110		63	0.280	
29	0.120		64	0.200	
30	2.550		65	0.090	
31	0.450		67	0.100	
32	1.700	(1.940)	68	0.430	
33	1.530		69	0.200	
34			70	0.050	
35		(0.250)	71		(0.060)
36	0.290		72	0.710	
37	0.100		73	0.540	
38	0.100		74	0.180	
39	1.490		TOTAL	40.430	6.820

\* This portion of town highway is Class 3, but is functionally Class 4

MILEAGE SUMMARY		
CLASS 2		
TH-1	1.210	
TH-2	5.150	
TOTAL CLASS 2	6.360	
CLASS 3		
TOTAL CLASS 3	40.430	
TOTAL TOWN	46.790	
STATE HIGHWAY		
VT-100	7.373	
TOTAL STATE HIGHWAY	7.373	
TOTAL STATE	7.373	

**TOTAL, TRAVELED HIGHWAYS, FEB. 10, 2007: 54.163**  
(Excludes Class 4 and Legal Trail Mileage)

- HIGHWAYS**
- INTERSTATE
- U.S. ROUTE
- STATE ROUTE
- CLASS 1
- CLASS 2
- CLASS 3
- CLASS 4
- LEGAL TRAIL
- INTERSTATE OR DIVIDED HIGHWAY
- STATE - HARD SURFACE OR PAVED
- TOWN - HARD SURFACE OR PAVED
- GRAVEL
- SOIL OR GRADED AND DRAINED EARTH
- UNIMPROVED OR PRIMITIVE
- IMPASSABLE OR UNTRAVELED
- LEGAL TRAIL
- DISCONTINUED
- HIGHWAY CLASS CHANGE
- RAILROAD
- FEDERAL CLASSIFICATION IDENTIFIER
- FAU URBAN ARTERIAL OR COLLECTOR
- MA MINOR ARTERIAL
- MJC MAJOR COLLECTOR
- MNC MINOR COLLECTOR
- PA PRINCIPAL ARTERIAL
- PUBLIC LAND
- POLITICAL SUBDIVISIONS
- STATE BOUNDARY
- COUNTY BOUNDARY
- TOWN BOUNDARY
- VILLAGE BOUNDARY
- URBAN COMPACT BOUNDARY
- WATER BODIES
- OPEN WATER
- SWAMP
- STREAM OR BROOK
- BRIDGE OR CULVERT
- BRIDGE OR CULVERT GREATER THAN 20'
- BRIDGE OR CULVERT 6' - 20'
- B34 STATE BRIDGE IDENTIFIER
- B34 TOWN BRIDGE IDENTIFIER

**DISCLAIMER:**  
The untraveled highways (laid-out town highways), discontinued highways, and legal trails shown hereon are those of which the Agency of Transportation has record; others may exist.  
Highway and bridge data by the Agency of Transportation, Policy & Planning Division. All other data from the Vermont Center for Geographic Information.

Vermont State Plane Coordinate System  
North American Datum of 1983  
SPCS\_Zone\_Identifier: 4400  
Geodetic Reference System 80  
4,000-meter grid, Easting - Northing

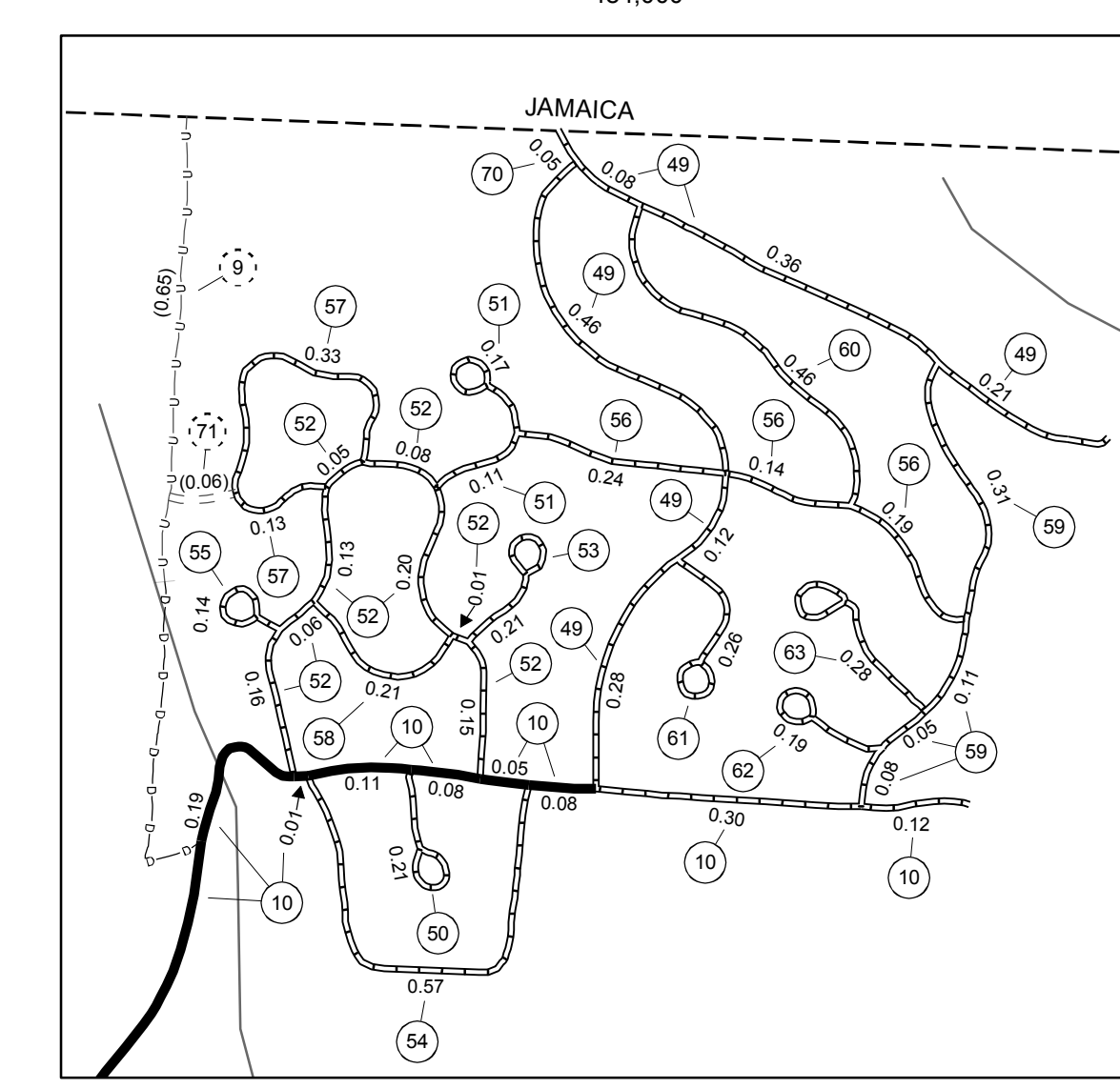
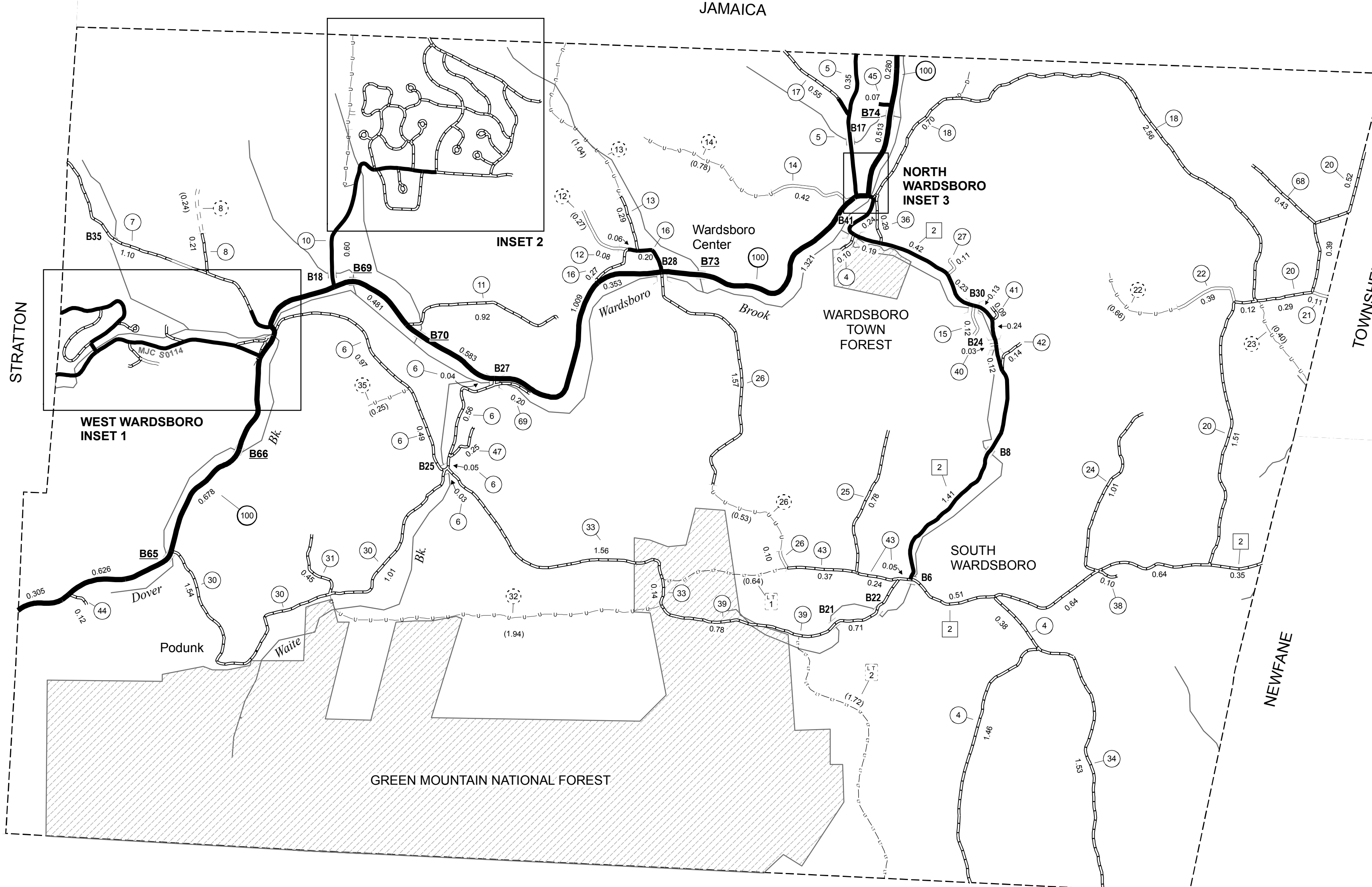

INSET 2 SCALE 1:12672

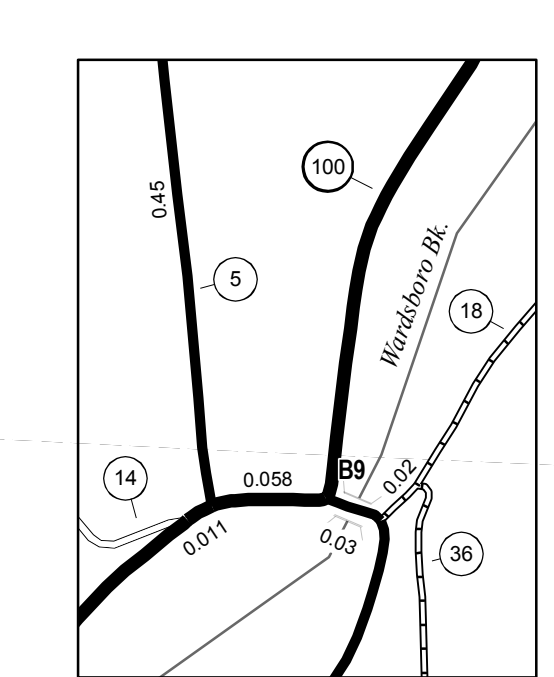

NORTH WARDSBORO INSET 3 SCALE 1:6336

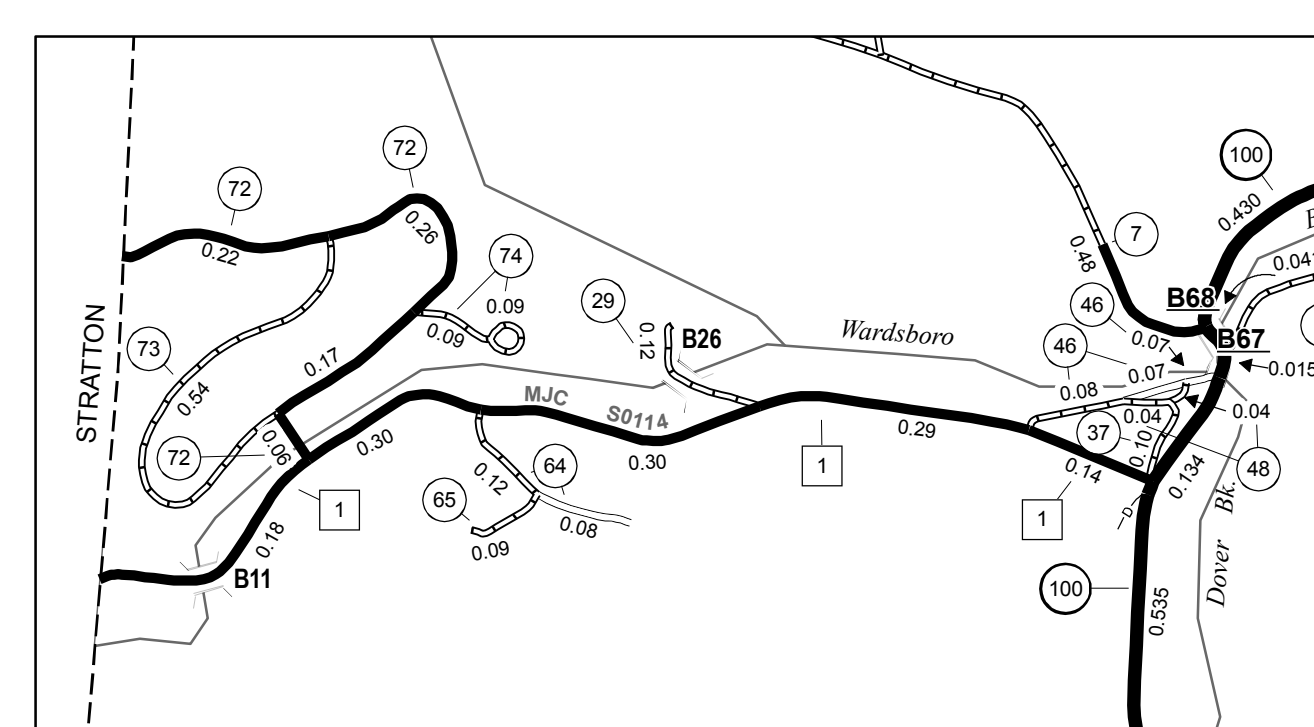

WEST WARDSBORO INSET 1 SCALE 1:12672

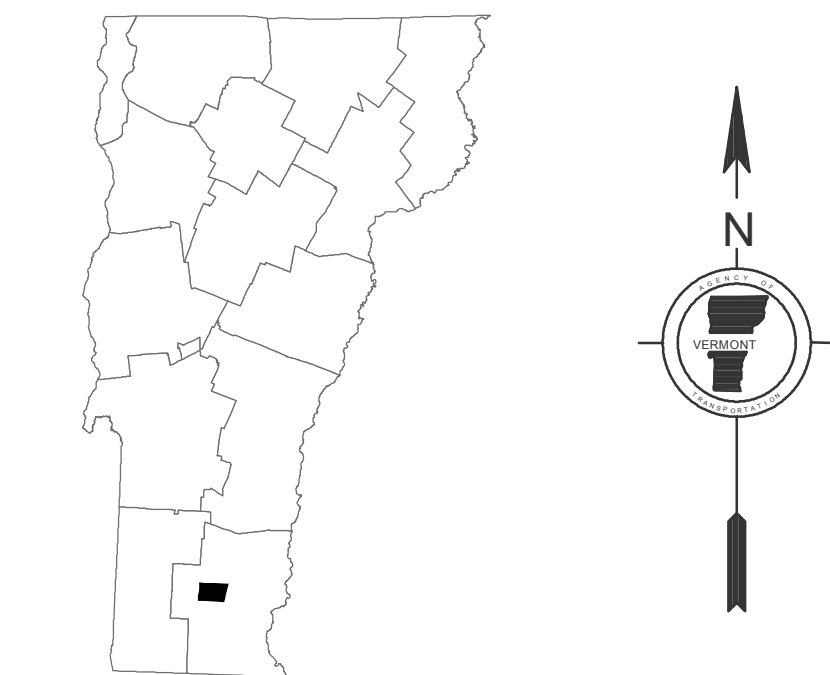

# VERMONT GENERAL HIGHWAY MAP

## Town of Wardsboro

WINDHAM COUNTY

Transportation District #2

Prepared by the  
Vermont Agency of Transportation  
Policy & Planning Division  
in cooperation with  
U.S. Department of Transportation  
Federal Highway Administration

Mileage as of: Feb. 10, 2007  
Map generated: October, 2007

SCALE: 1:25344

