

TOWN HWY. No.	LENGTH IN MILES CLASS 3	LENGTH IN MILES CLASS 4	LEGAL TRAIL No.	LENGTH IN MILES LEGAL TRAIL
4	1.25		1	(0.40)
5	1.20		2	(0.63)
6	0.81			
7	1.47			
8	0.18			
10	0.12			
11	1.55			
12	0.48			
13	0.76			
15	0.34			
16	0.35			
17	1.70			
18	0.76			
19	0.63			
20	0.20			
21	0.33	(0.24)		
22	1.09			
23	0.17			
24	0.20			
25	0.14			
26	0.12			
27	0.10			
28	0.11			
29	0.33			
30	0.07			
31	0.07			
32	0.31			
33		(0.11)		
34		(0.13)		
35	0.15			
36	0.10			
37	0.15			
38	0.12			
39	0.36			
40	0.24			
41	0.62			
42	0.17			
44	0.14			
45	0.16			
46	0.16			
TOTAL	17.21	0.48		

MILEAGE SUMMARY

CLASS 2			
TH-1	2,150		
TH-2	3,890		
TH-3	1,820		
TOTAL CLASS 2	7,860		
CLASS 3			
TOTAL CLASS 3	17.21		
TOTAL TOWN	25.070		
STATE HIGHWAY			
VT-142	8,680		
TOTAL STATE HIGHWAY	8,680		
US HIGHWAY			
US-5	0.218		
TOTAL US HIGHWAY	0.218		
TOTAL STATE	8,898		
INTERSTATE			
I-91	2,742		
TOTAL INTERSTATE	2,742		
TOTAL INTERSTATE	2,742		

TOTAL TRAVELED HIGHWAYS, FEB. 10, 2013: 36.710
(Excludes Class 4, Legal Trail, and Unidentified Corridor Mileage)

- HIGHWAYS**
 - INTERSTATE
 - U.S. ROUTE
 - STATE ROUTE
 - CLASS 1
 - CLASS 2
 - CLASS 3
 - CLASS 4
 - LEGAL TRAIL
 - INTERSTATE OR DIVIDED HIGHWAY
 - STATE - HARD SURFACE OR PAVED
 - TOWN - HARD SURFACE OR PAVED
 - GRAVEL
 - SOIL OR GRADED AND DRAINED EARTH
 - UNIMPROVED OR PRIMITIVE
 - IMPASSABLE OR UNTRAVELED
 - LEGAL TRAIL
 - DISCONTINUED
 - HIGHWAY CLASS CHANGE
 - RAILROAD
 - INACTIVE RAILROAD
 - NFR NATIONAL FOREST ROAD
 - SFH STATE FOREST HIGHWAY
 - P PARK AND RIDE
- POLITICAL SUBDIVISIONS**
 - STATE BOUNDARY
 - COUNTY BOUNDARY
 - TOWN BOUNDARY
 - VILLAGE BOUNDARY
 - URBAN COMPACT BOUNDARY
 - WATER BODY
 - STREAM OR BROOK
- BRIDGE OR CULVERT**
 - BRIDGE OR CULVERT GREATER THAN 20'
 - BRIDGE OR CULVERT 6' - 20'
- STATE BRIDGE OR CULVERT IDENTIFIER**
 - B34 / C34 STATE BRIDGE OR CULVERT IDENTIFIER
 - B34 / C34 TOWN BRIDGE OR CULVERT IDENTIFIER
- PUBLIC LAND - GREEN MOUNTAIN NATIONAL FOREST**
- PUBLIC LAND - STATE/MUNICIPAL**
- FEDERAL CLASSIFICATION IDENTIFIER**
 - FAU URBAN ARTERIAL OR COLLECTOR
 - MA MINOR ARTERIAL
 - MJC MAJOR COLLECTOR
 - MNC MINOR COLLECTOR
 - PA PRINCIPAL ARTERIAL

DISCLAIMER:
The untraveled highways (laid-out town highways), discontinued highways, and legal trails herein are those of which the Agency of Transportation has record; others may exist.

Highway and bridge data by the Agency of Transportation. All other data from the Vermont Center for Geographic Information. Only named streams are shown.

Vermont State Plane Coordinate System
North American Datum of 1983
SPCS_Zone_Identifier: 4400
Geodetic Reference System 80
4,000-meter grid, Easting - Northing

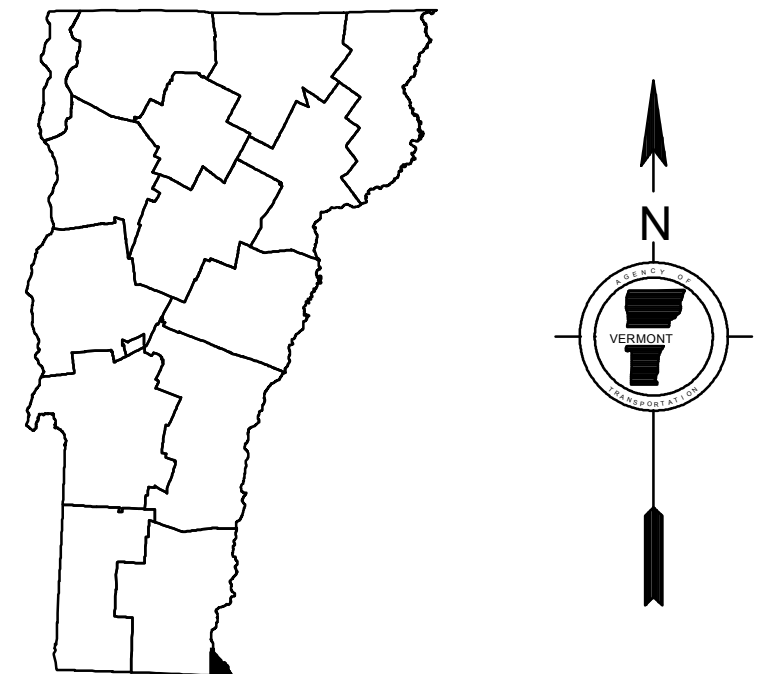
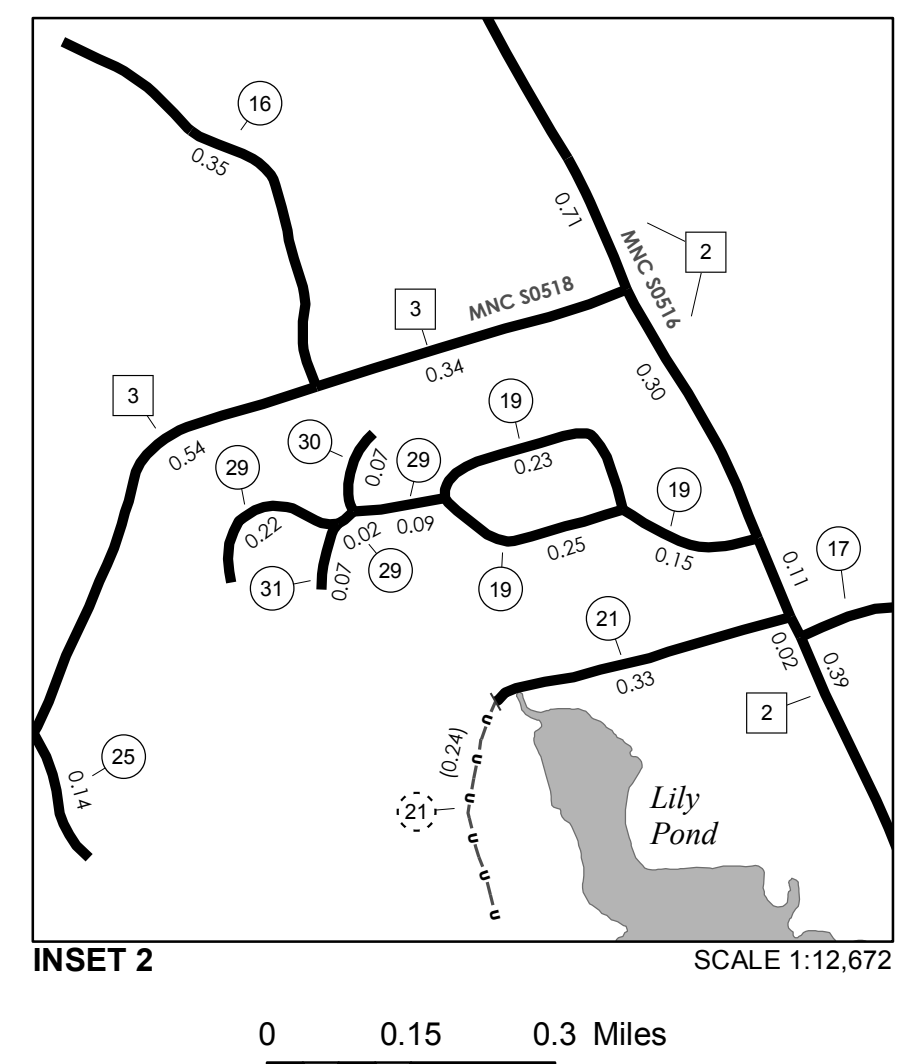
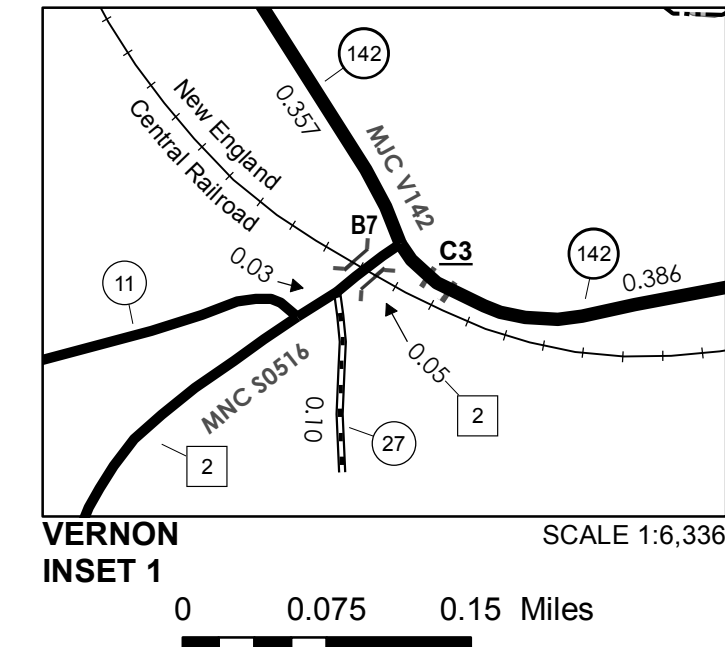

VERMONT
GENERAL HIGHWAY MAP
Town of Vernon

WINDHAM COUNTY
Transportation District #2
Prepared by the
Vermont Agency of Transportation
Division of Policy, Planning and Intermodal Development
in cooperation with
U.S. Department of Transportation
Federal Highway Administration

