

TOWN HWY. NO.	LENGTH IN MILES CLASS 3	LENGTH IN MILES CLASS 4
4	1.250	
5	1.200	
6	0.810	
7	1.470	
8	0.180	
10	0.120	
11	1.630	
12	0.480	
13	0.760	
15	0.340	
16	0.350	
17	1.700	
18	0.760	
19	0.630	
20	0.200	
21	0.330	(0.240)
22	1.090	
23	0.170	
24	0.200	
25	0.140	
26	0.120	
27	0.100	
28	0.110	
29	0.330	
30	0.070	
31	0.070	
32	0.310	
33		(0.110)
34		(0.130)
35	0.150	
36	0.100	
37	0.150	
38	0.120	
39	0.360	
40	0.240	
41	0.620	
42	0.170	
44	0.140	
45	0.160	
46	0.160	
TOTAL	17.290	0.480

MILEAGE SUMMARY

CLASS 2			
TH-1	2.150		
TH-2	3.890		
TH-3	1.820		
TOTAL CLASS 2	7.860		
CLASS 3			
TOTAL CLASS 3	17.290		
TOTAL TOWN	24.830		
STATE HIGHWAY			
VT-142	8.680		
TOTAL STATE HIGHWAY	8.680		
US HIGHWAY			
US-5	0.218		
TOTAL US HIGHWAY	0.218		
TOTAL STATE			
TOTAL STATE	8.898		
INTERSTATE			
I-91	2.742		
TOTAL INTERSTATE	2.742		

TOTAL, TRAVELED HIGHWAYS, FEB. 10, 2007: 36.790
(Excludes Class 4 and Legal Trail Mileage)

- HIGHWAYS**
- INTERSTATE
 - U.S. ROUTE
 - STATE ROUTE
 - CLASS 1
 - CLASS 2
 - CLASS 3
 - CLASS 4
 - LEGAL TRAIL
 - INTERSTATE OR DIVIDED HIGHWAY
 - STATE - HARD SURFACE OR PAVED
 - TOWN - HARD SURFACE OR PAVED
 - GRAVEL
 - SOIL OR GRADED AND DRAINED EARTH
 - UNIMPROVED OR PRIMITIVE
 - IMPASSABLE OR UNTRAVELED
 - LEGAL TRAIL
 - DISCONTINUED
 - HIGHWAY CLASS CHANGE
 - RAILROAD
- FEDERAL CLASSIFICATION IDENTIFIER**
- FAU URBAN ARTERIAL OR COLLECTOR
 - MA MINOR ARTERIAL
 - MJC MAJOR COLLECTOR
 - MNC MINOR COLLECTOR
 - PA PRINCIPAL ARTERIAL
- PUBLIC LAND**
- POLITICAL SUBDIVISIONS**
- STATE BOUNDARY
 - COUNTY BOUNDARY
 - TOWN BOUNDARY
 - VILLAGE BOUNDARY
 - URBAN COMPACT BOUNDARY
- WATER BODIES**
- OPEN WATER
 - SWAMP
 - STREAM OR BROOK
- BRIDGE OR CULVERT**
- BRIDGE OR CULVERT GREATER THAN 20'
 - BRIDGE OR CULVERT 6' - 20'
- B34 STATE BRIDGE IDENTIFIER**
- B34 TOWN BRIDGE IDENTIFIER**

DISCLAIMER:

The untraveled highways (laid-out town highways), discontinued highways, and legal trails shown hereon are those of which the Agency of Transportation has record; others may exist.

Highway and bridge data by the Agency of Transportation, Policy & Planning Division. All other data from the Vermont Center for Geographic Information.

Vermont State Plane Coordinate System
North American Datum of 1983
SPCS_Zone_Identifier: 4400
Geodetic Reference System 80
4,000-meter grid, Easting - Northing

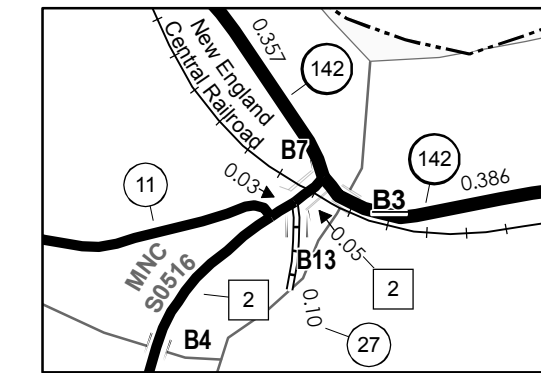
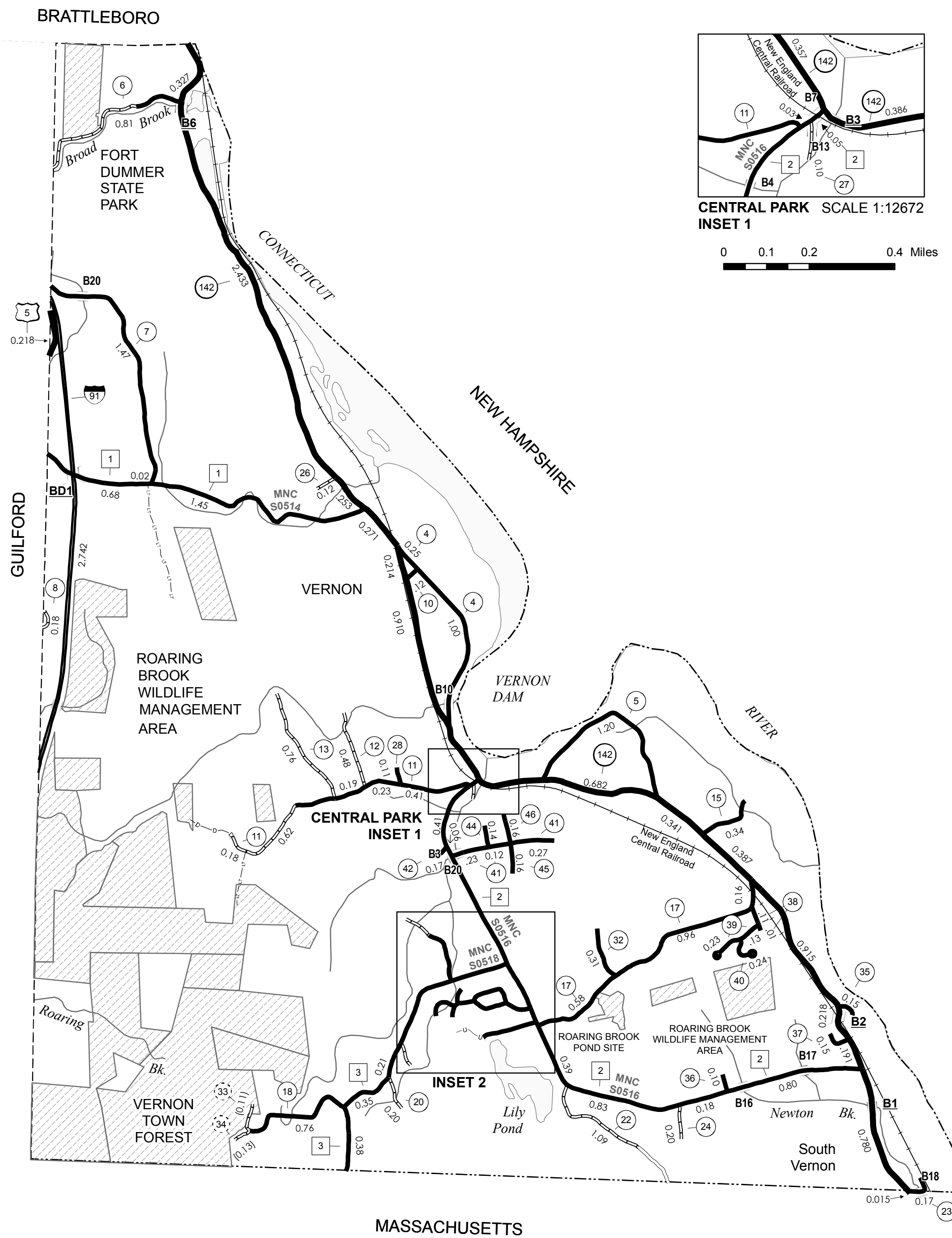

CENTRAL PARK SCALE 1:12672
INSET 1

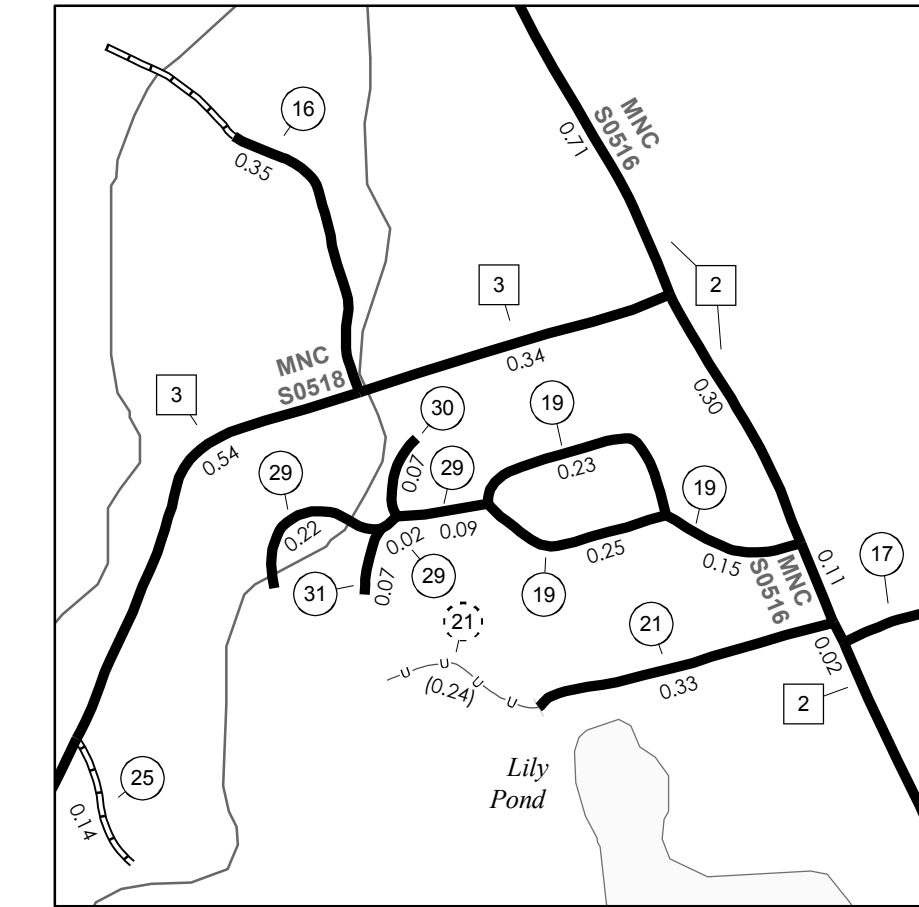
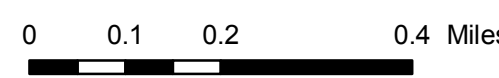

INSET 2 SCALE 1:12672

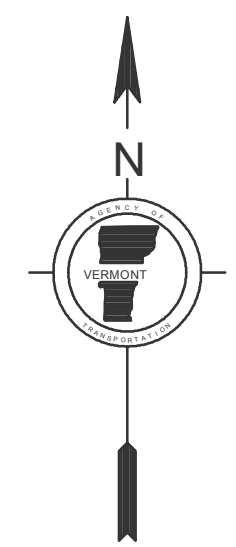
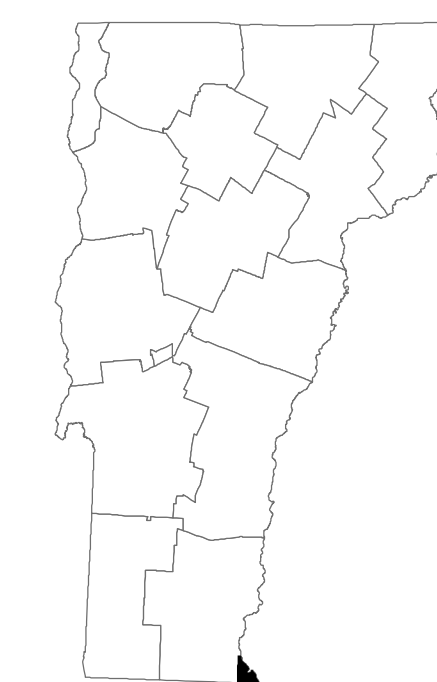
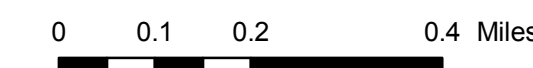

**VERMONT
GENERAL HIGHWAY MAP
Town of Vernon**
WINDHAM COUNTY

Transportation District #2

Prepared by the
Vermont Agency of Transportation
Policy & Planning Division
in cooperation with
U.S. Department of Transportation
Federal Highway Administration

Mileage as of: Feb. 10, 2007
Map generated: October, 2007

SCALE: 1:31680

