

Meas. by - C. H. Brooks
 - H. Wheeler - (Selectman) - 10/25/31

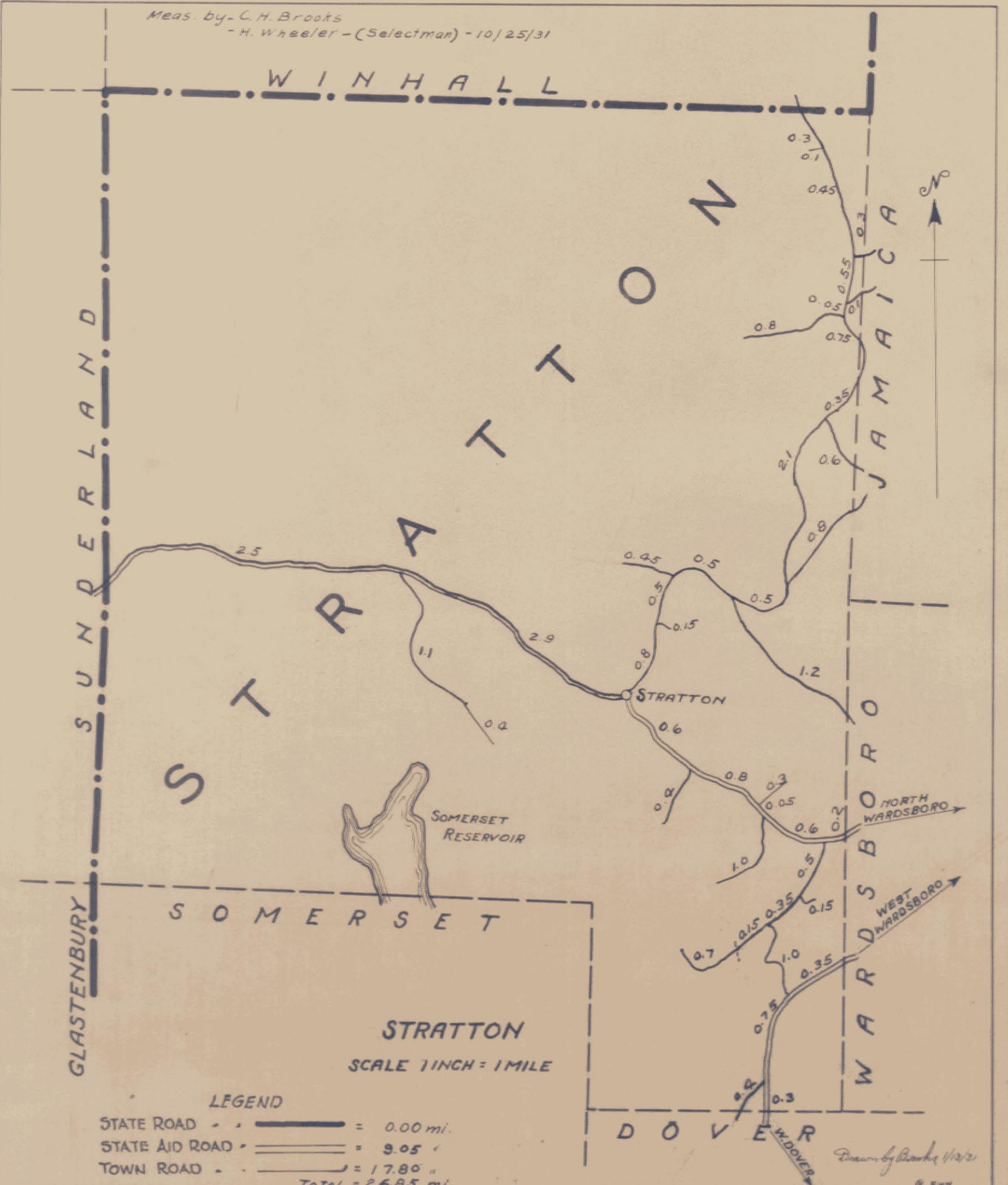

W I N H A L L

G L A S T E R L A N D

S T R A T T O N

J A M A I C A

S O M E R S E T

W A R D S B O R O

D O V E R

STRATTON

SOMERSET RESERVOIR

NORTH WARDSBORO

WEST WARDSBORO

W. DOVER

SCALE 1 INCH = 1 MILE

LEGEND

STATE ROAD - - - - - = 0.00 mi.

STATE AID ROAD - - - - - = 9.05 "

TOWN ROAD - - - - - = 17.80 "

Total = 26.85 mi.

Drawn by Brooks 1/12/32
 G. E. W. H.

District No. 2