

TOWN HWY. NO.	CLASS 3	CLASS 4	TOWN HWY. NO.	CLASS 3	CLASS 4
5	3.65		108	0.10	
6	3.72		109	0.05	(0.50)
7	2.53		110	0.03	
8	1.27		110		(0.07)
9	0.16		112	0.20	
10	0.40		113	0.15	
11	0.21		114		(1.41)
12	3.38		115	0.17	
13	0.03		116		(0.45)
14	1.44		117		(0.56)
15		(0.30)	118		(0.91)
16	0.54		119		(0.28)
17	0.27		120		(1.53)
18	0.07	(0.20)	121		(0.58)
18		(0.10)	122		(0.51)
19	0.70		300	0.09	
20	0.81		302	0.48	
21		(0.20)	304	0.27	
22	0.89		305	0.22	
23	0.81		306	0.24	
24	0.26		308	0.45	
26	0.20		310	0.05	
27	0.79		312	0.06	
28	0.41		314	0.08	
29	0.05		316	0.36	
31	0.44		318	0.09	
32	0.70		320	0.10	
33	1.52		322	0.10	
34	0.81		324	0.09	
35	0.06		326	0.19	
36	0.45		328	0.10	
37	2.21	(1.23)	330	0.09	
38	0.30		332	0.27	
39	0.29		334	0.06	
40	0.30		336	0.05	
41	0.58		338	0.07	
42	1.07	(0.17)	340	0.44	
43	0.10		342	0.13	
44	0.06		344	0.47	
45		(0.16)	346	0.10	
46	2.31		348	0.13	
47	0.19		350	0.69	
48	0.14		352	0.04	
49	0.25		354	0.21	
50	1.20		356	0.09	
51	1.31		358	0.09	
52	1.33		360	0.08	
53	0.58		362	0.10	
54	0.59	(0.07)	364	0.07	
55	0.53		366	0.09	
56	0.18		368	0.09	
57	0.35		370	0.04	
58	0.46	(0.91)	372	0.08	
59	0.37		374	0.08	
60		(0.07)	376	0.27	
61		(0.11)	378	0.09	
62		(0.30)	380	0.30	
63	0.09		382	0.15	
64	0.53		383	0.18	
65	0.06		384	0.17	
66	0.02		386	0.20	
67	0.13		388	0.04	
68	0.19		390	0.12	
69		(1.74)	392	0.08	
70		(0.07)	394	0.15	
72	0.19		396	0.04	
73		(0.01)	398	0.11	
74	0.17		400	0.15	
75	0.63		404	0.06	
77	0.16		406	0.22	
78	0.73		408	0.05	
79	0.14		410	0.05	
80	0.08		412	0.22	
81	0.15		414	0.03	
82	0.31	(0.59)	416	0.13	
83	0.82		418	0.21	
84	0.10	(0.50)	420	0.12	
84		(0.90)	422	0.31	
85	0.15		424	0.14	
86	0.06		426	0.05	
87	0.19		428	0.18	
88	0.22		430	0.24	
89	0.11		432	0.09	
91	0.16		434	0.06	
92	0.10		436	0.10	
93	0.07		438	0.29	
94	0.14		440	0.35	
95	0.18	(0.06)	442	0.20	
96	0.17		444	0.16	
97	0.24		446	0.15	
98	0.20		448	0.09	
99	0.09		450	0.28	
100	0.14		452	0.03	
102	0.26		454		(0.33)
103		(0.07)	455		(0.03)
104	0.02		456		(0.03)
105	0.09		457		(0.22)
107	0.07				
TOTAL			61.52	15.17	

* This portion of town highways Class 3, but is functionally Class 4

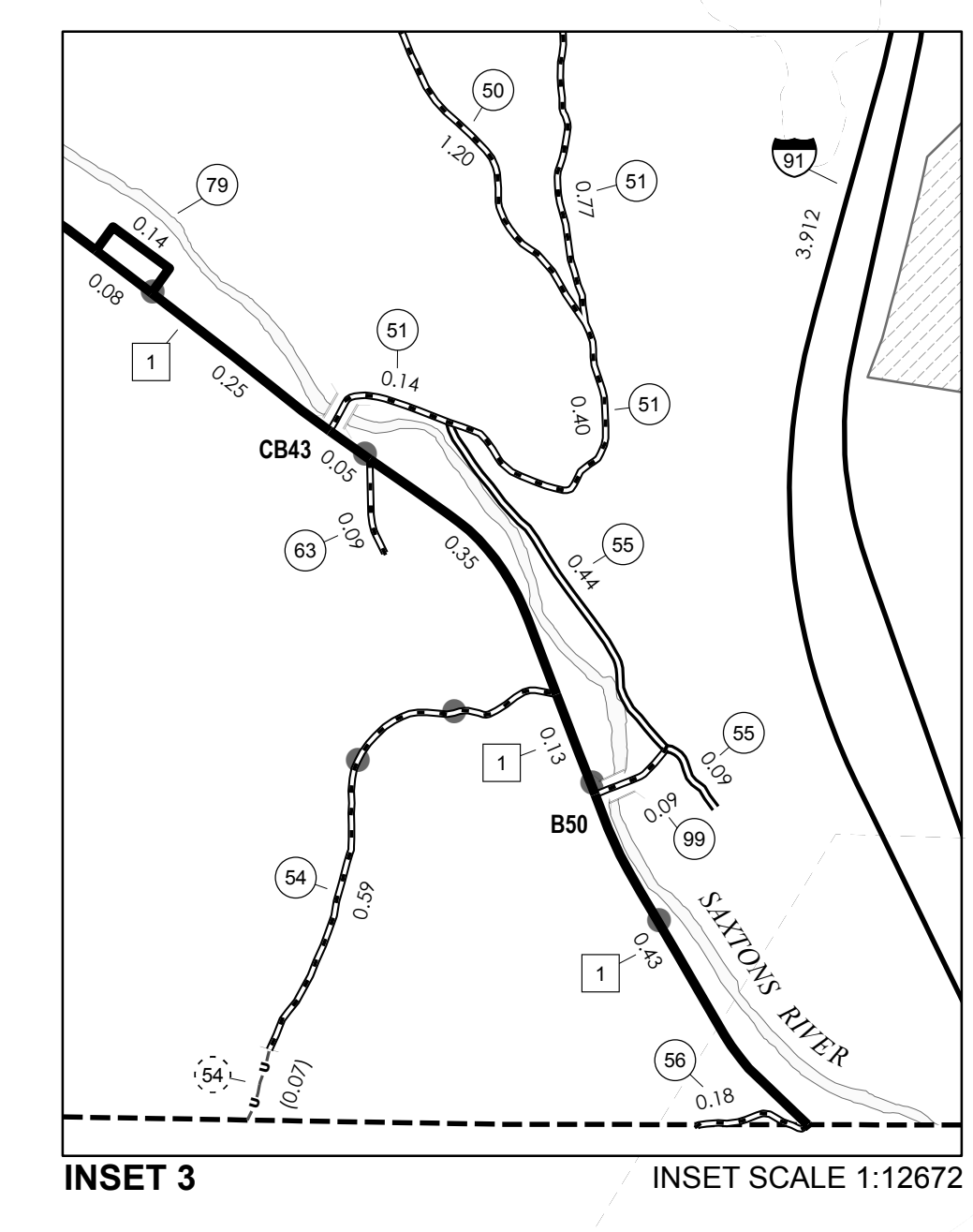
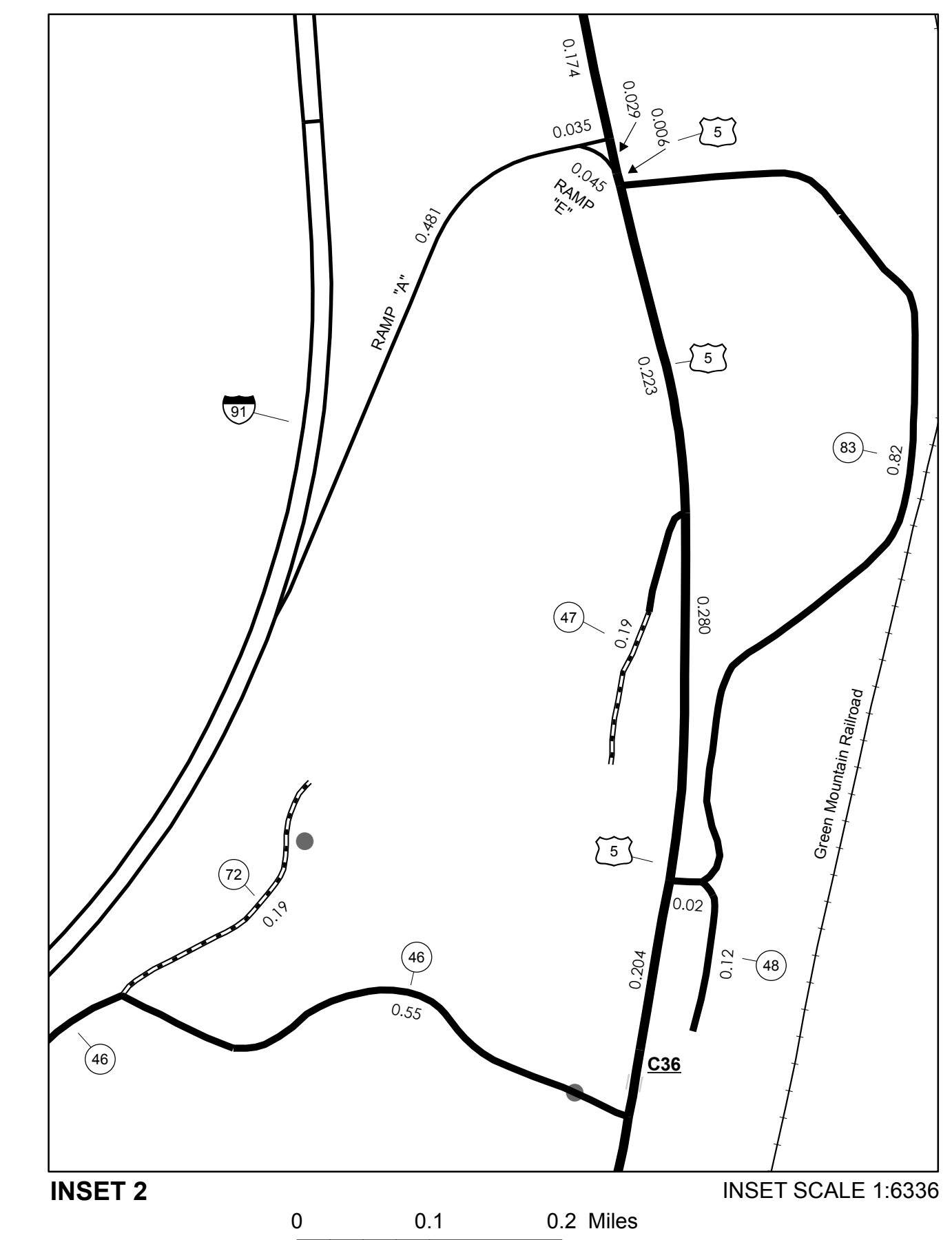
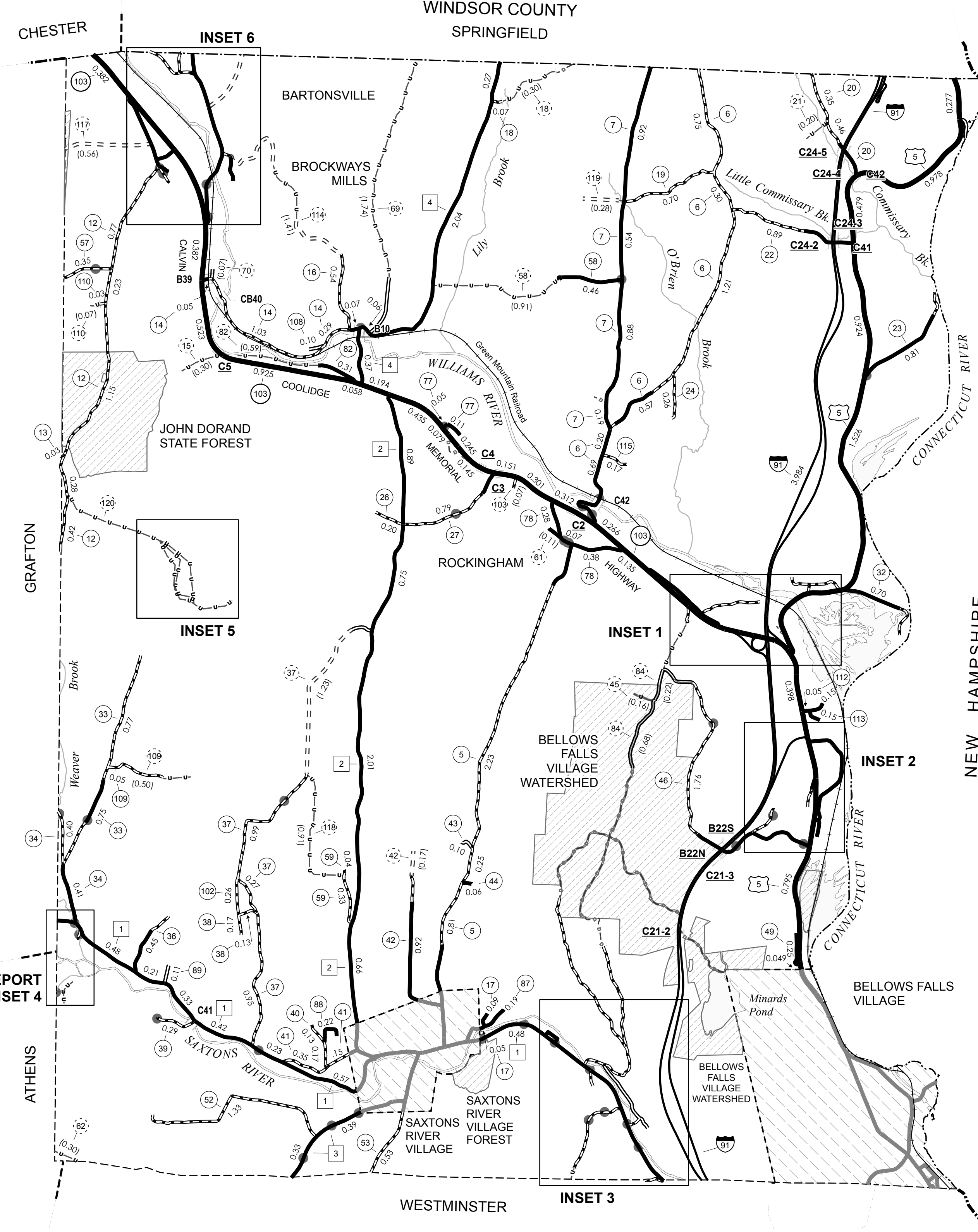
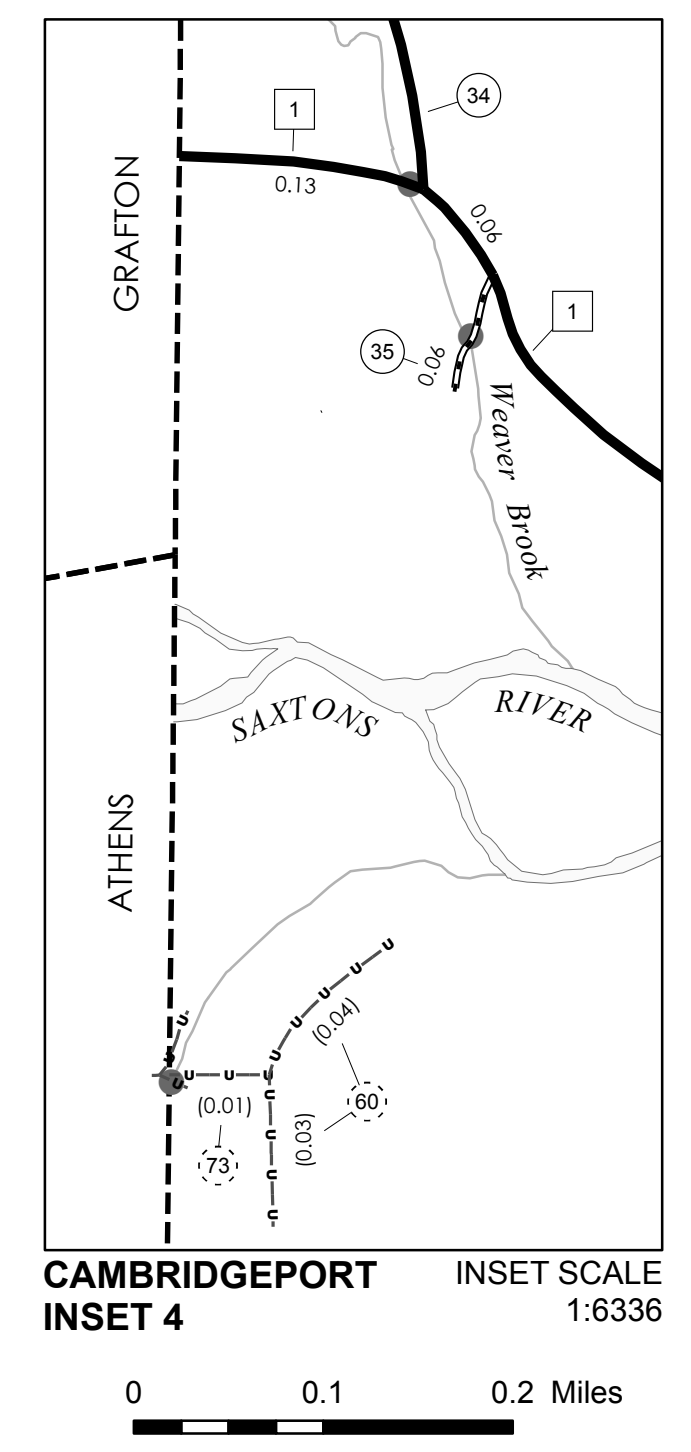
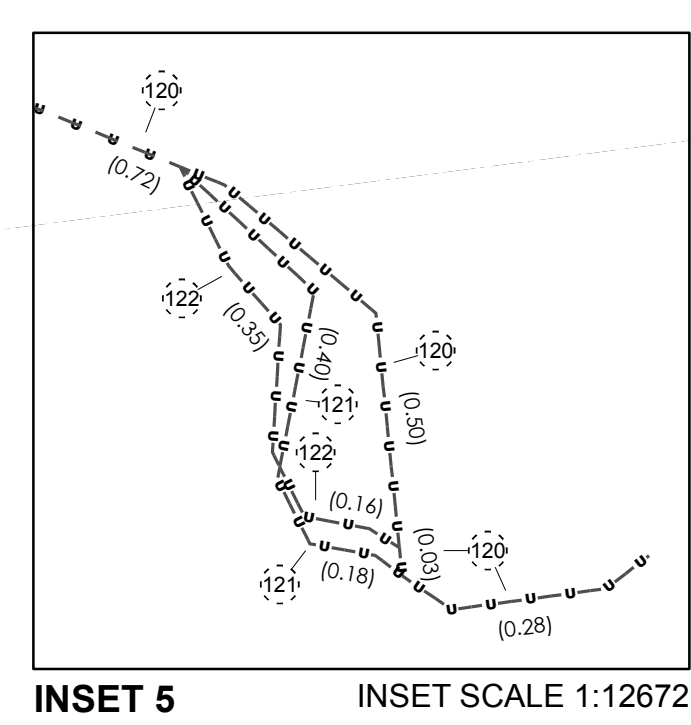
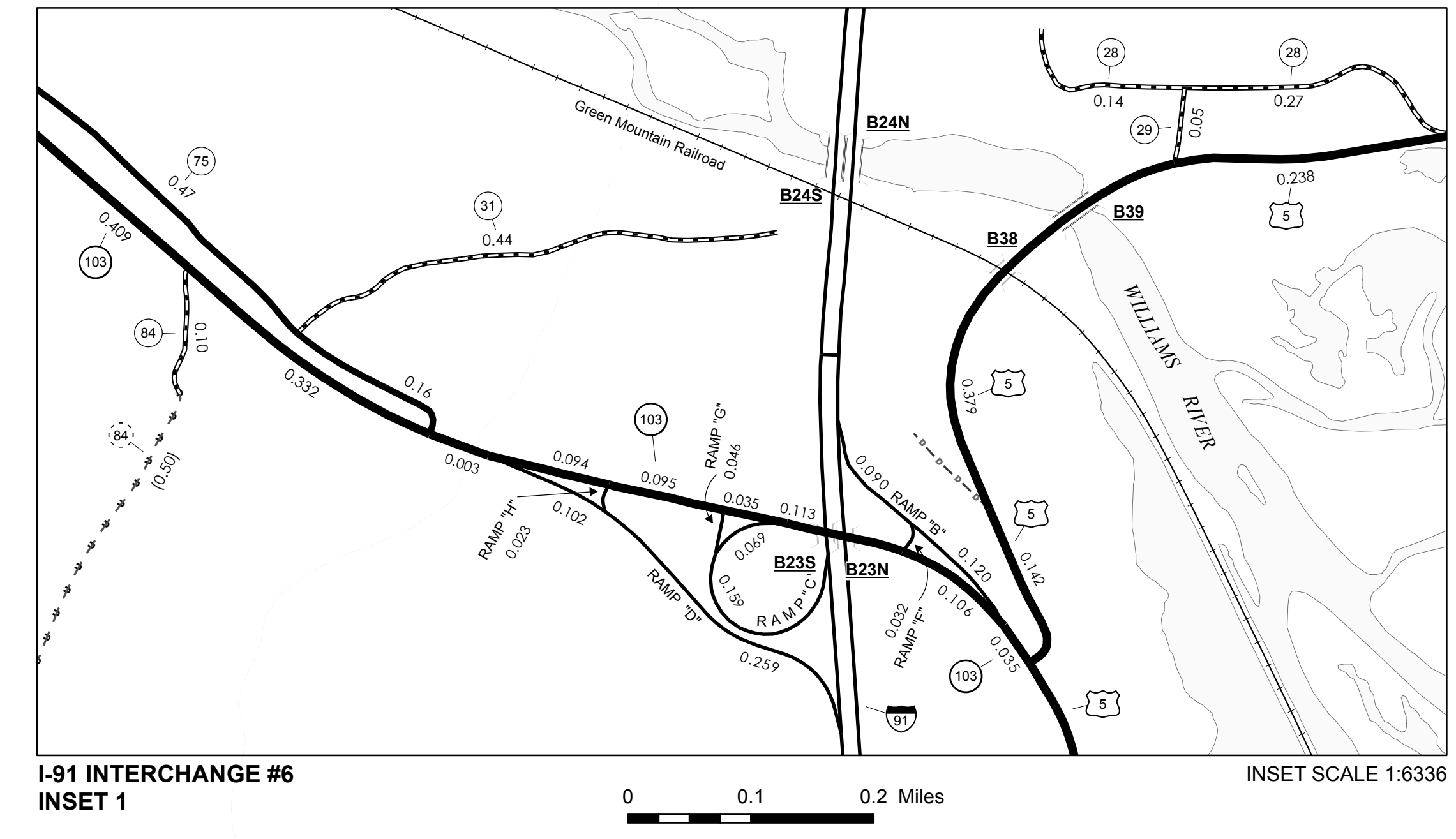
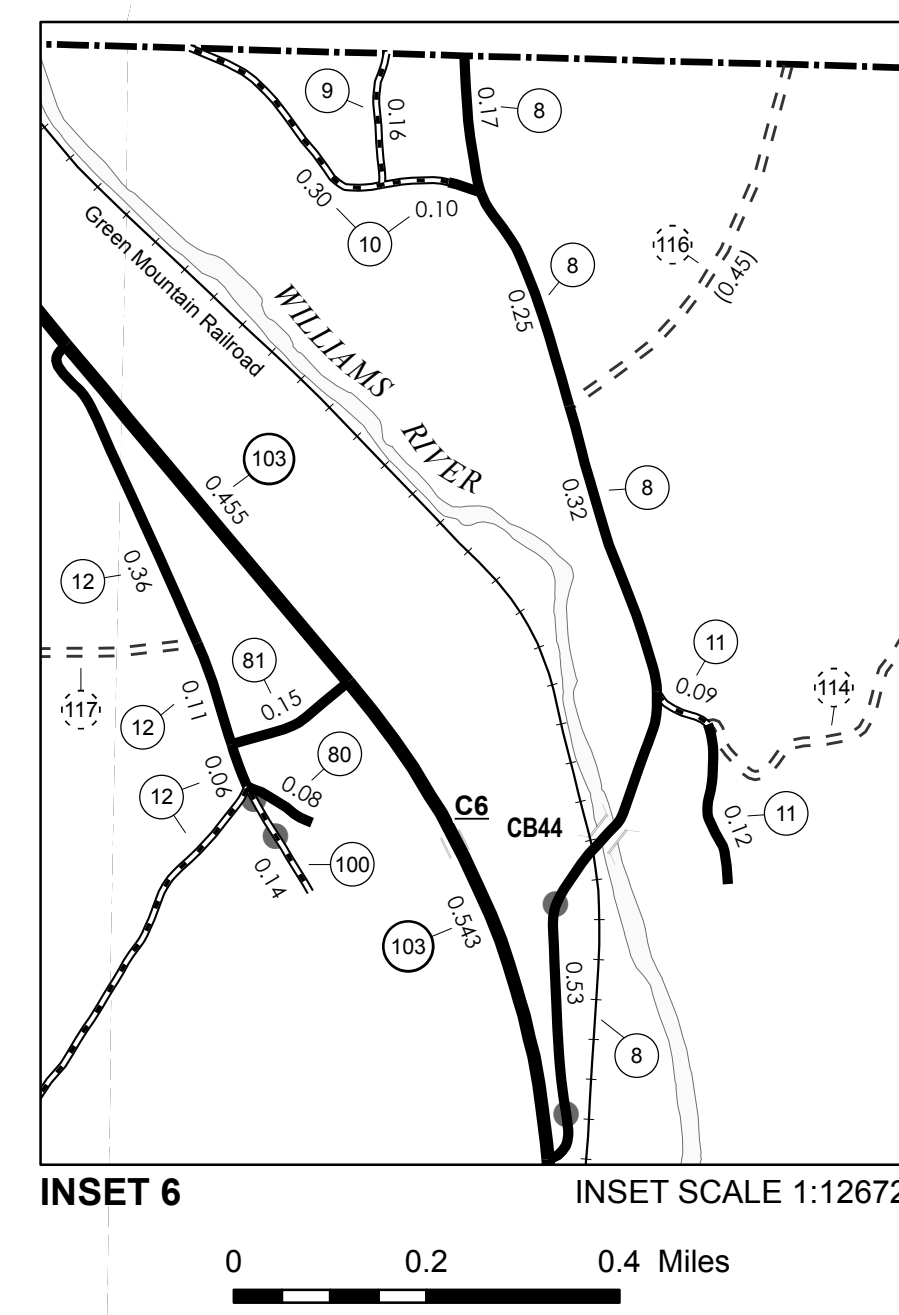

MILEAGE SUMMARY

CLASS	TH-1	TH-2	TH-3	TH-4	TH-5	TH-6	TH-7	TOTAL CLASS
CLASS 1	1.493							1.493
CLASS 2	5.190	4.670	1.320	2.740	1.307	0.249	0.040	15.516
CLASS 3								61.520
TOTAL CLASS								78.529
STATE HIGHWAY	6.753							6.753
US HIGHWAY		7.361						7.361
TOTAL STATE HIGHWAY		14.114						14.114
INTERSTATE		7.896						7.896
INTERSTATE - Ramp		1.461						1.461
TOTAL INTERSTATE		9.357						9.357

TOTAL, TRAVELED HIGHWAYS, FEB. 10, 2010: 102,000
(Excludes Class 4 and Legal Trail Mileage)

- HIGHWAYS**
- INTERSTATE
 - U.S. ROUTE
 - STATE ROUTE
 - CLASS 1
 - CLASS 2
 - CLASS 3
 - CLASS 4
 - LEGAL TRAIL
 - INTERSTATE OR DIVIDED HIGHWAY
 - STATE - HARD SURFACE OR PAVED
 - TOWN - HARD SURFACE OR PAVED
 - GRAVEL
 - SOIL OR GRADED AND DRAINED EARTH
 - UNIMPROVED OR PRIMITIVE
 - IMPASSABLE OR UNTRAVELED
 - LEGAL TRAIL
 - DISCONTINUED
 - HIGHWAY CLASS CHANGE
 - RAILROAD
- BRIDGE OR CULVERT**
- BRIDGE OR CULVERT GREATER THAN 20'
 - BRIDGE OR CULVERT 6' - 20'
 - TOWN SHORT STRUCTURE
 - B34 / C34 STATE BRIDGE OR CULVERT IDENTIFIER
 - B34 / C34 TOWN BRIDGE OR CULVERT IDENTIFIER
- PUBLIC LAND**
- POLITICAL SUBDIVISIONS**
- STATE BOUNDARY
 - COUNTY BOUNDARY
 - TOWN BOUNDARY
 - VILLAGE BOUNDARY
 - URBAN COMPACT BOUNDARY
 - WATER BODIES
 - STREAM OR BROOK
- FEDERAL CLASSIFICATION IDENTIFIER**
- FAU URBAN ARTERIAL OR COLLECTOR
 - MA MINOR ARTERIAL
 - MJC MAJOR COLLECTOR
 - MNC MINOR COLLECTOR
 - PA PRINCIPAL ARTERIAL

STRUCTURES - SURFACE WATER NOTE:

STRUCTURES:
Town short structures (bridges or culverts from 6 feet to less than 20 feet) are drawn from the Vermont Online Bridge & Culvert Inventory Tool (VOBCIT) database.
NOTE: Town shorts are not consistently tagged within VOBCIT.

SURFACE WATERS:
The surface waters are from the Vermont Hydrological Dataset (VHD). Only the named streams are shown.

DISCLAIMER:
The untraveled highways (bid-out town highways), discontinued highways, and legal trails shown hereon are those of which the Agency of Transportation has record; others may exist.
Highway and bridge data by the Agency of Transportation. All other data from the Vermont Center for Geographic Information.

VERMONT GENERAL HIGHWAY MAP
Town of Rockingham

WINDHAM COUNTY
Transportation District #2

Prepared by the
Vermont Agency of Transportation
Division of Planning, Outreach
and Community Affairs
in cooperation with
U.S. Department of Transportation
Federal Highway Administration

Mileage as of February 10, 2010
Map prepared June 30, 2010

SCALE 1:31,680

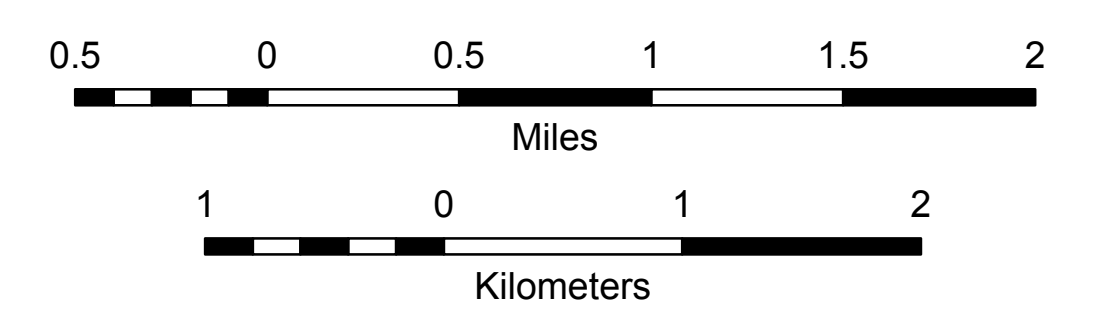

Vermont State Plane Coordinate System
North American Datum of 1983
SPCS Zone Identifier: 4400
Geodetic Reference System 80
4,000-meter grid, Easting - Northing